

# **STAGE 2 SUGGESTED CONSTRUCTION TRAFFIC CONTROL AND PROTECTION GENERAL NOTES**

- TRAFFIC CONTROL AND PROTECTION SHALL BE IN ACCORDANCE WITH THE STANDARD SPECIFICATIONS, CONTRACT SPECIAL PROVISIONS, CONSTRUCTION STAGING PLANS, THE LATEST EDITION OF THE "MANUAL OF UNIFORM TRAFFIC CONTROL DEVICES FOR STREETS AND HIGHWAYS," AND AS DIRECTED BY THE ENGINEER. TRAFFIC CONTROL SHOWN IN THE CONSTRUCTION STAGING PLAN REPRESENTS A GUIDE FOR THE SAFE MANAGEMENT OF TRAFFIC DURING THE EXECUTION OF THE WORK. MODIFICATIONS MAY BE NECESSARY DUE TO LOCAL CONDITIONS AT THE TIME OF CONSTRUCTION. ANY PROPOSED CHANGES BY THE CONTRACTOR TO THESE TRAFFIC CONTROL PLANS SHALL BE APPROVED BY THE ENGINEER PRIOR TO BEING IMPLEMENTED. ANY MODIFICATIONS OR ADDITIONS REQUIRED BY THE ENGINEER WILL BE INCLUDED IN THE COST OF TRAFFIC CONTROL AND PROTECTION, (SPECIAL) UNLESS A SEPARATE PAY ITEM HAS BEEN ESTABLISHED FOR THE WORK.
- ANY EXISTING OR TEMPORARY MARKINGS WHICH CONFLICT WITH MARKINGS REQUIRED FOR CONSTRUCTION STAGING SHALL BE REMOVED ACCORDING TO SECTION 703 OR 783 OF THE STANDARD SPECIFICATIONS, AS APPLICABLE.
- THERE SHALL BE AT LEAST ONE LANE OF TRAFFIC OPEN ON IL 171 IN BOTH DIRECTIONS AT ALL TIMES. THE OUTSIDE LANES OF IL 171 MAY BE CLOSED TO PROVIDE A SAFETY WORK ZONE FOR CONSTRUCTION OPERATIONS ON WEEKDAYS FROM 9AM TO 3PM. IL 171 WILL OPERATE WITH TWO LANES OPEN IN EACH DIRECTION DURING ALL OTHER TIMES.
- ACCESS TO ADJACENT PROPERTIES AND SIDE STREETS SHALL BE MAINTAINED AT ALL TIMES, EXCEPT AS NOTED HEREIN OR AS APPROVED BY THE ENGINEER. PERMANENT TRAFFIC SIGNAL WORK MAY PROCEED AT ANY TIME DURING CONSTRUCTION IF THE WORK DOES NOT INTERFERE WITH SUBSEQUENT WORK REQUIRED IN THAT AREA.
- 13TH STREET BETWEEN APPROXIMATELY STA 13+50 AND STA 14+50 WILL BE SIGNED AS A ROAD CLOSED IN ORDER TO FACILITATE THE RECONSTRUCTION OF 13TH STREET. THE CONTRACTOR SHALL INSTALL THE SIGNAGE AND APPROPRIATE TRAFFIC CONTROL MEASURES THE DAY BEFORE WORK IN THE AREA IS TO COMMENCE. THE SIGNAGE SHALL BE REMOVED ONCE THE PERTINENT CONSTRUCTION ITEMS ARE COMPLETED AND TWO LANES OF TRAFFIC CAN RESUME AS DIRECTED BY THE ENGINEER. THE MAXIMUM LENGTH OF THE ROAD CLOSED SHALL BE ONE (1) WEEK. SEE 13TH STREET DETOUR PLAN.
- ACCESS TO ADJACENT PROPERTIES AND SIDE STREETS SHALL BE MAINTAINED AT ALL TIMES, EXCEPT AS NOTED HEREIN OR AS APPROVED BY THE ENGINEER. PERMANENT TRAFFIC SIGNAL WORK MAY PROCEED AT ANY TIME DURING CONSTRUCTION AFTER THE TEMPORARY SIGNALS ARE INSTALLED AS LONG AS THAT WORK DOES NOT INTERFERE WITH SUBSEQUENT WORK REQUIRED IN THAT AREA.
- TEMPORARY PAVEMENT MARKING APPLIED TO FINAL PAVEMENT SURFACES AND EXISTING PAVEMENT SURFACES TO REMAIN SHALL BE PAVEMENT MARKING TAPE, TYPE III.
- PLATING AND/OR TEMPORARY DRAINAGE STRUCTURE ADJUSTMENTS MAY BE REQUIRED DUE TO THE STAGING OF CONSTRUCTION. THIS WORK WILL NOT BE PAID FOR SEPARATELY BUT WILL BE INCLUDED IN THE COST OF TRAFFIC CONTROL AND PROTECTION, (SPECIAL).
- AGGREGATE FOR TEMPORARY ACCESS SHALL BE USED TO MAINTAIN PEDESTRIAN WALKWAYS DURING CONSTRUCTION PRIOR TO COMPLETION OF PCC SIDEWALKS.
- SINCE A GRADE CROSSING EXISTS WITHIN THE VICINITY OF THE TEMPORARY TRAFFIC CONTROL ZONE, LANE RESTRICTIONS, FLAGGING OR OTHER OPERATIONS SHALL NOT BE PERFORMED IN A MANNER THAT WILL CAUSE HIGHWAY VEHICLES TO STOP ON THE RAILROAD TRACKS. IF THE QUEUING OF VEHICLES ACROSS THE TRACKS CANNOT BE AVOIDED, A FLAGGER OR UNIFORMED LAW ENFORCEMENT OFFICER SHALL BE PROVIDED AT THE GRADE CROSSING TO MINIMIZE THE POSSIBILITY OF HIGHWAY VEHICLES STOPPING ON THE TRACKS, EVEN THOUGH AUTOMATIC WARNING DEVICES ARE IN PLACE.

## **CONSTRUCTION STAGING LEGEND**

- TRAFFIC CONTROL DEVICE (BARRICADE, DRUM, VERTICAL PANEL) WITH STEADY BURN LIGHT AT 50' C/C (TYP.) ; 25' C/C ON TAPERS; 10' C/C AT INTERSECTION RETURNS AND DRIVEWAYS
- WORK ZONE
- DIRECTION OF TRAFFIC MOVEMENT
- TYPE III BARRICADE WITH 2 2-WAY FLASHING LIGHTS WITH ROAD CLOSED SIGN
- TEMPORARY INFORMATION SIGN/TRAFFIC CONTROL SIGN

## **STAGE 2 SUGGESTED CONSTRUCTION SEQUENCE**

- UPDATE CHANGEABLE MESSAGE SIGNS (4 TOTAL) ON NORTHBOUND AND SOUTHBOUND IL 171 AND EASTBOUND AND WESTBOUND 13TH STREET FIVE DAYS PRIOR TO COMMENCEMENT OF WORK TO NOTIFY THE MOTORING PUBLIC CONCERNING THE UPCOMING ROADWAY RECONSTRUCTION AND CONSTRUCTION.
- ESTABLISH TRAFFIC CONTROL AND PAVEMENT MARKING PER PLAN AND APPLICABLE IDOT STANDARDS.
- INSTALL TEMPORARY EROSION CONTROL DEVICES PER PLAN AND APPLICABLE DETAILS.
- CONSTRUCT CURB AND GUTTER.
- COMMENCE CONSTRUCTION OF PROPOSED TRAFFIC SIGNALS.
- CONSTRUCT AGGREGATE SUBGRADE AND HMA BASE COURSE.
- CONSTRUCT SIDEWALK.
- INSTALL TEMPORARY SEEDING AS REQUIRED.

## **STAGE 3 SUGGESTED CONSTRUCTION SEQUENCE**

- REMOVE EXISTING SURFACE AT INDICATED AREAS.
- CONSTRUCT LEVELING BINDER.
- COMPLETE FINAL PAVEMENT SURFACE COURSE, PAVEMENT MARKING AND SIGNING.
- COMPLETE CONSTRUCTION OF PROPOSED TRAFFIC SIGNALS AND INTERCONNECT.
- COMPLETE LANDSCAPE RESTORATION.

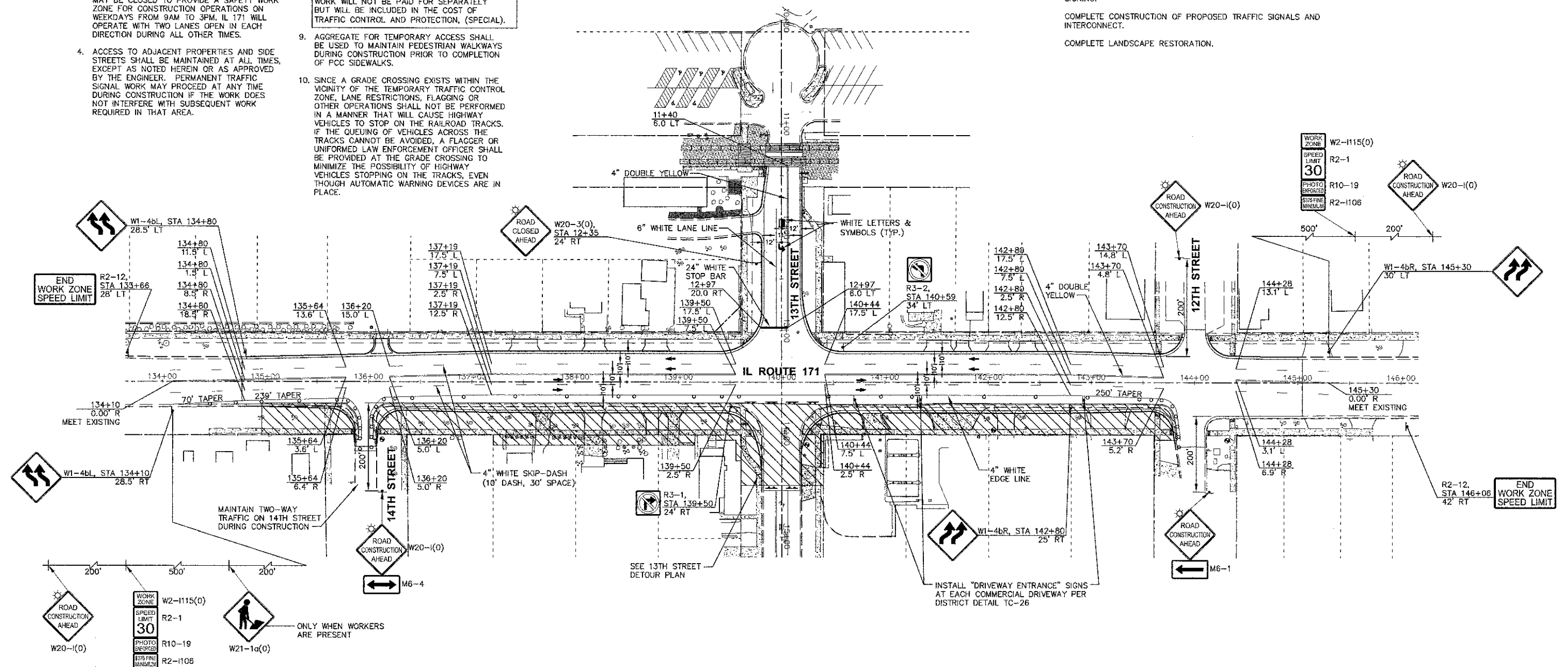
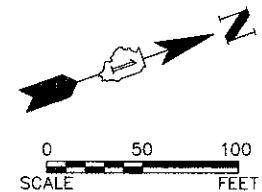

COPYRIGHT © 2013 ENGINEERING ENTERPRISES, INC.

**Engineering Enterprises, Inc.**  
CONSULTING ENGINEERS  
52 Wheeler Road  
Seger Grove, Illinois 60554  
630.466.6700 / www.eelweb.com

USER NAME = Larry Nolan  
DESIGNED - JRL & SWM  
DRAWN - CLN  
CHECKED - JL  
PLOT DATE = March 20, 2013

DESIGNED - JRL & SWM  
DRAWN - CLN  
CHECKED - JL  
DATE - 11/13/12

REVISED - JPS 02/08/13  
REVISED - CLN 03/19/13  
REVISED -  
REVISED -

STATE OF ILLINOIS  
DEPARTMENT OF TRANSPORTATION

**SUGGESTED CONSTRUCTION STAGING PLAN  
STAGE 2 AND STAGE 3**

SCALE: N.T.S. SHEET NO. 4 OF 4 SHEETS STA. N/A TO STA. N/A

F.A.P. RTE.	SECTION	COUNTY	TOTAL SHEETS	SHEET NO.
577	10-00068-00-TL	WILL	65	19
CONTRACT NO. 63788				
FED. ROAD DIST. NO. 1 ILLINOIS FED. AID PROJECT M-90036191				