

REVISIONS

NUMBER	BY	DATE

0 1 2  
 THIS BAR IS EQUAL TO 2"  
 AT FULL SCALE (34X22).

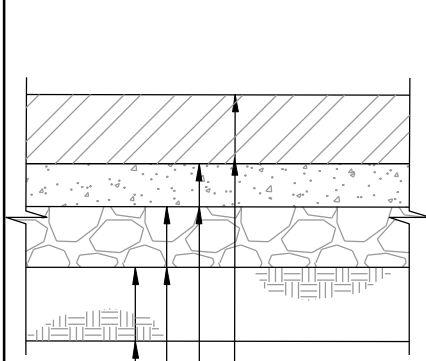
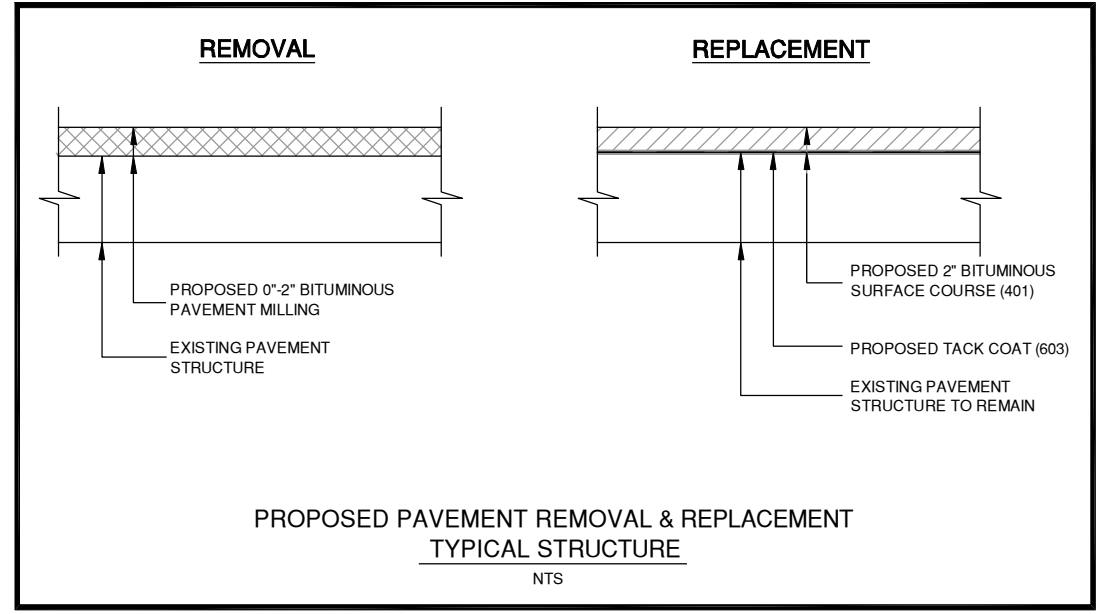
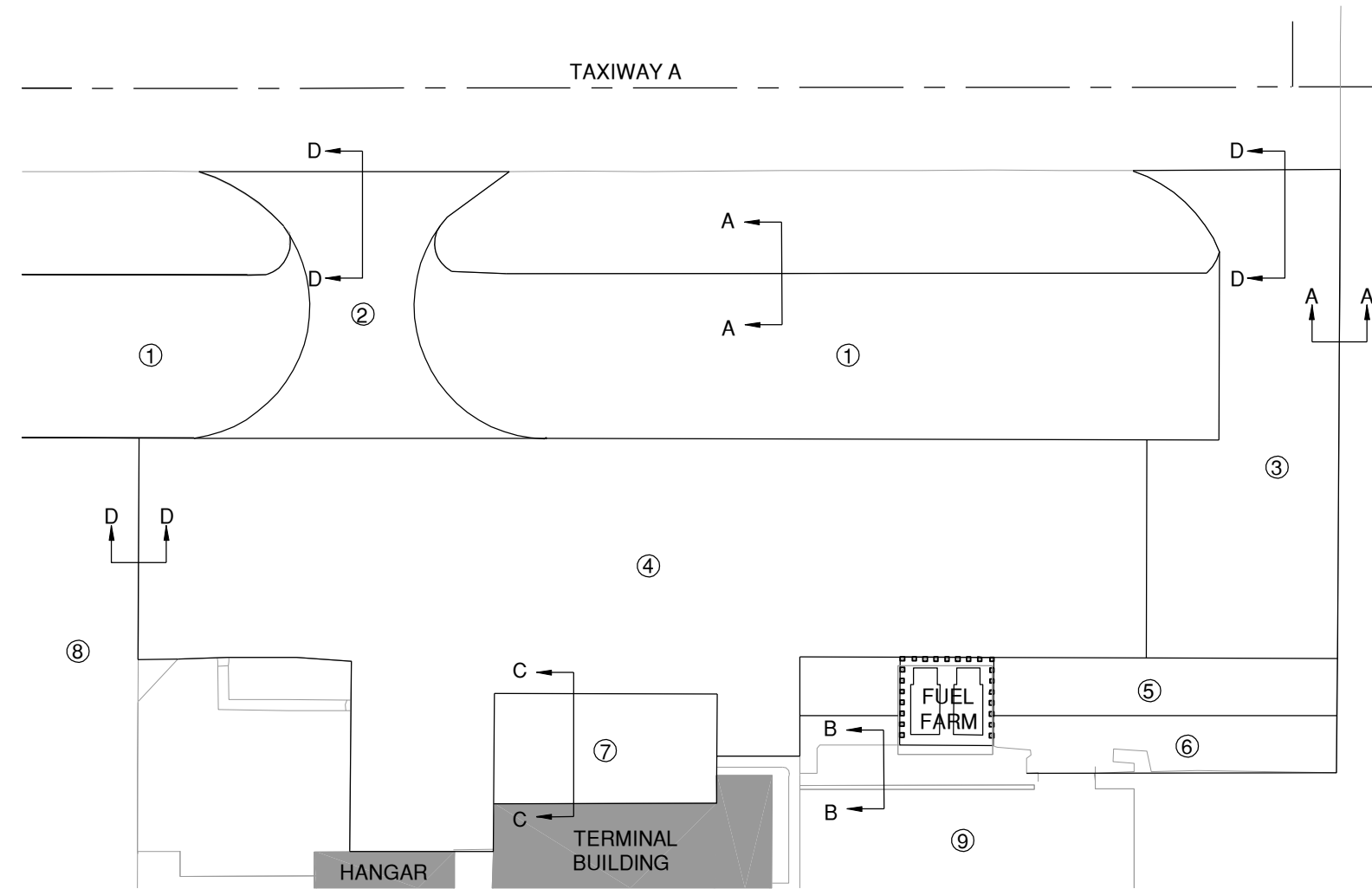
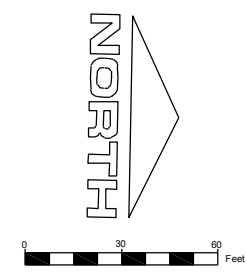
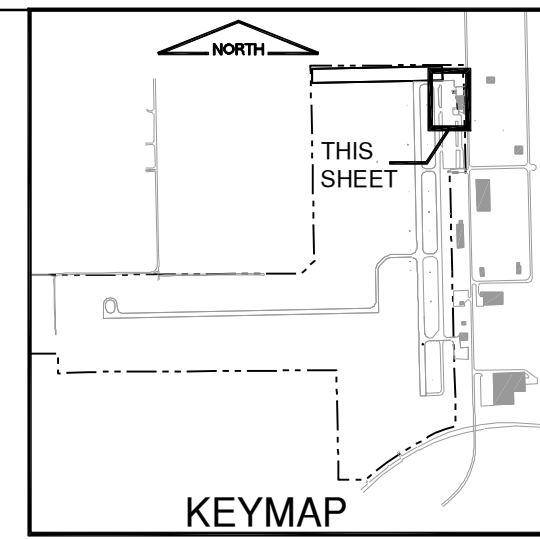

- 4" BITUMINOUS SURFACE COURSE (401)
- 6" CRUSHED AGGREGATE BASE COURSE (209)
- 8" OVERSIZED CRUSHED AGGREGATE BASE
- SUBGRADE

**AREA ①**  
 EXISTING PAVEMENT STRUCTURE  
 NTS

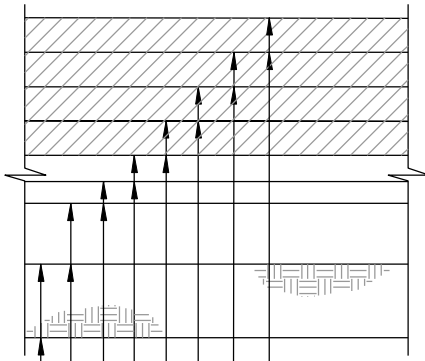

- 2" BITUMINOUS SURFACE COURSE (401)
- 2" BITUMINOUS SURFACE COURSE (401)
- 2" BITUMINOUS SURFACE COURSE (401)
- 2" BITUMINOUS SURFACE COURSE (401)
- 3/4" AVG BITUMINOUS LEVELING COURSE (201)
- 1/2" BITUMINOUS SURFACE COURSE (A-4)
- 6-1/2" SOIL CEMENT
- SUBGRADE

**AREA ②**  
 EXISTING PAVEMENT STRUCTURE  
 NTS

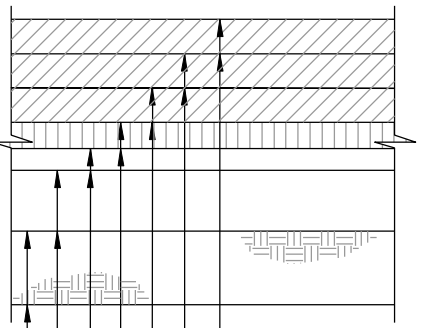

- 2" BITUMINOUS SURFACE COURSE (401)
- 2" BITUMINOUS SURFACE COURSE (401)
- 2" BITUMINOUS SURFACE COURSE (401)
- 3/4" BITUMINOUS LEVELING COURSE (XXX)
- 1/2" BITUMINOUS SURFACE COURSE (401)
- 7" AGGREGATE BASE COURSE (GRADE 2)
- SUBGRADE

**AREA ③**  
 EXISTING PAVEMENT STRUCTURE  
 NTS

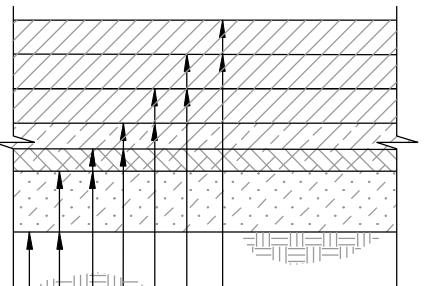

- 2" BITUMINOUS SURFACE COURSE (401)
- 2" BITUMINOUS SURFACE COURSE (401)
- 2" BITUMINOUS SURFACE COURSE (401)
- 3/4" AVG BITUMINOUS LEVELING COURSE (201)
- 1/2" BITUMINOUS SURFACE COURSE (A-4)
- 6-1/2" SOIL CEMENT
- SUBGRADE

**AREA ④**  
 EXISTING PAVEMENT STRUCTURE  
 NTS

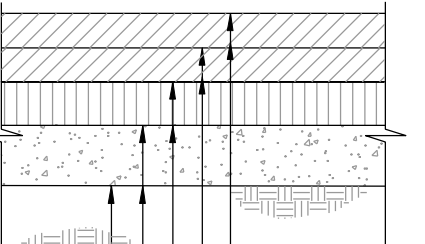

- 2" BITUMINOUS SURFACE COURSE (401)
- 2" BITUMINOUS SURFACE COURSE (401)
- 2" BITUMINOUS SURFACE COURSE (401)
- 2" BITUMINOUS BASE COURSE (201)
- 6" CRUSHED AGGREGATE BASE COURSE (209)
- SUBGRADE

**AREA ⑤**  
 EXISTING PAVEMENT STRUCTURE  
 NTS

**TAYLORVILLE MUNICIPAL AIRPORT**  
**TAYLORVILLE, ILLINOIS**  
**REHABILITATE NORTH PORTION OF AIRCRAFT PARKING APRON**  
**TYPICAL SECTIONS 1**

© Copyright CMT, Inc.  
  
**CMT**  
 CRAWFORD, MURPHY & TLL Y, INC.  
 CONSULTING ENGINEERS  
 License No. 184-000618

DESIGN BY:	AJH
DRAWN BY:	CMT
CHECKED BY:	CBG
APPROVED BY:	CET
DATE:	APRIL 18, 2014
JOB No:	13050-01
IL. PROJ. NO. TAZ-4342	
SBG NO. 3-17-SBGP-XX	
SHEET 06 OF 14 SHEETS	

K:\Taylorville\1305001\Draw\Sheets