

STATE OF ILLINOIS
DEPARTMENT OF TRANSPORTATION
PLAN FOR
PROPOSED LOCAL AGENCY IMPROVEMENT
FEDERAL FUNDED HIGHWAY PROJECT
(EMERGENCY FLOOD DAMAGE REPAIR)

ROUTE NO.	SECTION	COUNTY	TOTAL SHEET	SHEET NO.
C.H. R 40 (FAS 383)	13-00053-05-DR	PEORIA	4	1
FED. ROAD DISTRICT NO.		ILLINOIS	PROJECT: ER-3083 (104)	

INDEX OF SHEETS

- 1 COVER SHEET
- 2 SUMMARY OF QUANTITIES
- 3-4 CONSTRUCTION DETAIL SHEETS

PRINCEVILLE JUBILEE ROAD (C.H. R40)
SECTION NO. 13-00053-05-DR
PROJECT NO. :ER-3083 (104)
JOB NO. : C-94-036-14

PEORIA COUNTY, ILLINOIS

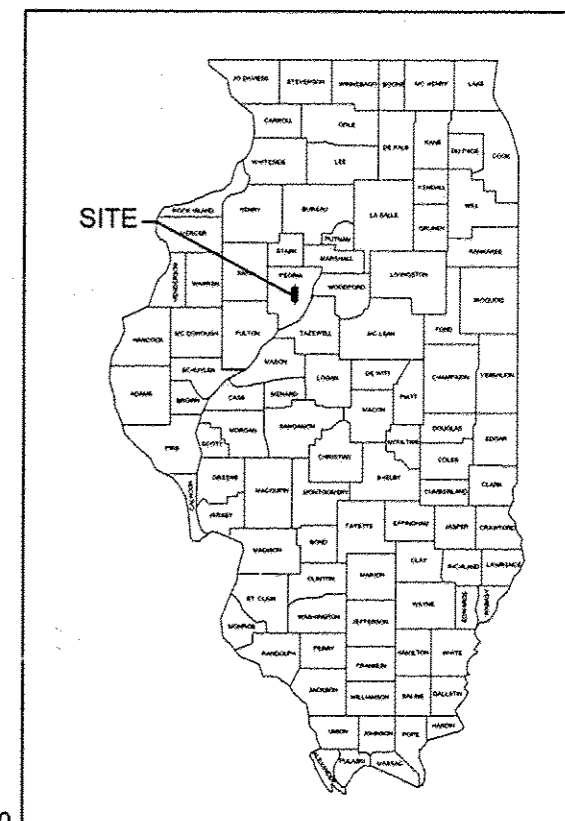

HIGHWAY STANDARDS

- 280001-07 - TEMPORARY EROSION CONTROL SYSTEMS
- 701011-04 - OFF ROAD MOVING OPERATIONS, 2L, 2W, DAY ONLY
- 701201-04 - LANE CLOSURE, 2L, 2W, DAY ONLY, FOR SPEED \geq 45 MPH
- 701301-04 - LANE CLOSURE, 2L, 2W, SHORT TIME OPERATIONS
- 701336-06 - LANE CLOSURE, 2L, 2W, WORK AREAS IN SERIES, FOR SPEED LIMIT \geq 45 MPH
- 701901-03 - TRAFFIC CONTROL DEVICES

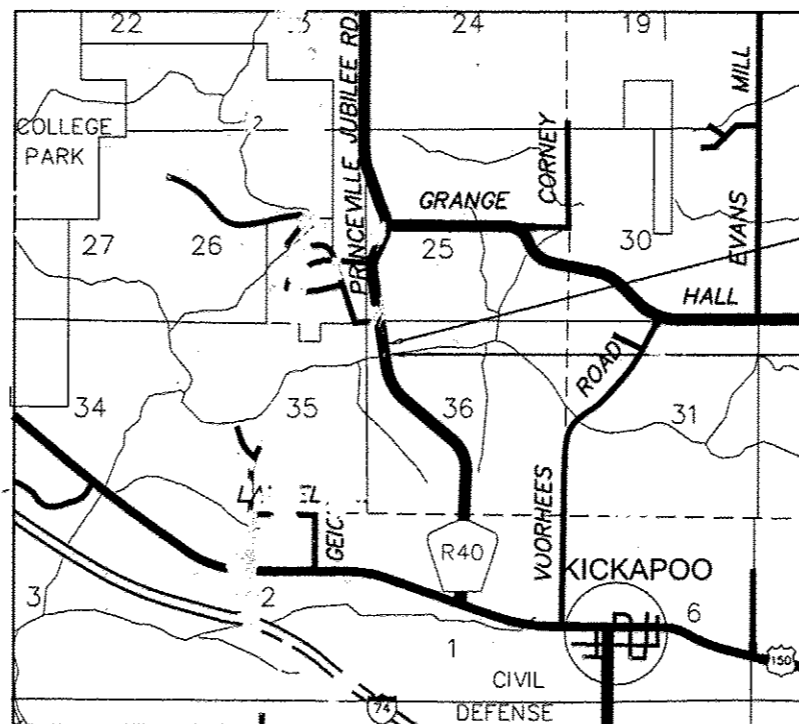

LOCATION MAP



APPROVED	<i>March 24</i>	20 14
	<i>Amy Benecke Peterson</i> PEORIA COUNTY ENGINEER	
PASSED	<i>March 24</i>	20 14
	<i>[Signature]</i> DISTRICT ENGINEER OF LOCAL ROADS & STREETS	
Releasing For Bid Based on Limited Review	<i>MARCH 28</i>	20 14
	<i>[Signature]</i> DEPUTY DIRECTOR OF HIGHWAYS, REGION THREE ENGINEER	
STATE OF ILLINOIS DEPARTMENT OF TRANSPORTATION		

J.U.L.I.E. : 1-800-892-0123

CONTRACT NO. : 89660
CATALOG #035047-00

FUNCTIONAL CLASSIFICATION: MAJOR COLLECTOR
TOTAL AND NET LENGTH OF PROJECT 269 FEET
EX. SPEED LIMIT 55 MPH, WORK ZONE SPEED LIMIT 45 MPH

THESE PLANS WERE PREPARED BY A FULL TIME MEMBER OF MY STAFF UNDER MY PERSONAL SUPERVISION.

Amy Benecke Peterson
PEORIA COUNTY ENGINEER



ROUTE NO.	SECTION	COUNTY	TOTAL SHEET	SHEET NO.
C.H. R. 40 (FAS 383)	13-00053-05-DR	PEORIA	4	3
FED. ROAD DISTRICT NO.	ILLINOIS PROJECT: ER-3083 (104)			
CONTRACT NO.	89660			

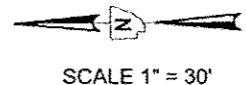

SEEDING CLASS III
 LT. STA. 33+00.00 TO STA. 35+69.00 0.3 ACRES
 RT. STA. 33+00.00 TO STA. 35+69.00 0.2 ACRES
 NOTE: [Pattern] AREA TOTAL = 0.5 ACRES

MULCH, METHOD 1
 LT. & RT. STA. 33+00.00 TO STA. 34+50.00 0.5 ACRES
 NOTE: [Pattern] AREA

EROSION CONTROL BLANKET
 LT. STA. 34+50.00 TO STA. 35+69.00 712 SQ. YD.
 RT. STA. 34+50.00 TO STA. 35+69.00 557 SQ. YD.
 NOTE: [Pattern] AREA TOTAL = 1,269 SQ. YD.

TREE REMOVAL 6 TO 15 UNIT DIAMETER
 STA. 35+55.00 107' LT. 9
 STA. 35+65.00 77' LT. 7
 TOTAL = 16 UNITS

CHANNEL EXCAVATION
 LT. & RT. STA. 35+54.00 TO STA. 35+69.00 302 CU. YD.
 (BRIDGE BANK SLOPES)

CONTROLLED LOW-STRENGTH MATERIAL
 BRIDGE SLOPEWALL UNDERMINED AREA 9 CU. YD.

AGGREGATE FOR TEMPORARY ACCESS
 LT. & RT. STA. 33+00.00 TO STA. 35+69.00 270 TON
 NOTE: SEE SPECIAL PROVISIONS

STONE RIPRAP, CLASS A5 305 SQ. YD.
 FILTER FABRIC 305 SQ. YD.

NITROGEN FERTILIZER NUTRIENTS
 LT. & RT. STA. 33+00.00 TO STA. 35+69.00 43 LB

PHOSPHORUS FERTILIZER NUTRIENTS
 LT. & RT. STA. 33+00.00 TO STA. 35+69.00 43 LB

NITROGEN FERTILIZER NUTRIENTS
 LT. & RT. STA. 33+00.00 TO STA. 35+69.00 43 LB

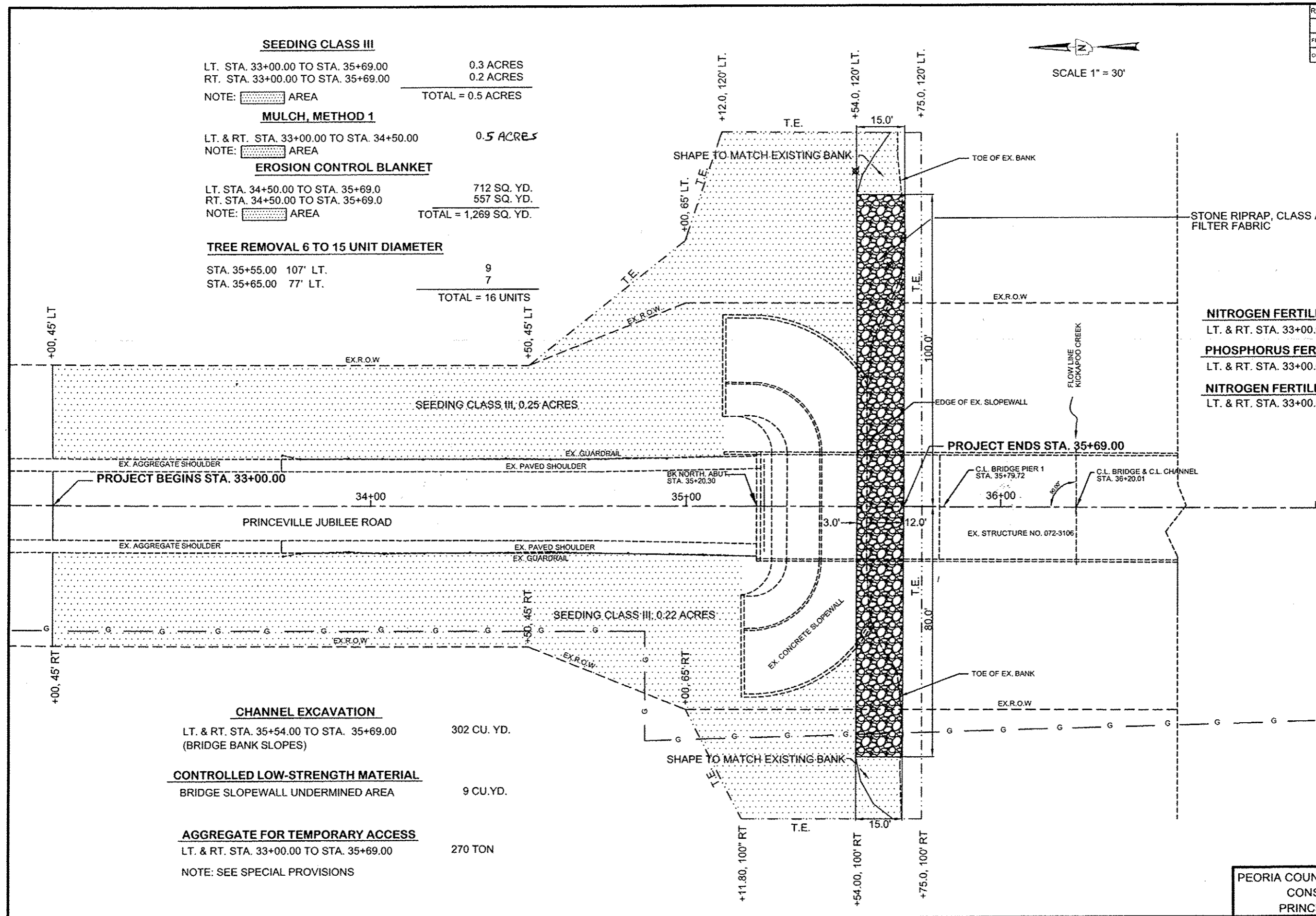

PEORIA COUNTY HIGHWAY DEPARTMENT
 CONSTRUCTION DETAILS
 PRINCEVILLE JUBILEE ROAD

ROUTE NO.	SECTION	COUNTY	TOTAL SHEET	SHEET NO.
C.H. R. 40 (FAS 383)	13-00053-05-DR	PEORIA	4	4
FED. ROAD DISTRICT NO.	ILLINOIS	PROJECT	ER-3083 (104)	
CONTRACT NO. 89660				

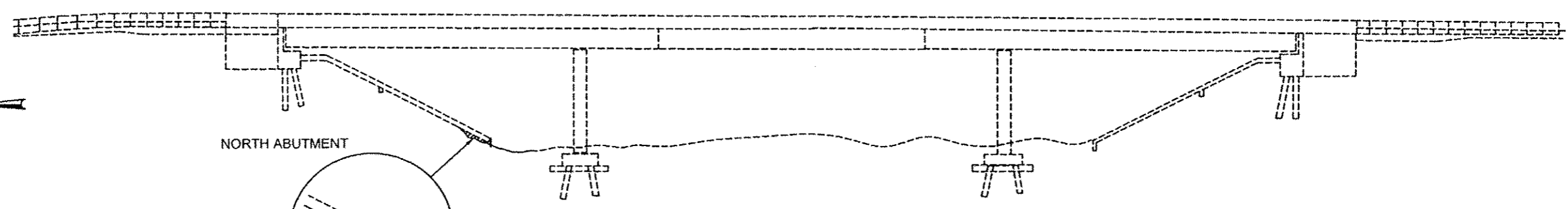
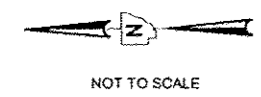

NORTH ABUTMENT

UNDERMINED AREA REPAIR DETAILS

FORM AND CLOSE THE EXPOSED AREA
 FILL UNDERMINED AREA WITH CONTROLLED LOW-STRENGTH MATERIAL AS DIRECTED BY THE ENGINEER.

GENERAL NOTES:

THE STANDARD SPECIFICATIONS ADOPTED JANUARY 1, 2012 BY THE ILLINOIS DEPARTMENT OF TRANSPORTATION SHALL APPLY TO THE WORK OF THIS CONTRACT.
 THE WORK INVOLVED IS FILL CONTROLLED LOW-STRENGTH MATERIAL IN UNDERMINED BRIDGE SLOPEWALL, EXCAVATION INSTALL STONE RIPRAP AT BRIDGE NORTH ABUTMENT AND ADJACENT BANK SLOPE AS SHOWN ON THE PLANS. INCLUDED IN THE UNIT COST FOR CONTROLLED LOW-STRENGTH MATERIAL IS TO FORM AND CLOSE UNDERMINED AREA, DRILL HOLES ON SLOPEWALL, FILL IN CONTROLLED LOW-STRENGTH MATERIAL AS DIRECTED BY THE ENGINEER. INCLUDED IN THE UNIT COST FOR STONE RIPRAP ARE RESHAPING AND COMPACTION OF EARTH REQUIRED TO BUILD THE BRIDGE SLOPEWALL, AND ADJACENT BANK SLOPE AS DIRECTED BY THE ENGINEER. ANY ADDITIONAL MATERIALS OR EQUIPMENT REQUIRED TO COMPLETE THE JOB WILL BE CONSIDERED INCLUDED IN THE COST OF STONE RIPRAP CLASS A5.

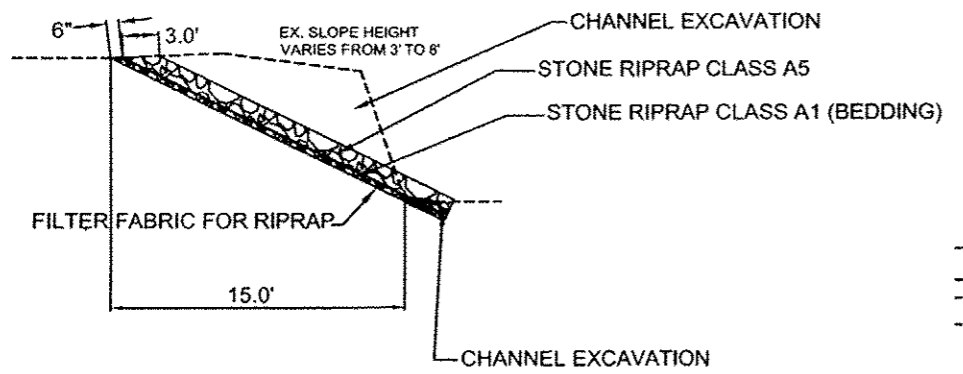

TYPICAL BANK SLOPE DETAILS

STONE RIPRAP DETAILS

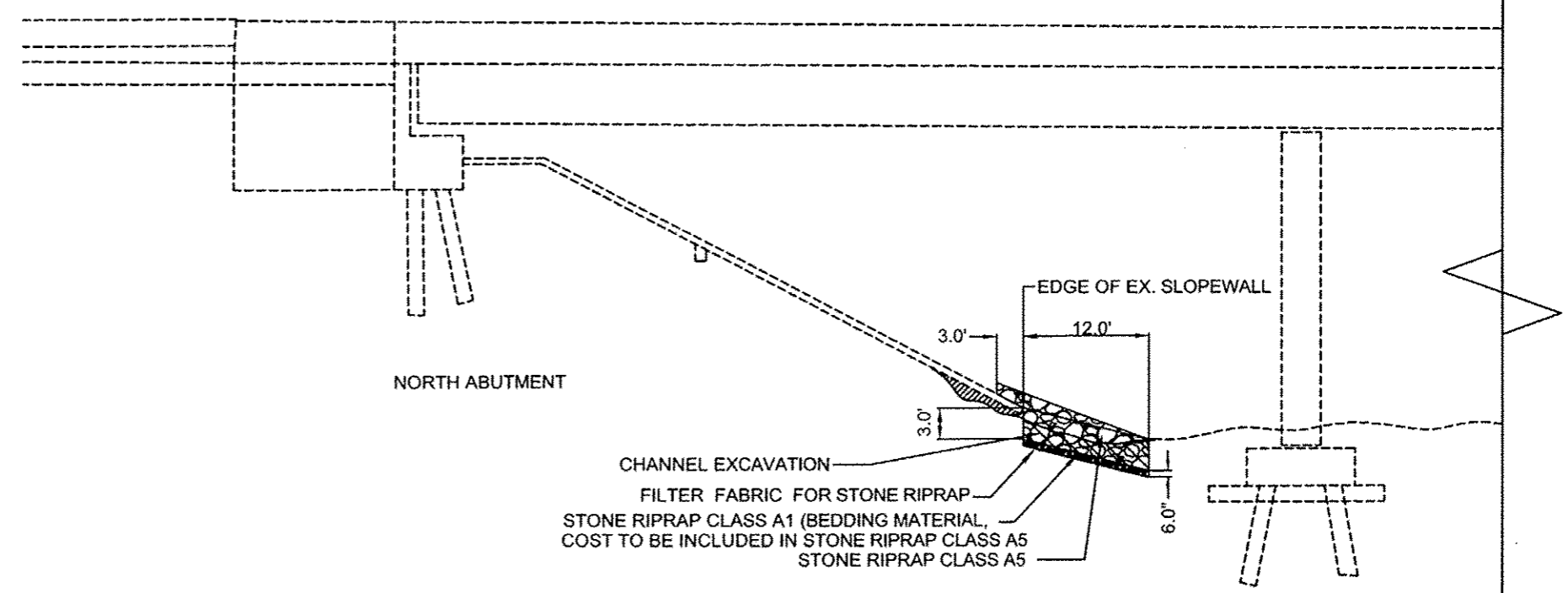

NORTH ABUTMENT

EDGE OF EX. SLOPEWALL
 3.0'
 12.0'
 3.0'
 6.0'

CHANNEL EXCAVATION
 FILTER FABRIC FOR STONE RIPRAP
 STONE RIPRAP CLASS A1 (BEDDING MATERIAL, COST TO BE INCLUDED IN STONE RIPRAP CLASS A5)
 STONE RIPRAP CLASS A5

TYPICAL BRIDGE SLOPE WALL - NORTH ABUTMENT

STONE RIPRAP DETAILS

PEORIA COUNTY HIGHWAY DEPARTMENT
 CONSTRUCTION DETAILS
 PRINCEVILLE JUBILEE ROAD