

STATE OF ILLINOIS
DEPARTMENT OF TRANSPORTATION
DIVISION OF HIGHWAYS
PROPOSED
HIGHWAY PLANS

F.A.P. RTE.	SECTION	COUNTY	TOTAL SHEETS	SHEET NO.
322	(1-1)RS-1, 10RS-2, 9RS-6	JACKSON	26	1
		ILLINOIS	CONTRACT NO. 78414	

FOR INDEX OF SHEETS, SEE SHEET NO 3

STATION EQUATIONS

NB US 51 STA 48+97.77 => SB US 51 PC STA 0N+00.00
 STA 40N+05.50 BK = STA 0S+00.00 AH

OMISSIONS

SOUTHBOUND US 51
 STA 20N+81 TO STA 21N+82
 STA 28N+03 TO STA 28N+60

TRAFFIC DATA

2014 ADT = 9900 WITH 3.6% TRUCKS
 POSTED SPEED = 30 MPH

TOWNSHIP

CARBONDALE

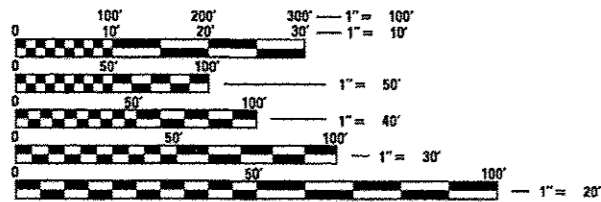

FULL SIZE PLANS HAVE BEEN PREPARED USING STANDARD ENGINEERING SCALES. REDUCED SIZED PLANS WILL NOT CONFORM TO STANDARD SCALES. IN MAKING MEASUREMENTS ON REDUCED PLANS, THE ABOVE SCALES MAY BE USED.

J.U.L.I.E.
 JOINT UTILITY LOCATION INFORMATION FOR EXCAVATION
 1-800-892-0123
 OR 811

PROJECT ENGINEER DARRYL LEFTWICH
PROJECT MANAGER CHARLES STEIN

CONTRACT NO. 78414

FAP ROUTE 322 (US 51)
SECTION (1-1)RS-1, 10RS-2, 9RS-6
3P PROJECT
RESURFACING IN CARBONDALE
JACKSON COUNTY

C-99-040-14

PROJECT : ACF-0322 (102)

R. 1 W.

PROPOSED PROJECT BEGINS
 STATION 47+51.11 SB US 51

PROPOSED PROJECT ENDS
 STATION 6S+20.74 SB US 51

PROPOSED PROJECT BEGINS
 STATION 76+67 NB US 51

PROPOSED PROJECT ENDS
 STATION 94+91.70 NB US 51

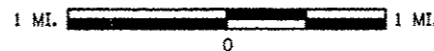
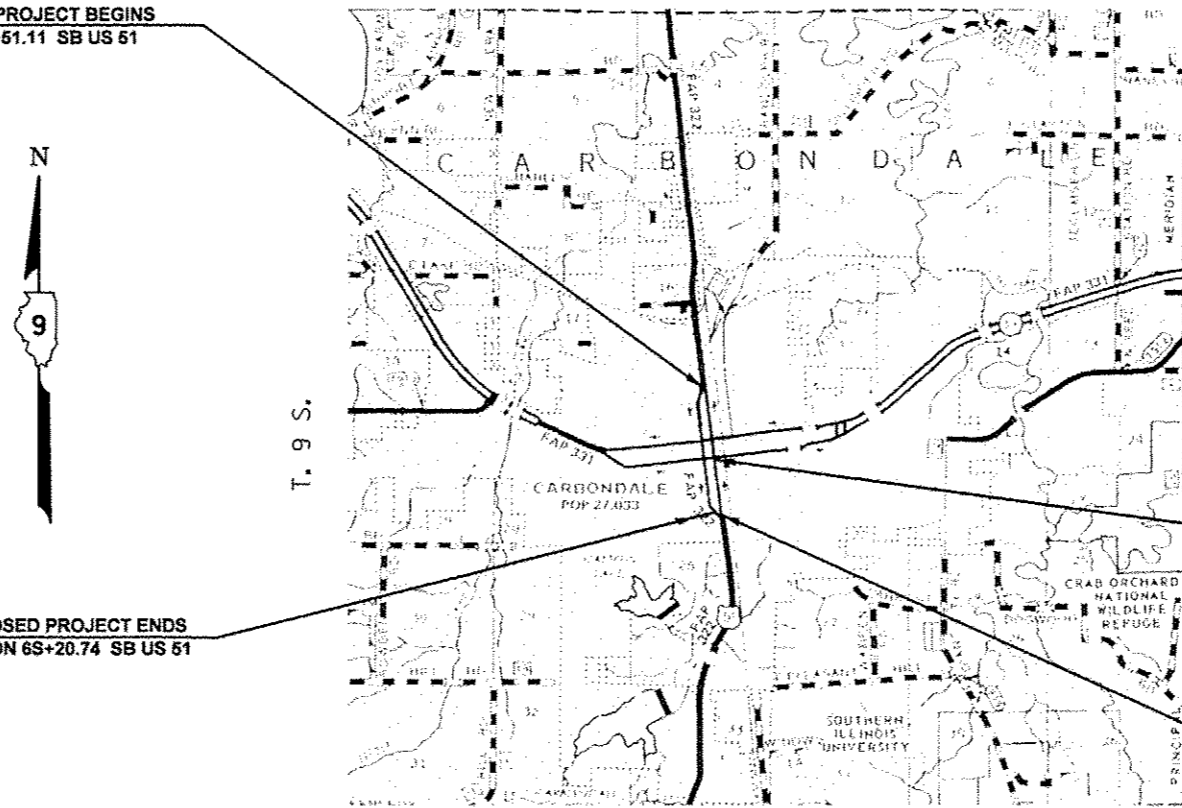

GROSS LENGTH = 4672.84 FT. = 0.885 MILE
 NET LENGTH = 4514.84 FT. = 0.855 MILE



STATE OF ILLINOIS
DEPARTMENT OF TRANSPORTATION
DIVISION OF HIGHWAYS

SUBMITTED *March 20, 2014*

Juliana K...
 DEPUTY DIRECTOR OF HIGHWAYS, REGION ENGINEER

May 9, 2014
John D. Baranzelli, P.E.
 ENGINEER OF DESIGN AND ENVIRONMENT

May 9, 2014
Cher Osman, P.E.
 DIRECTOR OF HIGHWAYS, CHIEF ENGINEER

PRINTED BY THE AUTHORITY
OF THE STATE OF ILLINOIS

SIGNATURE SHEET

Prepared By: *[Signature]*
DISTRICT STUDIES & PLANS ENGINEER

Examined By: *[Signature]*
DISTRICT LAND ACQUISITION ENGINEER

Examined By: *[Signature]*
DISTRICT PROGRAM DEVELOPMENT ENGINEER

Examined By: *[Signature]*
DISTRICT OPERATIONS ENGINEER

Examined By: *[Signature]*
DISTRICT PROJECT IMPLEMENTATION ENGINEER

Examined By: *[Signature]*
DISTRICT CONSTRUCTION ENGINEER

Examined By: *[Signature]*
DISTRICT MATERIALS ENGINEER

FILE NAME *	USER NAME * #USER#	DESIGNED -	REVISED -	STATE OF ILLINOIS DEPARTMENT OF TRANSPORTATION	SIGNATURE SHEET	F.A.P. RTE.	SECTION	COUNTY	TOTAL SHEETS	SHEET NO.
o:\pwork\pwork\1ef twchd1\d0381784\7814-shite-misc.dgn		DRAWN -	REVISED -			322	(1-1)RS-1, 10RS-2, 9RS-6	JACKSON	26	2
#MODELNAME#	PLOT SCALE = 100.0000' / 1"v PLOT DATE = 3/21/2014	CHECKED -	REVISED -		SCALE:	SHEET OF SHEETS		STA.	TO STA.	
		DATE -	REVISED -			<small>ILLINOIS FED. AID PROJECT</small>				

HMA MIXTURE DESIGNS

INDEX OF SHEETS

SHEET NO	DESCRIPTION
1	COVER SHEET
2	SIGNATURE SHEET
3	INDEX OF SHEETS, STANDARDS, AND MIX DESIGNS
4	GENERAL NOTES, COMMITMENTS
5-7	SUMMARY OF QUANTITIES
8-10	TYPICAL SECTIONS
11	PAVEMENT RESURFACING SCHEDULE
12	SIDEROAD & ENTRANCE RESURFACING SCHEDULE
13-15	MANHOLE/VAULT ADJUSTMENT & TEMPORARY RAMPS
16-17	PAVEMENT MARKING SCHEDULE
18-20	PLAN SHEETS
21-23	PAVEMENT MARKING PLAN SHEETS
24	DISTRICT STANDARDS
25	SIDEROAD AND ENTRANCE DETAIL
26	HMA SURFACE REMOVAL - BUTT JOINT

LIST OF STANDARDS

000001-06	Standard Symbols Abbreviations & Patterns
001006	Decimal of Inch & Foot
420701-02	Pavement Fabric
442101-07	Class B Patches
701427-02	Lane Closure Multi Lane - Intermittent or Moving Op. For EQ40 MPH
701601-09	Urban Lane Closure Multi Lane 1W2W + Non-traversable Med
701701-09	Urban Lane Closure Multi Lane Intersection
701901-03	Traffic Control Devices
780001-04	Typical Pavement Markings
781001-03	Typical Appraised Reflective Pavement Markers
782001	Prismatic Reflectors on Curbs
886001-01	Detector Loop Installations
701101-04	Off-Road Operations, Multilane, 15' (4.5m) to 24' (600mm) From Edge of Pavement
701426-06	Lane Closure, Multilane, Intermittent or Moving Oper., For Speeds >45 MPH

Locations	Hot-Mix Asphalt Surface Course
Mixture Use(s):	Polymerized Hot-Mix Asphalt Surface Course, Mix D, N90
AC/PG:	SBS PG76-22
ABR % (Max):	See Special Provision
Design Air Voids:	4.0 %, 90 Gyration Design
Mixture Composition: (Gradation Mixture)	IL-9.5mm
Friction Aggregate:	D Surface
Quality Management Program:	QCP

Locations	Hot-Mix Asphalt Leveling Binder
Mixture Use(s):	Polymerized Hot-Mix Asphalt Leveling Binder, N90, IL-9.5mm Fine Grade
AC/PG:	SBS PG76-22
ABR % (Max):	See Special Provision
Design Air Voids:	4.0 %, 90 Gyration Design
Mixture Composition: (Gradation Mixture)	IL-9.5mm Fine Grade
Friction Aggregate:	None
Quality Management Program:	QCP

Locations	Incidental HMA Surfacing
Mixture Use(s):	Hot-Mix Asphalt Surface Course, Mix C, N90
AC/PG:	PG64-22
ABR % (Max):	See Special Provision
Design Air Voids:	4.0 %, 90 Gyration Design
Mixture Composition: (Gradation Mixture)	IL-9.5mm
Friction Aggregate:	C Surface
Quality Management Program:	QCOA

Locations	Class D Patching
Mixture Use(s):	Hot-Mix Asphalt Binder Course, N90, IL-19.0mm Fine Grade
AC/PG:	PG64-22
ABR % (Max):	See Special Provision
Design Air Voids:	4.0 %, 90 Gyration Design
Mixture Composition: (Gradation Mixture)	IL-19.0mm Fine Grade
Friction Aggregate:	None
Quality Management Program:	QCOA

FILE NAME *	USER NAME * USER14	DESIGNED -	REVISED -	STATE OF ILLINOIS DEPARTMENT OF TRANSPORTATION	INDEX OF SHEETS, STANDARDS, AND MIX DESIGNS	F.A.P. RTE.	SECTION	COUNTY	TOTAL SHEETS	SHEET NO.	
c:\pwork\pedit\stf\stehd\140381784\178	14-hma-mix.dgn	DRAWN -	REVISED -			322	(1-1RS-1, 1ORS-2, 9RS-6)	JACKSON	26	3	
MODEL NAME *	PLOT SCALE * 100.0000 / 1 in.	CHECKED -	REVISED -			CONTRACT NO. 78414					
	PLOT DATE * 4/23/2014	DATE -	REVISED -			ILLINOIS FED. AID PROJECT					

INDEX OF SHEETS, STANDARDS AND MIX DESIGNS

GENERAL NOTES

THE THICKNESS OF THE HOT-MIX ASPHALT MIXTURE SHOWN ON THE PLANS IS THE NOMINAL THICKNESS. DEVIATIONS FROM THE NOMINAL THICKNESS WILL BE PERMITTED WHEN SUCH DEVIATIONS OCCUR DUE TO IRREGULARITIES IN THE EXISTING SURFACE OR BASE ON WHICH THE HOT-MIX ASPHALT MIXTURE IS PLACED.

FACTORS USED FOR ESTIMATING PLAN QUANTITIES ARE AS FOLLOWS AND SHALL NOT BE USED FOR THE BASIS OF FINAL QUANTITIES.

ALL HOT-MIX ASPHALT	2.016 TON/CU YD
ALL AGGREGATE	2.05 TON/CU YD
BITUMINOUS MATERIALS (PRIME COAT)	
ON MILLED HMA	0.050 LB / SQ FT
FOG COAT BETWEEN HMA LIFTS	0.025 LB / SQ FT

UNLESS OTHERWISE DIRECTED BY THE ENGINEER, RESURFACING SHALL BE PLACED IN A SEQUENCE THAT WILL MINIMIZE THE TIME THE CENTERLINE EDGE IS EXPOSED TO TRAFFIC. WHEN AT THE END OF A DAY'S OPERATION THE EXPOSED CENTERLINE EDGE IS GREATER THAN 2,000 FT., THE CONTRACTOR SHALL BE REQUIRED TO PAVE IN THE ADJACENT LANE ON THE FOLLOWING WORK DAY. PRIOR TO WINTER SHUT DOWN, RESURFACING ON ADJACENT LANES IS TO BE BROUGHT UP TO THE SAME ELEVATION.

THE QUANTITY OF SHORT TERM PAVEMENT MARKING SHOWN IN THE PLANS IS BASED ON ONE APPLICATION EACH FOR THE HMA SURFACE REMOVAL, AND BINDER COURSE.

PRIOR TO PLACEMENT OF THE FINAL PAVEMENT MARKINGS THE RESIDENT ENGINEER SHALL CONTACT THE BUREAU OF OPERATIONS AND ARRANGE FOR INSPECTION AND APPROVAL OF THE PAVEMENT MARKING LAYOUT.

QUANTITIES SHOWN IN THE PLANS FOR PATCHING ARE ESTIMATES. THE ACTUAL AMOUNT OF PATCHING REQUIRED SHALL BE DETERMINED BY THE ENGINEER.

THE CONTRACTOR SHALL STAMP STATIONING IN THE HOT-MIX ASPHALT SURFACE AT 300 FT. INTERVALS ALTERNATING SIDES ON THE OUTSIDE EDGE OF PAVEMENT AND AS DIRECTED BY THE ENGINEER. THE STATION SYMBOL STAMPS USED SHALL BE FURNISHED BY THE CONTRACTOR. THEY SHALL BE 5 1/2 IN. TALL OF A DESIGN APPROVED BY THE ENGINEER, AND SHALL REMAIN THE PROPERTY OF THE CONTRACTOR.

ATTAINMENT OF PROPER CROWN OR SUPERELEVATION SHALL BE FULLY ACCOMPLISHED WITH THE HOT-MIX ASPHALT SURFACE REMOVAL OR HOT-MIX ASPHALT BINDER COURSE, WHEN SPECIFIED.

THE LOCATION OF THE DETECTOR LOOPS, AS SHOWN ON THE PLANS, MAY BE ADJUSTED TO FIT FIELD CONDITIONS AS DIRECTED BY THE ENGINEER OF TRAFFIC OPERATIONS.

DETECTOR LOOP WIRE SHALL BE PLACED IN THE EXISTING CONDUIT FROM THE LOOP SAWCUT TO THE SPLICE POINT AT THE EXISTING HANDHOLE.

ALL DETECTOR LOOPS SHALL BE INSTALLED PRIOR TO RESURFACING.

VIBRATORY ROLLERS WILL NOT BE ALLOWED FOR THIS PROJECT.

SAW CUTS REQUIRED FOR BUTT JOINTS SHALL BE INCLUDED IN THE COST OF THE BUTT JOINT.

COMMITMENTS
NONE

FILE NAME *	USER NAME = #USER#	DESIGNED -	REVISED -	STATE OF ILLINOIS DEPARTMENT OF TRANSPORTATION	GENERAL NOTES & COMMITMENTS	F.A.P. RTE.	SECTION	COUNTY	TOTAL SHEETS	SHEET NO.
c:\p\work\p\dot\left\wchd\0301704\70414-sha-niso.dgn		DRAWN -	REVISED -			322	(1-1)RS-1, 10RS-2, BRS-6	JACKSON	26	4
PLOT SCALE * 100.0000 ' / in.		CHECKED -	REVISED -			CONTRACT NO. 78414				
MODELNAME#	PLOT DATE * 3/21/2014	DATE -	REVISED -			ILLINOIS FED. AID PROJECT				
SCALE: SHEET OF SHEETS STA. TO STA.										

GENERAL NOTES & COMMITMENTS

SUMMARY OF QUANTITIES

CODE NUMBER	ITEM DESCRIPTION	UNIT	LOCATION: URBAN			
			ROUTE: FAP 322 (US 51)			
			FUNDING:	80% FED	20% STATE	80% FED 20% LOCAL
TOTAL QUANTITY	ROADWAY 0005	ROADWAY 0005	ROADWAY 0005	ROADWAY 0005		
40600909	POLYMERIZED LEVELING BINDER (MACHINE METHOD), IL-9.5FG, N90	TON	1155	1101	54	
40600985	PORTLAND CEMENT CONCRETE SURFACE REMOVAL - BUTT JOINT	SQ YD	399	399		
40600990	TEMPORARY RAMP	SQ YD	1878	1878		
40603545	POLYMERIZED HOT-MIX ASPHALT SURFACE COURSE, MIX "D", N90	TON	2185	2009	176	
40800050	INCIDENTAL HOT-MIX ASPHALT SURFACING	TON	28	28		
44000158	HOT-MIX ASPHALT SURFACE REMOVAL, 2 1/4"	SQ YD	15202	13823	1379	
44200966	CLASS B PATCHES, TYPE I, 10 INCH	SQ YD	69	69		
44200970	CLASS B PATCHES, TYPE II, 10 INCH	SQ YD	337	337		
44200974	CLASS B PATCHES, TYPE III, 10 INCH	SQ YD	334	334		
44200976	CLASS B PATCHES, TYPE IV, 10 INCH	SQ YD	356	356		
44201299	DOWEL BARS 1 1/2"	EACH	1798	1798		
44213100	PAVEMENT FABRIC	SQ YD	690	690		
44213200	SAW CUTS	FOOT	5163	5163		
44213204	TIE BARS 3/4"	EACH	426	426		

14

SUMMARY OF QUANTITIES - CONT

CODE NUMBER	ITEM DESCRIPTION	UNIT	TOTAL QUANTITY	URBAN	
				FAP 322 (US 51)	
				80% FED	20% STATE
				ROADWAY	ROADWAY
				0005	0005
44300200	STRIP REFLECTIVE CRACK CONTROL TREATMENT	FOOT	7152		7152
56109210	WATER VALVES TO BE ADJUSTED	EACH	15		15
60255500	MANHOLES TO BE ADJUSTED	EACH	10		10
67000400	ENGINEER'S FIELD OFFICE, TYPE A	CAL MO	3		3
67100100	MOBILIZATION	L SUM	1		1
70102630	TRAFFIC CONTROL AND PROTECTION, STANDARD 701601	L SUM	1		1
70102635	TRAFFIC CONTROL AND PROTECTION, STANDARD 701701	L SUM	1		1
70106800	CHANGEABLE MESSAGE SIGN	CAL MO	3		3
70300100	SHORT TERM PAVEMENT MARKING	FOOT	3610		3610
70301000	WORK ZONE PAVEMENT MARKING REMOVAL	SO FT	3610		3610
* 78003100	PREFORMED PLASTIC PAVEMENT MARKING, TYPE B - LETTERS AND SYMBOLS	SO FT	248		128 120
* 78003110	PREFORMED PLASTIC PAVEMENT MARKING, TYPE B - LINE 4"	FOOT	7887		2465 5422
* 78003130	PREFORMED PLASTIC PAVEMENT MARKING, TYPE B - LINE 6"	FOOT	40		40
* 78003150	PREFORMED PLASTIC PAVEMENT MARKING, TYPE B - LINE 12"	FOOT	2208		2208

* SPECIALTY ITEM

FILE NAME :	USER NAME : jefswichd	DESIGNED -	REVISED -	STATE OF ILLINOIS DEPARTMENT OF TRANSPORTATION	SUMMARY OF QUANTITIES SHEET 2 OF 3	F.A.P. RTE. 322	SECTION (1-1/RS-1, 1ORS-2, 9RS-6)	COUNTY JACKSON	TOTAL SHEETS 26	SHEET NO. 6
Default	14	DRAWN -	REVISED -	SCALE:	SHEET OF SHEETS	STA. TO STA.	ILLINOIS FED. AID PROJECT CONTRACT NO. 78414			
		CHECKED -	REVISED -							
		DATE -	REVISED -							

SUMMARY OF QUANTITIES - CONT

LOCATION:	URBAN			
ROUTE:	FAP 322 (US 51)			
FUNDING:	80% FED	20% STATE	80% FED	20% LOCAL
TOTAL QUANTITY	ROADWAY 0005		ROADWAY 0005	

CODE NUMBER	ITEM DESCRIPTION	UNIT	TOTAL QUANTITY	ROADWAY 0005	ROADWAY 0005
* 78003180	PREFORMED PLASTIC PAVEMENT MARKING, TYPE B - LINE 24"	FOOT	190	190	
* 78100100	RAISED REFLECTIVE PAVEMENT MARKER	EACH	129	129	
* 78200300	PRISMATIC CURB REFLECTOR	EACH	14	14	
78300200	RAISED REFLECTIVE PAVEMENT MARKER REMOVAL	EACH	129	129	
* 88600100	DETECTOR LOOP, TYPE I	FOOT	594	594	
X4060110	BITUMINOUS MATERIALS (PRIME COAT)	POUND	16726	16726	
X4400100	PORTLAND CEMENT CONCRETE SURFACE REMOVAL (VARIABLE DEPTH)	SQ YD	2547	924	1623
X4406025	PARTIAL DEPTH REMOVAL, TYPE I, 2.5"	SO YD	165	165	
X4406225	PARTIAL DEPTH REMOVAL, TYPE II, 2.5"	SO YD	74	74	
X4421000	PARTIAL DEPTH PATCHING	TON	27	27	
* X7830074	GROOVING FOR RECESSED PAVEMENT MARKING 7"	FOOT	26	26	
Z0034105	MATERIAL TRANSFER DEVICE	TON	3556	3556	

10
12

* SPECIALTY ITEM

FILE NAME :	USER NAME : laftrichd	DESIGNED -	REVISED -	STATE OF ILLINOIS DEPARTMENT OF TRANSPORTATION	SUMMARY OF QUANTITIES SHEET 3 OF 3	F.A.P. RTE.	SECTION	COUNTY	TOTAL SHEETS	SHEET NO.
es:\pe_work\p\dot\laftrichd\0381784\7814-sha-misc.dgn	DRAWN -	REVISED -	322			4-1RS-1, 1ORS-2, 9RS-6	JACKSON	26	7	
PLOT SCALE = 100.0000' / 1"	CHECKED -	REVISED -	CONTRACT NO. 78414							
Default	DATE -	REVISED -	SCALE:			SHEET OF SHEETS	STA. TO STA.	ILLINOIS FED. AID PROJECT		

TYPICAL SECTION
 US RTE 51
 EXISTING PAVEMENT WITH HMA SURFACE

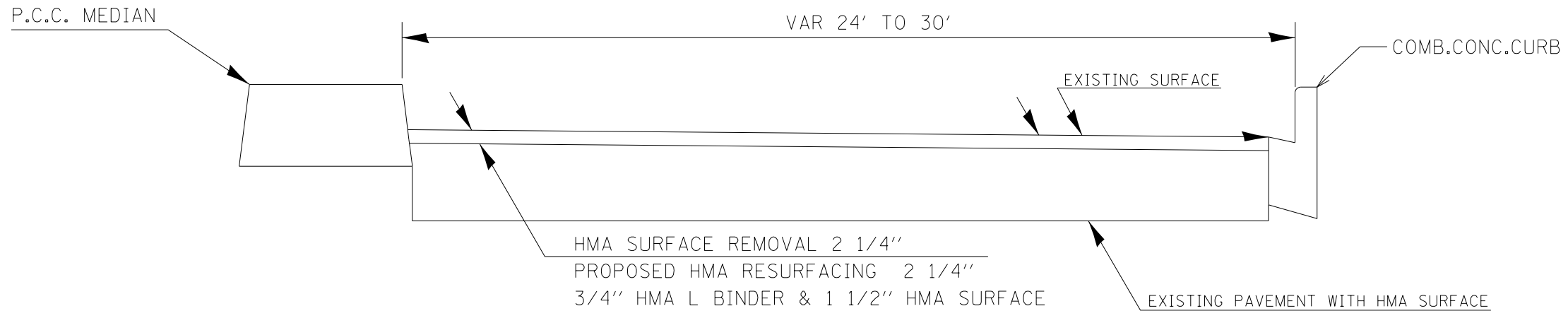

SB US 51
 STA 48+51.11 TO STA 0N+87.16

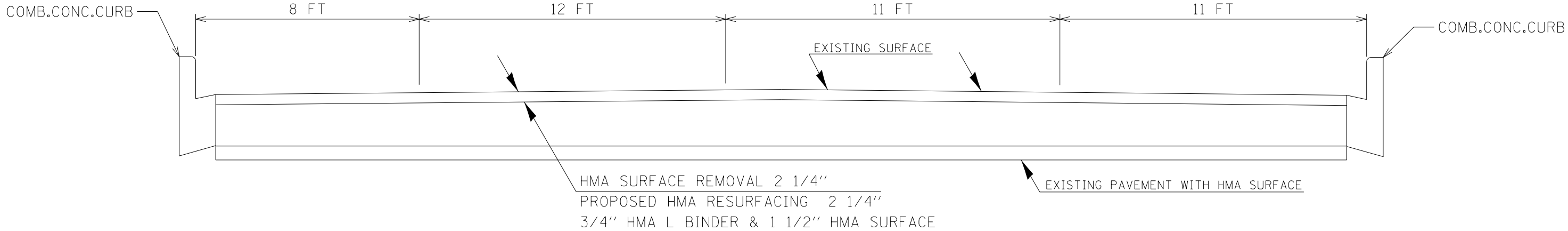

NB US 51
 STA 76.67 TO STA 78+78.28
 TYPICAL SHOWN IN DIRECTION OF TRAVEL

13' RT STA 48+97.77 => STA 0N+00
 EQUATION STA 40N+05 BK = STA 0S+00 AH

FILE NAME =	USER NAME = \$USER\$	DESIGNED -	REVISED -	STATE OF ILLINOIS DEPARTMENT OF TRANSPORTATION	TYPICAL SECTIONS SHEET 1 OF 3				F.A.P. RTE.	SECTION	COUNTY	TOTAL SHEETS	SHEET NO.
ci:\pw\work\p\idot\leftwchd\0381784\7814-sha-misc.dgn		DRAWN -	REVISED -		322	(1-1)RS-1, 1ORS-2, 9RS-6	JACKSON	26	8				
\$MODELNAME\$		CHECKED -	REVISED -		CONTRACT NO. 78414								
	PLOT DATE = 4/23/2014	DATE -	REVISED -		SCALE:	SHEET	OF	SHEETS	STA.	TO	STA.	ILLINOIS FED. AID PROJECT	

TYPICAL SECTION
US RTE 51
EXISTING PCC PAVEMENT

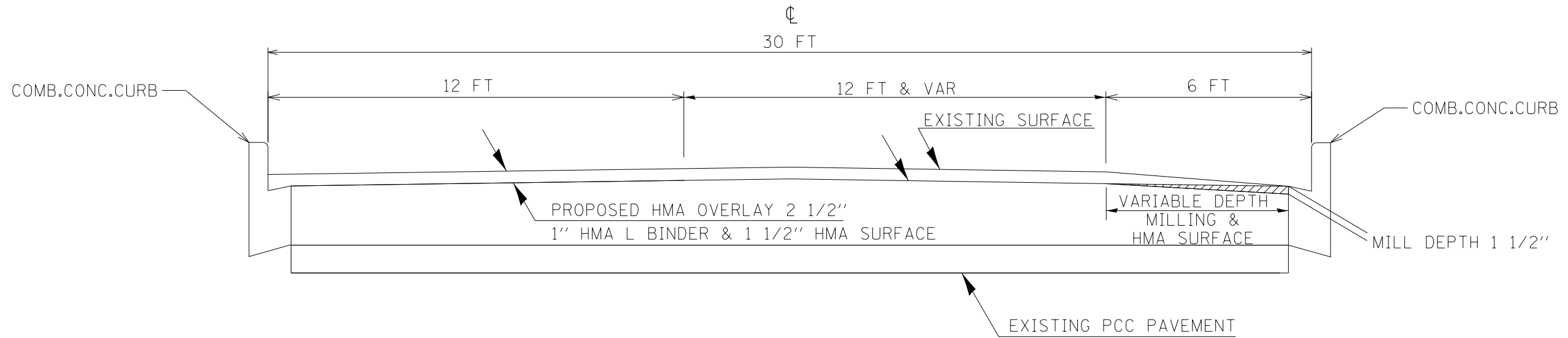

13' RT STA 48+97.77 => STA ON+00
EQUATION STA 40N+05 BK = STA 0S+00 AH

SB US 51
*STA ON+87.16 TO STA 9N+21.23
**STA 3S+69.80 TO STA 6S+20.74

*STA 6N+71 TO STA 9N+21.23 TRANSITION AREA
**TRANSITION AREA

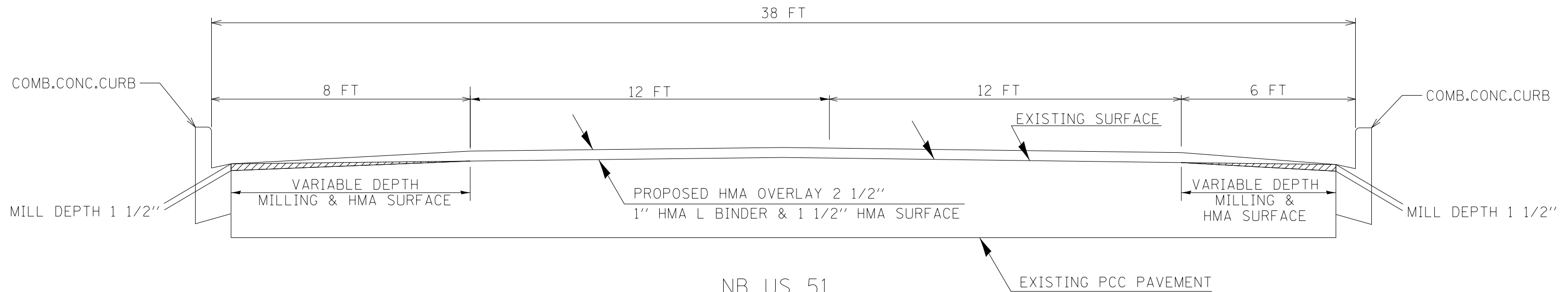

NB US 51
STA 78+78.28 TO STA 94+91.7
TYPICAL SHOWN IN DIRECTION OF TRAVEL

FILE NAME =	USER NAME = \$USER\$	DESIGNED -	REVISED -	STATE OF ILLINOIS DEPARTMENT OF TRANSPORTATION	TYPICAL SECTIONS SHEET 2 OF 3				F.A.P. RTE.	SECTION	COUNTY	TOTAL SHEETS	SHEET NO.
ci:\pw\work\p\midot\leftwichdl\d0381784\7814-sha-misc.dgn		DRAWN -	REVISED -		322	(1-1)RS-1, 1ORS-2, 9RS-6	JACKSON	26	9				
\$MODELNAME\$	PLOT SCALE = 100.0000' / in.	CHECKED -	REVISED -		CONTRACT NO. 78414								
	PLOT DATE = 4/23/2014	DATE -	REVISED -		SCALE:	SHEET	OF	SHEETS	STA.	TO	STA.	ILLINOIS FED. AID PROJECT	

TYPICAL SECTION
 US RTE 51
 EXISTING PAVEMENT WITH HMA SURFACE

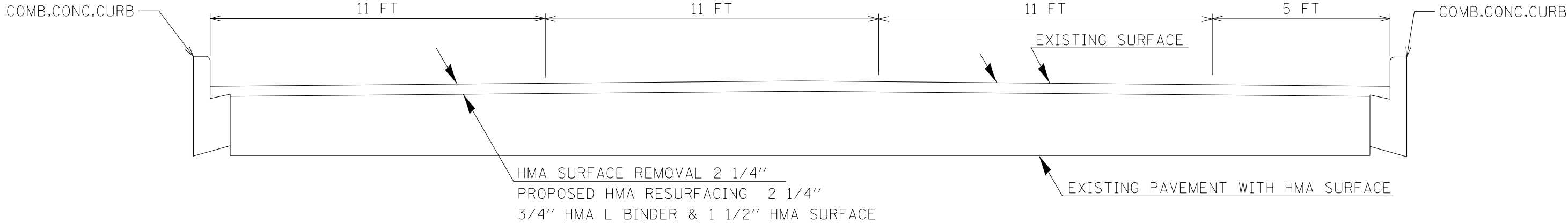

SB US 51
 STA 9N+21.23 TO STA 28N+03

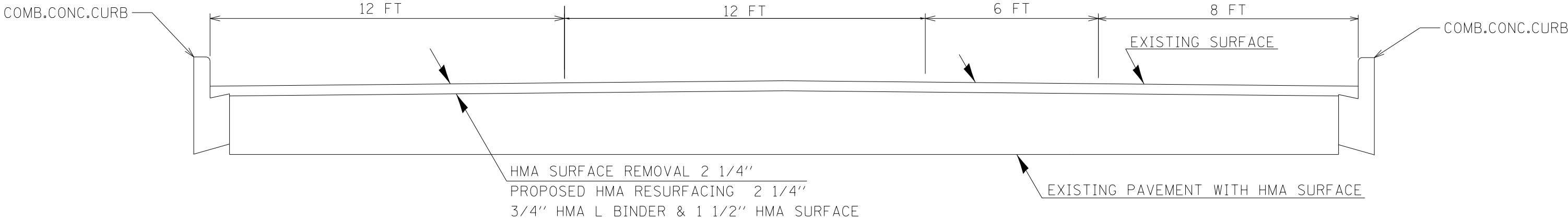

SB US 51
 STA 28N+60 TO STA 3S+69.80

FILE NAME =	USER NAME = \$USER\$	DESIGNED -	REVISED -	STATE OF ILLINOIS DEPARTMENT OF TRANSPORTATION	TYPICAL SECTIONS SHEET 3 OF 3				F.A.P. RTE.	SECTION	COUNTY	TOTAL SHEETS	SHEET NO.
c:\pwork\pwork\leftwchd\0381784\7814-sha-misc.dgn		DRAWN -	REVISED -		322	(1-1RS-1, 1ORS-2, 9RS-6)	JACKSON	26	10				
\$MODELNAME\$		CHECKED -	REVISED -		CONTRACT NO. 78414								
	PLOT DATE = 4/23/2014	DATE -	REVISED -		SCALE:	SHEET	OF	SHEETS	STA.	TO	STA.	ILLINOIS FED. AID PROJECT	

PAVEMENT RESURFACING SCHEDULE

US 51 CARBONDALE LOCATION STATION TO STATION				LENGTH (INFO ONLY)	PARKING LANE AREA	BINDER THICK	TRANSITION RAMP ADDITIONAL BINDER	POLY HMA LB IL-9.5mm N90	POLY HMA SC "D" N90	HMA SURF REM 2 1/4	PCC SURF REM VAR DEP	STRIP REF CR CON TR	BIT MATLS PR CT	PCC SURFACE REMOVAL - BUTT JOINT
STA	TO	STA		FEET	SQ YD	IN	TON	TON	TON	SQ YD	SQ YD	FOOT	LB	SQ YD
SB US 51														
STA 48+51	TO STA	49+84.90		133.8		0.75	11.67	34.2	45.0	535.5		0.0	361.4	
	OR STA	0+87.13												
EQN STA 48+97.77	BK = STA	0+00.00	AH											
STA 0+87.13	TO STA	6+71.47		584.3		1.00		87.3	152.7		259.7	1168.7	1168.7	
STA 6+71.47	TO STA	9+21.50		250.0		1.00		42.3	72.7		111.1	500.1	559.4	
STA 9+21.50	TO STA	20+81.00		1159.5		0.75	14.78	220.4	411.3	4896.0		0.0	3304.8	
WALNUT STREET OMISSION (WB IL 13)														
STA 20+81.00	TO STA	21+82.00		101.0										
STA 21+82.00	TO STA	28+03.00		621.0		0.75		110.1	220.2	2622.0		0.0	1769.9	
MAIN STREET OMISSION (EB IL 13)														
STA 28+03.00	TO STA	28+60.00		57.0										
STA 28+60.00	TO STA	40+05.50		1145.5	1018.2	0.75		205.8	411.5	4898.9		0.0	3306.8	
EQN 40+05.50	BK = STA	0+00.00	AH											
STA 0+00.00	TO STA	2+99.25		299.3	266.0	0.75	14.78	67.8	106.1	1263.5		0.0	852.9	
STA 2+99.25	TO STA	3+69.76		70.5		1.00		14.0	23.7		31.3	141.0	183.3	
STA 3+69.76	TO STA	6+20.74		251.0		1.00		43.6	74.8		111.5	502.0	576.1	
STA 5+70.74	TO STA	6+20.74		50.0		1.00		3.9	17.4					172.2
	SB LENGTH TOTAL =			4672.9										
	LESS OMISSIONS =			4514.9										
NB US 51														
STA 76+67.00	TO STA	78+78.30		211.3	187.8	0.75	16.33	57.7	82.8	986.1		0.0	665.6	
STA 78+78.30	TO STA	79+34.50		56.2	50.0	1.00		10.3	20.7		68.7	168.6	152.6	
STA 79+34.50	TO STA	94+69.25		1534.8	1364.2	1.00		248.3	515.7		1875.8	4604.3	3760.2	
STA 94+69.25	TO STA	94+91.70		22.5	20.0	1.00		4.4	8.7		27.4	67.4	64.3	
STA 94+41.70	TO STA	94+91.70		50.0		1.00		4.7	21.3		61.1			226.8
	NB LENGTH TOTAL =			1824.7										
TOTALS														
								1155	2185	15202	2547	7152	16726	399

SIDEROAD & ENTRANCE RESURFACING SCHEDULE

NAME	STATION	SIDEROAD	SIDEROAD	DISTANCE	PCC	INCIDENTAL	TEMPORARY
		WIDTH AT EOP	WIDTH AT BK OF SURF	EOP TO BK OF SURF	SURF REM VAR DEP	HMA SURF	RAMPS •
		FT	FT	FT	SQ YD	TON	SQ YD
SB US 51							
WILLOW ST	RT						
ENTRANCE	RT	0+20	54.4	24.5	11.6		15.1
W CHESTNUT	LT	3+82.3	83.5	36.0	25.0	132.1	38.7
W CHESTNUT	RT	3+82.3	101.4	39.3	25.0	166.4	28.2
ENTRANCE	RT	6+20.2	52.9	29.5	18.9		14.7
ENTRANCE	RT	7+87.4	54.3	40.0	14.2		15.1
W SYCAMORE	LT	8+61.5	86.4	41.1	15.0	92.2	40.0
W SYCAMORE	RT	8+61.5	55.6	23.2	20.4	73.4	15.4
W FREEMAN	LT	4+01.7	71.1	26.5	15.0	57.5	32.9
S UNIVERSITY AVE	RT	5+53.9	146.0	49.7	25.0	181.4	40.6
MILL ST		9+12.3					
NB US 51							
MILL ST	NA						
ENTRANCE	LT	94+23.8	24.9	12.9	9.3		6.9
ENTRANCE	RT	93+71.1	41.2	29.6	5.6		11.4
ENTRANCE	RT	93+02.8	25.9	16.6	4.9		7.2
ENTRANCE	RT	92+68.6	26.5	17.2	5.0		7.4
ENTRANCE	RT	91+98.6	24.8	14.7	5.0		6.9
W FREEMAN	LT	91+44.3	51.6	24.1	15.0	47.9	14.3
ENTRANCE	RT	90+94.9	24.5	13.9	5.0		6.8
ALLEY	LT	90+11.7	42.7	12.3	15.6		11.9
ENTRANCE	RT	89+21.7	19.9	9.7	5.0		5.5
W COLLEGE	LT	88+30.1	51.5	26.0	15.0	48.1	14.3
W COLLEGE	RT	88+30.1	43.8	24.9	15.0	45.7	12.2
ENTRANCE	LT	87+79.6	48.5	33.5	10.0		13.5
OLD NATIONAL DR	LT	85+97.3	45.0	16.5	17.7	40.3	12.5
ENTRANCE	RT	85+43.7	34.6	24.1	5.0		9.6
ENTRANCE	RT	84+32.2	24.8	14.8	5.1		6.9
W HOSPITAL DR	LT	84+14.0	36.4	20.6	15.0	39.7	10.1
ENTRANCE	RT	83+04.2	42.5	32.3	5.2		11.8
W CHERRY	LT	82+44.8	45.4	22.8	15.0	48.5	12.6
ENTRANCE	RT	82+40.5	26.9	16.6	5.0		7.5
AMTRACK STATION	RT	79+50	248.1	193.4	9.3		68.9
W ELM	LT	79+05.9	41.0	23.6	15.0	46.8	11.4
W WALNUT	NA	75+79.3					
TOTALS					1938	28	925

* SEE MANHOLE VAULT ADJUSTMENT SCHEDULE FOR ADDITIONAL QUANTITY
 ** LT & RT ARE GIVEN IN RESPECT TO DIRECTION OF TRAVEL

PAVEMENT MARKING - PARKING & BIKE SYMBOLS

RTE 13 / 127 LOCATION STATION TO STATION		PAINT PAVEMENT MARKING - LINE 4"			LETTERS AND SYMBOLS (BIKE PATH)
		PARKING T WHITE	PARKING ELBOW YELLOW	NO PARKING HASHED YELLOW	
PROP ALI		FT	FT	FT	FT
SB US 51					
BIK 0+87.16					6
0+87.16 TO W CHESTNUT					6
W CHESTNUT TO W SYCAMORE					6
W SYCAMORE TO W PECAN					6
W PECAN TO W OAK					6
W OAK TO W JACKSON					6
W JACKSON TO W MAIN					6
W MAIN TO W MONROE					6
W MONROE TO W ELM		16	8		6
W ELM TO W CHERRY		44	8		6
W CHERRY TO W COLLEGE		36	16		6
W COLLEGE TO W FREEMAN		16	8		6
W FREEMAN TO S UNIVERSITY					6
NB US 51					
PARKING					
W WALNUT TO W ELM		28	16		
W ELM TO W CHERRY		20	8	110.0	6
W CHERRY TO W HOSPITAL DR		0	16		6
W HOSPITAL DR TO OLD NATIONAL DR		8	8		6
OLD NATIONAL TO W COLLEGE		12	16		6
W COLLEGE TO W FREEMAN		20	16		6
W FREEMAN TO MILL ST		28	8		6
MILL ST BIKE PATH BEGINS					6
TOTALS		228	128	110	120
		466			

MANHOLE / VAULT ADJUSTMENT AND TEMPORARY RAMP SCHEDULE

US 51 CARBONDALE LOCATION STATION TO STATION			PVMT WIDTH	WORK TYPE FEET	BINDER THICK IN	SURFACE THICK IN	TOTAL THICK IN	MANHOLES TO BE ADJUSTED EACH	VALVE VAULTS TO BE ADJUSTED EACH	TEMP RAMPS * FOOT	COMMENT
STA	TO	STA									
<u>SB US 51</u>											
	STA	48+51.11	24.0							24	BUTT JOINT
STA	48+51	TO STA	49+84.90		133.8	0.75	1.5	2.25			
	ALSO STA	0+87.16									
	STA	0+87.16	30.0							30	BUTT JOINT
EQN STA	48+97.74	BK = STA	0+00.00	AH							
STA	0+87.16	TO STA	9+21.50		834.3						
	LT STA	8+49.12						1			MANHOLE
	RT STA	8+77.66						1			MANHOLE
STA	9+21.50	TO STA	20+81.00		1159.5	0.75	1.5	2.25			
	STA	9+21.50	38.0							38	BUTT JOINT
	LT STA	9+77.34								25	MANHOLE
	LT STA	10+82.95								25	MANHOLE
	STA	10+97.46								25	MANHOLE
	RT STA	11+15.36								25	MANHOLE
	LT STA	14+11.84								25	MANHOLE
	RT STA	14+29.20								25	MANHOLE
	LT STA	14+29.40								25	MANHOLE
	RT STA	14+60.28								20	VAULT
	LT STA	14+77.33								25	MANHOLE
	LT STA	15+68.66								25	MANHOLE
	RT STA	17+65.2165								20	VAULT
	RT STA	18+31.97								25	MANHOLE
	STA	20+81.00	38.0							38	BUTT JOINT
<u>WALNUT STREET OMISSION (WB IL 13)</u>											
STA	20+81.00	TO STA	21+82.00		101.0						
STA	21+82.00	TO STA	28+03.00		621.0	0.75	1.5	2.25			
	STA	21+82.00	38.0							38	BUTT JOINT
	LT STA	23+04.09								25	MANHOLE
	STA	23+09.80								25	MANHOLE
	STA	26+63.07								25	MANHOLE
	RT STA	26+79.60								25	MANHOLE
	LT STA	26+79.80								25	MANHOLE
	STA	28+03.00	38.0							38	BUTT JOINT

PAVEMENT MARKING SCHEDULE

US 51 CARBONDALE LOCATION STATION TO STATION	PERFORMED PLASTIC PAVEMENT MARKING							SHORT TERM PVTM MRK FT	RAISED REFLECTIVE PAVT MKR EACH	PRISMATIC CURB REFL EACH	RAISED REFL PAVT MKR REMOVAL EACH	WORK ZONE PAVT MK REM SQ FT	GROOVING RECESSED PAVT MK 7" SQ FT	DESCRIPTION	
	SOLID WHITE 4" FT	SOLID YELLOW 4" FT	SKIP DASH WHITE 4" FT	SOLID WHITE 6" FT	SOLID WHITE 12" FT	SOLID WHITE 24" FT	LETTERS AND SYMBOLS SQ FT								
SB US 51															
STA 48+51 TO STA 49+84.90 OR STA 0+87.16		267.6	33.4					67	3		3	67			
EQN STA 48+97.74 BK = STA 0+00.00 AH															
STA 0+87.16 TO STA 3+82.00 SRR & SRL STA 3+82.00	294.8		73.7					147	7	14	7	147			SIDE ROAD GAP
STA 3+82.00 TO STA 8+61.50 SRR & SRL STA 8+61.50	479.5		119.9					240	12		12	240			SIDE ROAD GAP
STA 8+61.50 TO STA 9+18.96	57.5		14.4					29	1		1	29			
STA 9+18.96 TO STA 10+96.80									3		3				
STA 10+96.80 TO STA 12+00.00	-122.0														
STA 12+00.00 TO STA 13+75.00	175.0		87.5					175	4		4	175			
STOP BAR & CROSS WALK STA 13+75.00 TO STA 14+52.00			38.5		120.0	38		77	2		2	77			
CROSS WALK STA 14+52.00 TO STA 17+34.00	282.0		141.0		120.0			282	8		8	282			
CROSS WALK STA 17+34.00 TO STA 18+04.00			35.0		120.0			70	2		2	70			
CROSS WALK STA 18+04.00 TO STA 20+78.00	274.0		137.0					274	6		6	274			
STOP BAR						38									
MAIN STREET OMISSION (WB IL 13)															
STA 20+78.00 TO STA 21+76.00															
STA 21+76.00 TO STA 24+57.00	281.0		140.5					281	8		8	281			
CROSS WALK STA 24+57.00 TO STA 25+16.00					120.0				2		2				
CROSS WALK					120.0										
STA 25+16.00 TO STA 28+03.00	547.0		78.5				63.6	157	12		12	157			
STOP BAR & CROSS WALK					120.0	38									
WALNUT STREET OMISSION (EB IL 13)															
STA 28+03.00 TO STA 28+60.00															
CROSS WALK					160.0										

PAVEMENT MARKING SCHEDULE - CONTINUED

US 51 CARBONDALE LOCATION STATION TO STATION	PERFORMED PLASTIC PAVEMENT MARKING							SHORT TERM PVMT MRK	RAISED REFLECTIVE PAVT MKR	PRISMATIC CURB REFL	RAISED REFL PAVT MKR REMOVAL	WORK ZONE PAVT MK REM	GROOVING RECESSED PAVT MK 7"	DESCRIPTION
	SOLID WHITE 4"	SOLID YELLOW 4"	SKIP DASH WHITE 4"	SOLID WHITE 6"	SOLID WHITE 12"	SOLID WHITE 24"	LETTERS AND SYMBOLS							
	FT	FT	FT	FT	FT	FT	SQ FT	FT	EACH	EACH	EACH	SQ FT		
STA 28+60.00 TO STA 31+69.80 CROSS WALK	259.8		77.5					155	5		5	155		
SRR & SR 31+69.80 CROSS WALK	-50.0													SIDE ROAD GAP
STA 31+69.80 TO STA 35+07.70 CROSS WALK	337.9		84.5					169	5		5	169		
SRR & SR 35+07.70 CROSS WALK	-56.0													SIDE ROAD GAP
STA 35+07.70 TO STA 40+05.50	497.8		124.5					249	7		7	249		
EQN STA 40+05.50 BK = STA 0+00.00 AH														
STA 0+00.00 TO STA 0+87.70 STOP BAR & CROSS WALK	87.7		21.9					44	1		1	44		
SRR & SR 0+87.70 CROSS WALK	-70.0													SIDE ROAD GAP
STA 0+87.70 TO STA 2+99.25	211.6		52.9					106	4		4	106		
STA 2+99.25 TO STA 3+69.76	70.5		17.6					35	2		2	35		
STA 3+69.76 TO STA 6+19.82	215.0		62.5					125	6		6	125		
MISCELLANIOUS														
STA 28+77.00 TO STA 29+75.00 LT HATCHED AREA	88													
RT SKIP DASH ARC				14										
NB US 51														
CROSS WALK														
STA 76+67.00 TO STA 77+10.00	43.0		10.8					22	4		4	22		
STA 77+10.00 TO STA 79+34.50			56.1					112	5		5	112		
STA 79+34.50 TO STA 87+98.00 CROSS WALK	863.5		215.9					432	10		10	432		
STA 87+98.00 TO STA 88+70.00 STOP BAR & CROSS WALK														
STA 88+70.00 TO STA 94+69.25	599.3		149.8					300	8		8	300		
STA 94+69.25 TO STA 94+91.70	22.5		5.6					11	1		1	11		
STA 94+91.70 TO STA 95+60.00				26									26	
SHEET 1 TOTALS	2227.	267.6	925.2	0	1000	114	63.6	1850	71	14	71	1850	0	
SHEET 2 TOTALS	3120.	0.0	879.5	40	1208	76	63.6	1759	58	0	58	1759	26	
BIKE PATH SYMBOLS - PROJECT TOTAL							120.0							SEE OTHER SCHEDULE
PARKING MARKERS - PROJECT TOTAL	228	238												SEE OTHER SCHEDULE
TOTALS	5576	506	1805	40	2208	190	248.0	3610	129	14	129	3610	26	
7887														

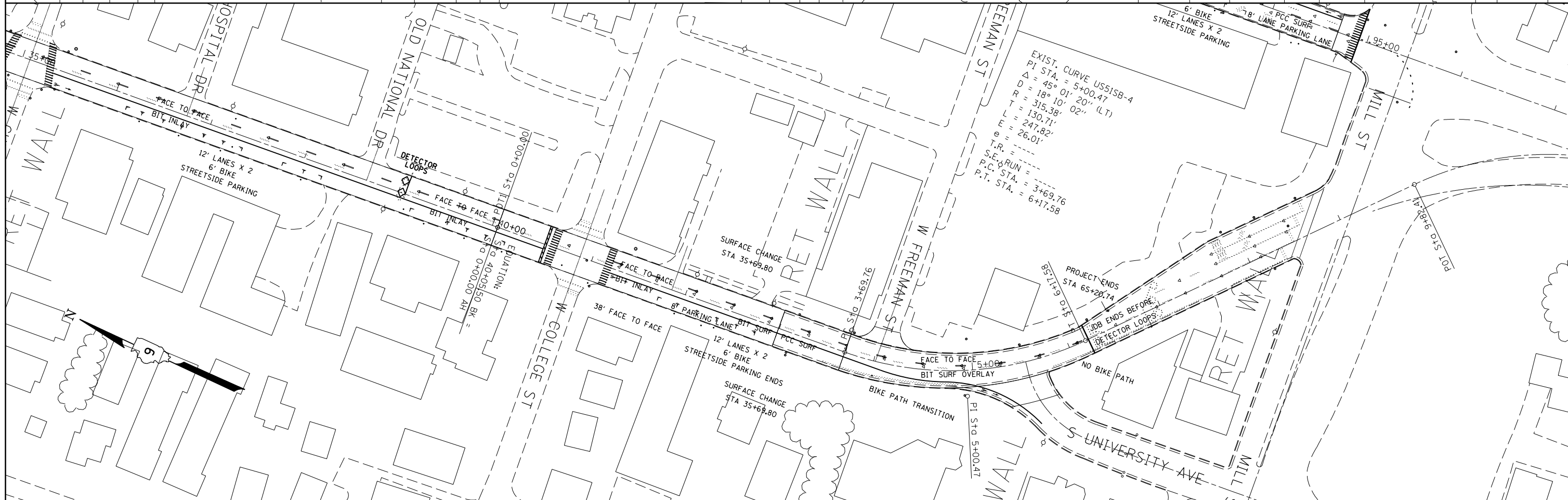
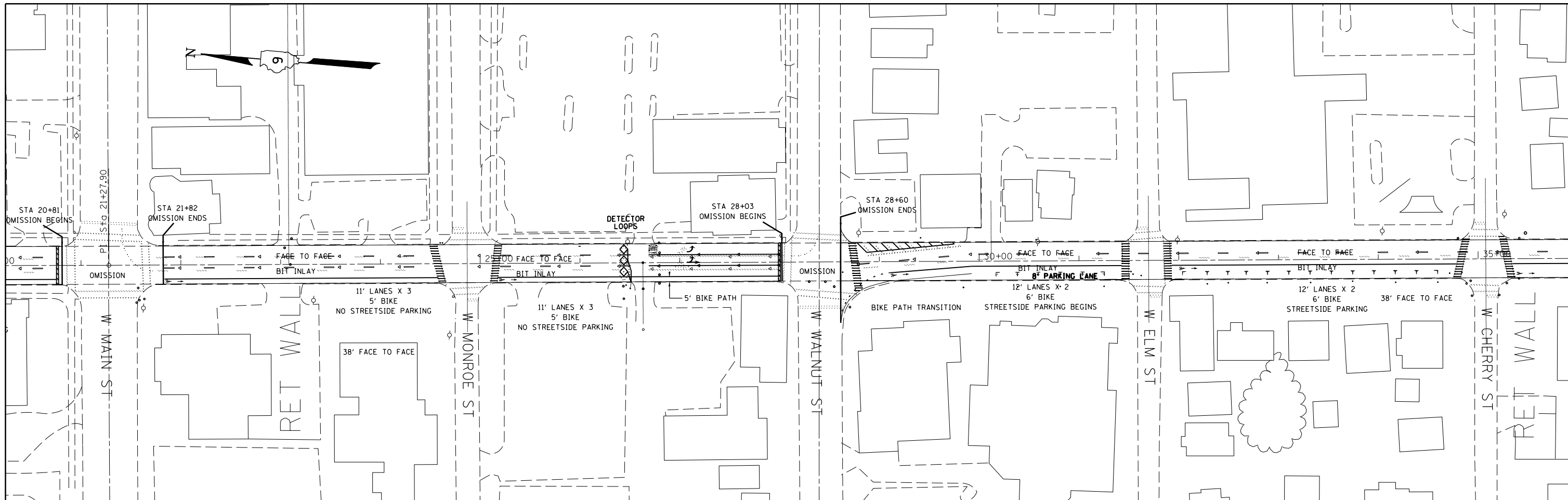

FILE NAME =	USER NAME = \$USER\$	DESIGNED -	REVISED -	STATE OF ILLINOIS DEPARTMENT OF TRANSPORTATION	PLAN US 51 CARBONDALE SHEET 2 OF 3		F.A.P. R.E.	SECTION	COUNTY	TOTAL SHEETS	SHEET NO.		
ei:\pw\work\p\midot\left\lftwchd\ld0381784\7814-sh1b-plen.dgn		DRAWN -	REVISED -				322	(1-1RS-1, 1ORS-2, 9RS-6)	JACKSON	26	19		
\$MODELNAME\$		CHECKED -	REVISED -				CONTRACT NO. 78414						
		DATE -	REVISED -				ILLINOIS FED. AID PROJECT						

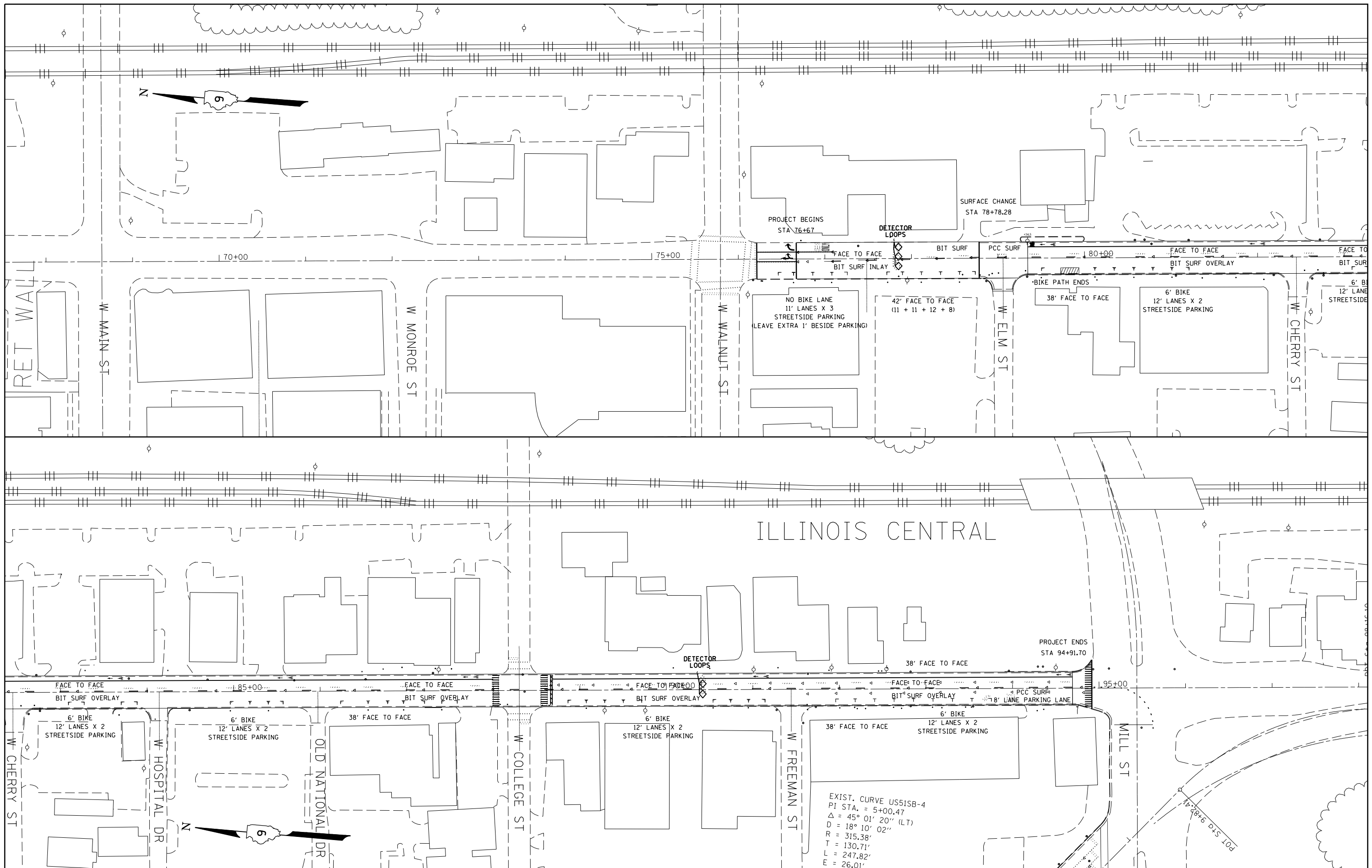

FILE NAME =	USER NAME = \$USER*	DESIGNED -	REVISED -
ei:\pwwork\pwwid\left\ltd\0381784\7814-shb-plan.dgn		DRAWN -	REVISED -
\$MODELNAME*	PLOT SCALE = 100.0000' / 1"	CHECKED -	REVISED -
	PLOT DATE = 4/24/2014	DATE -	REVISED -

**STATE OF ILLINOIS
DEPARTMENT OF TRANSPORTATION**

**PLAN US 51 CARBONDALE
SHEET 3 OF 3**

SCALE: SHEET OF SHEETS STA. TO STA.

F.A.P. RTE.	SECTION	COUNTY	TOTAL SHEETS	SHEET NO.
322	(1-1)RS-1, 1ORS-2, 9RS-6	JACKSON	26	20
CONTRACT NO. 78414				
ILLINOIS FED. AID PROJECT				

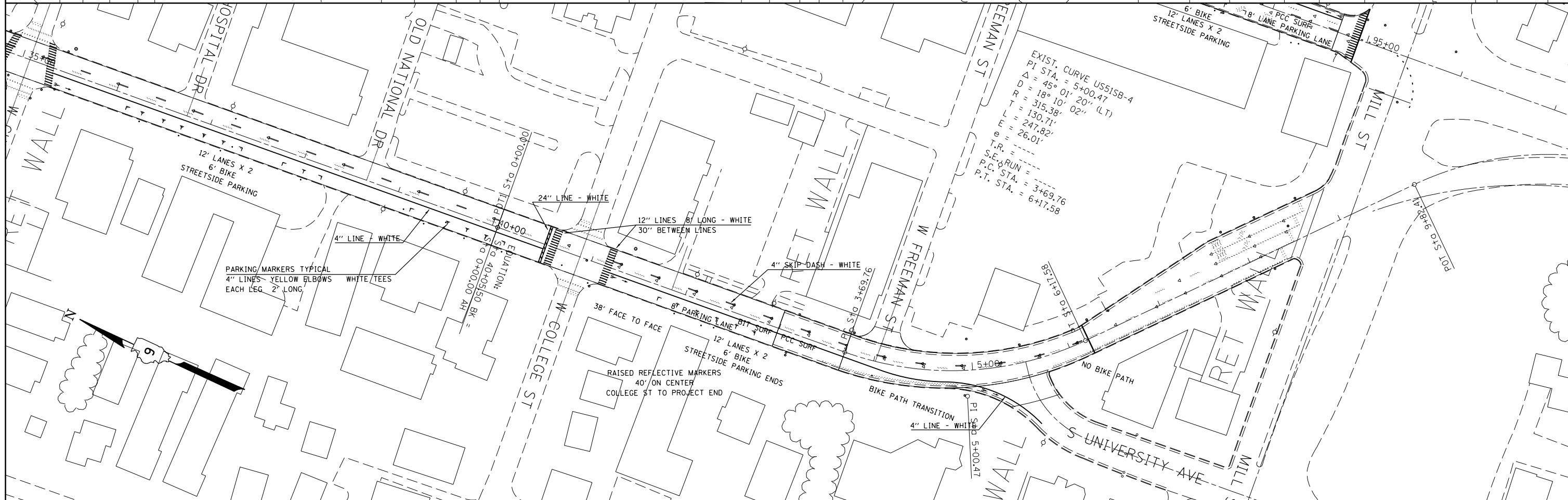
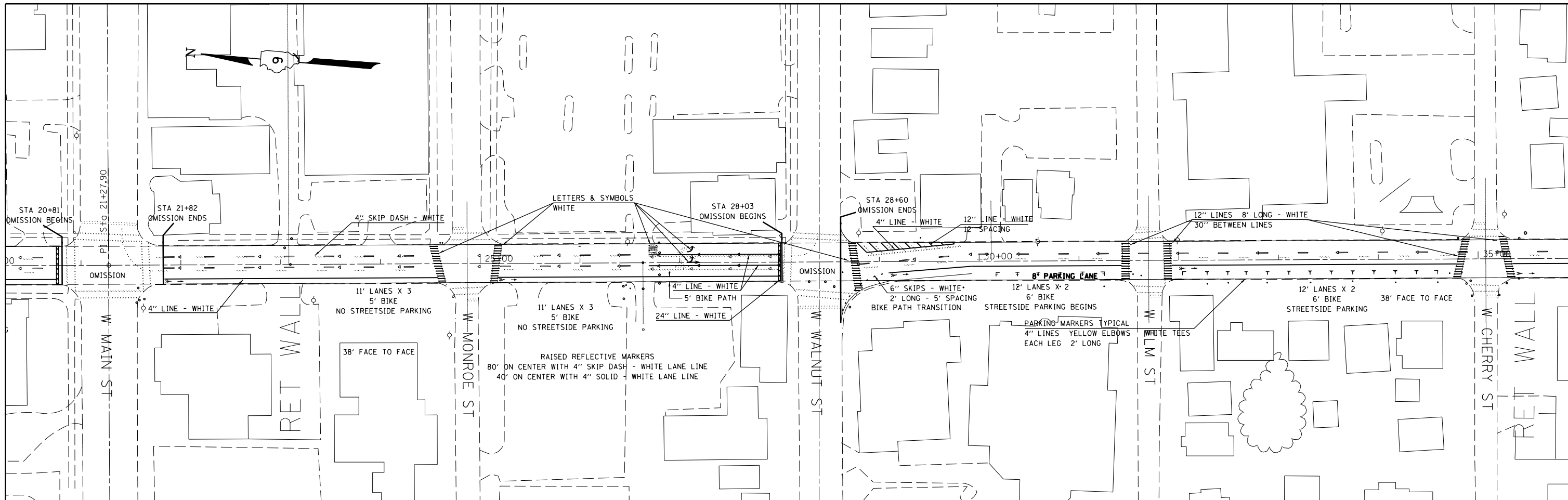

FILE NAME =	USER NAME = \$USERS	DESIGNED -	REVISED -
ei:\pwwork\pwwork\left\ltd\0381784\7814-sh-to-pmkplan.dgn		DRAWN -	REVISED -
\$MODELNAME\$	PLOT SCALE = 100.0000' / 1"	CHECKED -	REVISED -
	PLOT DATE = 4/24/2014	DATE -	REVISED -

**STATE OF ILLINOIS
DEPARTMENT OF TRANSPORTATION**

**PAVEMENT MARKING PLAN
SHEET 2 OF 3**

F.A.P. RTE.	SECTION	COUNTY	TOTAL SHEETS	SHEET NO.
322	(1-1)RS-1, 1ORS-2, 9RS-6	JACKSON	26	22
CONTRACT NO. 78414				
ILLINOIS FED. AID PROJECT				

SCALE: SHEET OF SHEETS STA. TO STA.

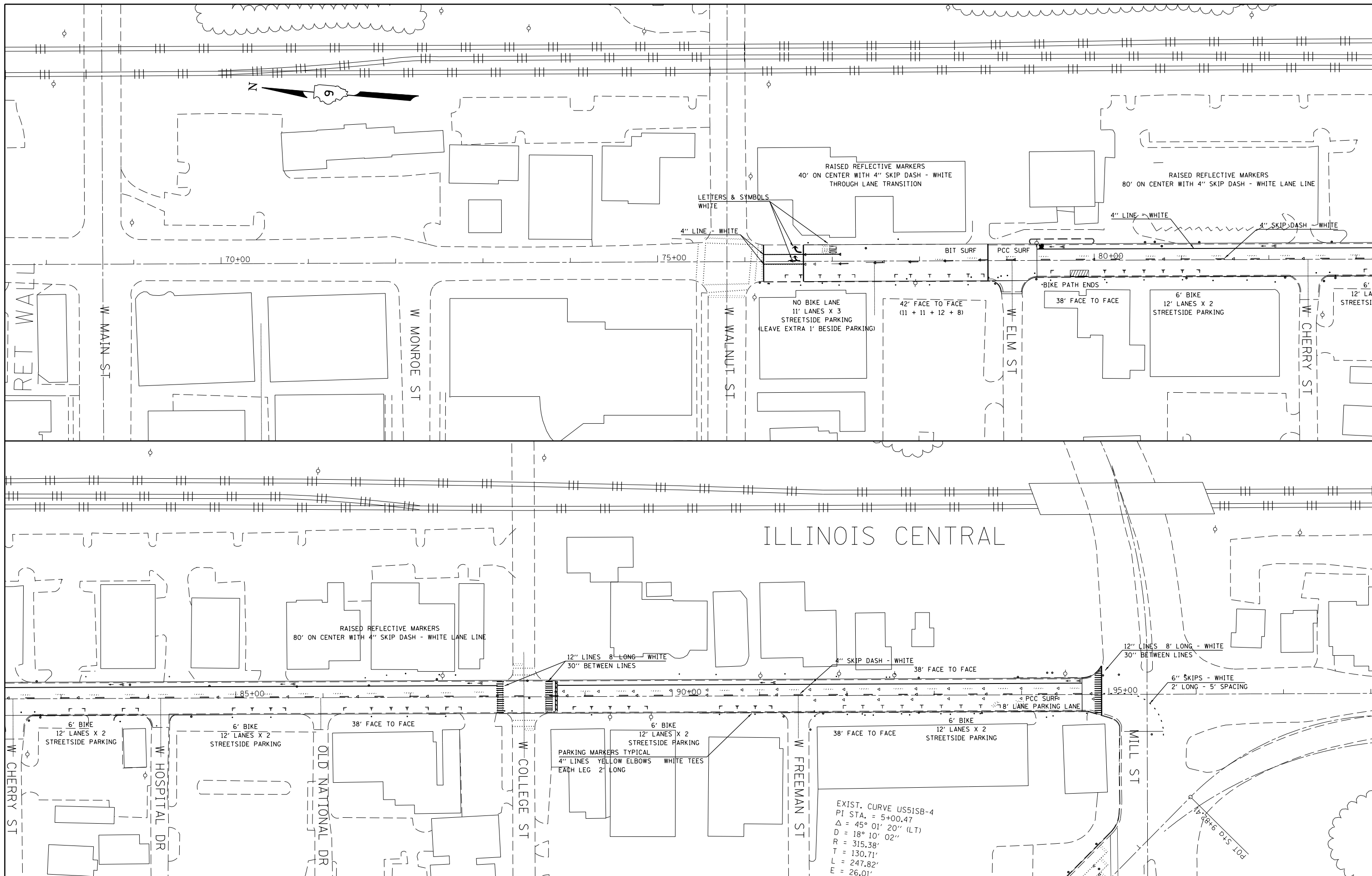

FILE NAME =	USER NAME = \$USER\$	DESIGNED -	REVISED -
ei:\pw_work\pwidot\leftwchd\0381784\7814-sh-to-pmkplan.dgn		DRAWN -	REVISED -
\$MODELNAME\$	PLOT SCALE = 100.0000' / in.	CHECKED -	REVISED -
	PLOT DATE = 4/24/2014	DATE -	REVISED -

**STATE OF ILLINOIS
DEPARTMENT OF TRANSPORTATION**

**PAVEMENT MARKING PLAN
SHEET 3 OF 3**

SCALE: SHEET OF SHEETS STA. TO STA.

F.A.P. RTE.	SECTION	COUNTY	TOTAL SHEETS	SHEET NO.
322	(1-1RS-1, 1ORS-2, 9RS-6)	JACKSON	26	23
CONTRACT NO. 78414				
ILLINOIS FED. AID PROJECT				

ILLINOIS STANDARD

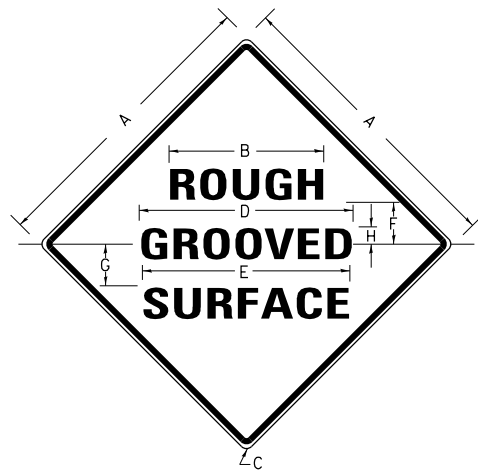

COLORS:

LEGEND AND BORDER- BLACK NON-REFLECTORIZED
BACKGROUND- ORANGE REFLECTORIZED

SIGN SIZE	DIMENSIONS							
	A	B	C	D	E	F	G	H
48X48	48.0	24.1	3.0	34.0	33.0	6.0	13.0	3.5

SIGN SIZE	SERIES LINES			MAR-GIN	BOR-DER	BLANK STD.
	1	2	3			
48X48	7C	7C	7C	0.8	1.2	B4-48D

ALL DIMENSIONS IN INCHES

NOTES:

PRIOR TO ALLOWING TRAFFIC ON ANY PORTION OF THE ROADWAY THAT HAS BEEN COLDMILLED, THE CONTRACTOR SHALL HAVE ERECTED "ROUGH GROOVED SURFACE" SIGNS THAT CONFORM TO THE ABOVE DETAILS. A MINIMUM OF ONE SIGN AT EACH END OF THE IMPROVEMENT WILL BE REQUIRED. THE CONTRACTOR SHALL MAINTAIN THE "ROUGH GROOVED SURFACE" SIGNS UNTIL THE COLDMILLED SURFACE IS COVERED WITH LEVELING BINDER OR SURFACE COURSE.

IF AT ANY TIME THE SIGNS ARE IN PLACE BUT NOT APPLICABLE, THEY SHALL BE TURNED FROM THE VIEW OF MOTORISTS OR COVERED AS DIRECTED BY THE ENGINEER.

THE COST OF FURNISHING, ERECTING, MAINTAINING, AND REMOVING THE REQUIRED SIGNS SHALL BE INCLUDED IN THE CONTRACT.

STD. 9-39

REVISIONS	
REDRAWN	2-15-89
REVISED	4-6-93
REVISED	3-27-08
REVIEWED	5-17-13

TEMPORARY HOT-MIX ASPHALT TRANSITIONS

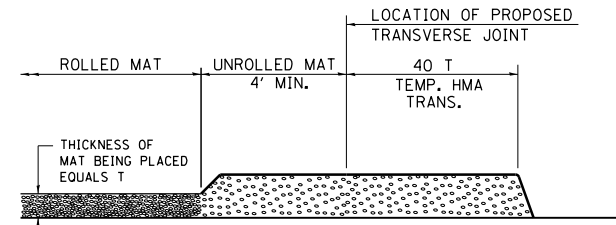

STEP I

- PLACE HOT-MIX ASPHALT MAT, LENGTH 40 TIMES THE THICKNESS OF THE MAT BEING PLACED PAST THE PROPOSED TRANSVERSE JOINT LOCATION USING NORMAL OPERATING PROCEDURES.
- EXTREME CARE SHOULD BE TAKEN TO MAINTAIN ENOUGH MATERIAL IN FRONT OF THE SCREED TO MAINTAIN REQUIRED PAVING DEPTH.

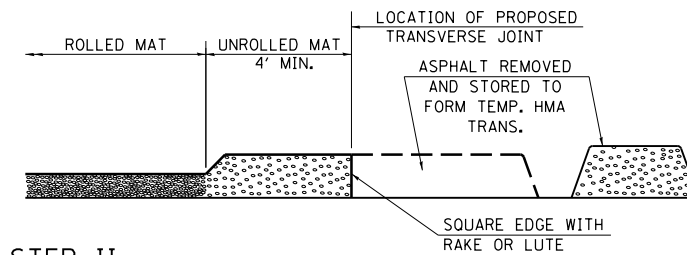

STEP II

- MOVE THE PAVER OUT OF THE WAY AND REMOVE THE ASPHALT FROM THE AREA OF THE PROPOSED TEMPORARY HOT-MIX ASPHALT TRANSITION.
- SQUARE UP THE END OF THE MAT WITH A RAKE OR LUTE.
- NOTE THAT THE MAT WITHIN 4' OF THE END OF JOINT IS NOT TO BE ROLLED AT THIS TIME.

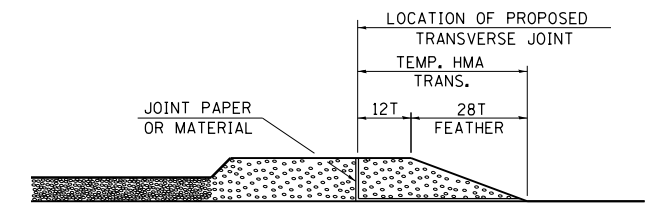

STEP III

- JOINT PAPER OR OTHER PRESELECTED JOINT MATERIAL IS THEN PLACED IN THE CLEARED AREA AND THE EXCESS ASPHALT USED TO HAND FORM A TRANSITION TO THE DIMENSIONS SHOWN ABOVE.
- NOTE THAT IN CONSTRUCTING THE TRANSITION, THE MAT DEPTH IS CONTINUED AS PART OF THE TRANSITION BEFORE FORMING THE FEATHER.

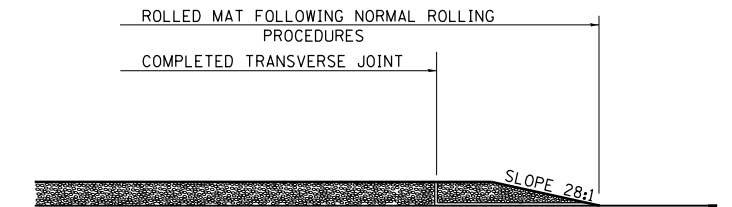

STEP IV

- COMPLETE TEMPORARY TRANSITION BY ROLLING.
- TO RESUME PAVING, AT THE JOINT, REMOVE TEMPORARY TRANSITION AND DISPOSE OF THE MATERIAL ACCORDING TO ART. 202.03 OF THE STD. SPECS. (COST INCLUDED IN THE CONTRACT).
- CONSTRUCTING THE TEMPORARY TRANSITIONS WILL NOT BE PAID FOR SEPARATELY IN ACCORDANCE WITH ARTICLE 406.14 OF THE STANDARD SPECIFICATIONS.

STD. 9-26

REVISIONS	
REDRAWN	2-15-89
REVISED	8-16-94
REVISED	01-09-07
RESIZED	05-8-08
REVISED	05-16-13

UNEVEN LANES SIGN

W8-11 (48" x 48")

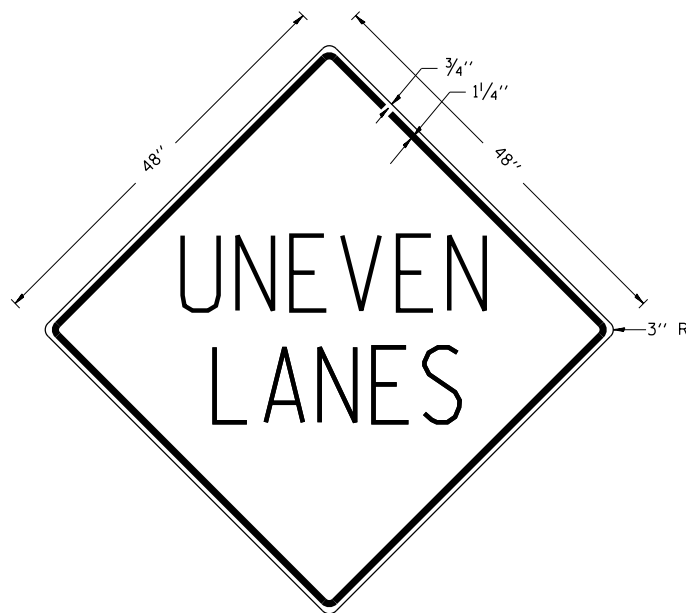

COLORS:

LEGEND AND BORDER - BLACK NON-REFLECTORIZED
BACKGROUND - ORANGE REFLECTORIZED

NOTE: PRIOR TO ALLOWING TRAFFIC ON ANY PORTION OF THE ROADWAY THAT HAS BEEN COLDMILLED OR BEFORE RESURFACING OPERATIONS BEGIN, THE CONTRACTOR SHALL HAVE ERECTED "UNEVEN PAVEMENT" SIGNS THAT CONFORM TO THE ABOVE DETAILS. A MINIMUM OF ONE SIGN AT EACH END OF THE IMPROVEMENT WILL BE REQUIRED. THE CONTRACTOR SHALL MAINTAIN THE "UNEVEN PAVEMENT" SIGNS UNTIL THE RESURFACING OPERATIONS ARE COMPLETED.

IF AT ANY TIME THE SIGNS ARE IN PLACE BUT NOT APPLICABLE, THEY SHALL BE TURNED FROM THE VIEW OF MOTORISTS OR COVERED AS DIRECTED BY THE ENGINEER.

THE COST OF FURNISHING, ERECTING, MAINTAINING, AND REMOVING THE REQUIRED SIGNS SHALL BE INCLUDED IN THE CONTRACT.

STD. 9-41

REVISIONS	
DRAWN	2-15-89
REVISED	4-06-93
RESIGNED	7-23-04
REVISED	5-08-08
REVIEWED	5-17-13

P.C.C. PATCHING-PARTIAL DEPTH

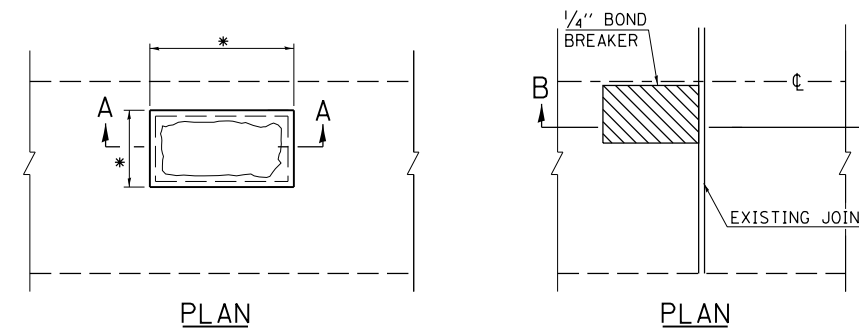

* LIMITS OF PARTIAL DEPTH PATCHING AS DIRECTED BY THE ENGINEER.

NOTES:

THE CONTRACTOR HAS THE OPTION OF SAWING THE PAVEMENT AND CHIPPING THE EDGES OR BY MILLING THE DEFINED AREA OF THE PATCH.

THE PAVEMENT SHALL BE SAWED A MINIMUM OF 2 INCH DEPTH IF THE SAWING OPTION IS USED.

THE DIAMETER OF THE WHEEL SAW OR MILLING MACHINE SHALL BE OF SUFFICIENT SIZE TO MAINTAIN THE 1:1 SIDE SLOPE. CHIPPING MAY STILL BE REQUIRED ON NARROW SIDES IF SO DIRECTED BY THE ENGINEER.

BEFORE SANDBLASTING, ALL VISIBLE WIRE MESH SHALL BE REMOVED FLUSH WITH THE CONCRETE BEING PATCHED.

IMMEDIATELY BEFORE APPLYING GROUT PRIOR TO CONCRETE PLACEMENT ALL EXPOSED SURFACES SHALL BE CLEANED BY SANDBLASTING, AIRBLASTING, WASHING AND BRUSHING.

A HAND VIBRATOR OR VIBRATING SCREED SHALL BE USED DURING THE PATCHING OPERATIONS. BURLAP CURING BLANKETS ARE NOT REQUIRED. CURING SHALL BE WITH CURING COMPOUNDS MEETING THE APPROVAL OF THE ENGINEER.

FOR ADDITIONAL REQUIREMENTS AND BASIS OF PAYMENT, SEE THE SPECIAL PROVISIONS.

SECTION A-A

SECTION B-B

STD. 9-37

REVISIONS	
DRAWN	2-15-89
REVISED	3-26-08
REVISED	5-16-13

FILE NAME =	USER NAME = \$USER\$	DESIGNED -	REVISED -
c:\pw\work\p\dot\left\lchd\ld0381784\7814-sh-ti-details.dgn		DRAWN -	REVISED -
\$MODELNAME\$	PLOT SCALE = 100.0000' / 1in.	CHECKED -	REVISED -
	PLOT DATE = 3/21/2014	DATE -	REVISED -

STATE OF ILLINOIS
DEPARTMENT OF TRANSPORTATION

DISTRICT STANDARDS

SCALE: SHEET OF SHEETS STA. TO STA.

F.A.P. RTE.	SECTION	COUNTY	TOTAL SHEETS	SHEET NO.
322	(1-1)RS-1, 10RS-2, 9RS-6	JACKSON	26	24
CONTRACT NO. 78414				
ILLINOIS FED. AID PROJECT				

SIDEROAD AND ENTRANCE DETAILS

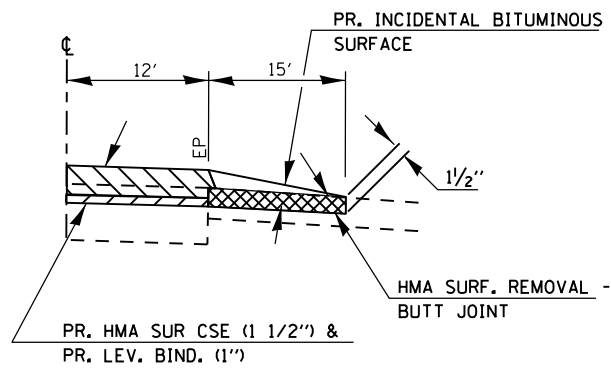

SIDE ROAD SEC. B-B
EX. BIT. OR CONC. SURFACE

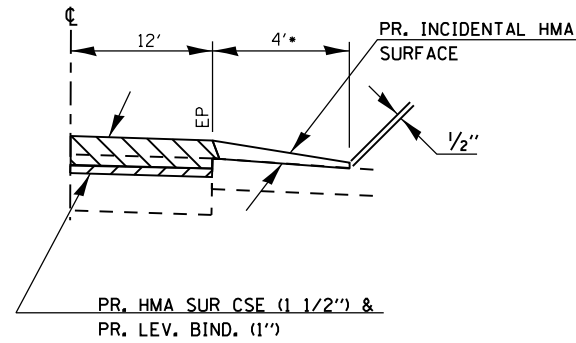

PE OR CE SEC. A-A
EX. BIT. OR CONC. SURFACE
•OR END OF BIT. APRON

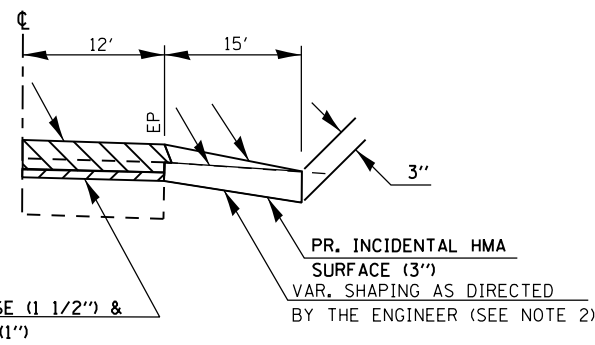

SIDE ROAD SEC. B-B
EX. AGGREGATE SURFACE
(SEE NOTE 1)

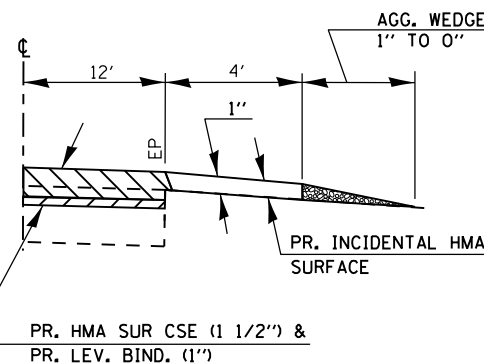

PE OR CE SEC. A-A
EX. AGGREGATE SURFACE

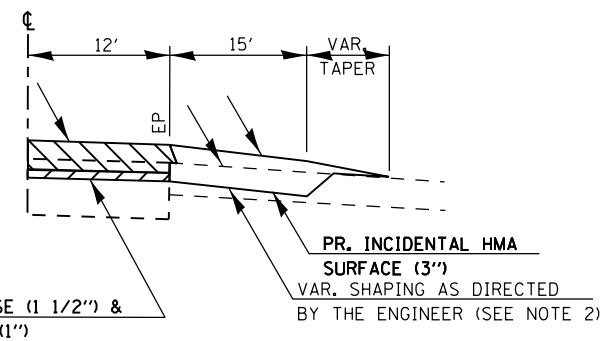

SIDE ROAD SEC. B-B
EX. OIL & CHIP SURFACE
(SEE NOTE 1)

NOTES

1. IF EXISTING SUBBASE IS INADEQUATE, AS DETERMINED BY THE ENGINEER, THE SIDE ROADS SHALL BE CORED OUT AND AGGREGATE SUBBASE, TYPE B SHALL BE PLACED FOR BASE. THE COST OF CORING OUT THE SIDE ROAD AND ANY AGGREGATE BASE COURSE SHALL BE PAID FOR AS SPECIFIED IN ART. 109.04 OF THE STANDARD SPECIFICATIONS FOR ROAD AND BRIDGE CONSTRUCTION. IF EXISTING SUBBASE IS DETERMINED TO BE ADEQUATE, THE PREPARATION OF THE BASE SHALL BE CONSTRUCTED ACCORDING TO ARTICLE 406.19.
2. VARIABLE SHAPING IS INCLUDED IN THE COST OF INCIDENTAL HOT-MIX ASPHALT SURFACE.

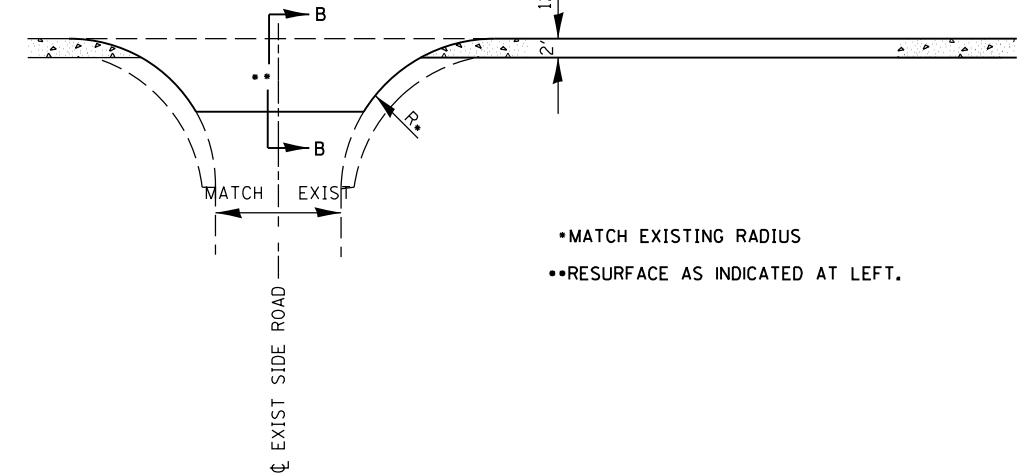
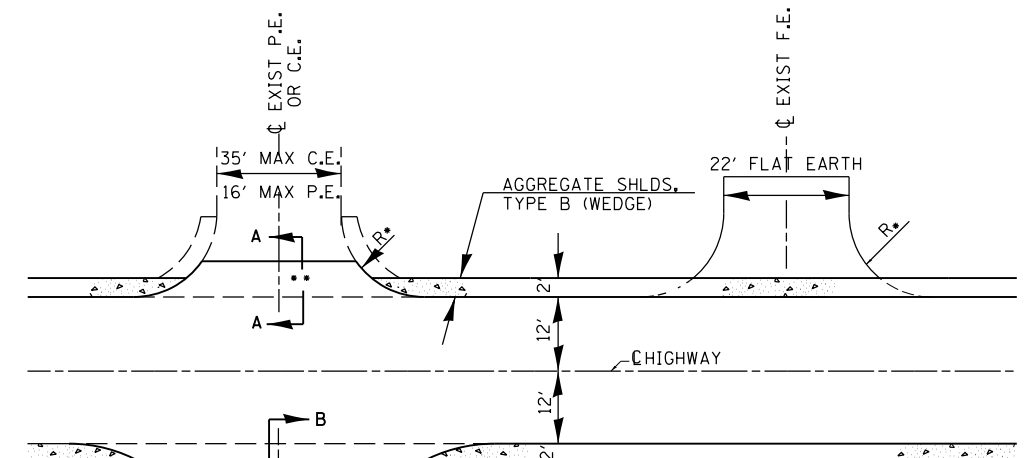

- MATCH EXISTING RADIUS
- RESURFACE AS INDICATED AT LEFT.

ENTRANCE SCHEDULE

TYPE	NUMBER OF ENTRANCES
S.R.	45
P.E.	3
C.E.	1

FILE NAME =	USER NAME = \$USER\$	DESIGNED -	REVISED -
ei:\pw\work\p\dot\left\lchd\1\0381784\7814-sh1-d\details.dgn		DRAWN -	REVISED -
\$MODELNAME\$	PLOT SCALE = 100.0000' / 1" =	CHECKED -	REVISED -
	PLOT DATE = 3/21/2014	DATE -	REVISED -

**STATE OF ILLINOIS
DEPARTMENT OF TRANSPORTATION**

SIDEROAD AND ENTRANCE DETAILS

SCALE: SHEET OF SHEETS STA. TO STA.

F.A.P. RTE.	SECTION	COUNTY	TOTAL SHEETS	SHEET NO.
322	(1-1)RS-1, 1ORS-2, 9RS-6	JACKSON	26	25
CONTRACT NO. 78414				
ILLINOIS FED. AID PROJECT				

DETAIL FOR PCC SURFACE REMOVAL -
BUTT JOINT

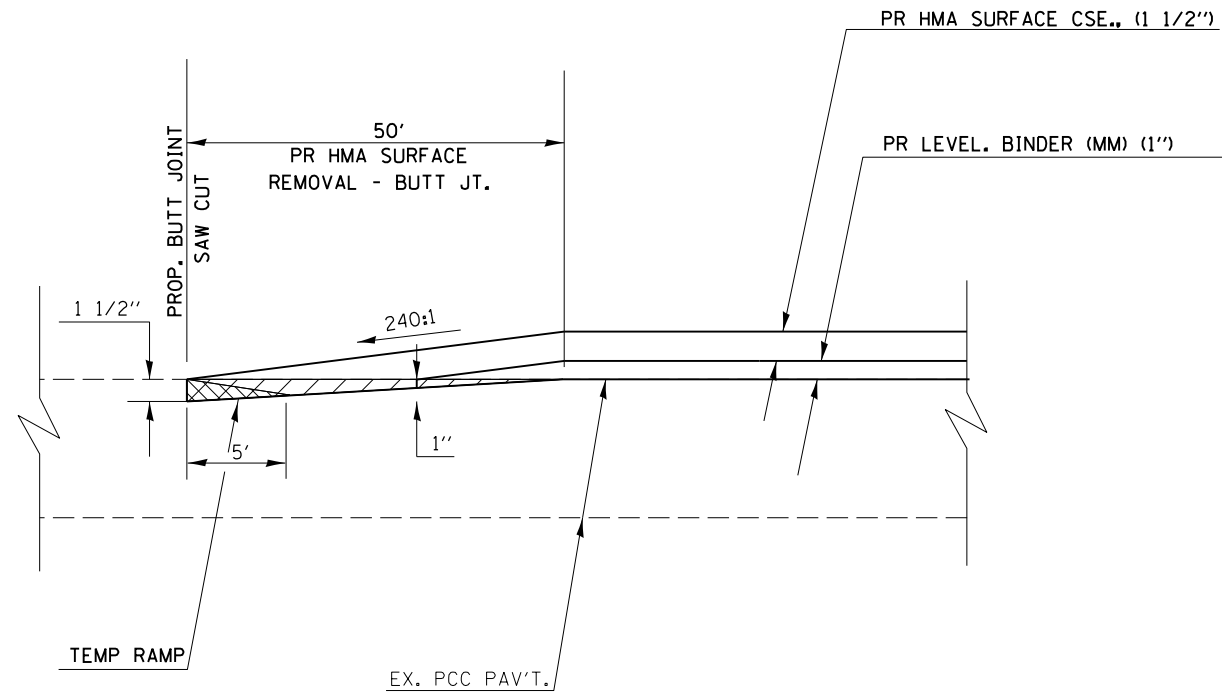

TO BE USED:
STA. 5+70.74 TO STA. 6+20.74
STA. 94+41.70 TO STA. 94+91.70

FILE NAME =	USER NAME = \$USER\$	DESIGNED -	REVISED -
ct:\pw\work\p\dot\left\lft\chd\ld0381784\78#14-sh-ti-details.dgn		DRAWN -	REVISED -
	PLOT SCALE = 100.0000' / 1" =	CHECKED -	REVISED -
\$MODELNAME\$	PLOT DATE = 3/21/2014	DATE -	REVISED -

STATE OF ILLINOIS
DEPARTMENT OF TRANSPORTATION

DETAILS - BUTT JOINT

SCALE: SHEET OF SHEETS STA. TO STA.

F.A.P. RTE.	SECTION	COUNTY	TOTAL SHEETS	SHEET NO.
322	(1-1)RS-1, 1ORS-2, 9RS-6	JACKSON	26	26
CONTRACT NO. 78414				
ILLINOIS FED. AID PROJECT				