

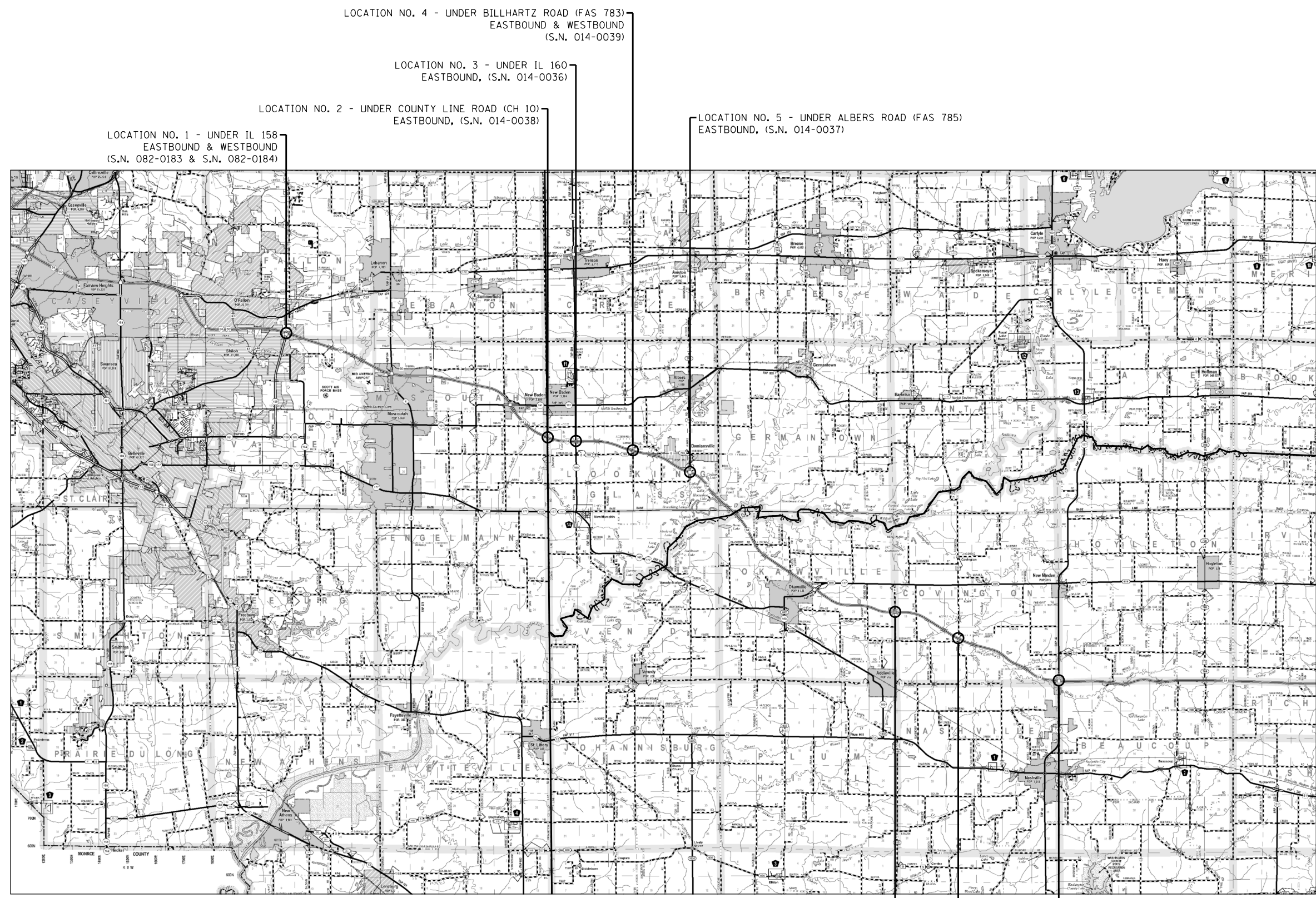

NOT TO SCALE



LOCATION NO. 1 - UNDER IL 158  
EASTBOUND & WESTBOUND  
(S.N. 082-0183 & S.N. 082-0184)

LOCATION NO. 2 - UNDER COUNTY LINE ROAD (CH 10)  
EASTBOUND, (S.N. 014-0038)

LOCATION NO. 3 - UNDER IL 160  
EASTBOUND, (S.N. 014-0036)

LOCATION NO. 4 - UNDER BILLHARTZ ROAD (FAS 783)  
EASTBOUND & WESTBOUND  
(S.N. 014-0039)

LOCATION NO. 5 - UNDER ALBERS ROAD (FAS 785)  
EASTBOUND, (S.N. 014-0037)

LOCATION NO. 6 - UNDER ADDIEVILLE ROAD (CH 4)  
EASTBOUND, (S.N. 095-0036)

LOCATION NO. 7 - UNDER COVINGTON ROAD (CH 27)  
EASTBOUND & WESTBOUND  
(S.N. 095-0037)

LOCATION NO. 8 - UNDER IL 127 (FAP 42)  
EASTBOUND & WESTBOUND  
(S.N. 095-0052)

ST. CLAIR  
COUNTY

CLINTON  
COUNTY

WASHINGTON  
COUNTY

ST. CLAIR  
COUNTY



**STATE OF ILLINOIS  
DEPARTMENT OF TRANSPORTATION**

**LOCATION MAP OF  
PATCHING OPERATIONS**

SCALE: SHEET 1 OF 1 SHEETS STA. TO STA.

\*ST. CLAIR, CLINTON, & WASHINGTON

FILE NAME = H:\6513 IDOT DB Ver\6513.10 W0 10 Patching\CADD_Sheets\0876G81-sht-overall plan.dgn	USER NAME = agerstner	DESIGNED - ARG	REVISED -
PLOT SCALE = 20000.0000' / in.	Default	DRAWN - ARG	REVISED -
PLOT DATE = 2/20/2014		CHECKED - KJS	REVISED -
		DATE - 11-15-2013	REVISED -

F.A.I. RTE.	SECTION	COUNTY	TOTAL SHEETS	SHEET NO.
64	DIST 8 PATCHING 2014-1	*	8	5
			CONTRACT NO. 76G81	
ILLINOIS FED. AID PROJECT				