

STATE OF ILLINOIS
DEPARTMENT OF TRANSPORTATION
DIVISION OF HIGHWAYS
PROPOSED
HIGHWAY PLANS

F.A.I. RTE.	SECTION	COUNTY	TOTAL SHEETS	SHEET NO.
55		ILLINOIS	10	1

• D6 SPRING ROAD REPAIR 2014-2
 • LOGAN/SANGAMON COUNTIES

INDEX OF SHEETS

1. COVER SHEET
2. GENERAL NOTES, COMMITMENTS & STANDARDS
3. PROJECT LOCATIONS
4. - 5. SUMMARY OF QUANTITIES
6. - 7. TYPICAL SECTIONS
8. - 10. PLAN SHEETS

WILLIAMSVILLE
 ADT (2013) = 29,900
 PV = 68%
 SU = 8.7%
 MU = 22.4%

BROADWELL
 ADT (2013) = 29,900
 PV = 76.0%
 SU = 3.3%
 MU = 20.7%

BL-55
 ADT (2013) = 29,900
 PV = 76.2%
 SU = 3.1%
 MU = 20.7%

FAI ROUTE 55 (I 55)
SECTION D6 SPRING RD REPAIR 2014-2

MILL, RESURFACE
LOGAN/SANGAMON COUNTY

D-96-073-14



C-96-073-14

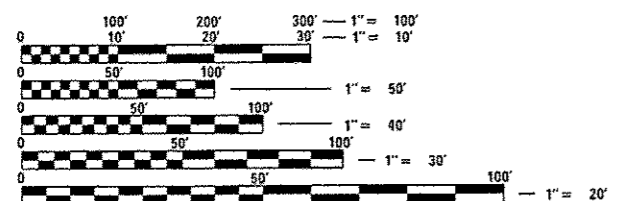
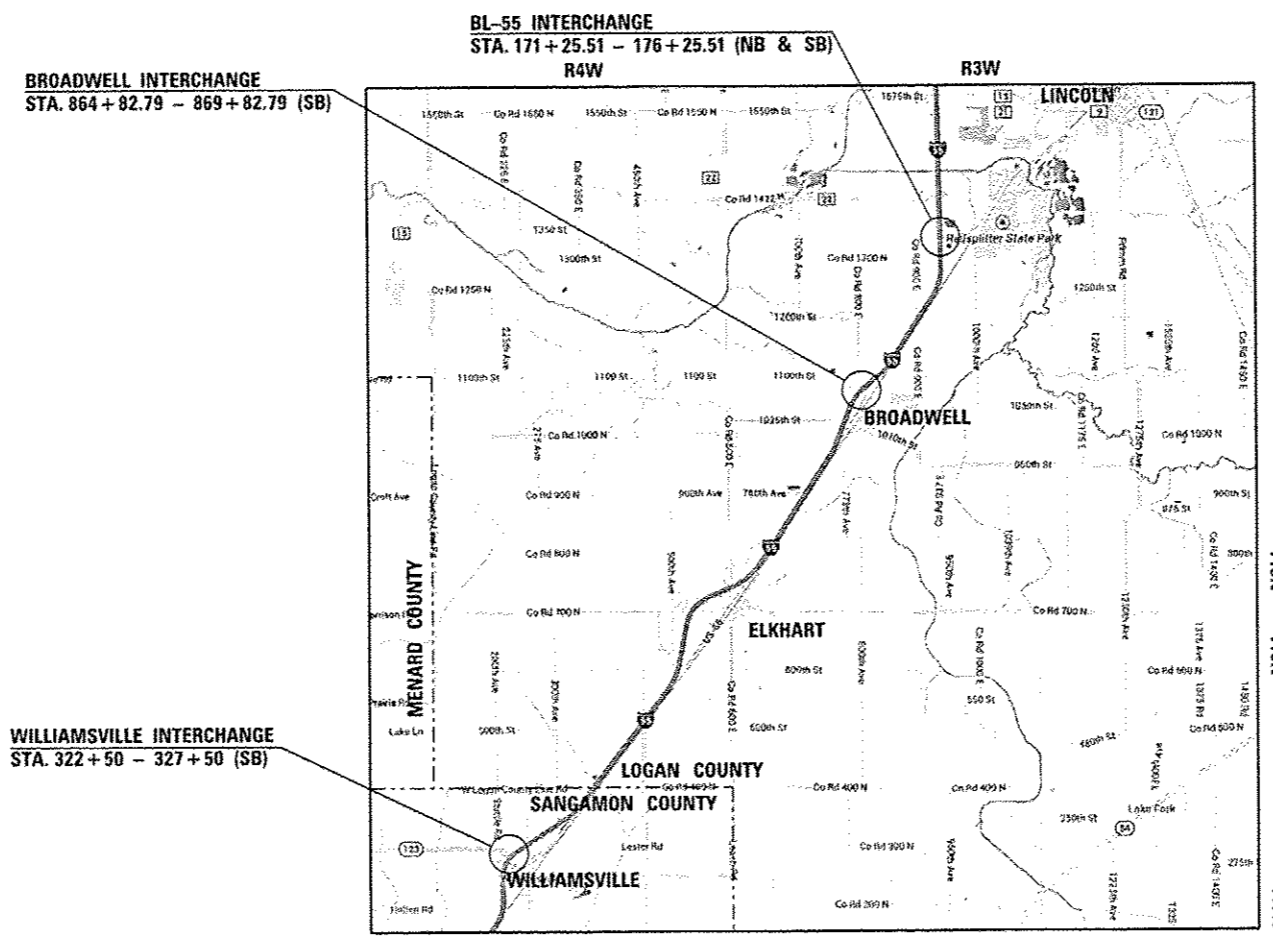

FULL SIZE PLANS HAVE BEEN PREPARED USING STANDARD ENGINEERING SCALES. REDUCED SIZED PLANS WILL NOT CONFORM TO STANDARD SCALES. IN MAKING MEASUREMENTS ON REDUCED PLANS, THE ABOVE SCALES MAY BE USED.

J.U.L.I.E.
 JOINT UTILITY LOCATION INFORMATION FOR EXCAVATION
 1-800-892-0123
 OR 811

PROJECT ENGINEER: VINCENT J. MADONIA (217) 785-9046
 PROJECT MANAGER: VICTOR T. YOUNG (217) 524-0472

GROSS LENGTH = 1500 FT. = 0.28 MILE
 NET LENGTH = 1500 FT. = 0.28 MILE

CONTRACT NO. 72H02



SEE SHEET NO. 3 FOR EXPANDED VIEW OF PROJECT LOCATIONS

STATE OF ILLINOIS
 DEPARTMENT OF TRANSPORTATION
 DIVISION OF HIGHWAYS

SUBMITTED April 17 20 14
Logan Z. Dushak
 DEPUTY DIRECTOR OF HIGHWAYS, REGION ENGINEER

May 9 20 14
John D. Baranzelli, P.E.
 acting ENGINEER OF DESIGN AND ENVIRONMENT

May 9 20 14
Omair Osman, P.E.
 DIRECTOR OF HIGHWAYS, CHIEF ENGINEER

PRINTED BY THE AUTHORITY
OF THE STATE OF ILLINOIS

PROJECT LOCATION

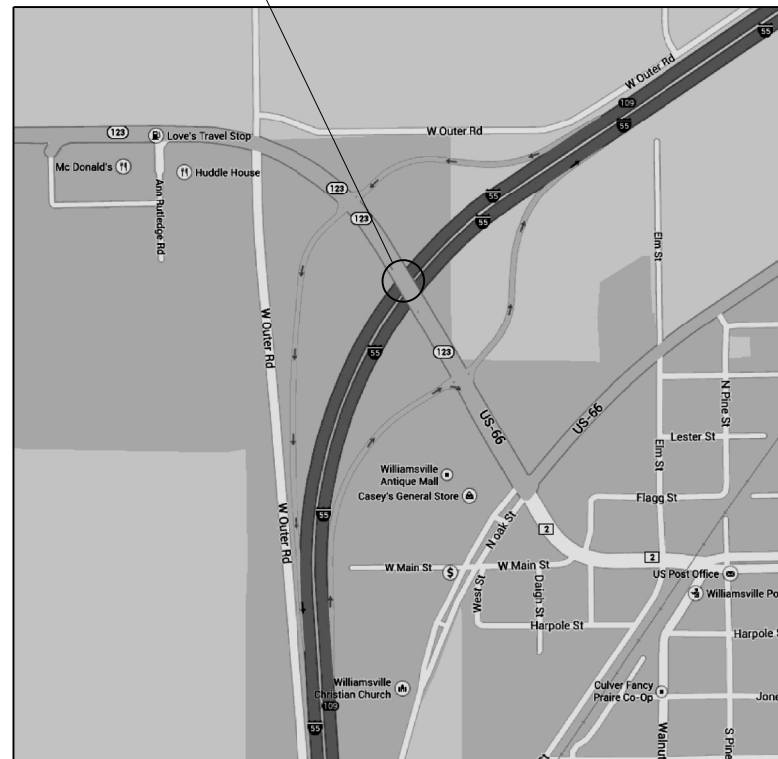

MILE MARKER 109

SOUTHBOUND LANE I-55 OVERHEAD
NEAR WILLIAMSVILLE, IL.
STA. 332+50 - 327+50

PROJECT LOCATION

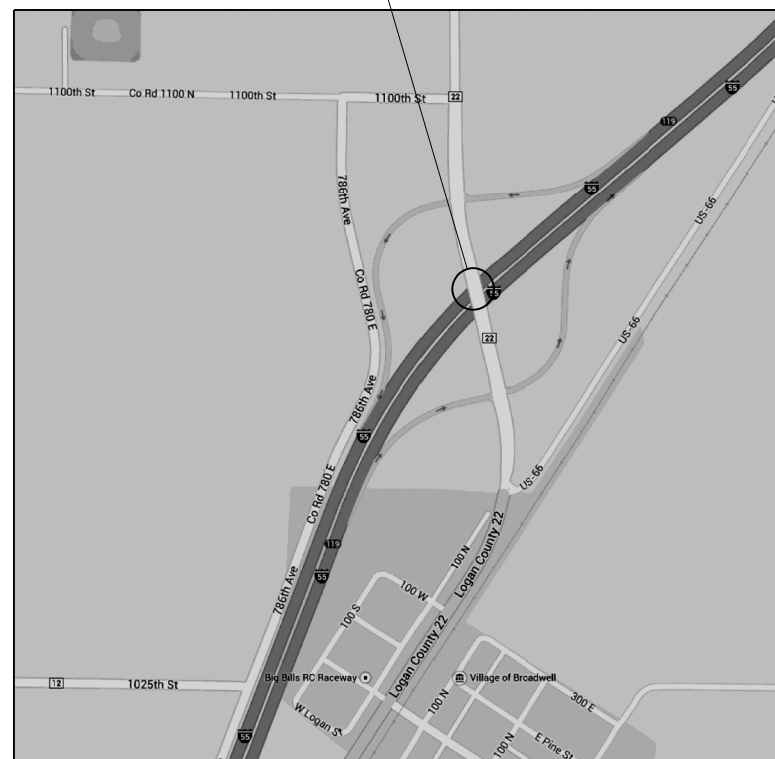

MILE MARKER 119

SOUTHBOUND LANE I-55 OVERHEAD
NEAR BROADWELL, IL.
STA. 864+82.79 - 869+82.79

PROJECT LOCATION

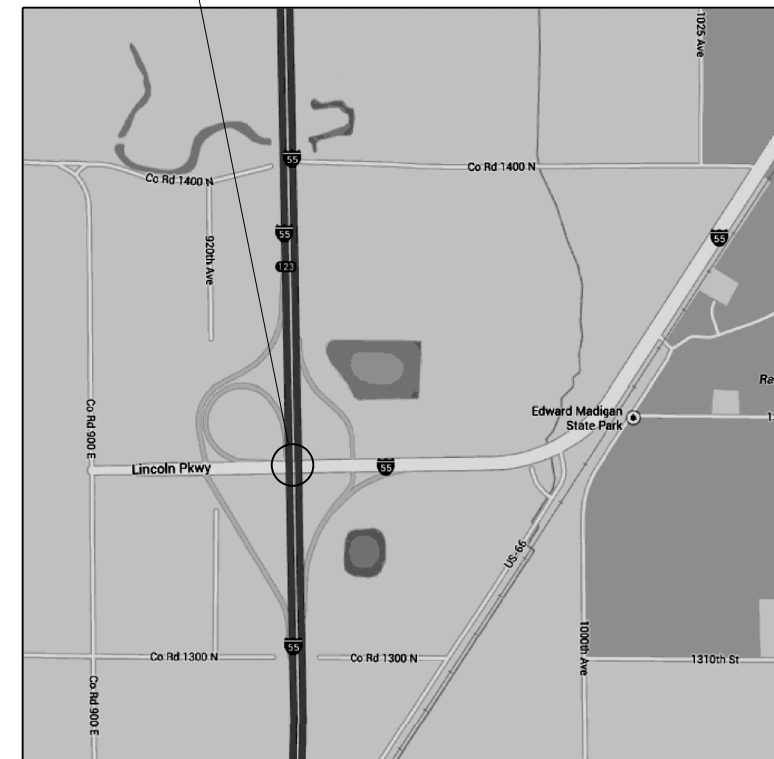

MILE MARKER 123

NORTHBOUND & SOUTHBOUND LANES
I-55 OVERHEAD NEAR LINCOLN, IL.
STA. 171+25.51 - 176+25.51

FILE NAME =	USER NAME = sparksgw	DESIGNED -	REVISED -
Default	PR02-sht-PROJLOC.dgn	DRAWN -	REVISED -
	PLOT SCALE = 0.1250' / 1" =	CHECKED -	REVISED -
	PLOT DATE = Apr-17-2014 02:19:15PM	DATE -	REVISED -

**STATE OF ILLINOIS
DEPARTMENT OF TRANSPORTATION**

PROJECT LOCATIONS

SCALE: SHEET OF SHEETS STA. TO STA.

F.A.I. RTE.	SECTION	COUNTY	TOTAL SHEETS	SHEET NO.
55	.	..	10	3
CONTRACT NO. 72H02				
ILLINOIS FED. AID PROJECT				

CODE NO.	ITEM	UNIT	TOTAL QUANTITY	100% STATE		
				SANGAMON COUNTY	LOGAN COUNTY	
				CONSTRUCTION CODE		
				ROADWAY 0005	ROADWAY 0005	ROADWAY 0005
			WILLIAMSVILLE	BROADWELL	BUS LOOP 55	
40600200	BITUMINOUS MATERIALS (PRIME COAT)	TON	3.2	0.8	0.8	1.6
40600300	AGGREGATE (PRIME COAT)	TON	12	3	3	6
40600845	POLYMERIZED LEVELING BINDER (MACHINE METHOD), N90	TON	728	168	168	392
40600982	HOT-MIX ASPHALT SURFACE REMOVAL - BUTT JOINT	SQ YD	320	80	80	160
40600990	TEMPORARY RAMP	SQ YD	160	40	40	80
40603545	POLYMERIZED HOT-MIX ASPHALT SURFACE COURSE, MIX "D", N90	TON	728	168	168	392
67100100	MOBILIZATION	L SUM	1	0.25	0.25	0.5
70100420	TRAFFIC CONTROL AND PROTECTION, STANDARD 701411	EACH	4	1	1	2
70100700	TRAFFIC CONTROL AND PROTECTION, STANDARD 701406	L SUM	1	0.25	0.25	0.5
70100800	TRAFFIC CONTROL AND PROTECTION, STANDARD 701401	L SUM	1	0.25	0.25	0.5
70100815	TRAFFIC CONTROL AND PROTECTION, STANDARD 701446	L SUM	1	0.25	0.25	0.5
70106800	CHANGEABLE MESSAGE SIGN	CAL MO	1	0.25	0.25	0.5
70200100	NIGHTTIME WORK ZONE LIGHTING	L SUM	1	0.25	0.25	0.5
70300100	SHORT TERM PAVEMENT MARKING	FOOT	544	136	136	272

FILE NAME #	USER NAME #	DESIGNED -	REVISED -
c:\pwork\p\idot\sparkgs\0307600\0672H02-akt-500.dgn	sparkgs	DRAWN -	REVISED -
		CHECKED -	REVISED -
		DATE -	REVISED -

**STATE OF ILLINOIS
DEPARTMENT OF TRANSPORTATION**

SUMMARY OF QUANTITIES

SCALE:	SHEET	OF	SHEETS	STA.	TO STA.
--------	-------	----	--------	------	---------

F.A.I. RTE.	SECTION	COUNTY	TOTAL SHEETS	SHEET NO.
55	*	**	10	4
CONTRACT NO. 72H02				

ADD ME W9A

CODE NO.	ITEM	UNIT	TOTAL QUANTITY	100% STATE		
				SANGAMON COUNTY	LOGAN COUNTY	
				CONSTRUCTION CODE		
				ROADWAY 0005 WILLIAMSVILLE	ROADWAY 0005 BROADWELL	ROADWAY 0005 BUS LOOP 55
70301000	WORK ZONE PAVEMENT MARKING REMOVAL	SQ FT	116	29	29	58
* 78004220	PREFORMED PLASTIC PAVEMENT MARKING, TYPE B - INLAID - LINE 5"	FOOT	1000	250	250	500
* 78009005	MODIFIED URETHANE PAVEMENT MARKING - LINE 5"	FOOT	4000	1000	1000	2000
* 78100100	RAISED REFLECTIVE PAVEMENT MARKER	EACH	64	16	16	32
78300100	PAVEMENT MARKING REMOVAL	SQ FT	64	16	16	32
X4401198	HOT-MIX ASPHALT SURFACE REMOVAL, VARIABLE DEPTH	SQ YD	8000	2000	2000	4000
X7010410	SPEED DISPLAY TRAILER	CAL MO	1	0.25	0.25	0.5

* SPECIALTY ITEM

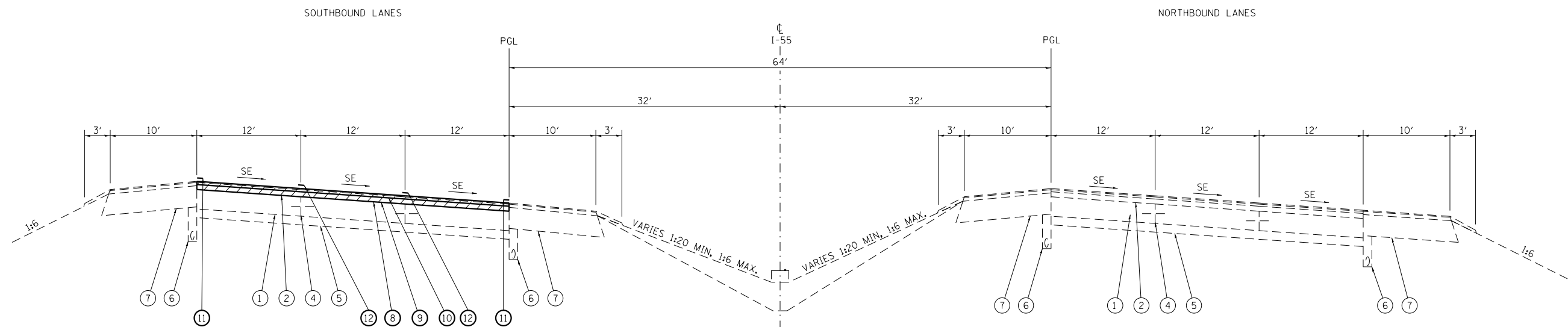

WILLIAMSVILLE

STA. 322+67.62 TO STA. 327+67.62

NOTES

1. MILL TO BARE CONCRETE.
2. MATCH EXISTING SUPERELEVATION

LEGEND

- ① EXISTING CRCP PAVEMENT 9"
- ② EXISTING HOT-MIX ASPHALT 3 1/4"
- ③ EXISTING HOT-MIX ASPHALT 3"
- ④ EXISTING LONGITUDINAL JOINT
- ⑤ EXISTING STABILIZED SUBBASE 4"
- ⑥ EXISTING UNDERDRAIN
- ⑦ EXISTING HOT-MIX ASPHALT SHOULDER
- ⑧ PROPOSED POLYMERIZED HOT-MIX ASPHALT LEVELING BINDER COURSE, IL-9.5, N90, 1 1/2"
- ⑨ PROPOSED POLYMERIZED HOT-MIX ASPHALT SURFACE COURSE, MIX "D", N90, 1 1/2"
- ⑩ PROPOSED HOT-MIX ASPHALT SURFACE REMOVAL, (VARIABLE DEPTH)
- ⑪ PROPOSED MODIFIED URETHANE PAVEMENT MARKING - LINE, 5"
- ⑫ PROPOSED PREFORMED PLASTIC PAVEMENT MARKING TYPE B - INLAID - LINE, 5"

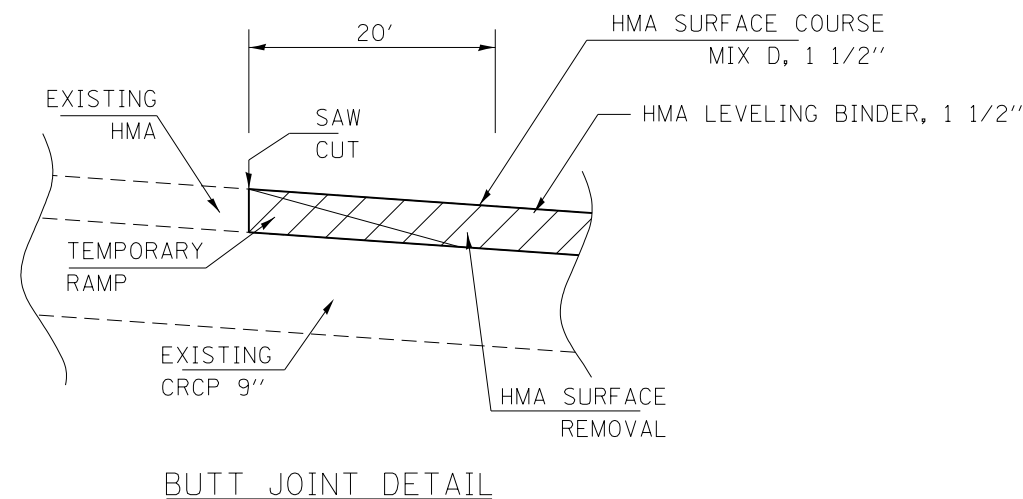

BUTT JOINT DETAIL

• D6 SPRING RD REPAIR 2014-2
 •• LOGAN/SANGAMON COUNTIES

FILE NAME =	USER NAME = sparksgw	DESIGNED -	REVISED -
ci:\pw\work\p\idot\sparksgw\10387600\0672\PH02-sht-typical.dgn		DRAWN -	REVISED -
Default	PLOT SCALE = 100.0000' / 1in.	CHECKED -	REVISED -
	PLOT DATE = Apr-17-2014 02:19:24PM	DATE -	REVISED -

STATE OF ILLINOIS
 DEPARTMENT OF TRANSPORTATION

I-55 TYPICAL SECTIONS
 D6 SPRING RD REPAIR 2014-2

SCALE: SHEET OF SHEETS STA. TO STA.

F.A.I. RTE.	SECTION	COUNTY	TOTAL SHEETS	SHEET NO.
55	•	••	10	6
CONTRACT NO. 72H02				
ILLINOIS FED. AID PROJECT				

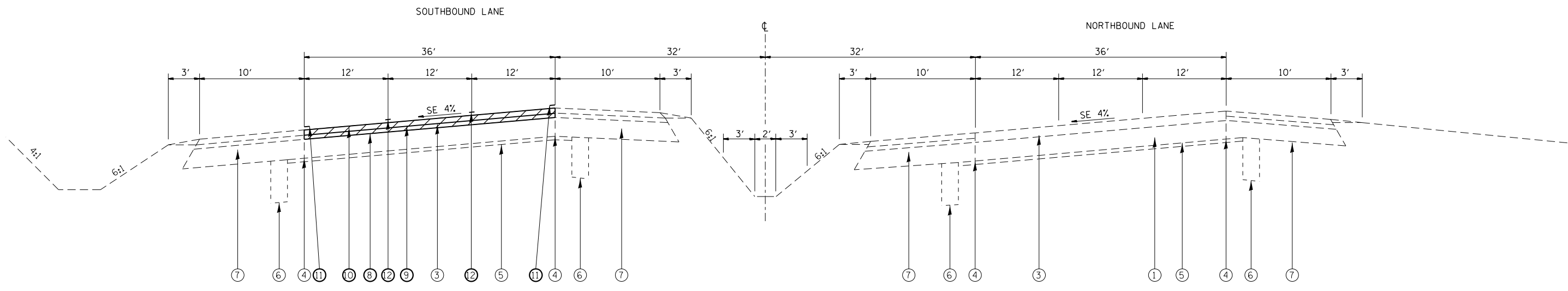

BROADWELL

STA. 865+12.63 TO STA. 870+12.63

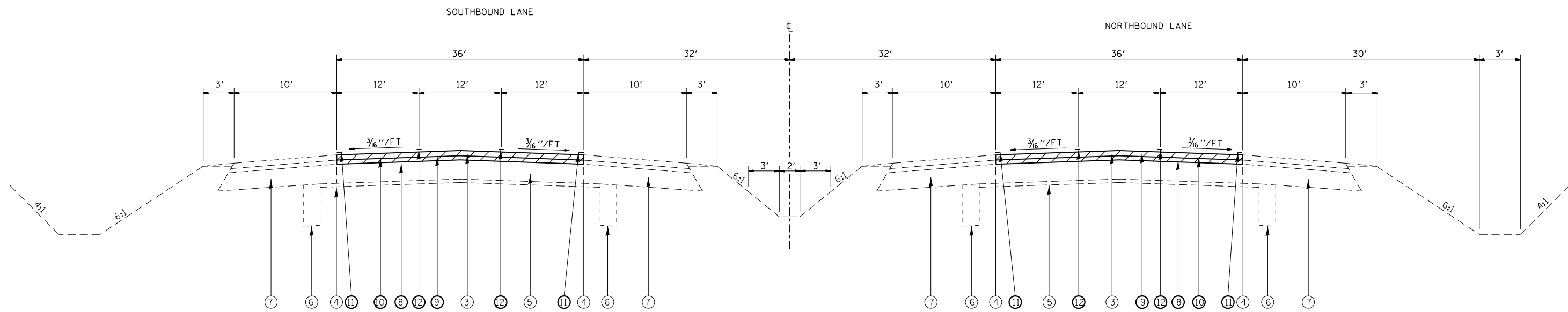

LINCOLN

STA. 171+25.51 TO STA. 176+25.51
BL-55 (SB & NB)

NOTES

1. MILL TO BARE CONCRETE.
2. MATCH EXISTING SUPERELEVATION

LEGEND

- ① EXISTING CRCP PAVEMENT 9"
- ② EXISTING HOT-MIX ASPHALT 3/4"
- ③ EXISTING HOT-MIX ASPHALT 3"
- ④ EXISTING LONGITUDINAL JOINT
- ⑤ EXISTING STABILIZED SUBBASE 4"
- ⑥ EXISTING UNDERDRAIN
- ⑦ EXISTING HOT-MIX ASPHALT SHOULDER
- ⑧ PROPOSED POLYMERIZED HOT-MIX ASPHALT LEVELING BINDER COURSE, IL-9.5, N90, 1 1/2"
- ⑨ PROPOSED POLYMERIZED HOT-MIX ASPHALT SURFACE COURSE, MIX "D", N90, 1 1/2"
- ⑩ PROPOSED HOT-MIX ASPHALT SURFACE REMOVAL, (VARIABLE DEPTH)
- ⑪ PROPOSED MODIFIED URETHANE PAVEMENT MARKING - LINE, 5"
- ⑫ PROPOSED PREFORMED PLASTIC PAVEMENT MARKING TYPE B - INLAID - LINE, 5"

• D6 SPRING RD REPAIR 2014-2
•• LOGAN/SANGAMON COUNTIES

FILE NAME =	USER NAME = sparksgw	DESIGNED -	REVISED -	STATE OF ILLINOIS DEPARTMENT OF TRANSPORTATION	I-55 TYPICAL SECTIONS D6 SPRING RD REPAIR 2014-2				F.A.I. RTE.	SECTION	COUNTY	TOTAL SHEETS	SHEET NO.			
Default	c:\pwwork\pwwork\sparksgw\10387600\0672\PH02-sh-typical.dgn	DRAWN -	REVISED -		SCALE:	SHEET	OF	SHEETS	STA.	TO	STA.	55	•	••	10	7
	PLOT SCALE = 100.0000' / 1in.	CHECKED -	REVISED -													
	PLOT DATE = Apr-17-2014 02:19:24PM	DATE -	REVISED -													
												CONTRACT NO. 72H02				
												ILLINOIS FED. AID PROJECT				

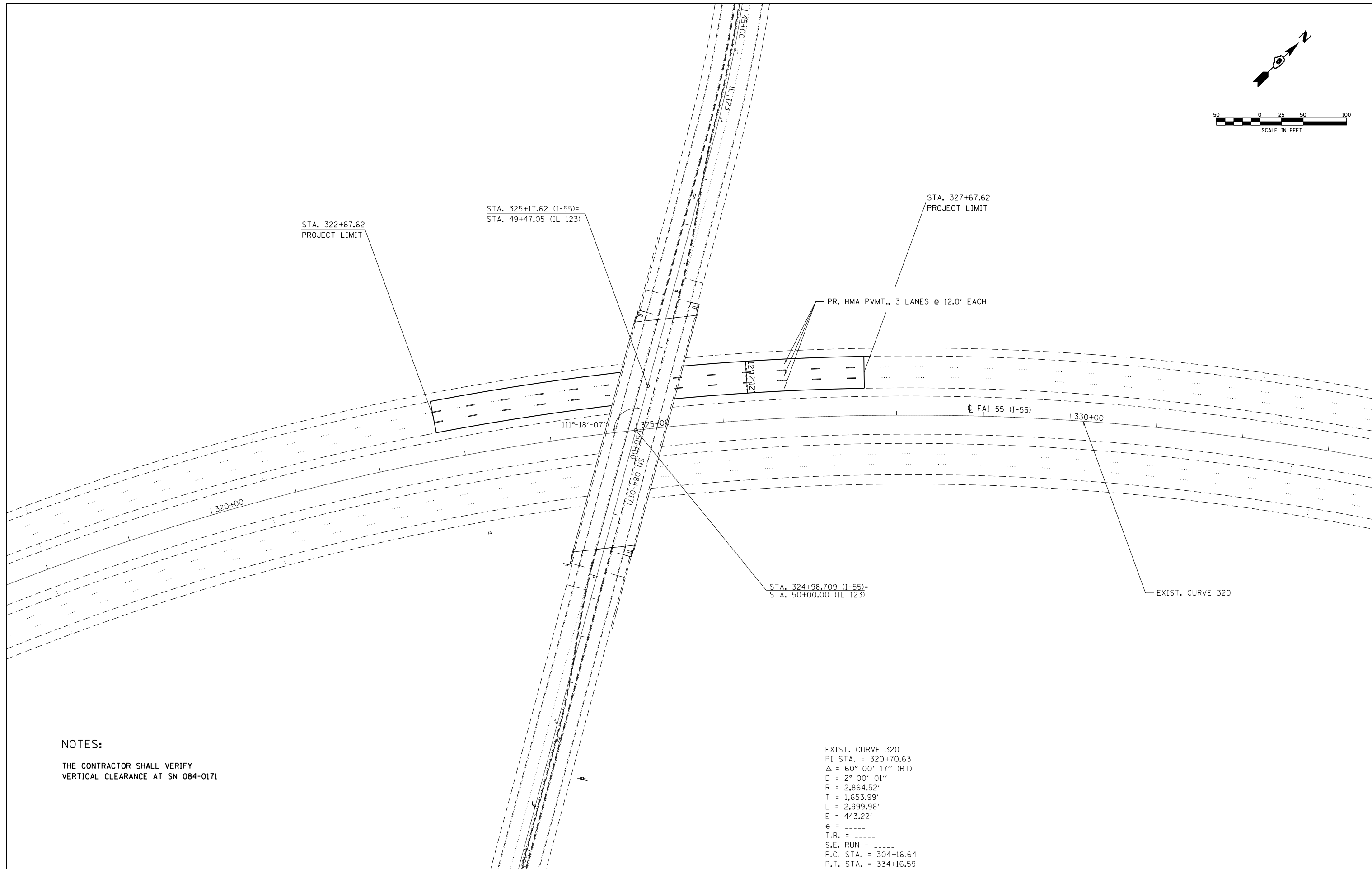
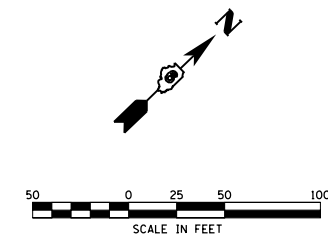

NOTES:

THE CONTRACTOR SHALL VERIFY
VERTICAL CLEARANCE AT SN 084-0171

EXIST. CURVE 320
 PI STA. = 320+70.63
 Δ = 60° 00' 17" (RT)
 D = 2° 00' 01"
 R = 2,864.52'
 T = 1,653.99'
 L = 2,999.96'
 E = 443.22'
 e = -----
 T.R. = -----
 S.E. RUN = -----
 P.C. STA. = 304+16.64
 P.T. STA. = 334+16.59

FILE NAME = c:\pwork\work\pwork\sparksgw\0387600\0672H02-sht-plan.dgn	USER NAME = sparksgw	DESIGNED -	REVISED -
Default	PLOT SCALE = 100.00' / in.	DRAWN -	REVISED -
	PLOT DATE = Apr-17-2014 02:19:25PM	CHECKED -	REVISED -
		DATE -	REVISED -

**STATE OF ILLINOIS
DEPARTMENT OF TRANSPORTATION**

**PLAN VIEW
I-55 - WILLIAMSVILLE EXIT**

SCALE: SHEET OF SHEETS STA. TO STA.

F.A.I. RTE.	SECTION	COUNTY	TOTAL SHEETS	SHEET NO.
55	.	**	10	8
CONTRACT NO. 72H02			ILLINOIS FED. AID PROJECT	

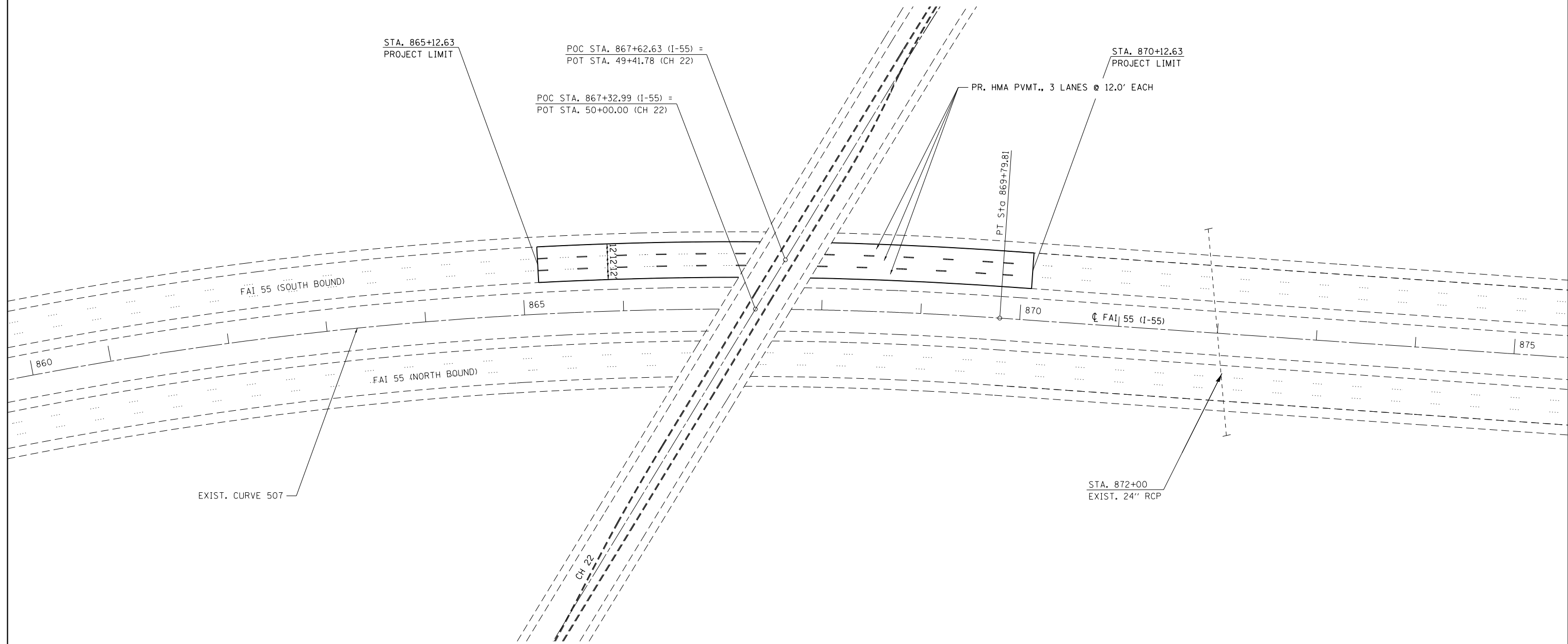
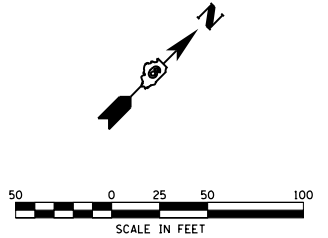

NOTES:

THE CONTRACTOR SHALL VERIFY
VERTICAL CLEARANCE AT SN 054-0039

EXIST. CURVE 507
 PI STA. = 860+49.87
 Δ = 28° 29' 41" (RT)
 D = 1° 29' 59"
 R = 3,820.47'
 T = 970.09'
 L = 1,900.02'
 E = 121.24'
 e = -----
 T.R. = -----
 S.E. RUN = -----
 P.C. STA. = 850+79.78
 P.T. STA. = 869+79.81

FILE NAME =	USER NAME = sparksgw	DESIGNED -	REVISED -
et:\pwork\pwork\sparksgw\0387600\0672H02-sht-plan.dgn		DRAWN -	REVISED -
Default	PLOT SCALE = 100.00' / in.	CHECKED -	REVISED -
	PLOT DATE = Apr-17-2014 02:19:25PM	DATE -	REVISED -

**STATE OF ILLINOIS
DEPARTMENT OF TRANSPORTATION**

PLAN VIEW I-55 - BROADWELL EXIT			
SCALE:	SHEET	OF SHEETS	STA. TO STA.

F.A.I. RTE.	SECTION	COUNTY	TOTAL SHEETS	SHEET NO.
55	.	**	10	9
CONTRACT NO. 72H02				

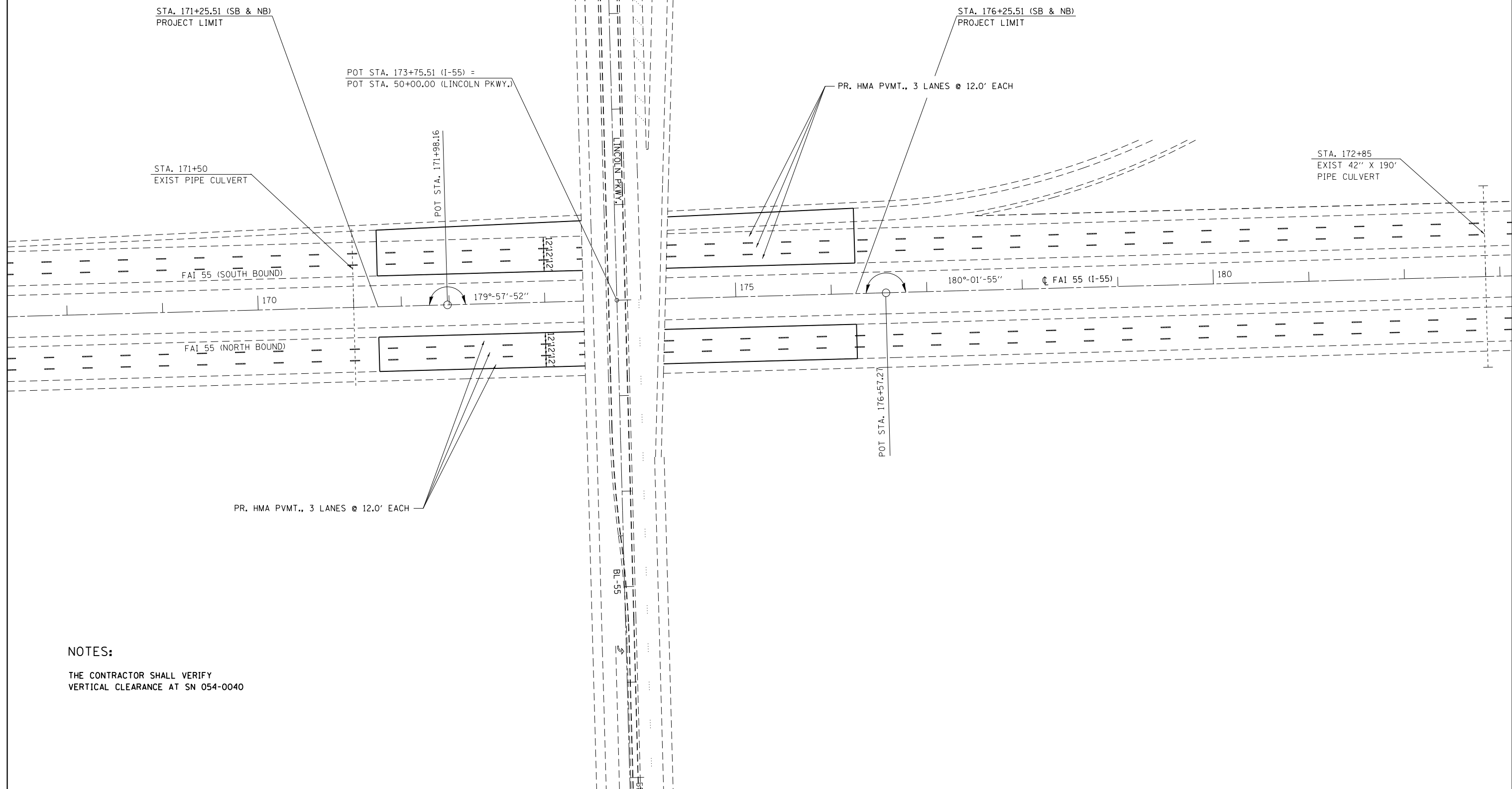
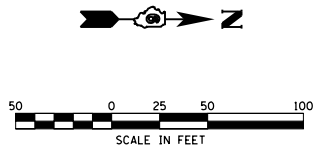

NOTES:
 THE CONTRACTOR SHALL VERIFY
 VERTICAL CLEARANCE AT SN 054-0040

FILE NAME = c:\pwork\pwork\sparksgw\0387600\0672H02-sht-plan.dgn	USER NAME = sparksgw	DESIGNED -	REVISED -
Default	PLOT SCALE = 100.00' / in.	DRAWN -	REVISED -
	PLOT DATE = Apr-17-2014 02:19:25PM	CHECKED -	REVISED -
		DATE -	REVISED -

**STATE OF ILLINOIS
 DEPARTMENT OF TRANSPORTATION**

**PLAN VIEW
 I-55 - LINCOLN EXIT**

SCALE: SHEET OF SHEETS STA. TO STA.

F.A.I. RTE.	SECTION	COUNTY	TOTAL SHEETS	SHEET NO.
55	.	**	10	10
ILLINOIS FED. AID PROJECT			CONTRACT NO. 72H02	