

EXIST. CURVE CURV81  
 PI STA. = 44+70.87  
 $\Delta = 11^\circ 39' 22''$  (RT)  
 $D = 2^\circ 09' 03''$   
 $R = 2,664.01'$   
 $T = 271.92'$   
 $L = 541.96'$   
 $E = 13.84'$   
 $e = \text{-----}$   
 $T.R. = \text{-----}$   
 $S.E. \text{ RUN} = \text{-----}$   
 $P.C. \text{ STA.} = 41+98.95$   
 $P.T. \text{ STA.} = 47+40.91$

- LEGEND**
- CLASS B PATCH, TYPE IV, 10 3/4" WITH HMA OVERLAY
  - VARIABLE DEPTH PATCH, TYPE IV, 10 3/4" TO 12 3/4"
  - CLASS B PATCH, TYPE IV, 10 3/4"
  - PORTLAND CEMENT CONCRETE SHOULDERS 8"
  - PORTLAND CEMENT CONCRETE SHOULDERS 10 3/4"
  - PORTLAND CEMENT CONCRETE SHOULDERS 12"
  - TEMPORARY DITCH CHECKS

EXIST. CURVE CURV82  
 PI STA. = 54+69.86  
 $\Delta = 47^\circ 29' 56''$  (RT)  
 $D = 3^\circ 27' 30''$   
 $R = 1,656.70'$   
 $T = 728.95'$   
 $L = 1,373.43'$   
 $E = 153.28'$   
 $e = \text{-----}$   
 $T.R. = \text{-----}$   
 $S.E. \text{ RUN} = \text{-----}$   
 $P.C. \text{ STA.} = 47+40.91$   
 $P.T. \text{ STA.} = 61+14.34$

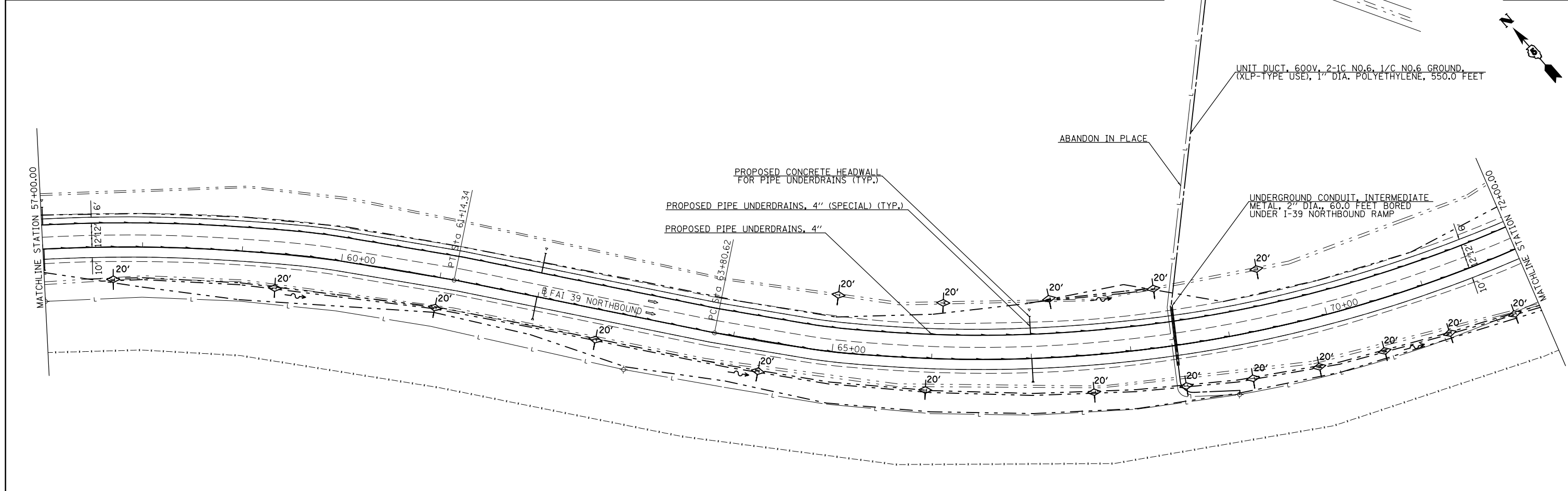

**STATE OF ILLINOIS  
 DEPARTMENT OF TRANSPORTATION**

**NORTH BOUND RAMP  
 PLAN SHEET**

FILE NAME =	USER NAME = bergenej	DESIGNED -	REVISED -
et:\pw\work\p\id\dot\bergenej\0373050\0570A28-sht-dblp\in.dgn		DRAWN -	REVISED -
	PLOT SCALE = 100.0000' / in.	CHECKED -	REVISED -
	PLOT DATE = 3/18/2014	DATE -	REVISED -

SCALE: SHEET 1 OF 3 SHEETS STA. 42+00 TO STA. 72+00

F.A.I. RTE.	SECTION	COUNTY	TOTAL SHEETS	SHEET NO.
39	57(2,3)R	McLean	214	39
CONTRACT NO. 70A28				
ILLINOIS FED. AID PROJECT				