

W12-1103
 MAX WIDTH
 10'-6"
 0.35 MILES
 AHEAD
 TO BE PLACED AT
 IL 43 (HARLEM AVE)

WEST U.S. RTE. 30
 (LINCOLN HIGHWAY)

CENTRAL AVENUE

W2-1 115(O)-3618
 R2-1-3648
 R10-1108p-3618
 R2-1106p-3618
 WORK ZONE
 SPEED LIMIT
 45
 PHOTO ENFORCED
 XXX FINE
 MINIMUM

- SYMBOLS**
- ↑ Arrow board
 - ▨ Work area
 - ⊥ Sign
 - ⊥ Type II barricade, drum, or vertical barricade with steady burn monodirectional light
 - Drums with steady burning monodirectional light
 - ⋯ Pavement marking removal
 - ⇒ Direction of traffic
 - ⊥ Type III barricade with flashing light
 - ⊥ Direction Indicator barricade with steady burn monodirectional light @ 20' C-C

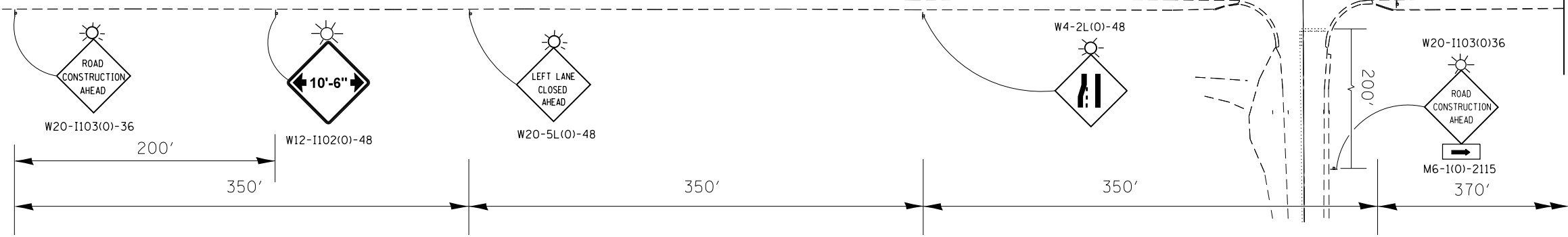

* REMOVE SIGNS WHEN WORKERS OR FLAGGERS ARE NOT PRESENT FOR MORE THAN ONE HOUR.

NOTES

1. EXISTING CONFLICTING PAVEMENT MARKING LINES SHALL BE REMOVED.
2. ALL SIGNS SHALL BE POST MOUNTED.

WET REFLECTIVE TAPE TYPE III, 4" SOLID YELLOW LINE TYP

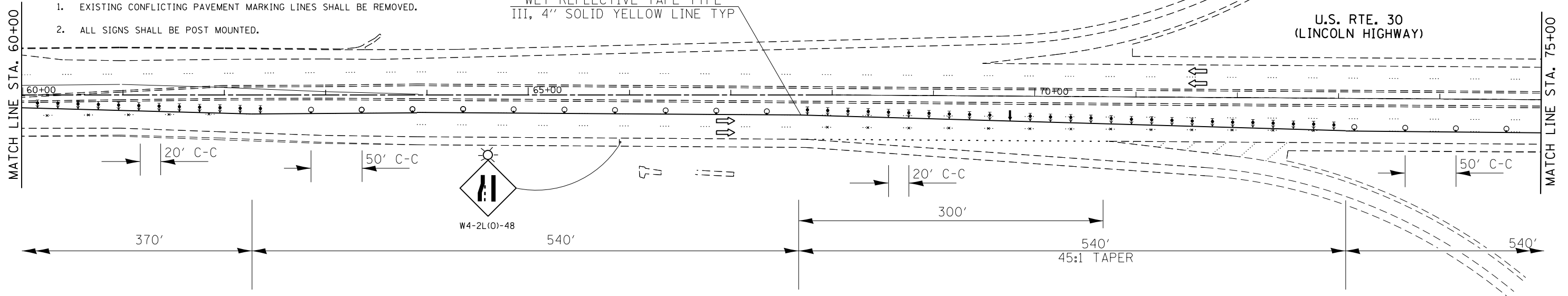

FILE NAME =	USER NAME = hardnettr	DESIGNED -	REVISED -
ei:\pw\work\p\idot\hardnettr\d0374764\04114-sht-plan.dgn	04114-sht-plan.dgn	DRAWN -	REVISED -
Default	PLOT DATE = 4/4/2014	CHECKED -	REVISED -
		DATE -	REVISED -

STATE OF ILLINOIS
 DEPARTMENT OF TRANSPORTATION

US 30 OVER I-57
 TRAFFIC CONTROL PLAN STAGE II
 SCALE: SHEET 1 OF 3 SHEETS STA. TO STA.

F.A.P. RTE.	SECTION	COUNTY	TOTAL SHEETS	SHEET NO.
353	0404-1004HB-BR	COOK	28	20
CONTRACT NO. 60X21				ILLINOIS FED. AID PROJECT