

PR 2-CC RADIUS POINTS  
 R = 35' - 200', Ø = 2'

① STA. 104+74.08, 8.28' LT. (M.P. RD.) (MATCH EXISTING EDGE)  
 ② STA. 105+09.23, 11.67' LT. (M.P. RD.) (MATCH EXISTING EDGE)  
 ③ STA. 0+51.89, 9.42' LT. (E.P. ENT.) (MATCH EXISTING EDGE)

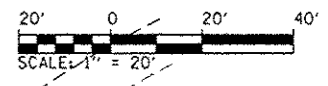

**BILL OF MATERIALS - EAST ENTRANCE**

ITEM	UNIT	TOTAL
EARTH EXCAVATION	CU YD	128
FURNISHED EXCAVATION	CU YD	25
TOPSOIL FURNISH AND PLACE, 4"	SQ YD	72
GRADING AND SHAPING DITCHES	FOOT	186
TEMPORARY DITCH CHECKS	FOOT	16
INLET AND PIPE PROTECTION	EACH	4
AGGREGATE BASE COURSE, TYPE A 6"	SO YD	157
AGGREGATE BASE COURSE, TYPE A 12"	SO YD	59
LEVELING BINDER (MACHINE METHOD), IL-9.5 FG N50	TON	9.8
HOT-MIX ASPHALT SURFACE REMOVAL - BUTT JOINT	SQ YD	477
HOT-MIX ASPHALT BINDER COURSE, IL 19.0 FG, N50	TON	492.7
HOT-MIX ASPHALT SURFACE COURSE, MIX "C", N50	TON	401.9

**BILL OF MATERIALS - EAST ENTRANCE**

ITEM	UNIT	TOTAL
PAVEMENT REMOVAL	SO YD	8
HOT-MIX ASPHALT SURFACE REMOVAL, 1 1/2"	SO YD	1,078
PAVED DITCH REMOVAL	FOOT	134
CLASS D PATCHES, TYPE IV, 6 INCH	SO YD	241
STRIP REFLECTIVE CRACK CONTROL TREATMENT	FOOT	1,200
AGGREGATE SHOULDERS, TYPE B	TON	59.1
AGGREGATE WEDGE SHOULDER, TYPE B	TON	170.2
PAVED DITCH, TYPE B-30	FOOT	129
SIGN PANEL - TYPE I	SO FT	10
WOOD SIGN SUPPORT	FOOT	30
PAINT PAVEMENT MARKING - LINE 4"	FOOT	1,020
PAINT PAVEMENT MARKING - LINE 24"	FOOT	74

**BILL OF MATERIALS - EAST ENTRANCE**

ITEM	UNIT	TOTAL
LIGHT POLE, WOOD, 30 FOOT, CLASS 5	EACH	1
REMOVE EXISTING GATE	EACH	1
TUBULAR STEEL GATE	EACH	1
PIPE CULVERTS TO BE CLEANED 15"	FOOT	161
PIPE CULVERTS TO BE CLEANED 36"	FOOT	92
REMOVE SIGN COMPLETE	EACH	1
LUMINAIRE (SPECIAL)	EACH	3
CONCRETE REMOVAL (SPECIAL)	SO YD	4
FIBER-MODIFIED ASPHALT CRACK SEALING	FOOT	900
BITUMINOUS MATERIALS (PRIME COAT)	POUND	2,983

• QUANTITIES ARE ESTIMATED AND SHALL ONLY BE USED AT THE DISCRETION OF THE ENGINEER

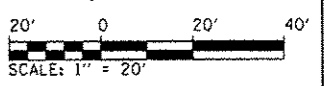
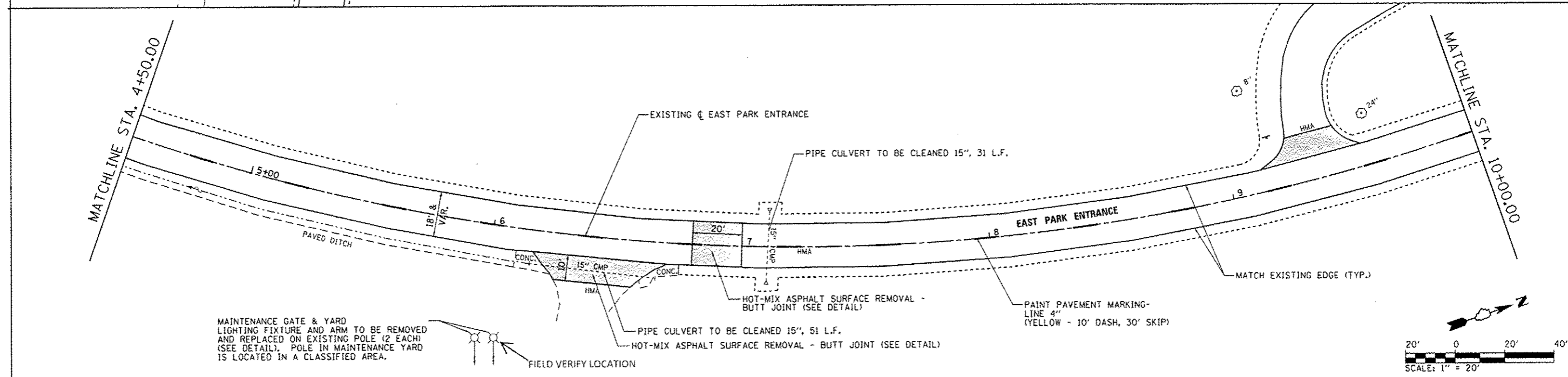

MAINTENANCE GATE & YARD LIGHTING FIXTURE AND ARM TO BE REMOVED AND REPLACED ON EXISTING POLE (2 EACH) (SEE DETAIL). POLE IN MAINTENANCE YARD IS LOCATED IN A CLASSIFIED AREA.

FIELD VERIFY LOCATION