

RESURFACING - TRAFFIC SIGNAL SCHEDULE OF QUANTITIES

The "Pay Items" below are paid separately as per the attached "Specification" for MAGNETIC DETECTOR REMOVAL AND DETECTOR LOOP INSTALLATION.

Code No.	Pay Item	Unit	Quantity
85000200	MAINTENANCE OF EXISTING TRAFFIC SIGNAL INSTALLATION	EACH	
87301305	ELECTRIC CABLE IN CONDUIT, LEAD-IN, NO. 14 1 PAIR	FOOT	
88500100	INDUCTIVE LOOP DETECTOR	EACH	
88600100	DETECTOR LOOP, TYPE 1	FOOT	

NOTE:
THIS PLAN IS FOR THE PURPOSE OF REPLACING THE DETECTOR LOOPS ONLY. ALL OTHER INFORMATION SHOWN IS NOT RELATED AND WILL BE DISREGARDED.

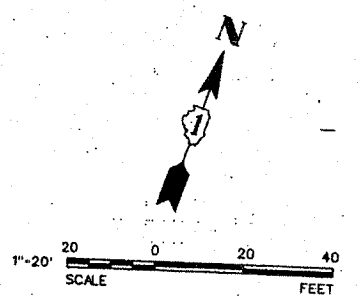
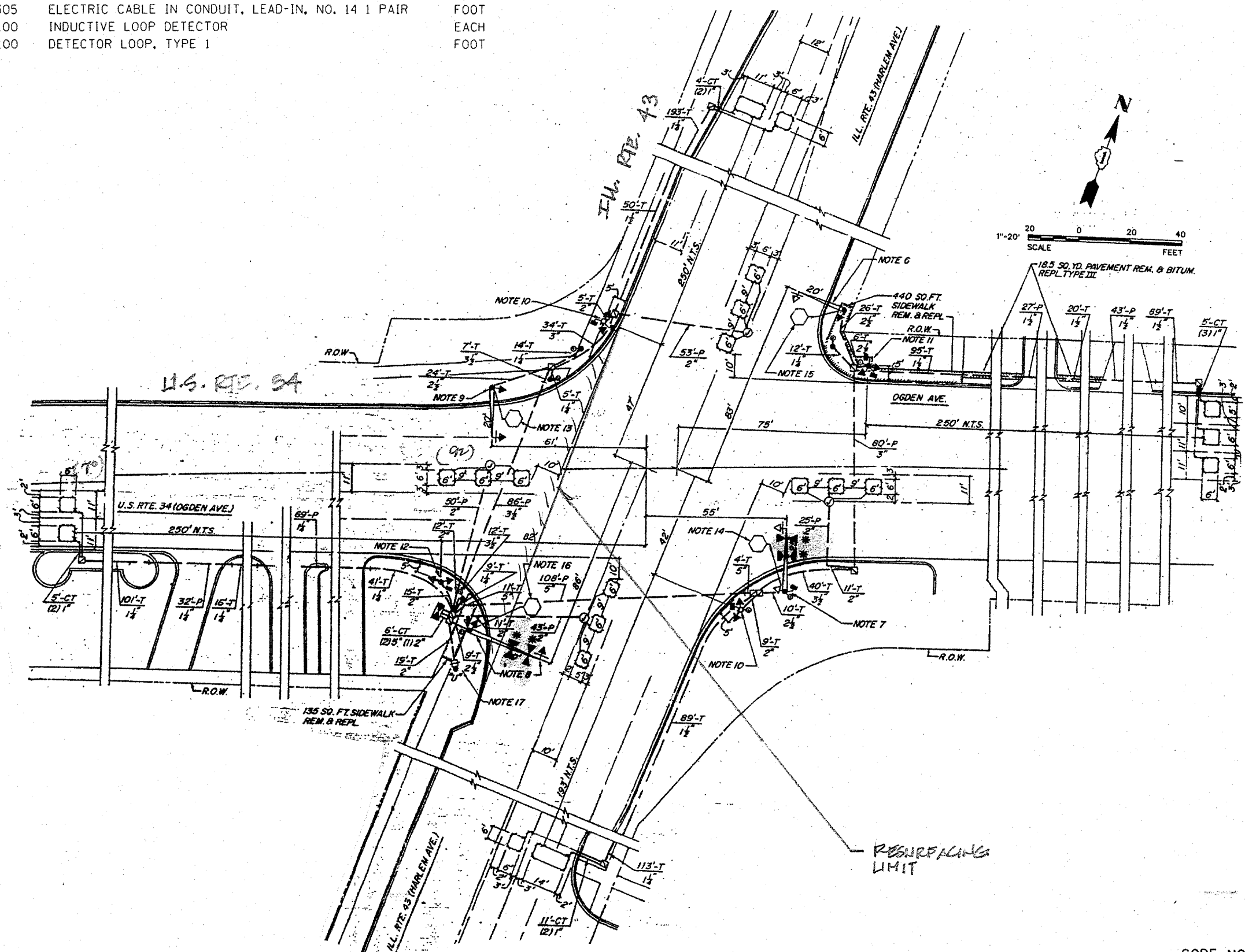

	PROPOSED	EXISTING
CONTROLLER	☒	☒
SERVICE INSTALLATION	■	□
SIGNAL HEAD	▶	◀
SIGNAL HEAD WITH BACKPLATE	▶	◀
SIGNAL HEAD, PEDESTRIAN	■	□
SIGNAL POST	●	○
MAST ARM ASSEMBLY AND POLE, STEEL	●	○
MAST ARM ASSEMBLY AND POLE, ALUMINUM	◐	◑
COMMON TRENCH	CT	
UNIT DUCT	UD	
HANDHOLE	■	□
HEAVY DUTY HANDHOLE	■	□ "E"
DOUBLE HANDHOLE	■	□

REPLACE ALL DETECTOR LOOPS AS SHOWN
(WITHIN THE RESURFACING LIMITS)

CODE NO.	QUANTITY	UNIT	ITEM
86600600	162	FOOT	DETECTOR LOOP REPLACEMENT