

U.S. ROUTE 30

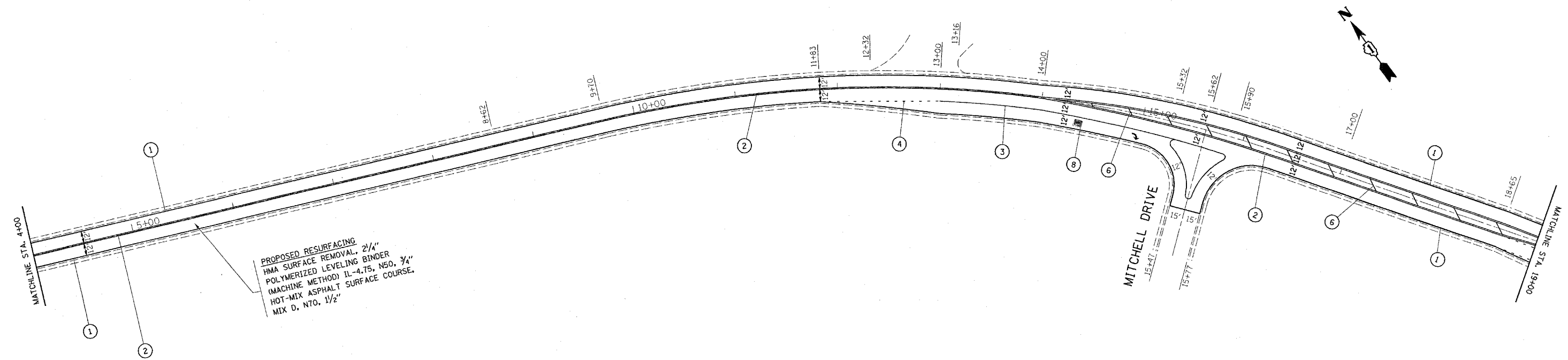

PROPOSED RESURFACING
 HMA SURFACE REMOVAL, 2 1/4"
 POLYMERIZED LEVELING BINDER
 (MACHINE METHOD) IL-4.75, N50, 3/4"
 HOT-MIX ASPHALT SURFACE COURSE,
 MIX D, N70, 1 1/2"

U.S. ROUTE 30

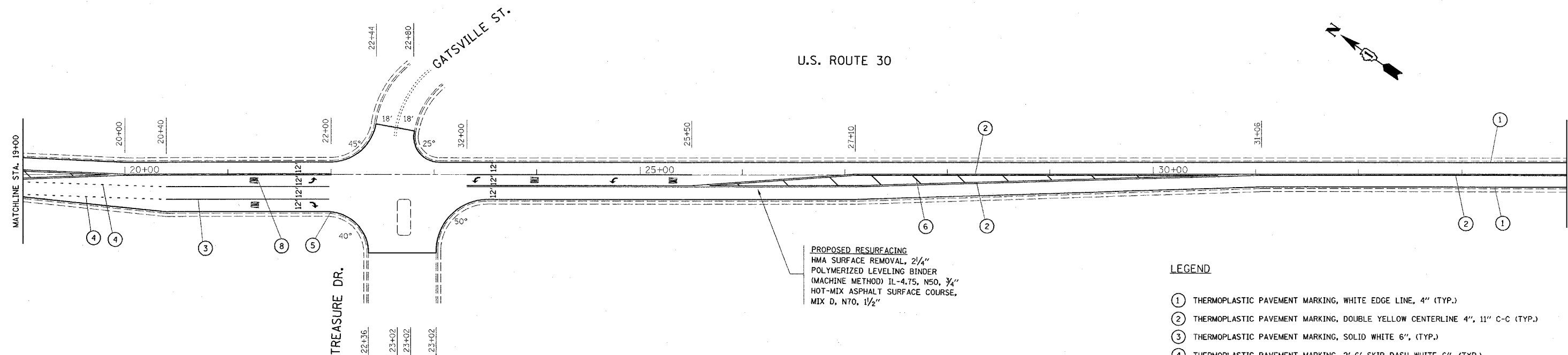

PROPOSED RESURFACING
 HMA SURFACE REMOVAL, 2 1/4"
 POLYMERIZED LEVELING BINDER
 (MACHINE METHOD) IL-4.75, N50, 3/4"
 HOT-MIX ASPHALT SURFACE COURSE,
 MIX D, N70, 1 1/2"

LEGEND

- ① THERMOPLASTIC PAVEMENT MARKING, WHITE EDGE LINE, 4" (TYP.)
- ② THERMOPLASTIC PAVEMENT MARKING, DOUBLE YELLOW CENTERLINE 4", 11" C-C (TYP.)
- ③ THERMOPLASTIC PAVEMENT MARKING, SOLID WHITE 6", (TYP.)
- ④ THERMOPLASTIC PAVEMENT MARKING, 2'-6" SKIP DASH WHITE 6", (TYP.)
- ⑤ THERMOPLASTIC PAVEMENT MARKING, SOLID WHITE STOP BAR 24", (TYP.)
- ⑥ THERMOPLASTIC PAVEMENT MARKING, SOLID YELLOW LINE 12", 15' SPACING OR 5' MINIMUM, (TYP.)
- ⑦ THERMOPLASTIC PAVEMENT MARKING, 10'-30' SKIP DASH YELLOW 4", (TYP.)
- ⑧ THERMOPLASTIC PAVEMENT MARKING, LETTERS & SYMBOLS, (TYP.)
- ⑨ THERMOPLASTIC PAVEMENT MARKING, SOLID YELLOW 4", (TYP.)

FILE NAME =
 c:\projects\dl20205\sh_rdwj.dgn

USER NAME = ulrichkd
 PLOT SCALE = 50.0000' / 1"
 PLOT DATE = 4/4/2008

DESIGNED -
 DRAWN -
 CHECKED -
 DATE -

REVISED -
 REVISED -
 REVISED -
 REVISED -

STATE OF ILLINOIS
 DEPARTMENT OF TRANSPORTATION

U.S. RTE. 30 (U.S. RTE. 34 TO WILL COUNTY LINE)
 ROADWAY AND PAVEMENT MARKING PLAN

SCALE: 1" = 50' SHEET NO. OF SHEETS STA. 4+00.00 TO STA. 34+00.00

F.A.P. RTE.	SECTION	COUNTY	TOTAL SHEETS	SHEET NO.
349	16RS-6	WILL	21	8
FED. ROAD DIST. NO. 1 ILLINOIS FED. AID PROJECT			CONTRACT NO. 60A98	