

- SPALL REPAIR NOTES:**
- A** CONTRACTOR SHALL NOT OVERSAW.
  - B** CONTRACTOR SHALL SAWCUT 2" DEPTH EXCEPT AS NECESSARY TO NOT OVERSAW.
  - C** CONTRACTOR SHALL REMOVE EXISTING PCC DOWN TO UNDISTURBED MATERIAL. VOID SHALL BE FILLED WITH ELASTOMERIC CONCRETE AS SPECIFIED IN ITEM AR501 FOR SPALL REPAIR.

**SPALL REPAIR DETAIL**  
NOT TO SCALE

NOTE: FOR USE WITH SPALL WIDTHS GREATER THAN 0.5".

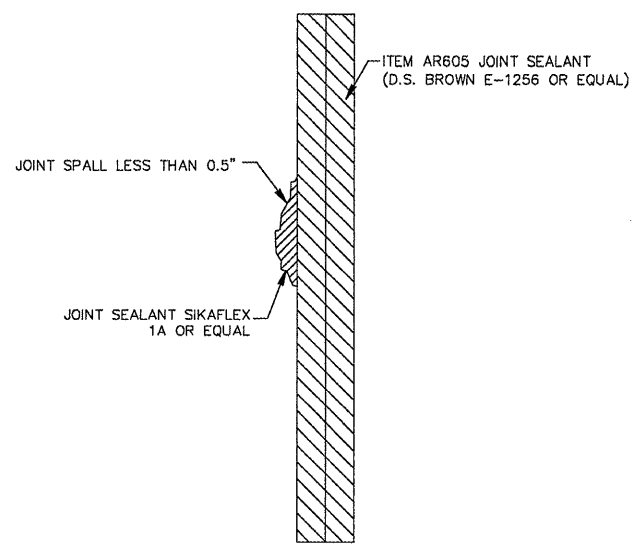

**MINOR SPALL REPAIR DETAIL**  
NOT TO SCALE

NOTE: FOR USE WITH SPALL WIDTHS LESS THAN 0.5".

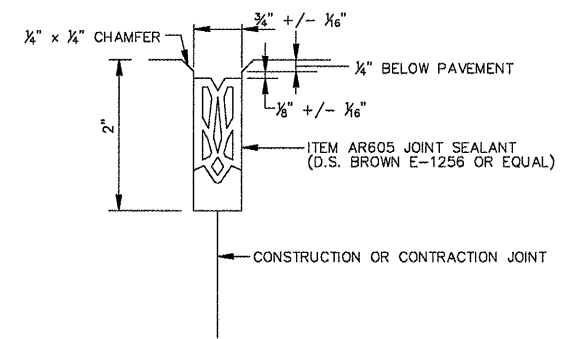

**JOINT SEALANT DETAIL**  
NOT TO SCALE

NOTE: RECORDS INDICATE THAT THE EXISTING JOINT WIDTH IS 0.5" FOR TAXIWAY G AND 0.375" FOR ALL OTHER PAVEMENTS.

REVISIONS		
NUMBER	BY	DATE

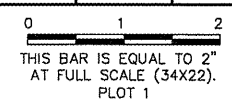

**MIDAMERICA ST. LOUIS AIRPORT  
ST. CLAIR COUNTY, ILLINOIS**

**RUNWAY AND TAXIWAY JOINT REPAIR**

ONE MEMORIAL DRIVE, SUITE 500  
ST. LOUIS, MO 63102  
(314) 438-5500



**CMT**  
CRANFORD, MURPHY & TILLY, INC.  
CONSULTING ENGINEERS  
© Copyright CMT, Inc.  
PROFESSIONAL ENGINEERING - 184-000613

**IL PROJECT: BLV-3886  
AIP PROJ: 3-17-0146-XX**

FILE: 08\_DETAILS.dwg

DESIGN BY: LEW

DRAWN BY: ASA

CHECKED BY: BWG

APPROVED BY: BWG

DATE: APRIL 17, 2009

JOB No: 09098-01

**JOINT REPAIR  
DETAILS**