

NOTE: ELEVATIONS PROVIDED AT LOCATIONS THAT MATCH EXISTING PAVEMENTS OR BUILDING FLOORS ARE FOR REFERENCE ONLY. THE CONTRACTOR SHALL CONSTRUCT THE PROPOSED JOINTS FLUSH WITH EXISTING OR AS DETAILED. CONTRACTOR IS RESPONSIBLE FOR VERIFYING EXISTING ELEVATIONS AT MATCH POINTS.

LEGEND

- EXISTING BUILDINGS
- EXISTING PAVEMENT
- PROPOSED PAVEMENT

*625.61 PROPOSED SPOT ELEVATION

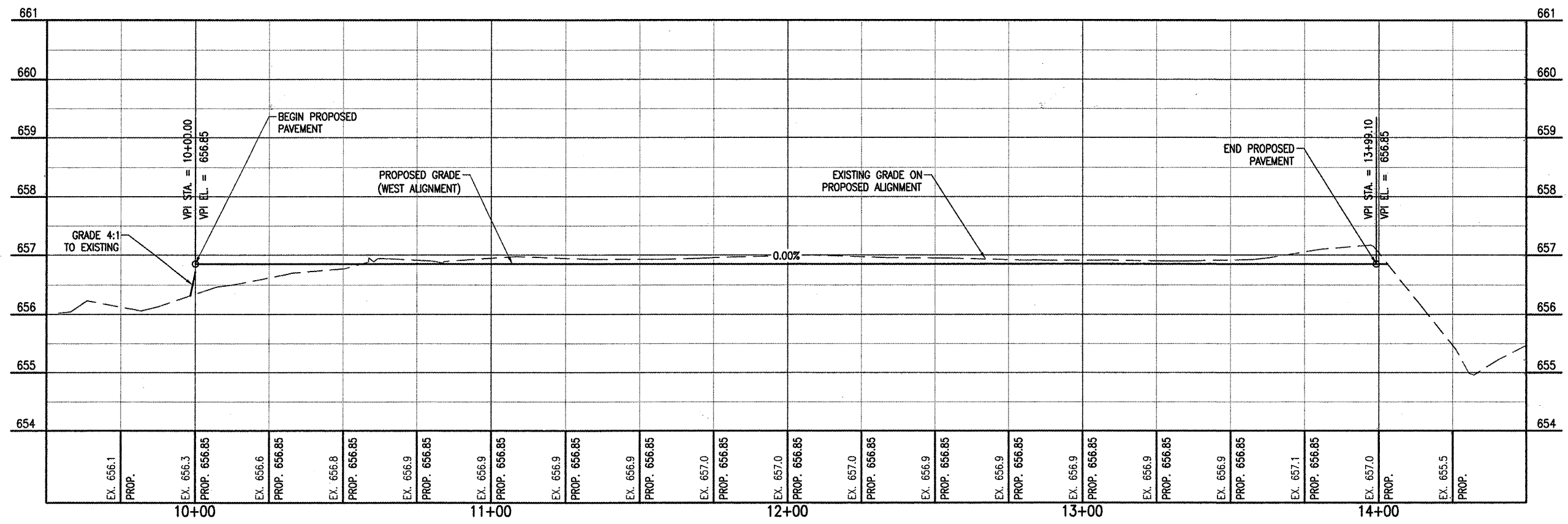
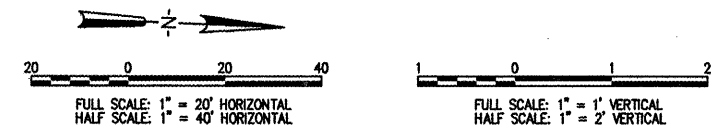

	BY															
	REVISION															
	DATE															
EDGAR COUNTY AIRPORT PARIS, ILLINOIS																
		L. PROJ.: PRG-3889		A.I.P. PROJ.: 3-17-0077-B11												
<p>SET Project No. 0840209_0800 Filename: R-701PWP.DWG Scale: 1"=20'H, 1"=1'V Date: 04/17/09</p> <table border="1" style="width: 100%; border-collapse: collapse;"> <tr> <td>LAYOUT</td> <td>DAK</td> <td>03/05/09</td> </tr> <tr> <td>DRAWN</td> <td>DAK</td> <td>03/06/09</td> </tr> <tr> <td>REVIEWED</td> <td>JDW</td> <td>03/18/09</td> </tr> </table>								LAYOUT	DAK	03/05/09	DRAWN	DAK	03/06/09	REVIEWED	JDW	03/18/09
LAYOUT	DAK	03/05/09														
DRAWN	DAK	03/06/09														
REVIEWED	JDW	03/18/09														
 Copyright Hanson Professional Services Inc. 2009 Hanson Professional Services Inc. 1525 South Sixth Street Springfield, Illinois 62703-2886 www.hanson-inc.com Offices Nationwide																
REMOVE AND RECONSTRUCT T-HANGAR TAXIWAYS																
PROPOSED PLAN AND PROFILE - WEST ALIGNMENT																
9																
9 of 18 sheets																

APR 13, 2009 5:02 PM H4690115
 I:\0840209_0840209_PRC\CADD\AIRPORT_SHEET\PR-701PWP.DWG