

THE LOCATION, SIZE AND TYPE OF MATERIAL OF EXISTING UNDERGROUND UTILITIES INDICATED ON THE PLANS IS NOT REPRESENTED AS BEING ACCURATE, SUFFICIENT OR COMPLETE. IT SHALL BE THE CONTRACTOR'S RESPONSIBILITY TO DETERMINE THE ACTUAL LOCATION OF ALL SUCH FACILITIES, INCLUDING SERVICE CONNECTIONS TO UNDERGROUND UTILITIES. PRIOR TO CONSTRUCTION, THE CONTRACTOR SHALL NOTIFY THE UTILITY COMPANIES OF HIS OPERATIONAL PLANS AND SHALL OBTAIN FROM THE RESPECTIVE UTILITY COMPANIES DETAILED INFORMATION AND ASSISTANCE RELATIVE TO THE LOCATION OF THEIR FACILITIES AND THE WORKING SCHEDULE OF THE COMPANIES FOR REMOVAL OR ADJUSTMENT WHERE REQUIRED. IN THE EVENT AN UNEXPECTED UTILITY INTERFERENCE IS ENCOUNTERED DURING CONSTRUCTION, THE CONTRACTOR SHALL IMMEDIATELY NOTIFY THE UTILITY COMPANY OF JURISDICTION. THE ENGINEER SHALL ALSO BE IMMEDIATELY NOTIFIED. ANY SUCH MAINS AND SERVICES SHALL BE RESTORED TO SERVICE AT ONCE AND PAID FOR BY THE CONTRACTOR AT NO ADDITIONAL COST TO THE CONTRACT.

CALL J.U.L.I.E. AT 1-800-892-0123 FOR UTILITY INFORMATION.

REMOVE BITUMINOUS PAVEMENT (AR401900)

THE CONTRACTOR WILL REMOVE THE EXISTING BITUMINOUS MATERIAL TO THE EXISTING EARTH BASE. ALL REMOVED MATERIAL WILL BE DISPOSED OFF THE AIRPORT SITE.

WHERE THE PROPOSED REMOVAL AREA ABUTS THE EXISTING PAVEMENT, THE PAVEMENT WILL BE SAWED AS SHOWN ON THIS SHEET. THE SAWING WILL BE CONSIDERED AS AN INCIDENTAL ITEM TO THE PROPOSED PAVEMENT REMOVAL AND NO ADDITIONAL COMPENSATION WILL BE ALLOWED.

ANY ADJACENT PAVEMENT DAMAGED BY THE PAVEMENT REMOVAL OPERATIONS WILL BE REPAIRED AT THE CONTRACTOR'S OWN EXPENSE.

THIS ITEM OF WORK SHALL BE PAID FOR UNDER ITEM AR401900 REMOVE BITUMINOUS PAVEMENT, PER SQUARE YARD.

REMOVE CONCRETE PAVEMENT (AR501900)

THE CONTRACTOR SHALL REMOVE THE EXISTING CONCRETE APPROACH APRONS IDENTIFIED ON THIS SHEET IN ACCORDANCE WITH THE DETAILS ON SHEET 8. ALL WORK NECESSARY TO COMPLETE THE REMOVAL, INCLUDING SAWCUTTING AND DISPOSAL OF THE CONCRETE SHALL BE INCLUDED IN THE UNIT PRICE OF THE ITEM.

COORDINATION WITH AIRPORT MANAGEMENT AND TENANTS WILL BE REQUIRED TO PROVIDE THE CONTRACTOR ACCESS INTO THE HANGARS TO COMPLETE THE WORK.

COORDINATION AND PHASING SHALL BE INCIDENTAL TO THE CONTRACT AND NO ADDITIONAL COMPENSATION ALLOWED FOR DELAYS OR INCONVENIENCES CAUSED BY COORDINATION WITH THE AIRPORT.

THIS ITEM OF WORK SHALL BE PAID FOR UNDER ITEM AR501900 REMOVE CONCRETE PAVEMENT, PER SQUARE YARD.

BITUMINOUS PAVEMENT MILLING (ALTERNATE BID B)

THE AREAS SHOWN ON THIS SHEET TO BE MILLED WILL BE CUT OR TRIMMED TO A DEPTH OF 1.5 INCHES FOR THE PURPOSE OF CONSTRUCTING A BITUMINOUS BUTT JOINT FOR THE BITUMINOUS SURFACE COURSE. THE CUTTING OR TRIMMING WILL BE DONE BY ROTO-MILLING. THE TOLERANCE OF THE MILLING WILL BE AS STATED IN THE STANDARD SPECIFICATIONS.



ALL MILLED MATERIAL WILL BE DISPOSED OF OFF THE AIRPORT SITE. ANY ADJACENT PAVEMENT DAMAGED BY THE MILLING OPERATIONS WILL BE REPAIRED AT THE CONTRACTOR'S OWN EXPENSE.

IF A TRUE VERTICAL FACE IS NOT ESTABLISHED ALONG THE BUTT JOINT FROM THE MILLING OPERATIONS, THE CONTRACTOR IS REQUIRED TO SAWCUT THE JOINT. THE SAWING, IF NECESSARY, SHALL BE CONSIDERED INCIDENTAL TO THE BUTT JOINT CONSTRUCTION AND NO ADDITIONAL COMPENSATION ALLOWED.

ALL BITUMINOUS PAVEMENT MILLING AREAS WILL BE LOCATED AND MARKED BY THE CONTRACTOR AND APPROVED BY THE RESIDENT ENGINEER.

THE PAVEMENT MILLING WILL BE PAID FOR UNDER ITEM AR401655 BUTT JOINT CONSTRUCTION, PER SQUARE YARD.

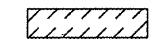
LEGEND

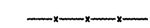
-  EXISTING PAVEMENT
-  PAVEMENT REMOVAL
-  EXISTING BUILDINGS
-  EXISTING FENCE

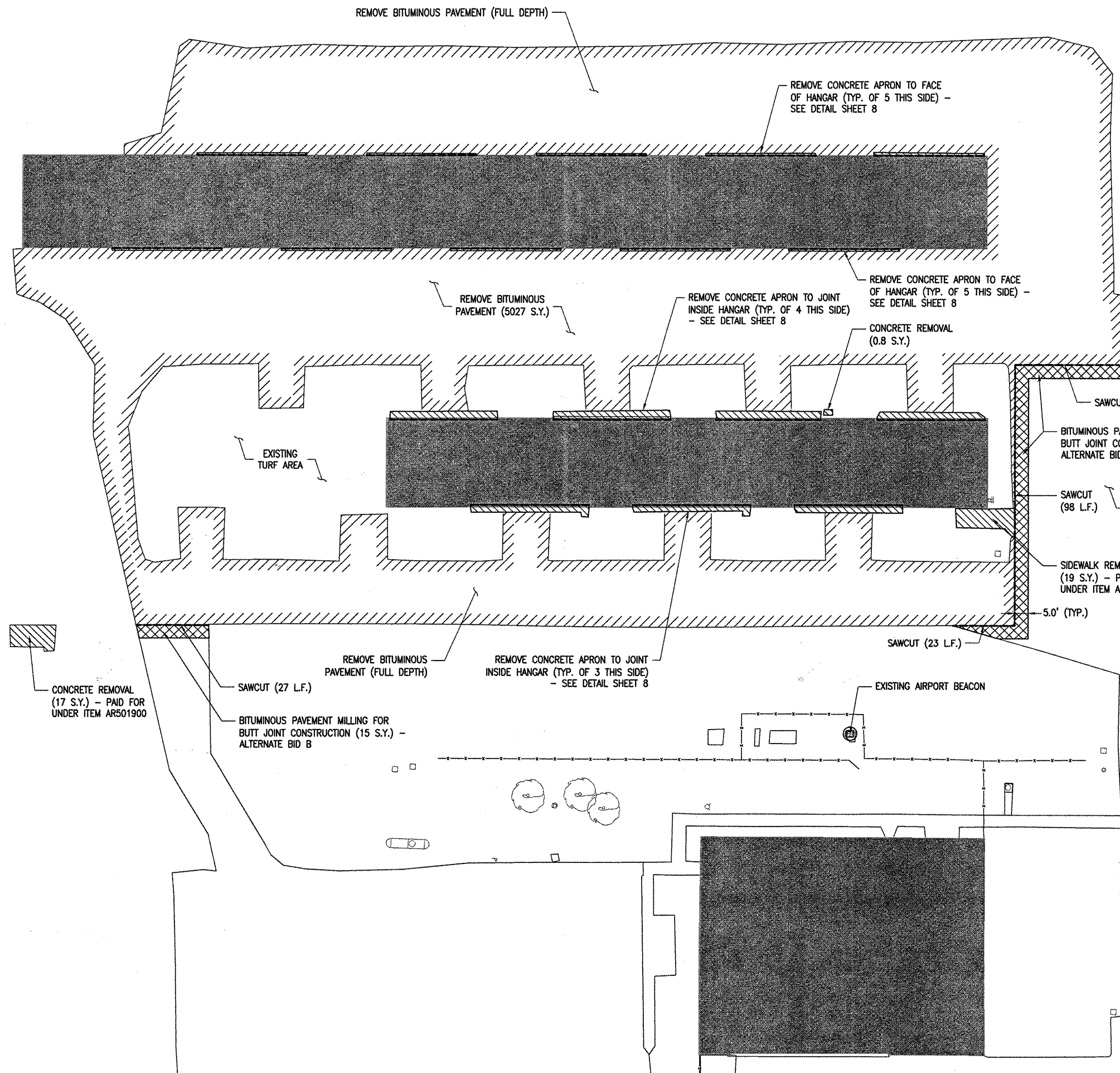
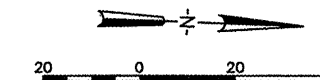

BY	
REVISION	
DATE	
EDGAR COUNTY AIRPORT PARIS, ILLINOIS	
A.I.P. PROJ.: 3-17-0077-B11	
IL PROJ.: PRG-3889	
HEI Project No. 0840209 0800	03/05/09
Revision R-111PRP.DWG	03/05/09
Scale: 1"=20'	03/05/09
Date: 04/17/09	03/18/09
LAYOUT	MLH
DRAWN	MLH
REVIEWED	JOW
HANSON Copyright Hanson Professional Services Inc. 2009 Hanson Professional Services Inc. 1525 South Sixth Street Springfield, Illinois 62703-2888 www.hanson-inc.com Offices Nationwide	
REMOVE AND RECONSTRUCT T-HANGAR TAXIWAYS	
PROPOSED PAVEMENT PREPARATION PLAN	
5	
5 of 18 sheets	