

F.A.S. RTE.	SECTION	COUNTY	TOTAL SHEETS	SHEET NO.
642	99-00124-03-PV	COLES	97	45
STA. 81+54.32		TO STA. 98+94.04		
FED. ROAD DIST. NO.		ILLINOIS FED. AID PROJECT		

5513044
BOATMEN'S NATIONAL BANK
OF CHARLESTON, TRUSTEE

5513046
KATHLEEN CHAMBERS

5513031
DEAN DOTY and CAROL DOTY

5513029
DEAN ANDREW DOTY

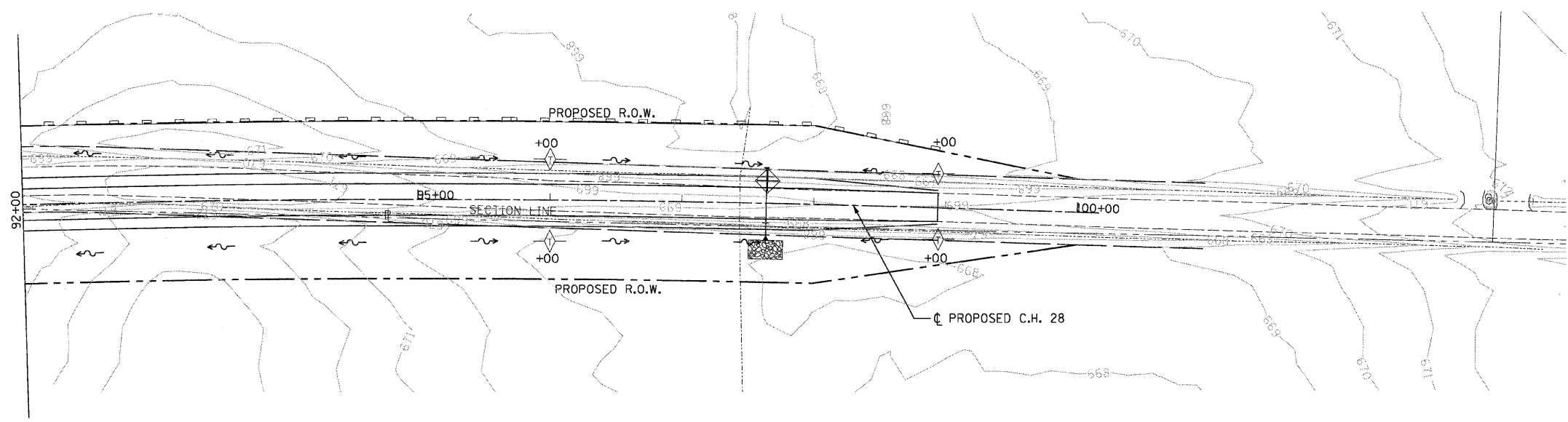
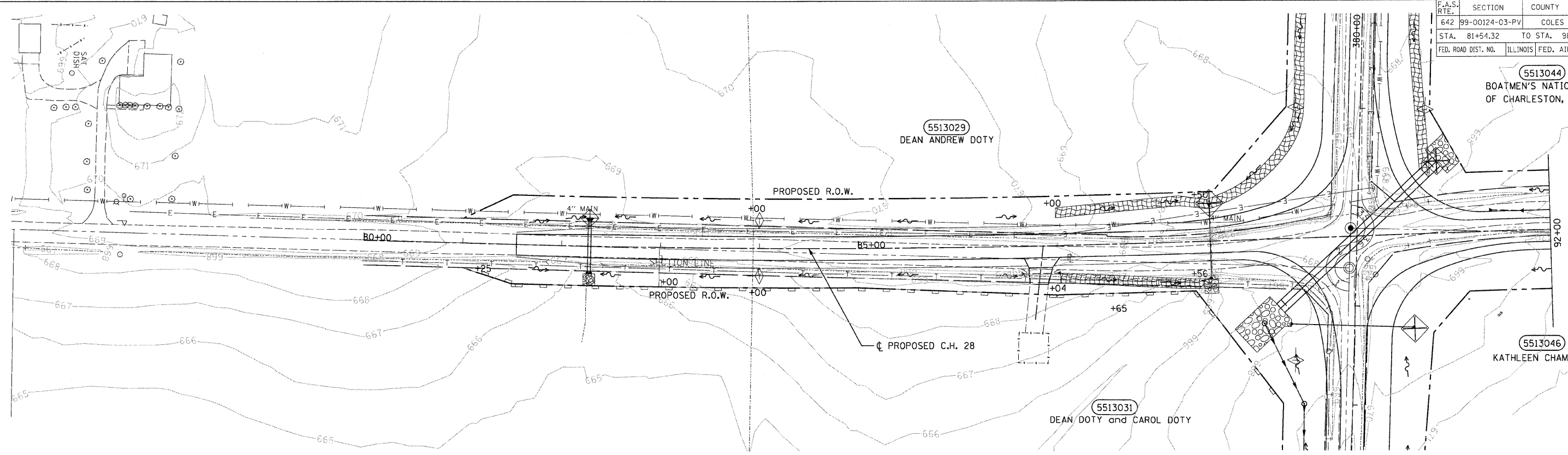

INTENDED SEQUENCE

1. PLACE PERIMETER EROSION CONTROL BARRIER PRIOR TO COMMENCEMENT OF ANY WORK. SEE STD. 280001.
2. CONSTRUCT EARTHWORK, INCLUDING DITCHES. (MAXIMUM 10 ACRES DISTURBED AT ONE TIME PRIOR TO SEEDING. SEE ART. 280).
3. PLACE AND MAINTAIN TEMPORARY AND PERMANENT EROSION CONTROLS AS WORK PROGRESSES, SEED EVERY 7 DAYS. SEE ART. 280.
4. FINAL SHAPE, GRADE, AND PAVE ROADWAY.
5. PLACE REMAINING PERMANENT EROSION CONTROLS.

LEGEND

- EROSION CONTROL BLANKET
- PERIMETER EROSION BARRIER
- DITCH CHECK TEMPORARY
- INLET AND PIPE PROTECTION
- DITCH FLOW
- DITCH FLOW SUMMIT

EA. L.F. SQ.YD.

0	0'	336
0	616'	0
6	0'	0
3	0'	0

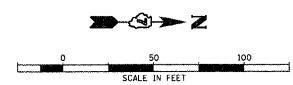

REVISIONS	
NAME	DATE

ILLINOIS DEPARTMENT OF TRANSPORTATION
EROSION CONTROL PLAN
C.H. 28
FAS 642
SEC NO. 99-00124-03-PV
COLES COUNTY, ILLINOIS

SCALE: HORIZ. 1"=50'
DATE 03/30/2009
DRAWN BY JAP
CHECKED BY SKM



03/30/2009
 BJB 03/19/03
 DRAWN BJP/JAP 03/31/03
 REVIEWED SSM 04/01/03
 I:\97\jobs\97s20280\Civil\Sheet\C-0128E.R06.dgn