

LEGEND

- ① PAINT PAVEMENT MARKING LINE - 4", SOLID YELLOW
- ② PAINT PAVEMENT MARKING LINE - 4", SOLID YELLOW DIAGONAL LINES @ 45° @ 4' CENTERS
- ③ PAINT STOP BAR PAVEMENT MARKING LINE - 12", SOLID WHITE
- ④ PAINT PAVEMENT MARKING - LETTERS AND SYMBOLS - SMALL SIZE, YELLOW
- ⑤ PAINT PAVEMENT MARKING - LETTERS AND SYMBOLS - SMALL SIZE, WHITE
- ⑥ PAINT PAVEMENT MARKING LINE - 6", SOLID WHITE
- ⑦ THERMOPLASTIC PAVEMENT MARKING - LETTERS AND SYMBOLS - LARGE SIZE, WHITE
- ⑧ THERMOPLASTIC PAVEMENT MARKING LINE - 4", SOLID YELLOW
- ⑨ THERMOPLASTIC PAVEMENT MARKING LINE - 6", SOLID WHITE
- ⑩ THERMOPLASTIC PAVEMENT MARKING LINE - 8", SOLID WHITE
- ⑪ THERMOPLASTIC PAVEMENT MARKING LINE - 12", SOLID YELLOW
- ⑫ THERMOPLASTIC PAVEMENT MARKING LINE - 24", SOLID WHITE

NOTE: 1. ALL SIGNS AND LOCATIONS SHALL BE IN ACCORDANCE WITH PART 9 OF THE 2003 EDITION OF THE MANUAL ON UNIFORM TRAFFIC CONTROL DEVICES FOR STREETS AND HIGHWAYS AS PERIODICALLY UPDATED. WHERE SIGNS ARE ALONG THE PATH, LATERAL SIGN CLEARANCE SHALL BE A MINIMUM OF 3 FEET AND A MAXIMUM OF 6 FEET FROM THE NEAR EDGE OF THE SIGN TO THE EDGE OF PATH. MOUNTING HEIGHT FOR GROUND-MOUNTED SIGNS ALONG THE PATH SHALL BE A MINIMUM OF 4 FEET AND A MAXIMUM OF 5 FEET, MEASURED FROM THE BOTTOM EDGE OF THE SIGN TO THE NEAR EDGE OF THE PATH SURFACE. ALL WOOD SIGN POSTS SHALL BE INSTALLED PER IDOT STANDARDS AND SPECIFICATIONS.

2. ALL SIGNS SHALL BE "HIGH INTENSITY" GRADE ILLUMINATION.

3. CONTRACTOR SHALL REMOVE EXISTING PAVEMENT MARKINGS THAT CONFLICT WITH REVISED TRAFFIC PATTERNS ACCORDING TO SECTION 783 OF THE STANDARD SPECIFICATIONS.

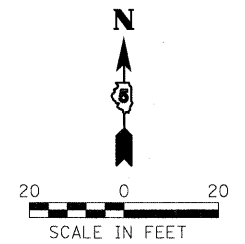
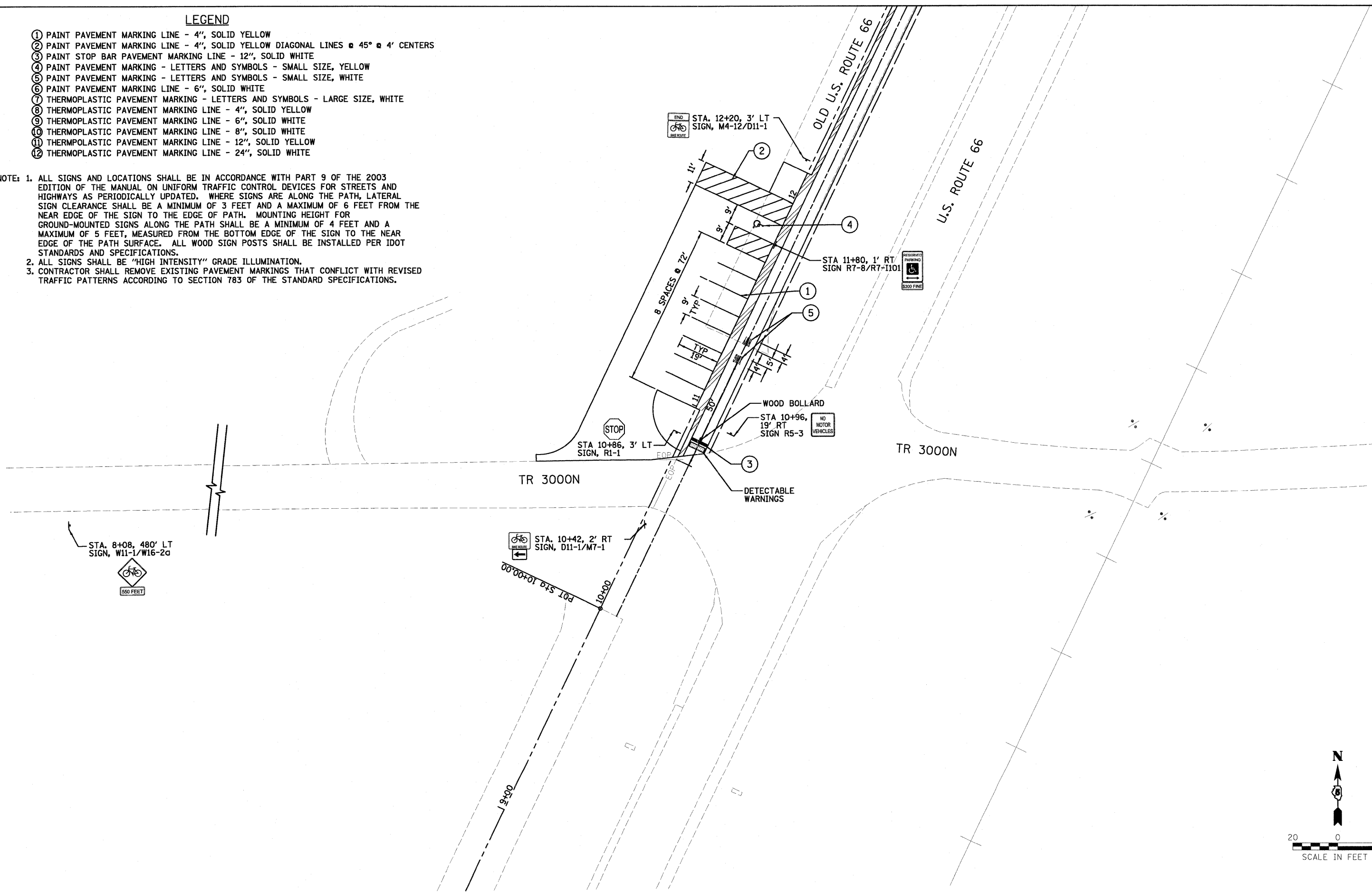

FILE NAME =	USER NAME = #USER#	DESIGNED - DWR	REVISED -	STATE OF ILLINOIS DEPARTMENT OF TRANSPORTATION	PAVEMENT MARKING AND SIGNING AT 3000N	F.A. RTE.	SECTION	COUNTY	TOTAL SHEETS	SHEET NO.
#FILE#		DRAWN - AJD/JTC	REVISED -			06-00025-01-BT	MCLEAN	36	20	
PLOT SCALE = #SCALE#		CHECKED - ERB	REVISED -			CONTRACT NO. 91410				
PLOT DATE = #DATE#		DATE - 03/27/09	REVISED -			FED. ROAD DIST. NO. ILLINOIS FED. AID PROJECT				

D:\City of Chicago\081275 Chicago Bike South.dwg