

F.A. RTE.	SECTION	COUNTY	TOTAL SHEETS	SHEET NO.
	06-00025-00-BT	McLEAN	36	1
FED. ROAD DIST. NO.	ILLINOIS	CONTRACT NO. 91410		

CITY OF CHENOA, ILLINOIS

CHENOA ROUTE 66

PRAIRIE TRAIL SOUTH

**FROM TR 3000N TO
COMMERCIAL ENTRANCE (69 + 95.56)**

FUNDING TYPE: SEC, MFT, ARRA, LOCAL

JOB C-95-326-09

SECTION 06-00025-01-BT

PROJECT NO. ARA-HD-0113 (029)

McLEAN COUNTY

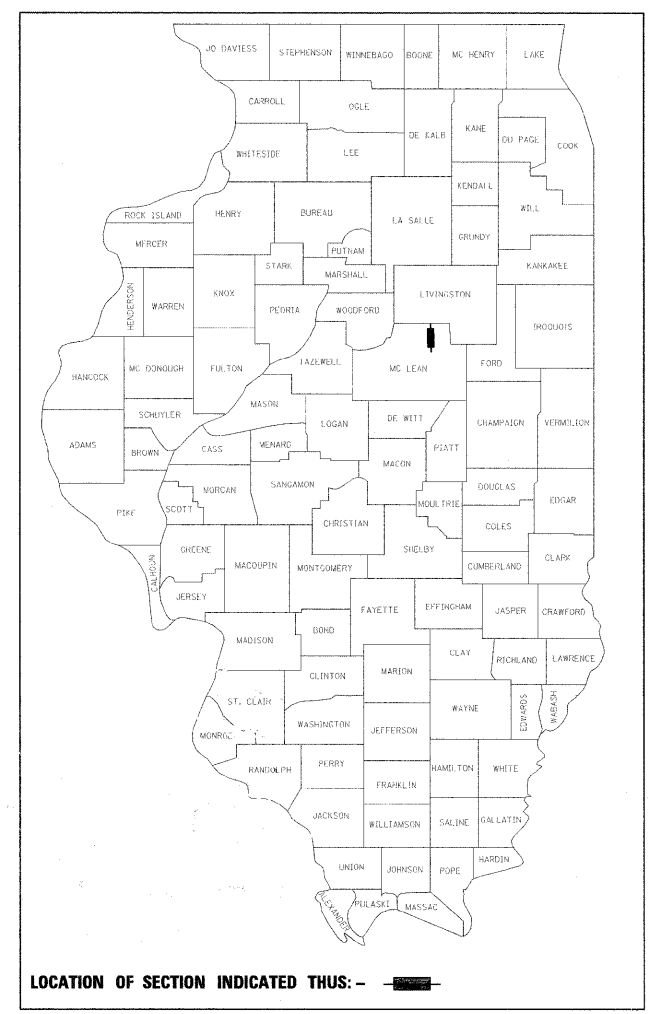

SHEET NO.	INDEX TO SHEETS
1	COVER SHEET
2	SUMMARY OF QUANTITIES, LEGEND AND GENERAL NOTES
3	TYPICAL CROSS SECTIONS
4	SCHEDULE OF QUANTITIES
5-15	BIKE TRAIL PLAN AND PROFILE
16	CONTROL AND SURVEY TIES
17	INTERSECTION DETAILS
18	DISTRICT 5 DETAIL: CONCRETE MEDIAN, TYPE SM-6 (SM-15) (DOWELLED)
19	MISCELLANEOUS DETAILS
20-23	PAVEMENT MARKING AND SIGNING DETAILS
24-29	EROSION CONTROL PLAN
30-36	BIKE TRAIL CROSS SECTIONS

STATE STANDARD DETAILS

000001-05	STANDARD SYMBOLS, ABBREVIATIONS AND PATTERNS
280001-04	TEMPORARY EROSION CONTROL SYSTEMS
420001-07	PAVEMENT JOINTS
420701-02	PAVEMENT FABRIC
424001-05	CURB RAMP FOR SIDEWALKS
606001-04	CONCRETE CURB TYPE B AND COMBINATION CONCRETE CURB AND GUTTER
606301-04	PC CONCRETE ISLANDS AND MEDIANS
701001-02	OFF-RD OPERATIONS, 2L, 2W, MORE THAN 15' (4.5 m) AWAY
701006-03	OFF-RD OPERATIONS, 2L, 2W, 15' (4.5 m) TO 24" (600 mm) FROM PAVEMENT EDGE
701011-02	OFF-RD MOVING OPERATIONS, 2L, 2W, DAY ONLY
701201-03	LANE CLOSURE, 2L, 2W DAY ONLY FOR SPEEDS ≥ 45MPH
701301-03	LANE CLOSURE, 2L, 2W, SHORT TIME OPERATIONS
701311-03	LANE CLOSURE 2L, 2W MOVING OPERATIONS-DAY ONLY
701901-01	TRAFFIC CONTROL DEVICES
720001-01	SIGN PANEL MOUNTING DETAILS
720006-02	SIGN PANEL ERECTION DETAILS
780001-02	TYPICAL PAVEMENT MARKINGS

BENCHMARKS:

- A. SAN MH RIM - 615' NORTH HWY 24, 139' WEST US HWY 66 (ELEV=708.68)
- B. SAN MH RIM - 830' NORTH HWY 24, 260' WEST US HWY 66 (ELEV=710.16)
- C. SAN MH RIM - 615' NORTH HWY 24, 95' WEST US HWY 66 (ELEV=707.50)
- D. SAN MH RIM - 808' NORTH HWY 24, 153' WEST US HWY 66 (ELEV=708.95)

STRUCTURAL DESIGN DATA:

BIKE TRAIL
DESIGN SPEED: 20 MPH
DESIGN YEAR: 2029
ADT (2009) = 0, (2029) = 90
PAVEMENT STRUCTURAL MATERIALS: SEE PROPOSED TYPICAL SECTIONS

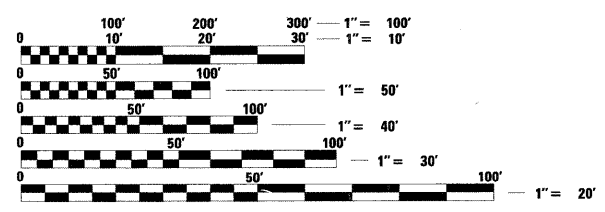

FULL SIZE PLANS HAVE BEEN PREPARED USING STANDARD ENGINEERING SCALES. REDUCED SIZED PLANS WILL NOT CONFORM TO STANDARD SCALES. IN MAKING MEASUREMENTS ON REDUCED PLANS, THE ABOVE SCALES MAY BE USED.

J.U.L.I.E.
JOINT UTILITY LOCATION INFORMATION FOR EXCAVATION
1-800-892-0123
OR 811

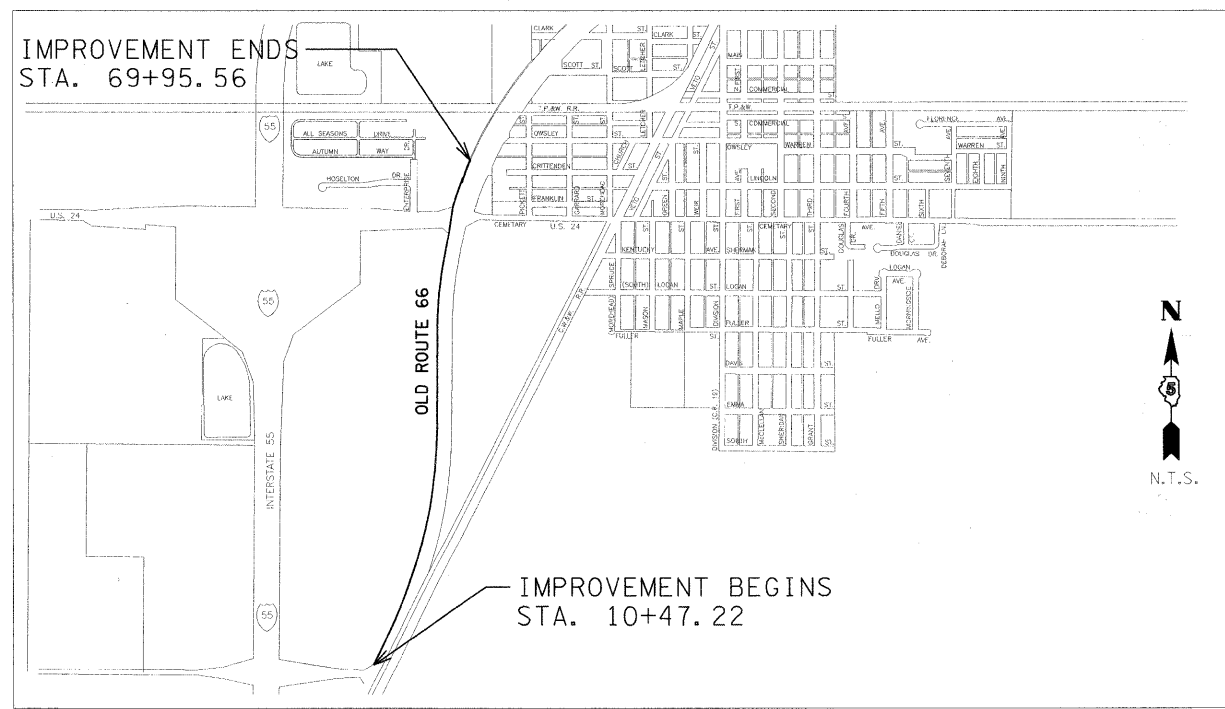

LOCATION MAP - CITY OF CHENOA
TOTAL LENGTH OF PROJECT = 5,948.34 FEET = 1.13 MILES
NET LENGTH OF PROJECT = 5,948.34 FEET = 1.13 MILES

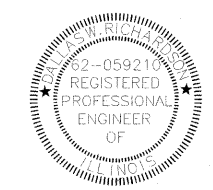

Dallas W. Protem
DATE: 3-27-09
EXPIRATION 11/30/2009

STATE OF ILLINOIS
DEPARTMENT OF TRANSPORTATION
DIVISION OF HIGHWAYS

APPROVED March 30 2009
R. J. Protem Mayor Pro Tem
LOCAL AGENCY REPRESENTATIVE

PASSED 3/31 2009
D. A. S.
DISTRICT 5 ENGINEER OF LOCAL ROADS AND STREETS

RELEASING FOR BID 3-31 2009
D. A. S.
DEPUTY DIRECTOR OF HIGHWAYS
REGION THREE ENGINEER

LIMITED REVIEW

**PRINTED BY THE AUTHORITY
OF THE STATE OF ILLINOIS**