

INDEX OF SHEETS

| DESCRIPTION | SHEET NO |
|---|----------|
| Title Sheet | 1 |
| General Note, Summary of Quantities, Typicals | 2 |
| 10th Av - Atwood & Cooper Parks to 15th St. | 3 |
| 10th Av - 15th St. to Woolf Ct. | 4 |
| 10th Av - Woolf Ct. to 11th St | 5 |
| 10th Av - 11th St to 9th St | 6 |
| 9th St - Sta 500+00 to 503+50 | 7 |
| 9th St - Sta 503+50 to 507+50 | 8 |
| City of Rochelle Details | 9 |
| Driveway Cross Sections | 10 |
| Driveway Cross Sections | 11 |

STANDARDS

| NUMBER | TITLE |
|-----------|---|
| 280001-04 | Tempory Erosion Control Systems |
| 606001-04 | Concrete Curb Type B and Combination Concrete Curb and Gutter |
| 701006-03 | Off-Rd Operations, 2L, 2W. 15' (4.5m) to 24" (600mm) From Pavement Edge |
| 701011-02 | Off-Rd Moving Operations 2L, 2W, Day Only |
| 701301-03 | Lane Closure, 2L, 2W Short Time Operations |
| 701501-05 | Urban Lane Closure 2L, 2W, Undivided |
| 701801-04 | Lane Closure Multilane 1W or 2W Crosswalk or Sidewalk Closure |
| 701901-01 | Traffic Control Devices |
| 720011-01 | Metal Post for Signs, Markers & Delineators |
| 728001-01 | Telescoping Steel Sign Support |
| 729001-01 | Applications of Types A & B Metal Post (For Signs & Markers) |

STATE OF ILLINOIS
DEPARTMENT OF TRANSPORTATION
DIVISION OF HIGHWAYS
PLANS FOR PROPOSED
SAFE ROUTES TO SCHOOL PROJECT
FEDERAL AND LOCAL FUNDING
10TH AVENUE SIDEWALK IMPROVEMENTS
9TH STREET TO COOPER & ATWOOD PARKS
SECTION: 08-00104-00-SW
PROJECT: SRTS-4008 (037)
JOB NO: C-40-019-08
CITY OF ROCHELLE
OGLE COUNTY
CONTRACT NO: 85458

| Route No. | Section | County | Total Sheets | Sheet No. |
|-----------------------------------|----------------|--------|--------------|-----------|
| 10th Av. | 08-00104-00-SW | OGLE | 11 | 1 |
| Illinois Project: SRTS-4008 (037) | | | | |
| Contract No. 85458 | | | | |

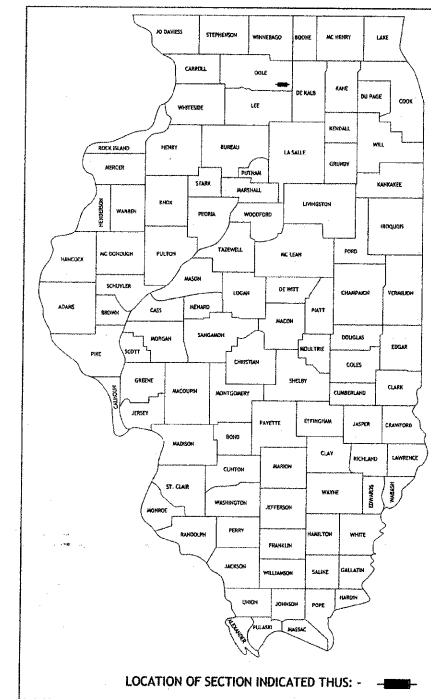

PRINTED BY AUTHORITY OF THE STATE OF ILLINOIS

I, SAMUEL C. TESREAU, A FULLY REGISTERED PROFESSIONAL ENGINEER UNDER THE LAWS OF THE STATE OF ILLINOIS, HEREBY CERTIFY THAT THIS PLAN, SPECIFICATION, OR REPORT WAS PREPARED BY MYSELF OR UNDER MY DIRECT SUPERVISION

Signed: *Samuel C. Tesreau*
 SAMUEL C. TESREAU, P.E.
 CITY ENGINEER
 LICENSE EXPIRES 11/30/2009



Date: 3/31/2009

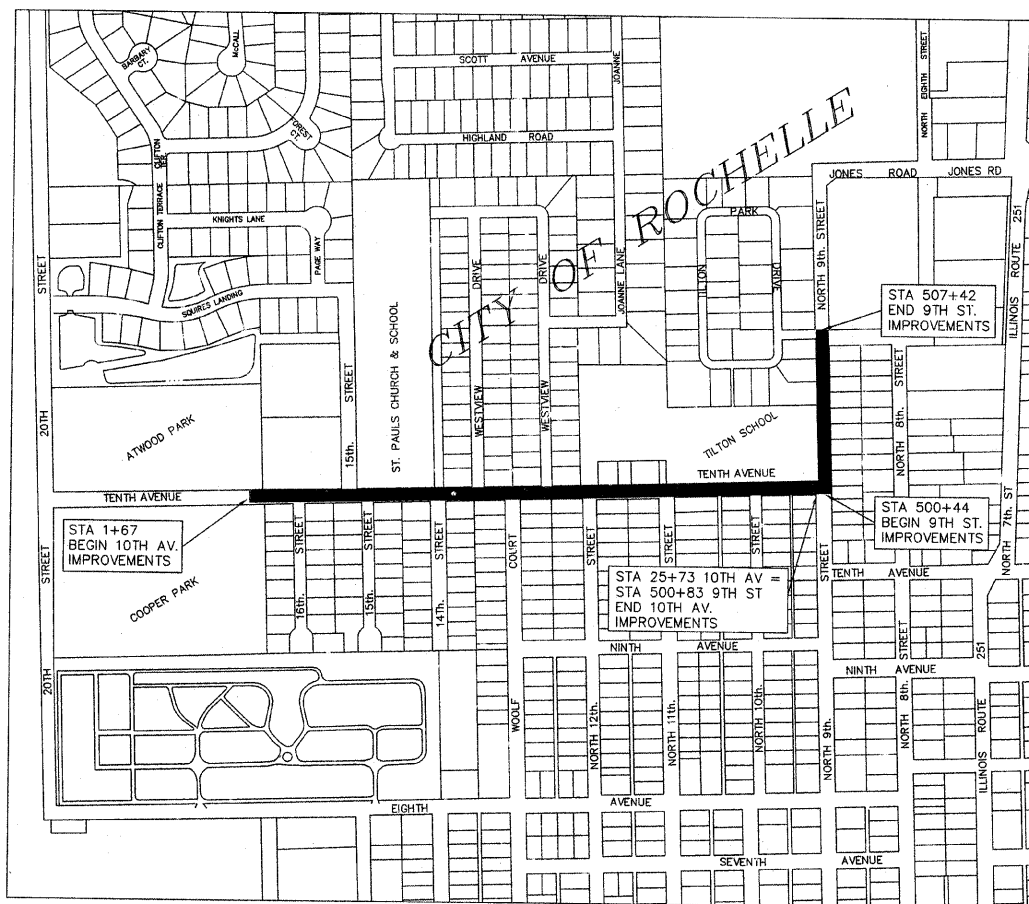

Location Map
Not to Scale

Gross Length of Improvements = 3,104
Net Length of Improvements = 3,104'

Federal and Local Funds

| AGENCY RESPONSIBLE FOR LETTING | |
|--|---|
| Approved | <u>3-31</u> 2009 <i>Ken Albrite</i> City Manager, City of Rochelle |
| Passed | <u>April 24</u> 2009 <i>George F. Brown</i> District 2 Engineer of Local Roads |
| Released for Bid Based on Limited Review | <u>April 24</u> 2009 <i>George F. Brown</i> Deputy Director of Highways/Region 2 Engineer |

CALL BEFORE YOU DIG
 CALL 811 or 1-800-892-0123
 48 hours/2 working days prior to digging.

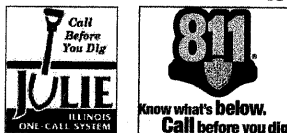

City of Rochelle
Engineering Division
 417 N. 6th St. Rochelle, IL 61068

GENERAL NOTES:

Specifications for this project shall be IDOT "Standard Specifications for Road and Bridge Construction", latest edition, IDOT "Recurring Special Provisions", latest edition, and City of Rochelle Special Provisions unless otherwise approved by the Engineer. All reference to "Engineer" shall mean the City Engineer or his authorized representative.

Any construction or work indicated in the plans or specified in the proposal shall be completed by the Contractor. Any construction or work not included in a pay item shall be incidental to the project contract cost. quantities shown are estimates and for information only. The contractor shall verify all quantities.

Contractor shall be required to file a Notice of Intent with the I.E.P.A. for N.P.D.E.S. storm water regulations as well as the S.W.P.P.P. Notice of Termination shall be filed once the project has been accepted by the City Engineer. Cost and fees associated with this item shall be considered incidental to the contract.

Call J.U.L.I.E. (1-800-892-0123) for utility location information prior to excavation. The location for existing utilities as shown on the plans are based on best information available, but not guaranteed. It shall be the Contractor's responsibility to ascertain their exact location from the utility companies and by field inspection. The contractor shall verify all underground utility locations in the field. The Contractor shall be responsible for "potholing" or locating utilities both vertical and horizontal, within the project limits or along any sewer trench, before installation of any proposed improvements to determine if conflicts exist with said improvements. The contractor shall be responsible for contacting the utility company for any adjustments. This item shall be considered incidental to the contract.

Protect all overhead and underground utility lines during construction. All Electric, Water, Sanitary Sewer, and Storm Sewer adjustments and/or relocations will be performed by the City of Rochelle unless otherwise directed by the Engineer.

Right-of-way line and property lines indicated on the plans are approximate. The contractor shall carefully preserve all existing property markers until an authorized surveyor has referenced their location. Property markers damaged by the contractor shall be replaced at the expense of the contractor. All property corner monumentation shall be restored to the condition existing before construction began.

Top of curb elevations indicated on the plans are to the top back of curb.

EARTHWORK, TRENCHBACKFILL, SUBGRADE AND PAVEMENT PREPARATION NOTES:

All excess earth excavation or unsuitable material shall be disposed of by the contractor off-site. This item shall be considered incidental to applicable pay items.

The upper 12 inches of subgrade below pavements, or new fills shall be brought to within $\pm 2\%$ of optimum moisture and compacted to not less than 90% of maximum density. Optimum moisture is estimated to be in the range of 8% to 9% during cool or wet seasons, therefore it may be necessary to disk and aerate the existing upper 12 inches of soil to achieve optimum moisture content.

No fill or backfill material shall be placed over frozen, muddy, or otherwise unstable material.

All fill or backfill shall be placed beneath exterior paved areas shall be compacted to not less than 90% of maximum density.

All fill and backfill shall be placed in lifts not greater than 8 inches in thickness, loose measurement, prior to compaction.

Areas of soft or unstable sub-base shall be undercut a minimum of 12 inches and aggregate base (CA-2 and IDOT breaker run) placed and compacted to 90% of maximum density.

All density measurements referenced above shall be in accordance with ASTM designation D1557-78 modified proctor method.

Contractor is responsible for maintaining a final grade that is suitable for drainage, seeding and landscaping (minimum of 4" of topsoil). Contractor shall restore all disturbed areas to preconstruction conditions or better.

Contractor shall protect and prevent damage to existing trees which are not indicated on the plans to be removed.

The contractor shall remove existing street signs and post and stockpile them at a safe location to prevent damage and theft. This work shall be considered incidental to the project. The contractor will provide and install new street signs as directed by the engineer.

EROSION AND SEDIMENTATION CONTROL NOTES:

Erosion control practices shall be constructed in accordance with the Standard Specifications, the Standards for Soil Erosion and Sediment Control as contained in IEPA/WPC/ 87-012 or current edition and according to Procedures and Standards for Urban Soil Erosion and Sedimentation Control in Illinois, latest edition, and according to the Standards of the City of Rochelle.

A temporary sediment barrier of straw bales or filter fabric shall be placed around each storm sewer inlet potentially impacted by work. This work shall considered incidental to the project Fabric filter fences or straw bales shall be placed around any stock pile with more than 10 cu. yd. of material. At the end of each work day, the contractor shall sweep or clean (not flush) any construction soil material from the street to prevent tracking.

The Engineer shall determine the adequacy of the contractor's erosion control efforts. The Engineer or his designated representative shall have full authority to suspend or limit the contractor's operations pending adequate performance of erosion control methods.

The contractor shall inspect erosion control structures daily and immediately after any major storm. All mud and debris shall be swept clean from roadways at the end of each working day or as directed by the Engineer. This item shall be considered incidental to the contract.

Refer to the Special Provisions for further requirements of contract pay items.

TREE REMOVAL SCHEDULE

| Location | Size |
|-------------------------------------|----------|
| STA 14+26, 30' LT | 24 Units |
| STA 21+55, 26' RT | 24 Units |
| STA 21+55, 26' RT (North Stem Only) | 12 Units |

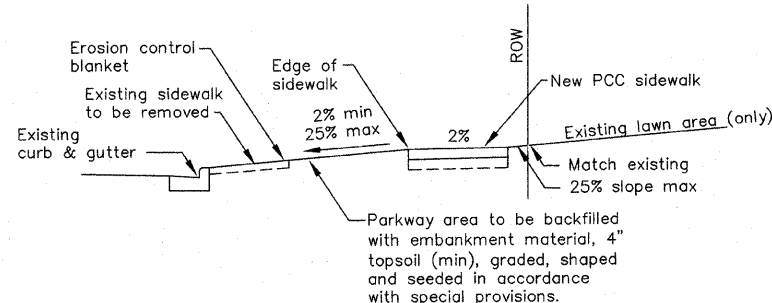

TYPICAL PARKWAY RESTORATION

SUMMARY OF QUANTITIES CONSTRUCTION TYPE CODE: Y051

| Item Number | Items | Unit | Quantity |
|-------------|--|------|-----------|
| 44000600 | Sidewalk Removal | SF | 14,088.00 |
| 44000200 | Driveway Pavement Removal | SY | 670 |
| 42400100 | Portland Cement Concrete Sidewalk, 4" | SF | 16,911.00 |
| 42400300 | Portland Cement Concrete Sidewalk, 6" | SF | 5,270.00 |
| 42400410 | Portland Cement Concrete Sidewalk, 8" | SF | 930 |
| 42400800 | Detectable Warnings | SF | 564 |
| 50800105 | Reinforcement Bars | LBS | 400 |
| 42300200 | Portland Cement Concrete Driveway Pmnt, 6" | SY | 470 |
| 42300400 | Portland Cement Concrete Driveway Pmnt, 8" | SY | 105 |
| 44001700 | Comb Conc. Curb & Gutter Remove & Replace | FT | 224 |
| 44002400 | Curb Removal, Special | FT | 408 |
| 20100110 | Tree Removal, 6" to 15" | UNIT | 12 |
| 20100210 | Tree Removal, over 15" | UNIT | 48 |
| 70101700 | Traffic Control and Protection | LS | 1 |
| 28000400 | Perimeter Erosion Barrier | FT | 1,200.00 |
| * 78001130 | Paint Pavement Marking - Line 6" | FT | 396 |
| * 78001150 | Paint Pavement Marking - Line 12" | FT | 1,410.00 |
| * 78001180 | Paint Pavement Marking - Line 24" | FT | 179 |
| 67100100 | Mobilization | LS | 1 |

* Specialty Items

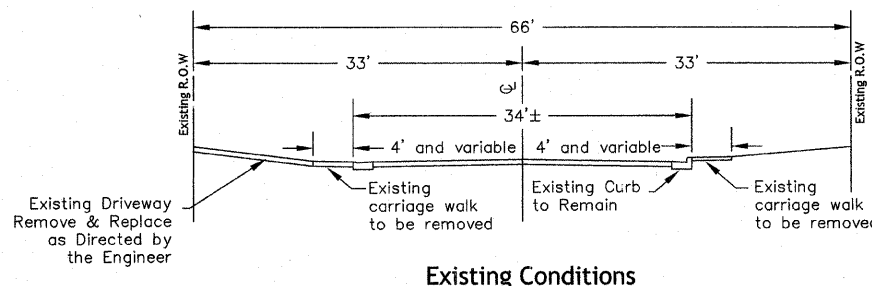

Existing Conditions

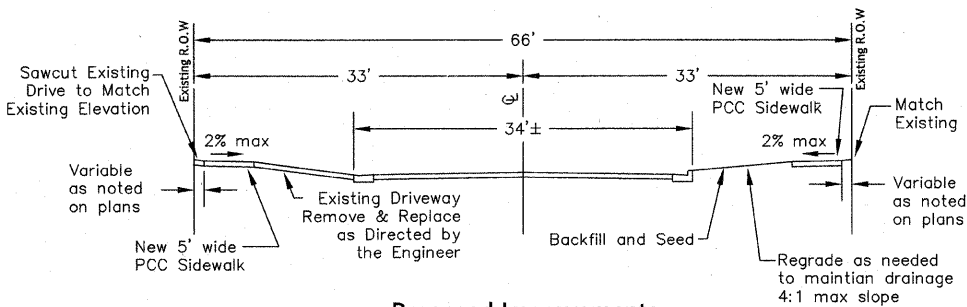

Proposed Improvements

10th AVENUE TYPICAL SECTIONS

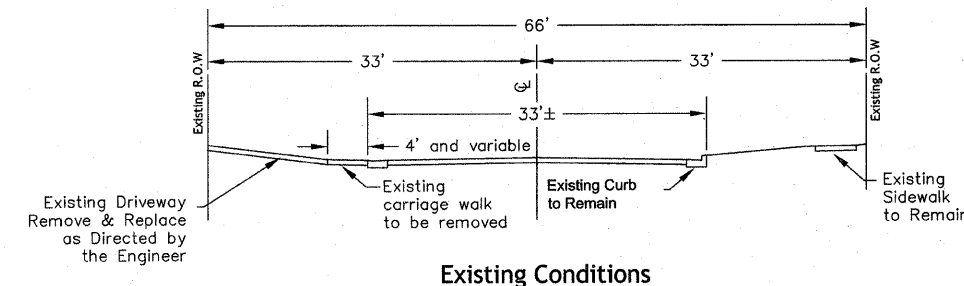

Existing Conditions

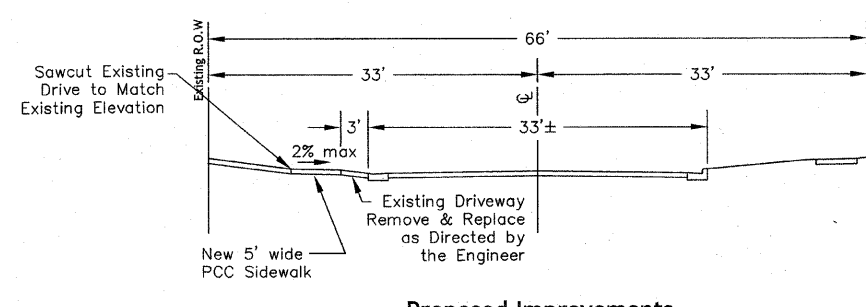

Proposed Improvements

9th STREET TYPICAL SECTIONS

| REVISIONS | | | |
|-----------|-----------------|---------|----------|
| REV | DESCRIPTION | DATE | APPROVED |
| 1 | Per IDOT Review | 3/23/09 | SCT |
| 2 | Per IDOT Review | 3/30/09 | SCT |

| | | |
|---|----------------|---|
| DRAWING: General Notes, Quantities, Typ Sections | | SHEET |
| DRAWN BY: CW | SCALE | 2 of 11 <i>Contract 8545B</i> |
| CHECKED BY: ST | HORZ SCALE: NA | |
| DATE: 3/20/09 | VERT SCALE: NA | |

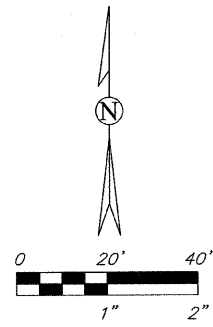

- PAVEMENT MARKING LEGEND**
- 1 PAINT PAVEMENT MARKING - LINE 6" (CROSSWALK EDGE LINE)
 - 2 PAINT PAVEMENT MARKING - LINE 12" (CROSSWALK)
 - 3 PAINT PAVEMENT MARKING - LINE 24" (STOP BAR)

THE FOLLOWING UTILITY POLES AND APPURTENANCES TO BE RELOCATED BY ROCHELLE MUNICIPAL UTILITIES OR THE APPLICABLE UTILITY COMPANY

STA 23+45, RT
STA 24+29, RT

PERIMETER EROSION BARRIER (SILT FENCE) TO BE PLACED AS DIRECTED BY THE ENGINEER

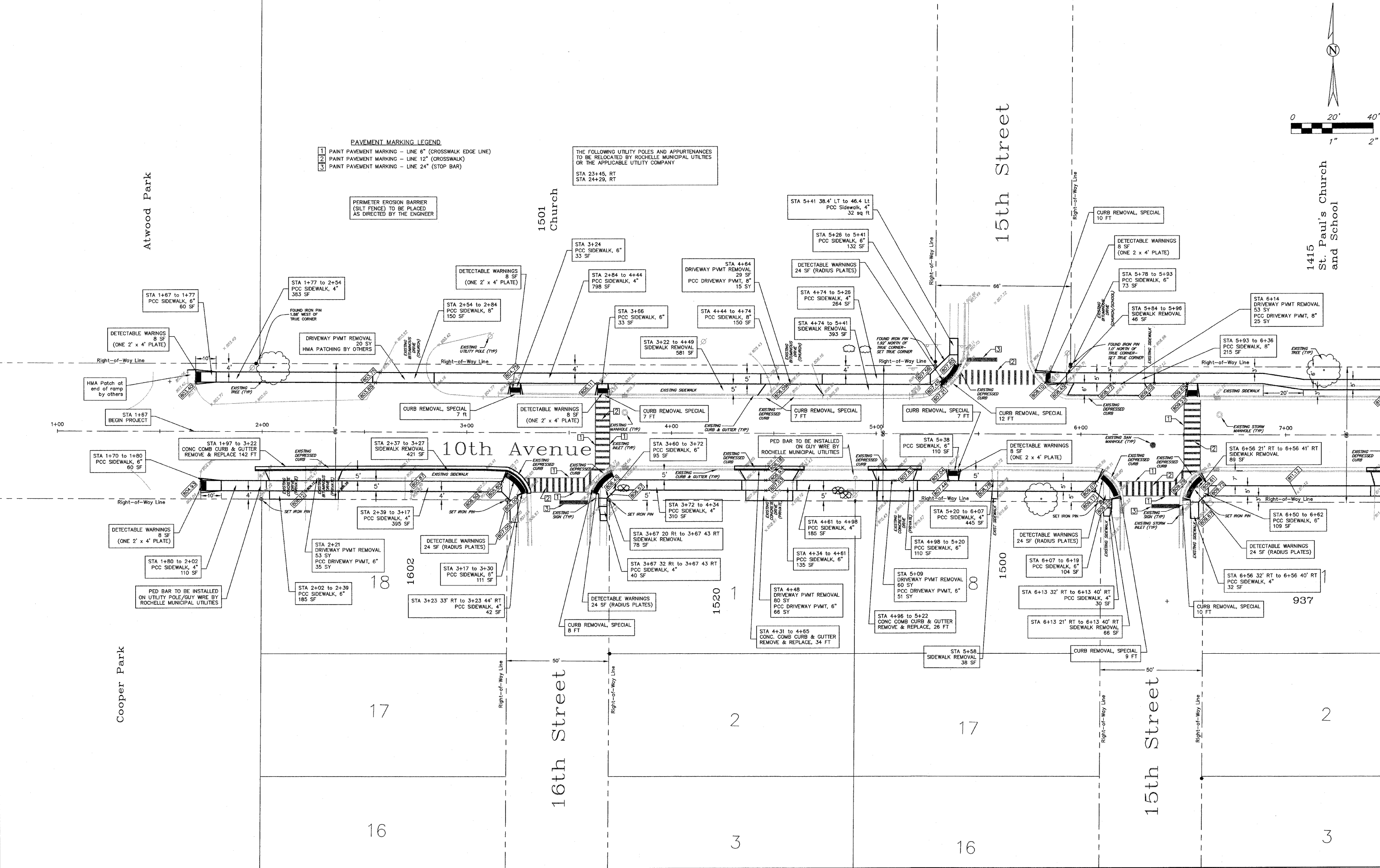

| REV | DESCRIPTION | DATE | APPROVED |
|-----|-----------------|---------|----------|
| 1 | Per IDOT Review | 3/23/09 | SCT |
| 2 | Per IDOT Review | 3/30/09 | SCT |

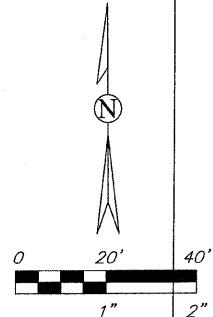

- PAVEMENT MARKING LEGEND**
- 1 PAINT PAVEMENT MARKING - LINE 6" (CROSSWALK EDGE LINE)
 - 2 PAINT PAVEMENT MARKING - LINE 12" (CROSSWALK)
 - 3 PAINT PAVEMENT MARKING - LINE 24" (STOP BAR)
- THE FOLLOWING UTILITY POLES AND APPURTENANCES TO BE RELOCATED BY ROCHELLE MUNICIPAL UTILITIES OR THE APPLICABLE UTILITY COMPANY:
 STA 13+17, RT
 STA 14+14, RT

PERIMETER EROSION BARRIER (SILT FENCE) TO BE PLACED AS DIRECTED BY THE ENGINEER

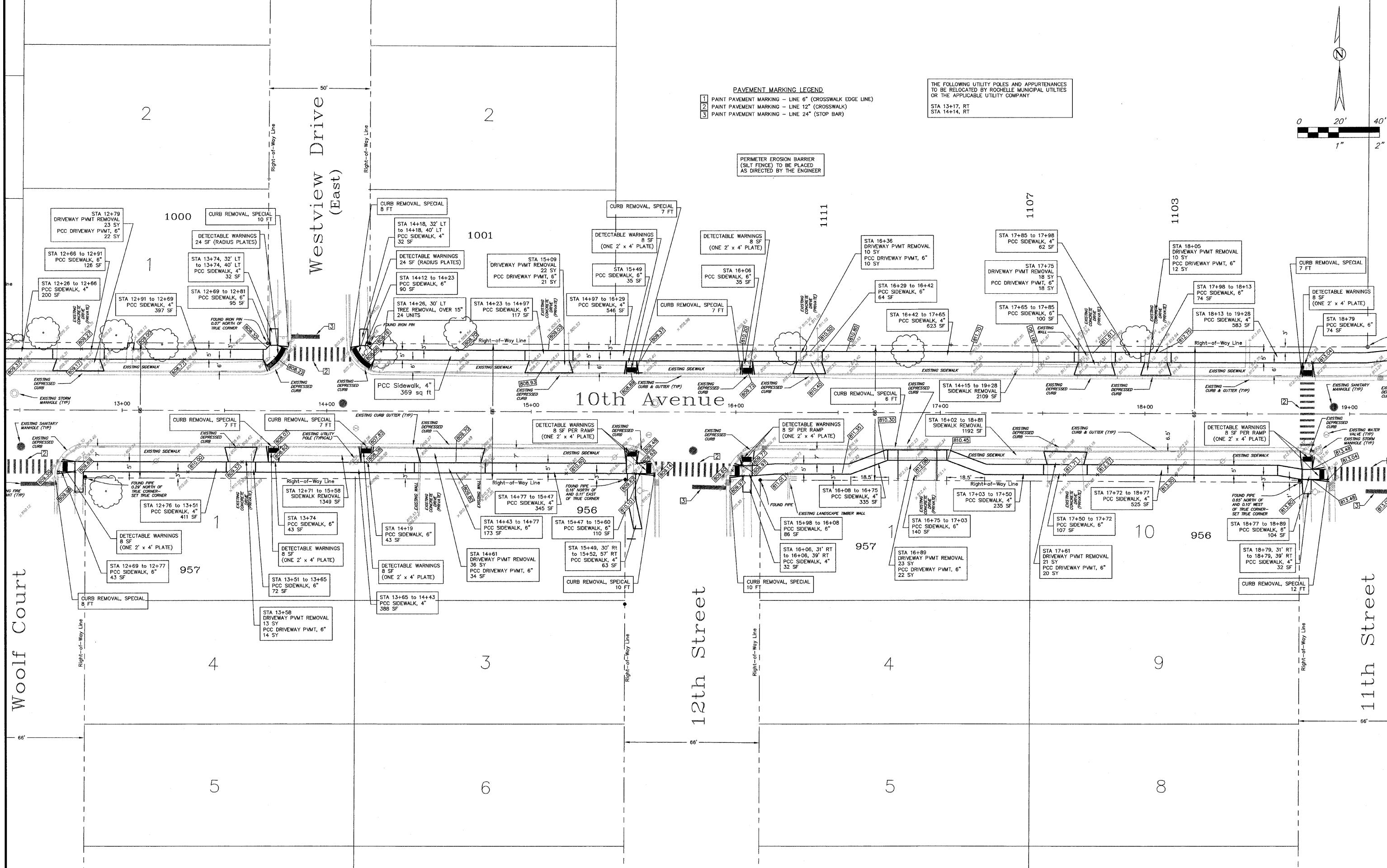

| REVISIONS | | | |
|-----------|-----------------|---------|----------|
| REV | DESCRIPTION | DATE | APPROVED |
| 1 | Per IDOT Review | 3/23/09 | SCT |
| 2 | Per IDOT Review | 3/30/09 | SCT |

- PAVEMENT MARKING LEGEND**
- 1 PAINT PAVEMENT MARKING - LINE 6" (CROSSWALK EDGE LINE)
 - 2 PAINT PAVEMENT MARKING - LINE 12" (CROSSWALK)
 - 3 PAINT PAVEMENT MARKING - LINE 24" (STOP BAR)

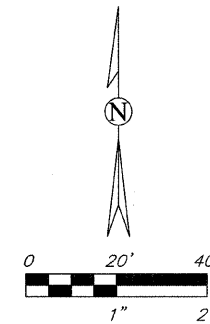

Tilton School

1050 Tilton School

PERIMETER EROSION BARRIER (SLT FENCE) TO BE PLACED AS DIRECTED BY THE ENGINEER

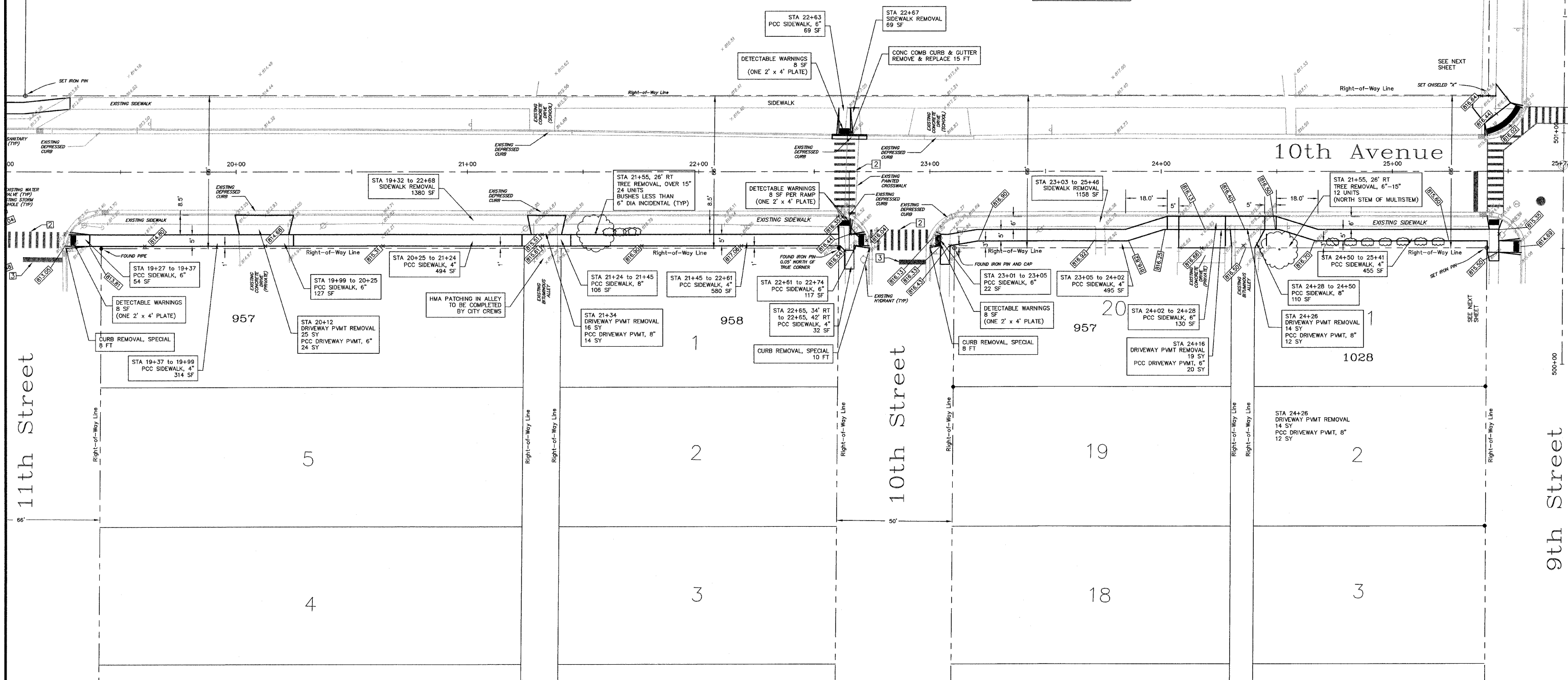

City of Rochelle
Engineering Division
417 N. 6th St. Rochelle, IL 61068

PROJECT: **Safe Routes to School
10th Avenue Sidewalk Improvements
9th Street to Atwood & Cooper Parks
Section No 08-00104-00-SW**

| REVISIONS | | | |
|-----------|-----------------|---------|----------|
| REV | DESCRIPTION | DATE | APPROVED |
| 1 | Per IDOT Review | 3/23/09 | SCT |
| 2 | Per IDOT Review | 3/30/09 | SCT |

DRAWING: **10th Avenue - 11th St. to 9th St.**

SCALE: HORIZ SCALE: 1" = 20'
VERT SCALE: N/A

SHEET: **6 of 11**
Contract 05A5B

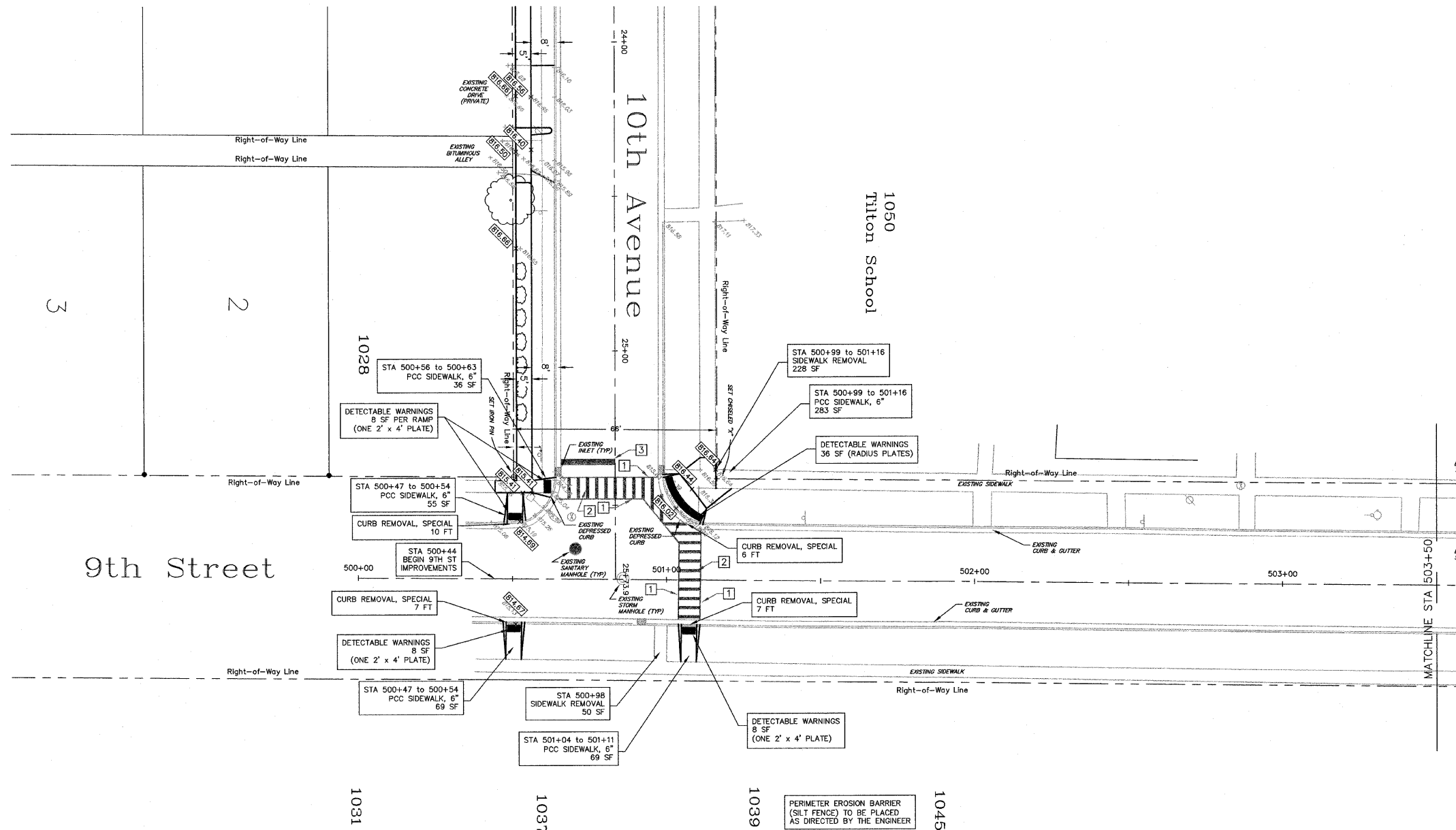
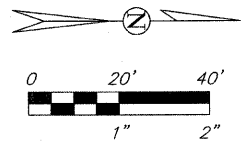

- PAVEMENT MARKING LEGEND**
- 1 PAINT PAVEMENT MARKING - LINE 6" (CROSSWALK EDGE LINE)
 - 2 PAINT PAVEMENT MARKING - LINE 12" (CROSSWALK)
 - 3 PAINT PAVEMENT MARKING - LINE 24" (STOP BAR)

| REVISIONS | | | |
|-----------|-----------------|---------|----------|
| REV | DESCRIPTION | DATE | APPROVED |
| 1 | Per IDOT Review | 3/23/09 | SCT |
| 2 | Per IDOT Review | 3/30/09 | SCT |

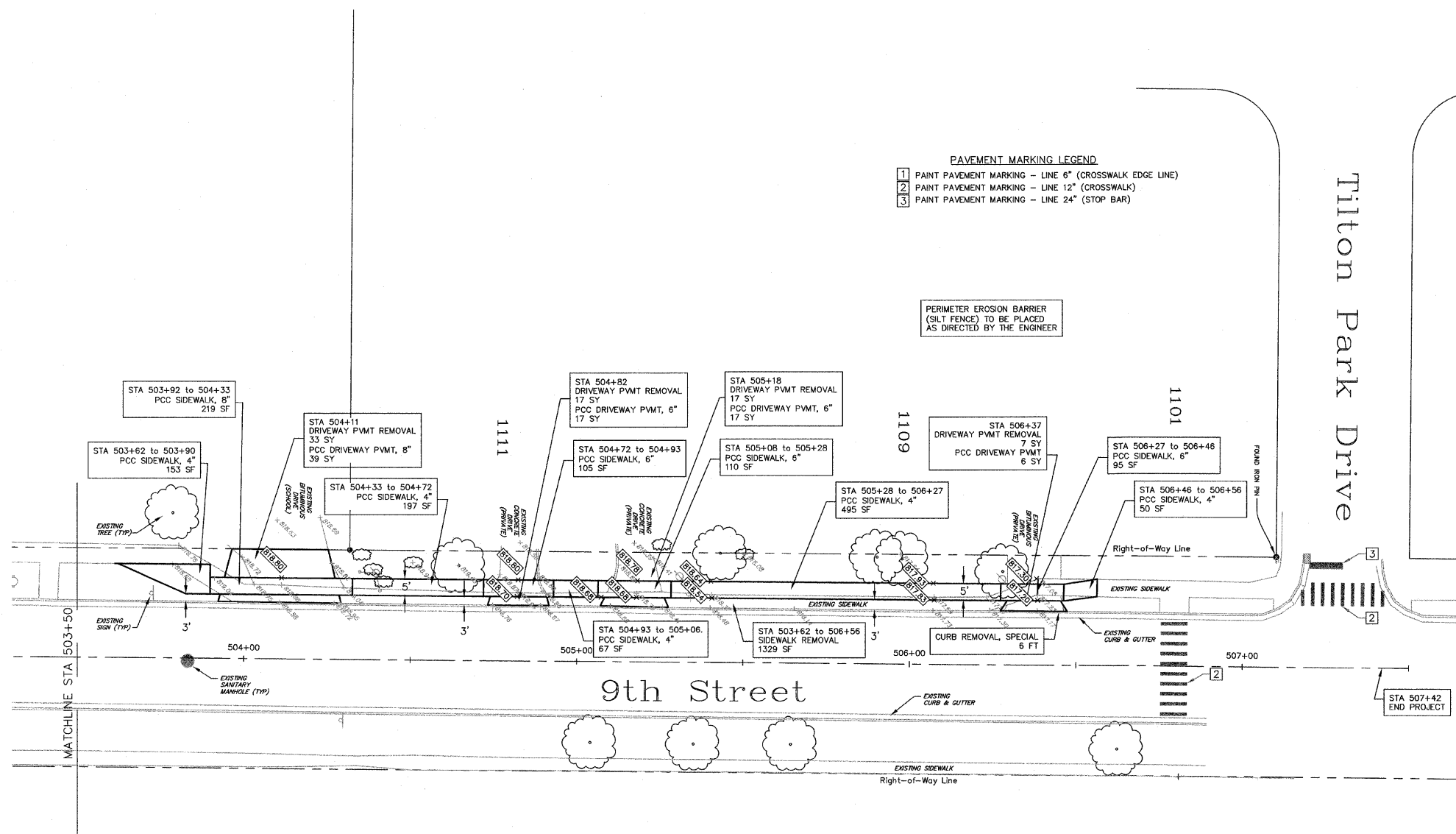
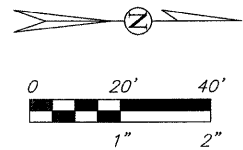

- PAVEMENT MARKING LEGEND**
- 1 PAINT PAVEMENT MARKING - LINE 6" (CROSSWALK EDGE LINE)
 - 2 PAINT PAVEMENT MARKING - LINE 12" (CROSSWALK)
 - 3 PAINT PAVEMENT MARKING - LINE 24" (STOP BAR)

PERIMETER EROSION BARRIER (SILT FENCE) TO BE PLACED AS DIRECTED BY THE ENGINEER

Tilton Park Drive

9th Street

STA 507+42
END PROJECT

| REVISIONS | | | |
|-----------|-----------------|---------|----------|
| REV | DESCRIPTION | DATE | APPROVED |
| 1 | Per IDOT Review | 3/23/09 | SCT |
| 2 | Per IDOT Review | 3/30/09 | SCT |

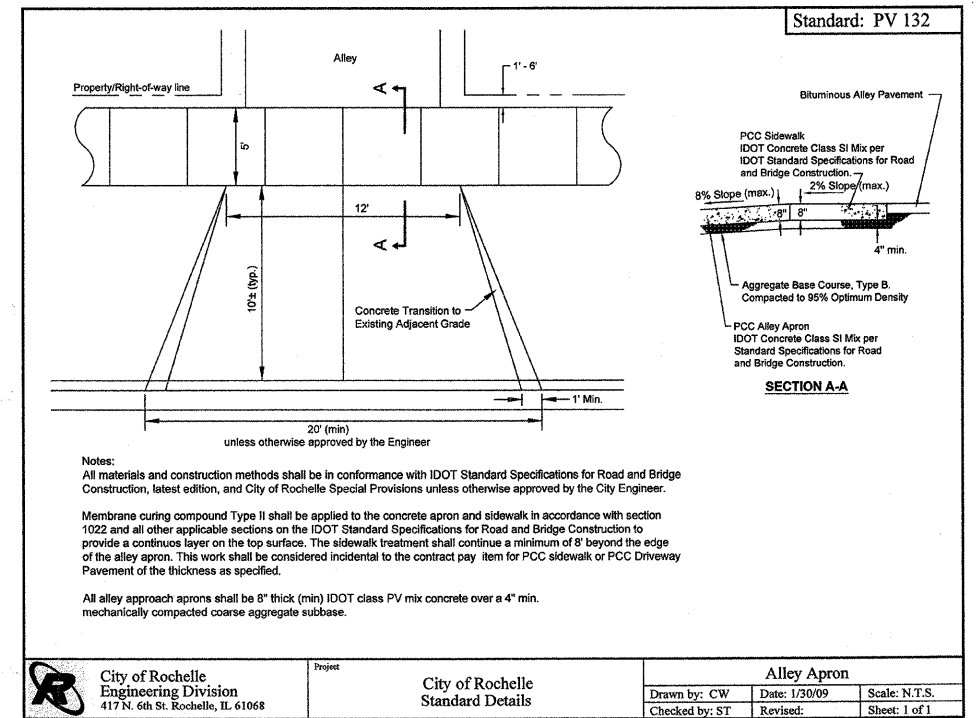
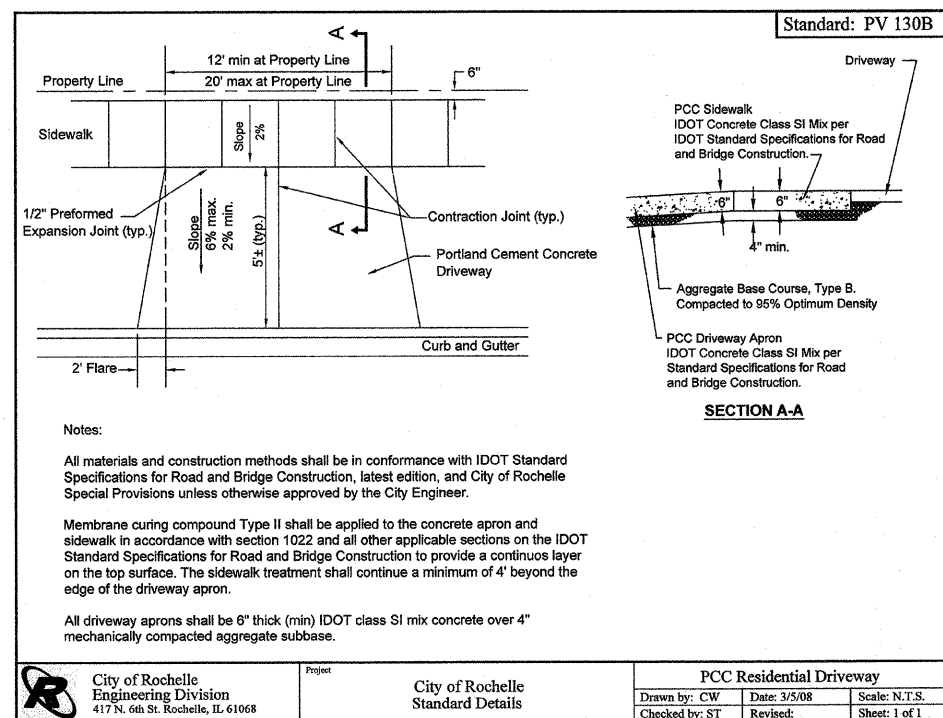
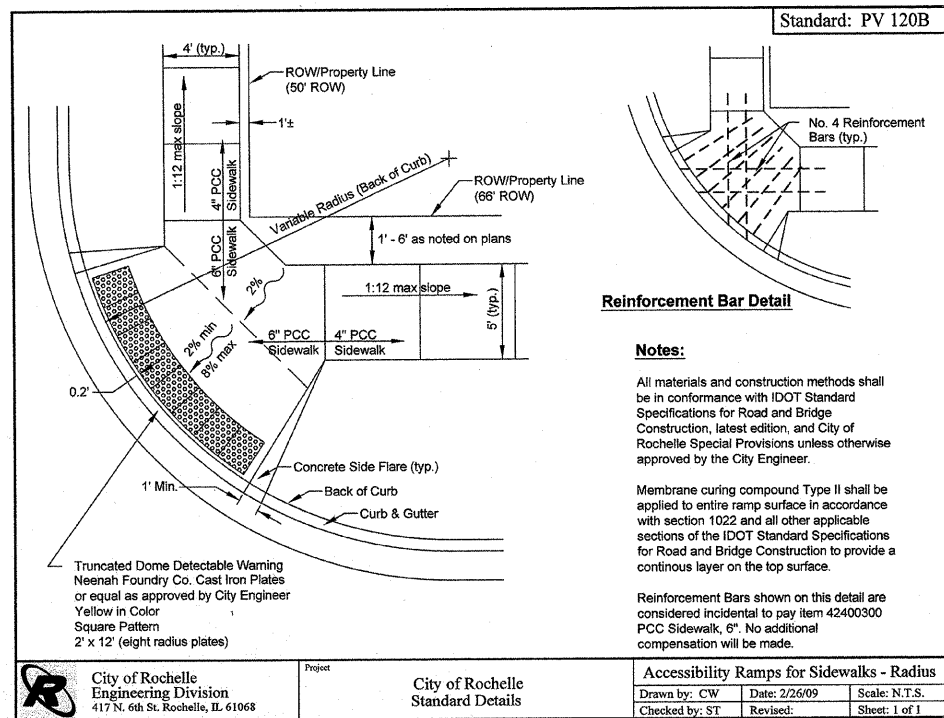
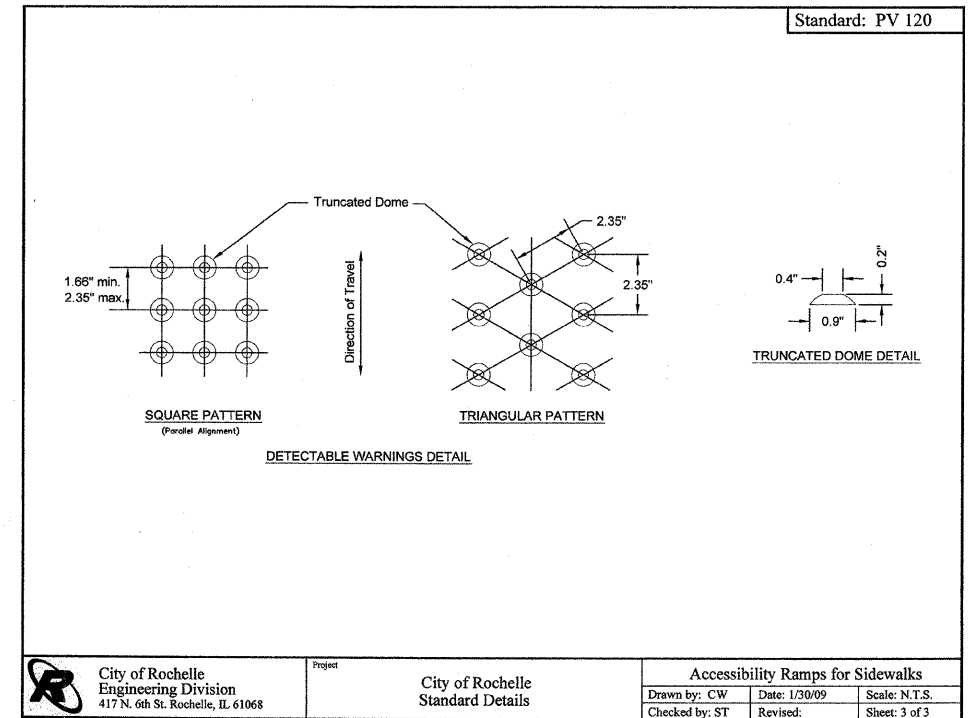
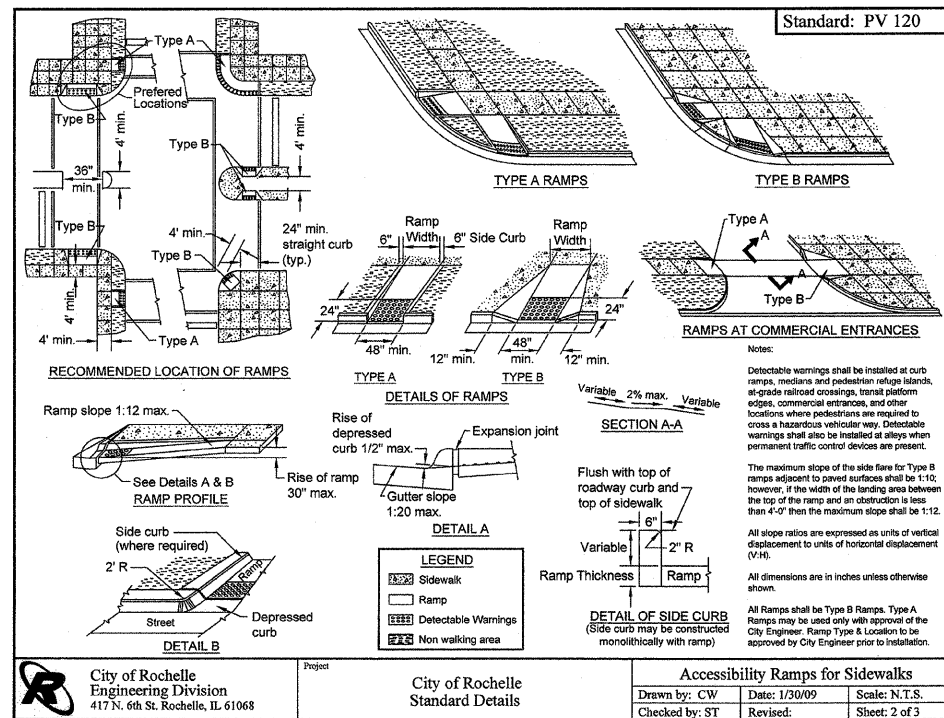
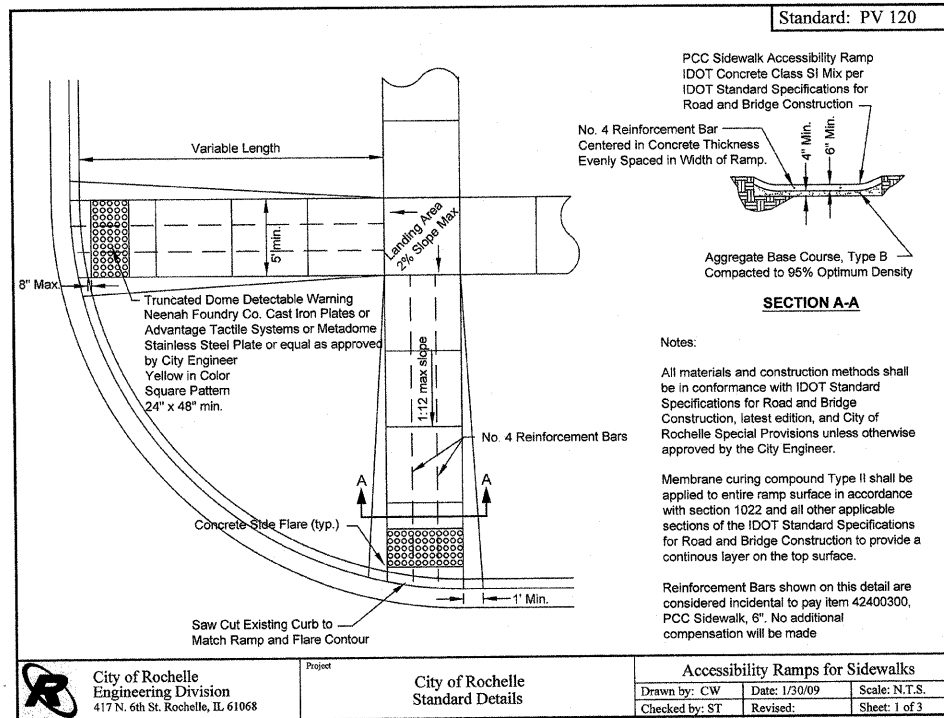

| REVISIONS | | | |
|-----------|-------------|------|----------|
| REV | DESCRIPTION | DATE | APPROVED |
| | | | |

| DRAWING: | | | |
|----------------|--|----------------|-----------------------|
| DRAWN BY: CW | | SCALE | |
| CHECKED BY: ST | | HORZ SCALE: NA | |
| DATE: 3/20/09 | | VERT SCALE: NA | |
| SHEET | | | 9 of 11 |
| | | | <i>Contract 85458</i> |

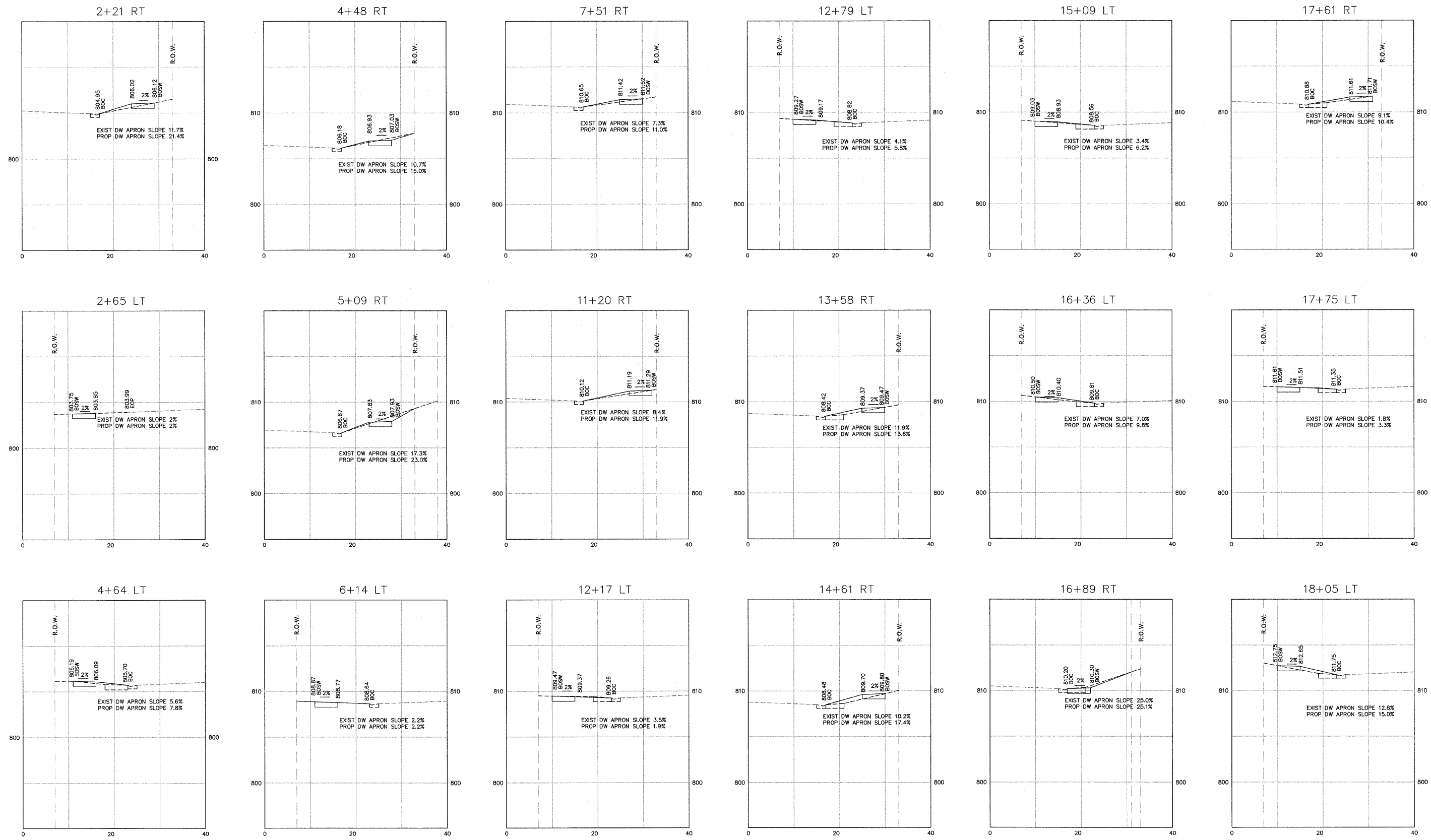

| REVISIONS | | | |
|-----------|-----------------|---------|----------|
| REV | DESCRIPTION | DATE | APPROVED |
| 1 | Per IDOT Review | 3/30/09 | SCT |
| | | | |
| | | | |

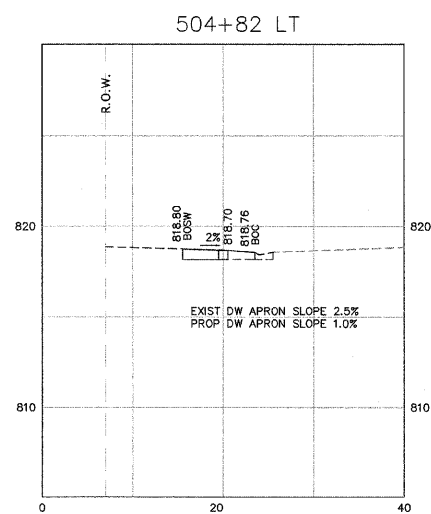
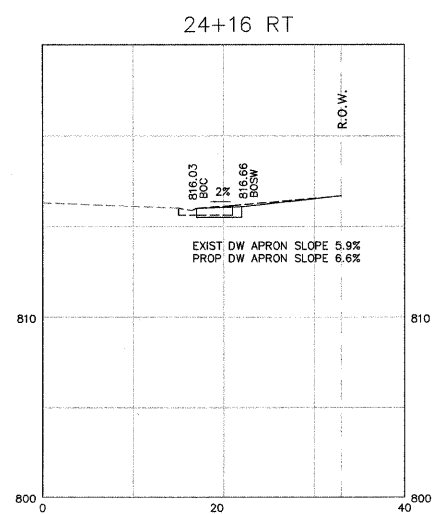
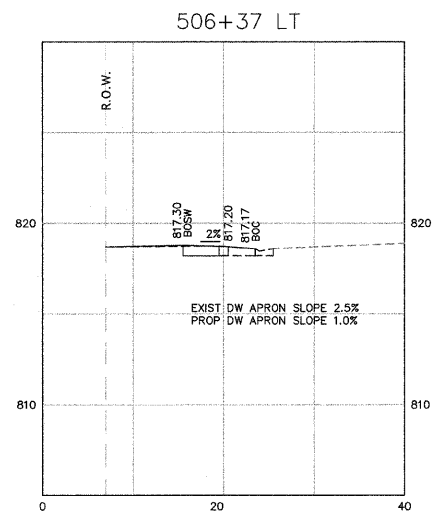
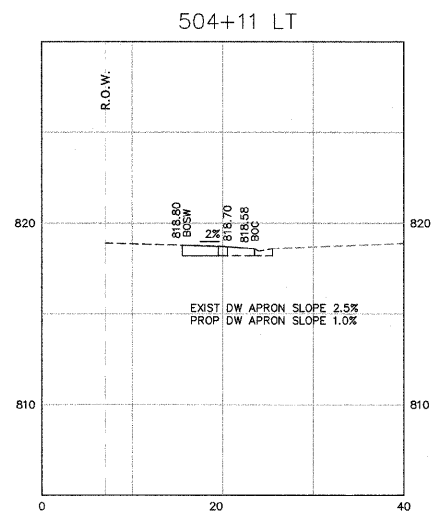
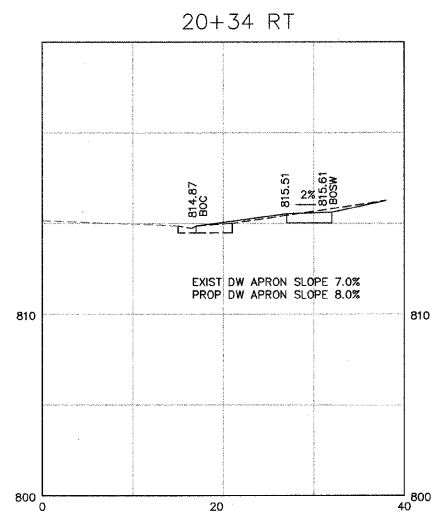
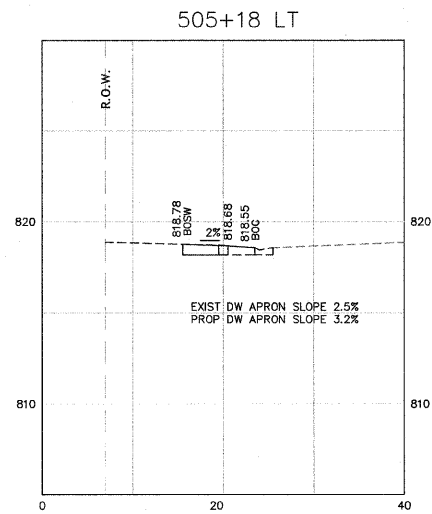
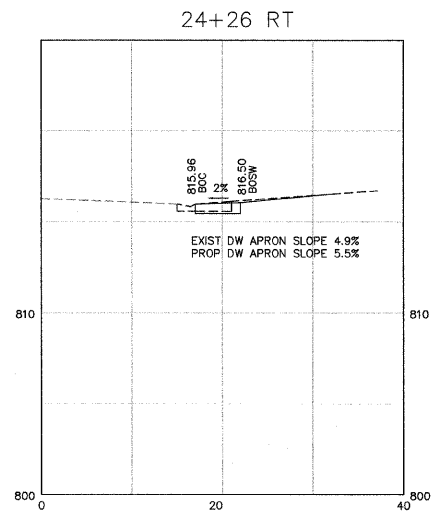
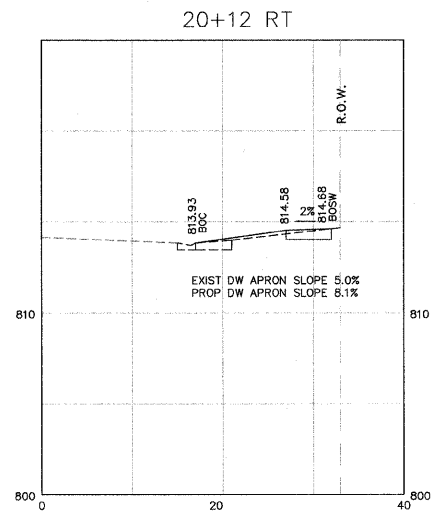

| REVISIONS | | | |
|-----------|-----------------|---------|----------|
| REV | DESCRIPTION | DATE | APPROVED |
| 1 | Per IDOT Review | 3/30/09 | SCT |
| | | | |
| | | | |