

SUGGESTED SEQUENCE OF CONSTRUCTION

- 1) CLOSE IL 169 DOWN TO TRAFFIC USING STANDARD BLR 22-6
- 2) REMOVE PAVEMENT AND EXISTING CULVERT.
- 3) LAY THE 48" PIPE CULVERT, BACKFILL WITH ROCK, AND OPEN TO TRAFFIC.
- 4) POUR ONE SIDE OF PATCH AND BUILD END SECTION WHILE TRAFFIC RUNS ON THE OTHER.
- 5) SWITCH TRAFFIC TO PATCH AND WORK ON OTHER SIDE.

- A STONE DUMPED RIPRAP, CLASS A4
- B PAVEMENT REMOVAL
- C PAVED SHOULDER REMOVAL
- D CLASS C PATCH, TY 4, 10"
- E SAW CUTS
- F SEEDING, CLASS 2
- G AGGREGATE SHOULDERS, TYPE B
- H PRECAST REINFORCED CONC. END SECTION, 48"
- I FLAP GATE
- J CAST IN PLACE END SECTION, 48"
- K REMOVE AND REINSTALL EXISTING SPBGR
- L REMOVE EXISTING CULVERTS
- M PIPE CULVERT CLASS A TYP. 4
- N INLET AND PIPE PROTECTION

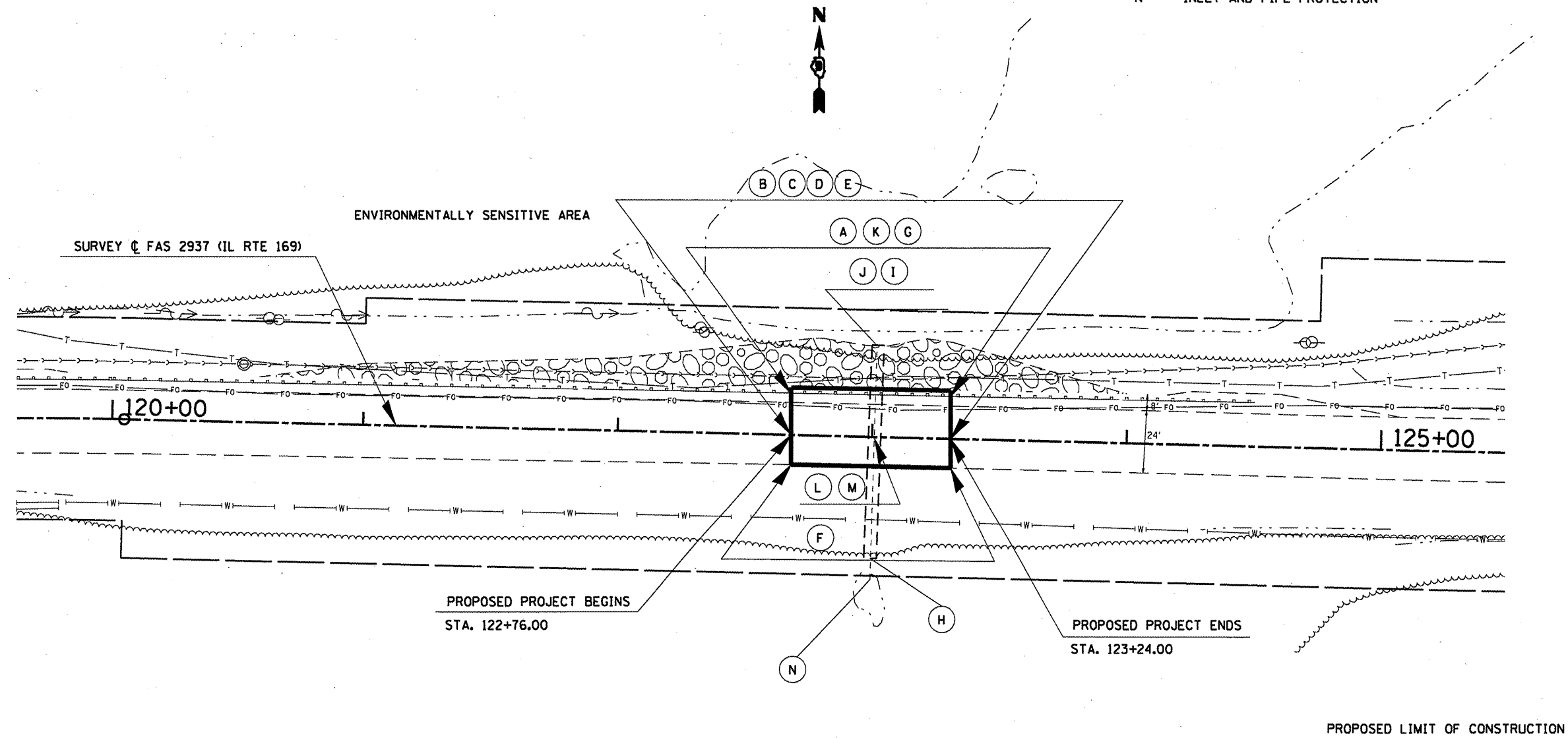

NOTE: DO NOT EXTEND PROPOSED CULVERT BEYOND THE LIMITS OF THE EXISTING CULVERT DUE TO THE ENVIRONMENTALLY SENSITIVE AREA.

**STATE OF ILLINOIS
DEPARTMENT OF TRANSPORTATION**

F.A.S. RTE.	SECTION	COUNTY	TOTAL SHEETS	SHEET NO.
2937	116(1-1)	PULASKI	7	5
CULVERT REPLACEMENT				
FED. ROAD DIST. NO. ILLINOIS FED. AID PROJECT				