

P.E.

R3-2-2424

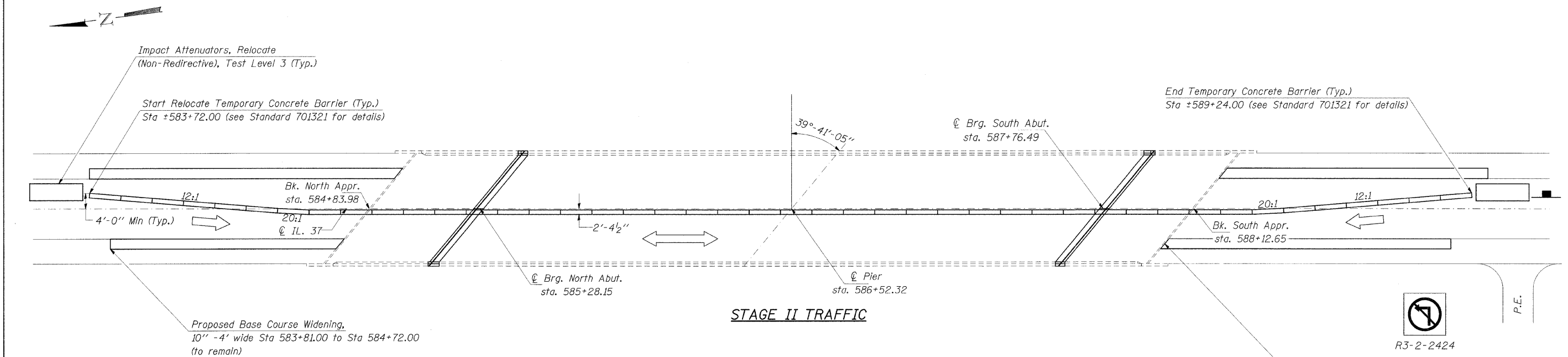

P.E.

R3-2-2424

Notes:
 See Standard 701321 for additional details.
 Rumble Strips will be needed on the north end of the project and should follow details shown in Standard 701321, final locations should be determined by the Engineer.

Proposed Base Course Widening,
 10'' - 4' wide Sta 588+02.00 to Sta 589+16.00
 (to remain)

**STAGE CONSTRUCTION
 DETAILS
 SN 044-0031**

FILE NAME =	USER NAME = cornellm	DESIGNED -	REVISED -	STATE OF ILLINOIS DEPARTMENT OF TRANSPORTATION	STAGE CONSTRUCTION SN 044-0031			F.A.I. RTE.	SECTION	COUNTY	TOTAL SHEETS	SHEET NO.	
c:\pw\work\p\WIDOT\CORNELLM\dms47925\04-0031-bsmart.dgn		DRAWN -	REVISED -		SCALE:	SHEET NO.	OF SHEETS	STA.	TO STA.	24/57	D9 BSMART FY09-1	JOHNSON/PULASKI	20 12
		CHECKED -	REVISED -									CONTRACT NO. 78095	
		DATE -	REVISED -									ILLINOIS FED. AID PROJECT	