

F.A.I. RTE.	SECTION	COUNTY	TOTAL SHEETS	SHEET NO.
55	VARIOUS	LIVINGSTON	13	1
		ILLINOIS	CONTRACT NO. 66940	

STATE OF ILLINOIS  
DEPARTMENT OF TRANSPORTATION  
DIVISION OF HIGHWAYS

**PROPOSED  
HIGHWAY PLANS**

FAI ROUTE 55 (I-55)  
SECTION VARIOUS / (53-1) I-4

**PAVEMENT PATCHING/RECONSTRUCTION  
LIVINGSTON AND GRUNDY COUNTIES**  
C-93-076-09

**INDEX OF SHEETS**

1. COVER SHEET
2. GENERAL NOTES
3. SUMMARY OF QUANTITIES
- 4-5. TYPICAL SECTIONS
- 6-8. SCHEDULES
- 9-10. CLASS A PATCHING DETAILS
11. PAVEMENT RECONSTRUCTION DETAILS
12. TYPICAL PAVEMENT MARKING
13. RAMP CLOSURE SIGNING

**STANDARDS**

- |           |  |
|-----------|--|
| 000001-05 | STANDARD SYMBOLS, ABBREVIATIONS AND PATTERNS                                   |
| 001001-02 | AREAS OF REINFORCEMENT BARS  |
| 001006    | DECIMAL OF AN INCH AND OF A FOOT   |
| 420001-07 | PAVEMENT JOINTS  |
| 420701-02 | PAVEMENT FABRIC  |
| 421001-02 | BAR REINFORCEMENT FOR CRC PAVEMENT   |
| 442001-04 | CLASS A PATCHES  |
| 483001-04 | PCC SHOULDER   |
| 701101-02 | OFF-ROAD OPERATIONS MULTILANE, 15' (4.5 m) TO 24" (600 mm) FROM PAVEMENT EDGE  |
| 701106-02 | OFF-ROAD OPERATIONS, MULTILANE, MORE THAN 15' (4.5 m) AWAY                     |
| 701400-03 | APPROACH TO LANE CLOSURE, FREEWAY/EXPRESSWAY                                   |
| 701401-05 | LANE CLOSURE, FREEWAY/EXPRESSWAY   |
| 701411-05 | LANE CLOSURE, MULTILANE, AT ENTRANCE OR EXIT RAMP FOR SPEEDS ≥ 45 MPH          |
| 701422-02 | LANE CLOSURE, MULTILANE, FOR SPEEDS ≥ 45 MPH TO 55 MPH                         |
| 701426-03 | LANE CLOSURE, MULTILANE, INTERMITTENT OR MOVING OPERATIONS FOR SPEEDS ≥ 45 MPH |
| 701451    | RAMP CLOSURE FREEWAY/EXPRESSWAY  |
| 701901-01 | TRAFFIC CONTROL DEVICES  |

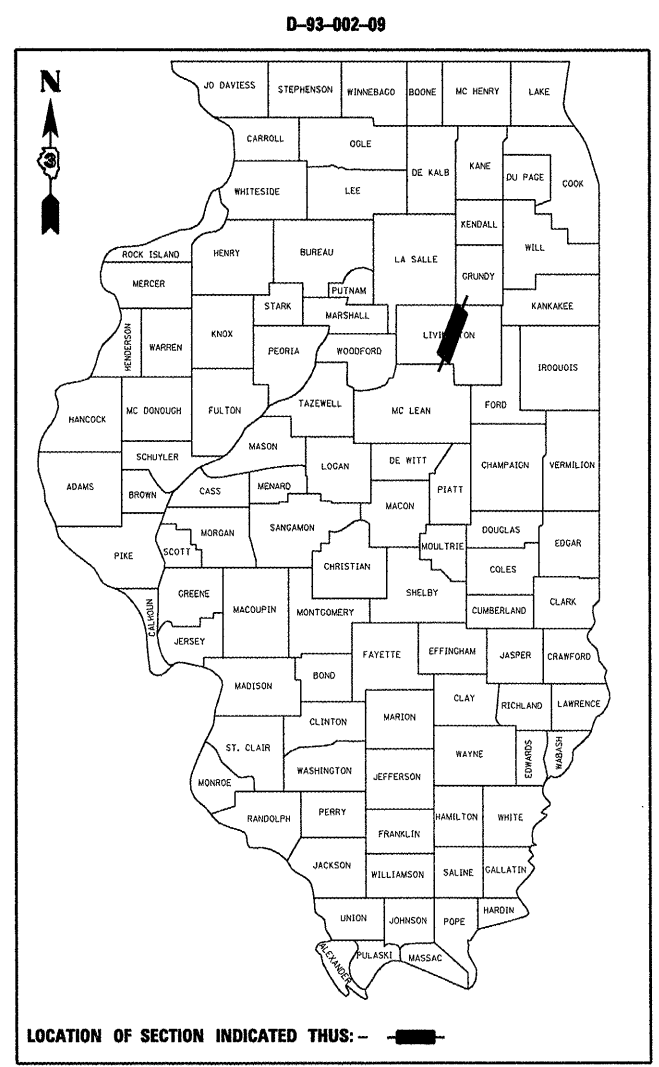

FUNCTIONAL CLASSIFICATION  
RURAL - INTERSTATE  
FAI ROUTE 55 (I-55)  
2007 ADT = 20400  
P.V. = 69.1% M.U. = 26.5% S.U. = 4.4%

**PAVEMENT RECONSTRUCTION**

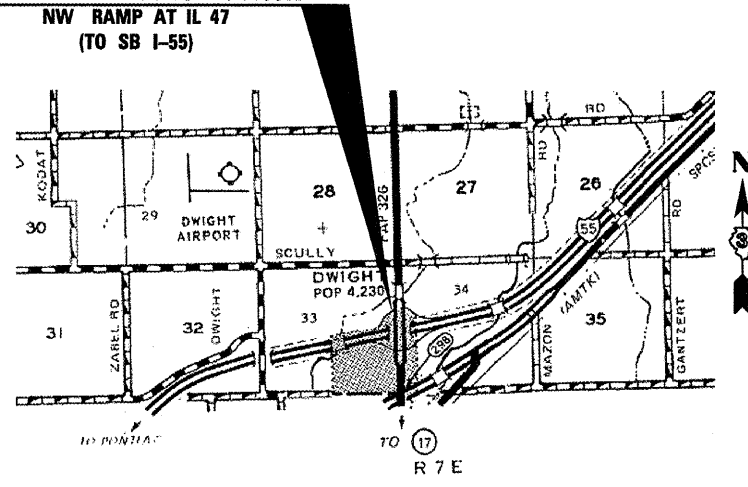

J.U.L.I.E.  
JOINT UTILITY LOCATION INFORMATION FOR EXCAVATION  
1-800-892-0123  
OR 811

PROJECT ENGINEER: JOE KANNEL  
UNIT CHIEF: RON WOODSHANK  
TOWNSHIPS: VARIOUS  
CONTRACT NO. 66940



**END PAVEMENT PATCHING**  
GRUNDY COUNTY LINE  
(M.M. 218.07)

**BEGIN PAVEMENT PATCHING**  
McCLEAN COUNTY LINE  
(M.M. 187.70)

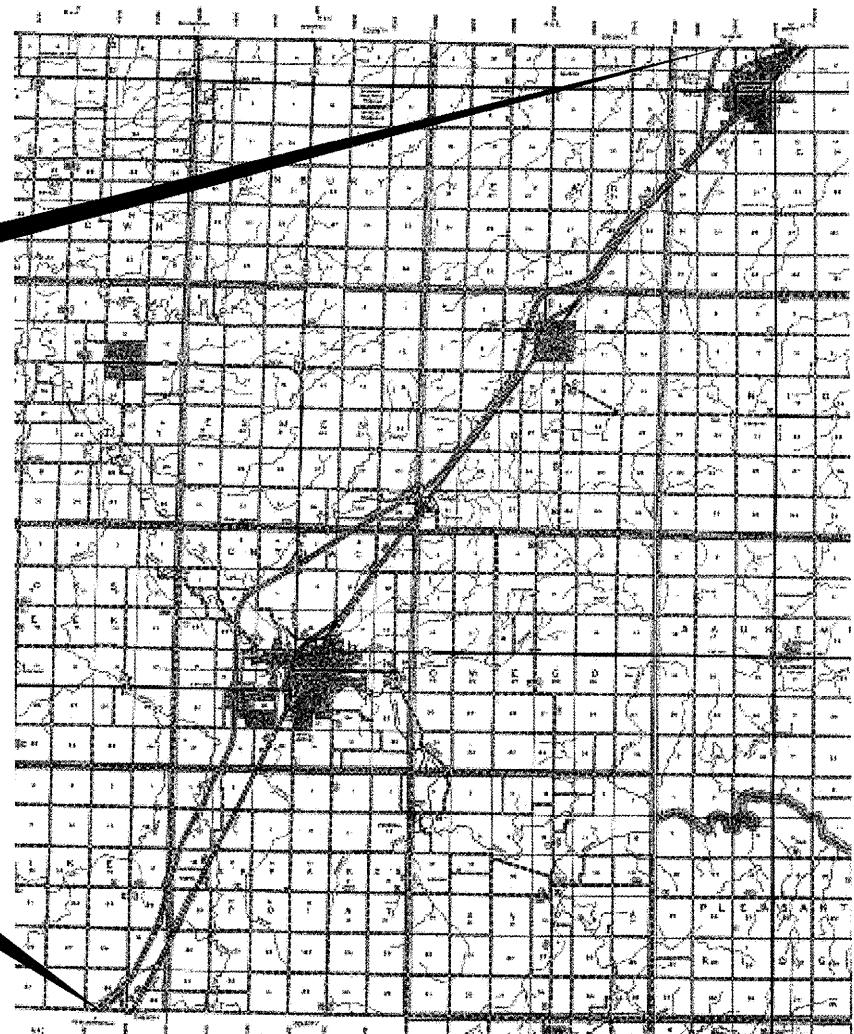

STATE OF ILLINOIS  
DEPARTMENT OF TRANSPORTATION  
DIVISION OF HIGHWAYS

SUBMITTED 7/2 2009  
*George R. Ryan*  
DEPUTY DIRECTOR OF HIGHWAYS, REGION ENGINEER

May 8, 20 09  
*Charles G. Ingersoll*  
ENGINEER OF DESIGN AND ENVIRONMENT

May 8, 20 09  
*Christine M. Reed*  
DIRECTOR OF HIGHWAYS, CHIEF ENGINEER

**PRINTED BY THE AUTHORITY  
OF THE STATE OF ILLINOIS**

**GENERAL NOTES**

PLAN DIMENSIONS AND DETAILS RELATIVE TO EXISTING ROADWAY OR STRUCTURE HAVE BEEN TAKEN FROM EXISTING PLANS AND ARE SUBJECT TO NOMINAL CONSTRUCTION VARIATIONS. IT SHALL BE THE CONTRACTOR'S RESPONSIBILITY TO VERIFY SUCH DIMENSIONS AND DETAILS IN THE FIELD AND TO MAKE NECESSARY APPROVED ADJUSTMENTS PRIOR TO CONSTRUCTION OR ORDERING OF MATERIALS. SUCH VARIATIONS SHALL NOT BE CAUSE FOR ADDITIONAL COMPENSATION FOR A CHANGE IN THE SCOPE OF THE WORK, HOWEVER, THE CONTRACTOR WILL BE PAID FOR THE QUANTITY ACTUALLY FURNISHED AT THE UNIT BID FOR THE WORK.

EXISTING REINFORCEMENT BARS EXTENDING INTO REMOVAL AREA SHALL BE CLEANED, STRAIGHTENED AND INCORPORATED INTO THE NEW CONSTRUCTION. ANY REINFORCEMENT BARS THAT ARE DAMAGED DURING CONCRETE REMOVAL SHALL BE REPLACED WITH AN APPROVED BAR SPLICER OR ANCHORAGE SYSTEM. COST INCLUDED WITH CONCRETE REMOVAL.

FOR STABILIZATION, ALL TYPE III BARRICADES SHALL REQUIRE A MINIMUM OF FOUR SAND BAGS PER BARRICADE.

THE CONTRACTOR SHALL BE RESPONSIBLE FOR PROTECTING UTILITY PROPERTY FROM CONSTRUCTION OPERATIONS AS OUTLINED IN ARTICLE 107.31 OF THE STANDARD SPECIFICATIONS. THE "JULIE" NUMBER IS 1-800-892-0123. A MINIMUM OF FORTY-EIGHT (48) HOURS ADVANCE NOTICE IS REQUIRED.

WHERE SECTION OR SUBSECTION MONUMENTS ARE ENCOUNTERED, THE ENGINEER SHALL BE NOTIFIED BEFORE SUCH MONUMENTS ARE REMOVED. THE CONTRACTOR SHALL PROTECT AND CAREFULLY PRESERVE ALL MONUMENTS UNTIL AN AUTHORIZED SURVEYOR OR AGENT HAS WITNESSED OR OTHERWISE REFERENCED THEIR LOCATION. THE CONTRACTOR SHALL BE RESPONSIBLE FOR HAVING AN AUTHORIZED SURVEYOR REESTABLISH ANY SECTION OR SUBSECTION MONUMENTS DESTROYED BY HIS OPERATIONS.

ABANDONED UNDERGROUND UTILITIES THAT CONFLICT WITH CONSTRUCTION SHALL BE DISPOSED OF OUTSIDE THE LIMITS OF THE RIGHT OF WAY ACCORDING TO ARTICLE 202.03 OF THE STANDARD SPECIFICATIONS AND AS DIRECTED BY THE ENGINEER. THIS WORK WILL NOT BE PAID FOR SEPARATELY BUT SHALL BE INCLUDED IN THE COST OF CLASS A PATCHING.

ANY REFERENCE TO A STANDARD IN THESE PLANS SHALL BE INTERPRETED TO MEAN THE EDITION AS INDICATED BY THE SUBNUMBER LISTED ON THE INDEX OF SHEETS OR THE COPY OF THE STANDARD INCLUDED IN THESE PLANS.

DATE: 4.1.09  
 PREPARED BY: Rid Paul M  
 DISTRICT STUDIES & PLANS ENGINEER  
 EXAMINED BY: Herbert K. Luger  
 DISTRICT CONSTRUCTION ENGINEER  
Wayne J. Phillips  
 DISTRICT MATERIALS ENGINEER  
Bruce A. Gushen  
 DISTRICT OPERATIONS ENGINEER

FILE NAME *	USER NAME = woodshankr1	DESIGNED - RON WOODSHANK	REVISED -
c:\pwwork\pwwdot\WOODSHANKR1\dms91693	D366948-detail1.dgn	DRAWN - RON WOODSHANK	REVISED -
	PLOT SCALE = 100.0000' / IN.	CHECKED -	REVISED -
	PLOT DATE = Mar 31, 2009 - 11:18:27 AM	DATE -	REVISED -

**STATE OF ILLINOIS  
 DEPARTMENT OF TRANSPORTATION**

**GENERAL NOTES**

SCALE: \_\_\_\_\_ SHEET NO. 1 OF 1 SHEETS STA. \_\_\_\_\_ TO STA. \_\_\_\_\_

F.A.I. RTE.	SECTION	COUNTY	TOTAL SHEETS	SHEET NO.
55	VARIOUS		13	2
* LIVINGSTON AND GRUNDY			CONTRACT NO. 66940	
ILLINOIS				

**SUMMARY OF QUANTITIES**

**CONSTRUCTION CODE: J000**

**RURAL  
100% STATE  
LIVINGSTON COUNTY GRUNDY COUNTY**

CODE NO.	ITEM	UNIT	TOTAL QUANTITY	LIVINGSTON COUNTY	GRUNDY COUNTY
20200500	EARTH EXCAVATION (WIDENING)	CU YD	20		20
20201450	SUB-BASE GRANULAR MATERIAL, TYPE A	CU YD	666		666
42000401	PORTLAND CEMENT CONCRETE PAVEMENT 9" (JOINTED)	SQ YD	404		404
44000100	PAVEMENT REMOVAL	SQ YD	404		404
44004250	PAVED SHOULDER REMOVAL	SQ YD	181		181
44200541	CLASS A PATCHES, TYPE II, 9 INCH	SQ YD	210	210	
44200545	CLASS A PATCHES, TYPE III, 9 INCH	SQ YD	52	52	
44200547	CLASS A PATCHES, TYPE IV, 9 INCH	SQ YD	27	27	
44200620	CLASS A PATCHES, TYPE II, 14 INCH	SQ YD	221	221	
44200624	CLASS A PATCHES, TYPE III, 14 INCH	SQ YD	20	20	
44200628	CLASS A PATCHES, TYPE IV, 14 INCH	SQ YD	53	53	
44213000	PATCHING REINFORCEMENT	SQ YD	584	584	
44213100	PAVEMENT FABRIC	SQ YD	241	241	
44213200	SAW CUTS	FOOT	2987	2987	
48300400	PORTLAND CEMENT CONCRETE SHOULDERS 9"	SQ YD	262		262
67100100	MOBILIZATION	L SUM	1	0.75	0.25
70100320	TRAFFIC CONTROL AND PROTECTION, STANDARD 701422	L SUM	1		1
70100420	TRAFFIC CONTROL AND PROTECTION, STANDARD 701411	EACH	16	16	
70100800	TRAFFIC CONTROL AND PROTECTION, STANDARD 701401	L SUM	1	1	
70100820	TRAFFIC CONTROL AND PROTECTION, STANDARD 701451	L SUM	1		1
70103815	TRAFFIC CONTROL SURVEILLANCE	CAL DA	12	12	
X 78008210	POLYUREA PAVEMENT MARKING TYPE I - LINE 4"	FOOT	740	438	302
X 78008230	POLYUREA PAVEMENT MARKING TYPE I - LINE 6"	FOOT	121	121	
Z0075310	TIE BARS 3/4"	EACH	30	30	

X SPECIALTY ITEM

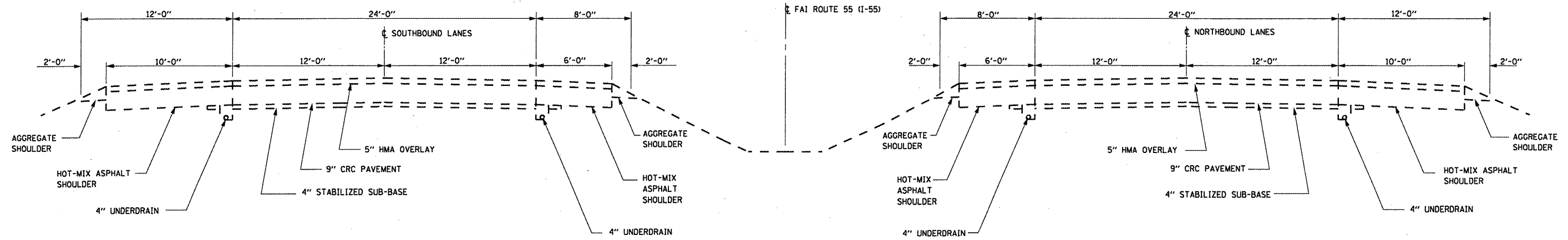

**TYPICAL SECTION  
MAINLINE**  
M.M. 187.70 TO M.M. 215.00

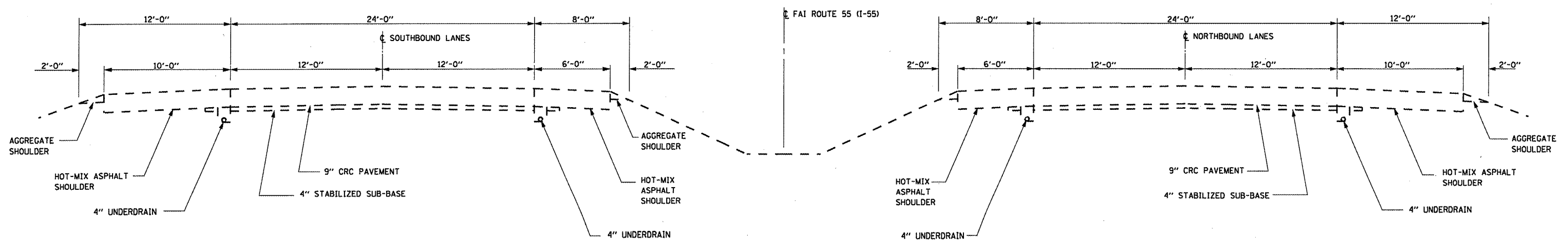

**TYPICAL SECTION  
MAINLINE**  
M.M. 215.00 TO M.M. 218.07

FILE NAME =	USER NAME = woodshankr1	DESIGNED - RON WOODSHANK	REVISED -	<b>STATE OF ILLINOIS DEPARTMENT OF TRANSPORTATION</b>	<b>TYPICAL SECTIONS</b>	F.A.I. RTE.	SECTION	COUNTY	TOTAL SHEETS	SHEET NO.	
ct:\pw\work\VPWIDOT\WOODSHANKRL\dms91693	0366940-detaila.dgn	DRAWN - RON WOODSHANK	REVISED -			55	VARIOUS		13	4	
	PLOT SCALE = 1/8" = 1' / IN.	CHECKED -	REVISED -			* LIVINGSTON AND GRUNDY		CONTRACT NO. 66940			
	PLOT DATE = Mar 31, 2009 - 11:18:36 AM	DATE -	REVISED -			ILLINOIS					
				SCALE: _____ SHEET NO. 1 OF 2 SHEETS STA. _____ TO STA. _____							

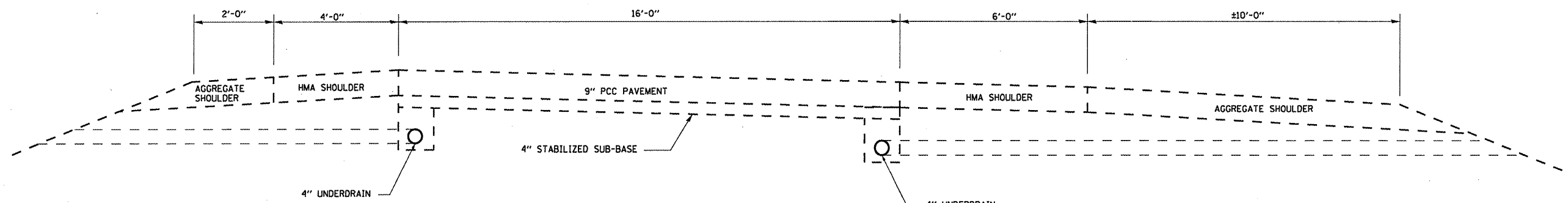

**EXISTING TYPICAL SECTION  
RAMP H**

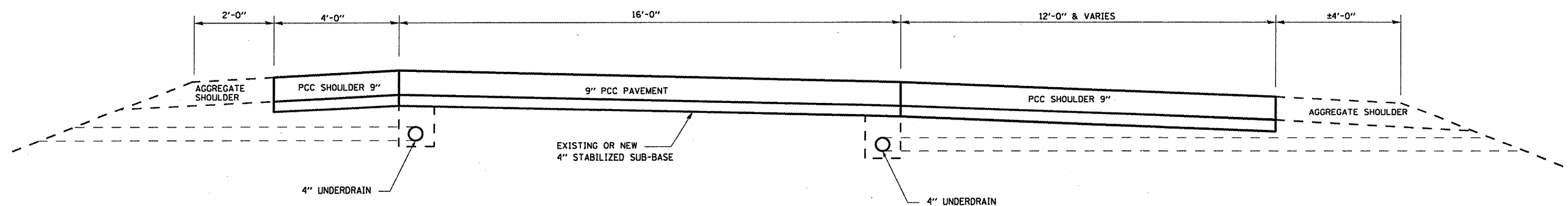

**PROPOSED TYPICAL SECTION  
RAMP H**

FILE NAME =	USER NAME = woodshankr1	DESIGNED - RON WOODSHANK	REVISED -
c:\pwork\pwork\WOODSHANKR1\dms91693	0366940-details.dgn	DRAWN - RON WOODSHANK	REVISED -
	PLOT SCALE = 100.0000' / IN.	CHECKED -	REVISED -
	PLOT DATE = Mar 31, 2009 - 11:18:40 AM	DATE -	REVISED -

**STATE OF ILLINOIS  
DEPARTMENT OF TRANSPORTATION**

**TYPICAL SECTIONS  
RAMP H AT IL 47**

SCALE: _____	SHEET NO. 2 OF 2 SHEETS	STA. _____ TO STA. _____	F.A.I. RTE. 55	SECTION VARIOUS	COUNTY *	TOTAL SHEETS 13	SHEET NO. 5
						* LIVINGSTON AND GRUNDY CONTRACT NO. 66940	
						ILLINOIS	

### SCHEDULE - NBL CLASS A PATCHING 14"

LOCATION BY MILE MARKER	PASSING LANE							DRIVING LANE					REMARKS			
	CLASS A PATCHING			PATCH REINF.	PAV'T FABRIC	SAW CUTS	TIE BARS	CLASS A PATCHING			PATCH REINF.	PAV'T FABRIC		SAW CUTS	TIE BARS	
	TYPE II	TYPE III	TYPE IV					TYPE II	TYPE III	TYPE IV						
SQ YD	SQ YD	SQ YD	SQ YD	SQ YD	FOOT	EACH	SQ YD	SQ YD	SQ YD	SQ YD	SQ YD	FOOT	EACH			
187.70								8				8	8	66		PROJECT BEGIN, McCLEAN CO. LINE  IL RTE 116 INTERCHANGE  IL RTE 23 INTERCHANGE    ODELL INTERCHANGE  MAZON RIVER  BEGIN CONCRETE SECTION
195.30																
196.40																
196.90	8			8	8	66										
197.00								13				13	13	78		
200.20																
202.20								8				8	8	66		
202.50								8				8	8	66		
202.70								8				8	8	66		
203.57								8				8	8	66		
203.58								8				8	8	66		
206.20	8			8	8	66										
207.90								8				8	8	66		
208.70																
210.50	8			8	8	66		8				8	8	66		
213.15																
214.90	8			8	8	66										
214.95										27				108	10	
215.00										27				108	10	
<b>TOTALS</b>	<b>32</b>			<b>32</b>	<b>32</b>	<b>264</b>		<b>77</b>		<b>53</b>		<b>131</b>	<b>77</b>	<b>822</b>	<b>20</b>	

### SCHEDULE - SBL CLASS A PATCHING 14"

LOCATION BY MILE MARKER	PASSING LANE							DRIVING LANE					REMARKS			
	CLASS A PATCHING			PATCH REINF.	PAV'T FABRIC	SAW CUTS	TIE BARS	CLASS A PATCHING			PATCH REINF.	PAV'T FABRIC		SAW CUTS	TIE BARS	
	TYPE II	TYPE III	TYPE IV					TYPE II	TYPE III	TYPE IV						
SQ YD	SQ YD	SQ YD	SQ YD	SQ YD	FOOT	EACH	SQ YD	SQ YD	SQ YD	SQ YD	SQ YD	FOOT	EACH			
218.07								8				8	8	66		PROJECT BEGIN, GRUNDY COUNTY LINE      IL RTE 17 INTERCHANGE      BEGIN HMA OVERLAY SECTION
217.97																
217.95	8			8	8	66										
217.67								8				8	8	66		
217.62	8			8	8	66										
217.57								13				13	13	78		
217.55								8				8	8	66		
216.97																
215.97								8				8	8	66		
215.42	13			13	13	78										
215.41								8				8	8	66		
215.37	8			8	8	66										
215.32								13				13	13	78		
215.22	8			8	8	66			20			20	20	93		
215.00																
<b>TOTALS</b>	<b>45</b>			<b>45</b>	<b>45</b>	<b>342</b>		<b>67</b>	<b>20</b>			<b>87</b>	<b>87</b>	<b>579</b>		

SCHEDULE - NBL CLASS A PATCHING 9"													
LOCATION BY MILE MARKER	PASSING LANE						DRIVING LANE						REMARKS
	CLASS A PATCHING			PATCH REINF.	SAW CUTS FOOT	TIE BARS EACH	CLASS A PATCHING			PATCH REINF.	SAW CUTS FOOT	TIE BARS EACH	
	TYPE II SQ YD	TYPE III SQ YD	TYPE IV SQ YD				TYPE II SQ YD	TYPE III SQ YD	TYPE IV SQ YD				
215.00							8				8	60	
215.05							8				8	60	
216.70													
217.00							13				13	68	
217.80													
TOTALS							29				29	188	

IL RTE 17 INTERCHANGE  
END PROJECT, GRUNDY COUNTY LINE

SCHEDULE - SBL CLASS A PATCHING 9"													
LOCATION BY MILE MARKER	PASSING LANE						DRIVING LANE						REMARKS
	CLASS A PATCHING			PATCH REINF.	SAW CUTS FOOT	TIE BARS EACH	CLASS A PATCHING			PATCH REINF.	SAW CUTS FOOT	TIE BARS EACH	
	TYPE II SQ YD	TYPE III SQ YD	TYPE IV SQ YD				TYPE II SQ YD	TYPE III SQ YD	TYPE IV SQ YD				
215.00													
214.97	8			8	66		8				8	66	
213.77									27		27	108	10
213.57													
213.37	8			8	66		8				8	66	
210.27	8			8	60		8				8	60	
210.17	8			8	60		8				8	60	
209.27							8				8		
209.17							8				8		
209.07	8			8	60		8				8		
209.00													
207.87	8			8	60								
207.77							8				8		
207.72	8			8	60								
207.70							8				8		
204.17							8				8		
203.47								20			20		
203.42							13				13		
202.87							8				8		
202.07								16			16		
200.67							8				8		
200.57													
199.87								16			16		
199.47							8				8		
196.67													
192.47							8				8		
187.70													
TOTALS	56			56	432		125	52	27		204	360	10

BEGIN HMA OVERLAY SECTION  
MAZON RIVER  
ODELL INTERCHANGE  
IL RTE 23 INTERCHANGE  
IL RTE 116 INTERCHANGE  
END PROJECT McCLEAN COUNTY LINE

SCHEDULE - NBL PAVEMENT MARKING				
LOCATION	POLYUREA PAVEMENT MARKING TYPE 1, LINE 4"		POLYUREA PAVEMENT MARKING TYPE 1, LINE 6"	REMARKS
	YELLOW	WHITE	WHITE	
MILE				
187.70		6	2	PROJECT BEGIN, McCLEAN CO. LINE
195.30		6	2	
196.40				IL RTE 116 INTERCHANGE
196.90	6		2	
197.00		10	3	
200.20				IL RTE 23 INTERCHANGE
202.20	6		2	
202.50		6	2	
202.70		6	2	
203.57		6	2	
203.58		6	2	
206.20	6		2	
207.90		6	2	
208.70				ODELL INTERCHANGE
210.50	6	6	2	
213.15				MAZON RIVER
214.90	6		2	
214.95		20	5	
215.00		20	5	
215.00		6	2	BEGIN CONCRETE PAVEMENT SECTION
215.05		6	2	
216.70				IL RTE 17 INTERCHANGE
217.00		10	3	
217.80				END PROJECT, GRUNDY COUNTY LINE
TOTAL		150	44	

SCHEDULE - SBL PAVEMENT MARKING				
LOCATION	POLYUREA PAVEMENT MARKING TYPE 1, LINE 4"		POLYUREA PAVEMENT MARKING TYPE 1, LINE 6"	REMARKS
	YELLOW	WHITE	WHITE	
MILE				
218.07		6	2	PROJECT BEGIN, GRUNDY COUNTY LINE
217.97		6	2	
217.95	6		2	
217.67		6	2	
217.62	6		2	
217.57		10	3	
217.55		6	2	
216.97				IL RTE 17 INTERCHANGE
215.97		6	2	
215.42	10		3	
215.41		6	2	
215.37	6		2	
215.32		10	3	
215.22	6	15	4	
215.00				BEGIN HMA OVERLAY SECTION
214.97	6	6	2	
213.77		20	5	
213.57				MAZON RIVER
213.37	6	6	2	
210.27	6	6	2	
210.17	6	6	2	
209.27		6	2	
209.17		6	2	
209.07	6	6	2	
209.00				ODELL INTERCHANGE
207.87	6		2	
207.77		6	2	
207.72	6		2	
207.70		6	2	
204.17		6	2	
203.47		15	4	
203.42		10	3	
202.87		6	2	
202.07		12	3	
200.67		6	2	
200.57				IL RTE 23 INTERCHANGE
199.87		12	3	
199.47		6	2	
196.67				IL RTE 116 INTERCHANGE
192.47		6	2	
187.70				END PROJECT McCLEAN COUNTY LINE
TOTAL		300	81	

SCHEDULE - IL 47 RAMP PAVEMENT MARKING			
LOCATION	POLYUREA PAVEMENT MARKING TYPE 1, LINE 4"		REMARKS
	YELLOW	WHITE	
MILE			
TOP OF RAMP	120	182	IL 47 TO I-55 SB RAMP
TOTAL		302	



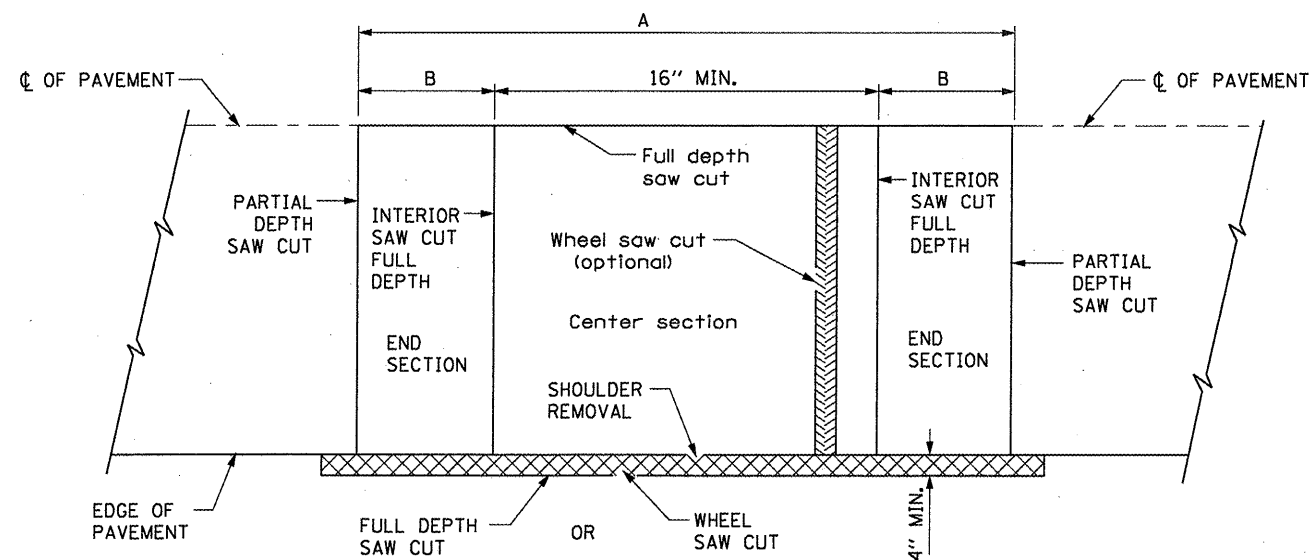

**EXISTING PAVEMENT SAWING DETAIL**  
(AGAINST BITUMINOUS SHOULDER)

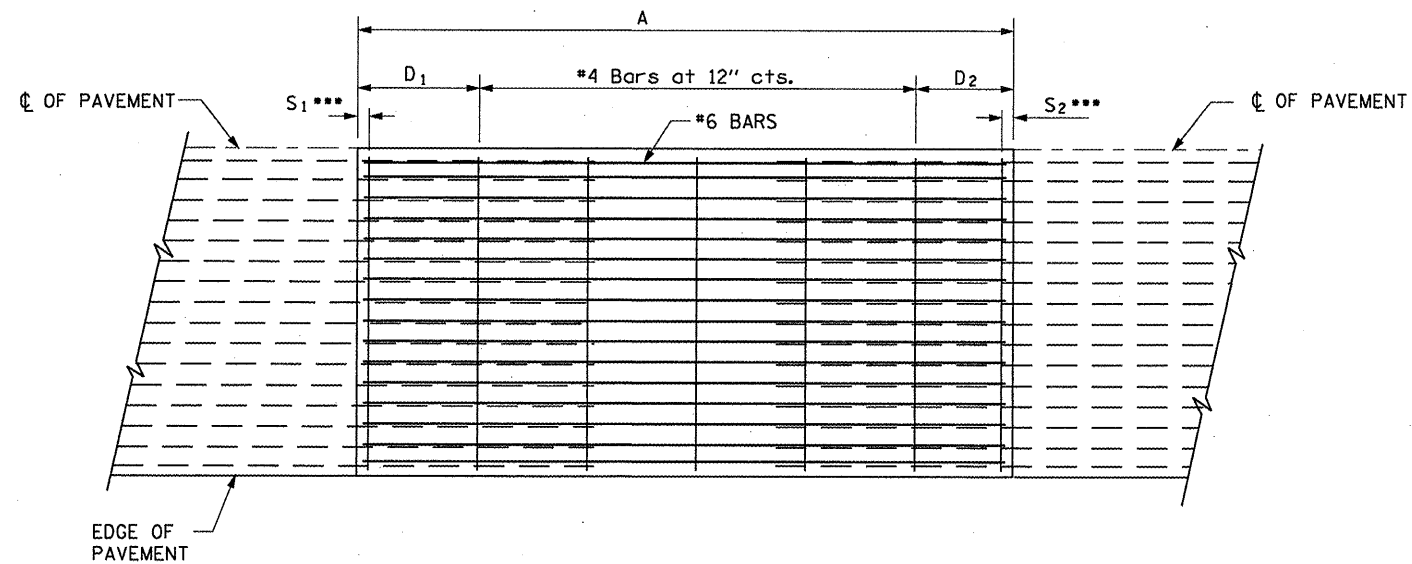

**PROPOSED PAVEMENT DETAIL**  
(AGAINST CONCRETE SHOULDER)

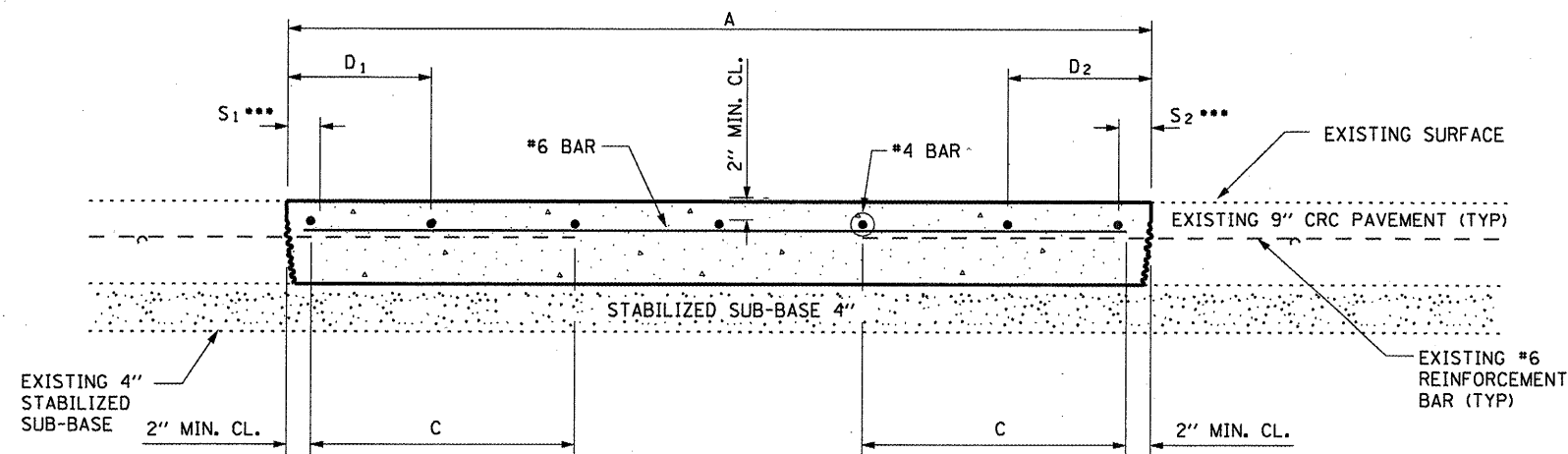

**PROPOSED CLASS A PATCHING DETAIL**

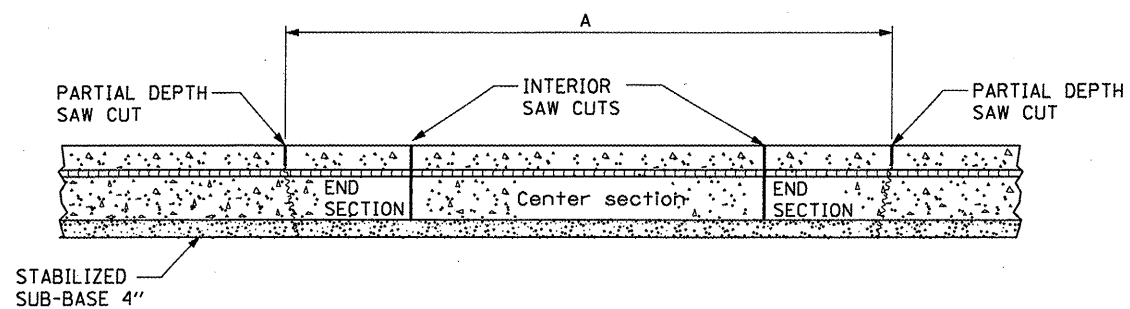

**REMOVAL DETAIL**

EXISTING LONGITUDINAL REINFORCEMENT BARS	A (min.)	B (min.)	C (min.)
No. 6	6'-0"	21"	19"

**NOTES:**

- EVERY 3<sup>rd</sup> INTERSECTION MUST BE TIED
- LAP NEW REINFORCEMENT WITH EXISTING LONGITUDINAL REINFORCEMENT
- VARIABLES: WHERE S<sub>1</sub> AND S<sub>2</sub> ARE 2 1/2" MIN. AND 12" MAX. D<sub>1</sub> = 2(S<sub>1</sub>) AND D<sub>2</sub> = 2(S<sub>2</sub>)

FILE NAME =	USER NAME = woodshankr1	DESIGNED - RON WOODSHANK	REVISED -
c:\pwork\pwork\woodshankr1\dms91693\366940-details.dgn		DRAWN - RON WOODSHANK	REVISED -
PLOT SCALE = 100.0000' / IN.		CHECKED -	REVISED -
PLOT DATE = Mar 31, 2009 - 01:41:21 PM		DATE -	REVISED -

**STATE OF ILLINOIS**  
**DEPARTMENT OF TRANSPORTATION**

**CLASS A PATCHING DETAILS**  
**WITHOUT HMA OVERLAY**

SCALE: SHEET NO. 1 OF 2 SHEETS STA. TO STA.

F.A.I. RTE.	SECTION	COUNTY	TOTAL SHEETS	SHEET NO.
55	VARIOUS		13	9
* LIVINGSTON AND GRUNDY			CONTRACT NO. 66940	
ILLINOIS				

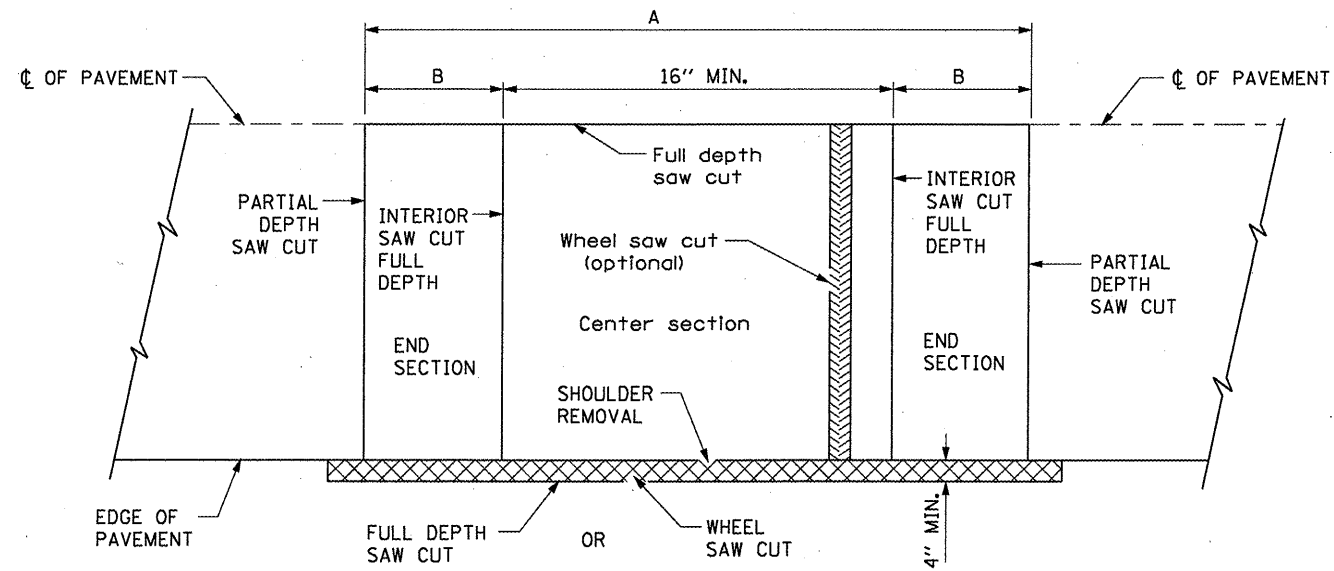

**EXISTING PAVEMENT SAWING DETAIL**  
(AGAINST BITUMINOUS SHOULDER)

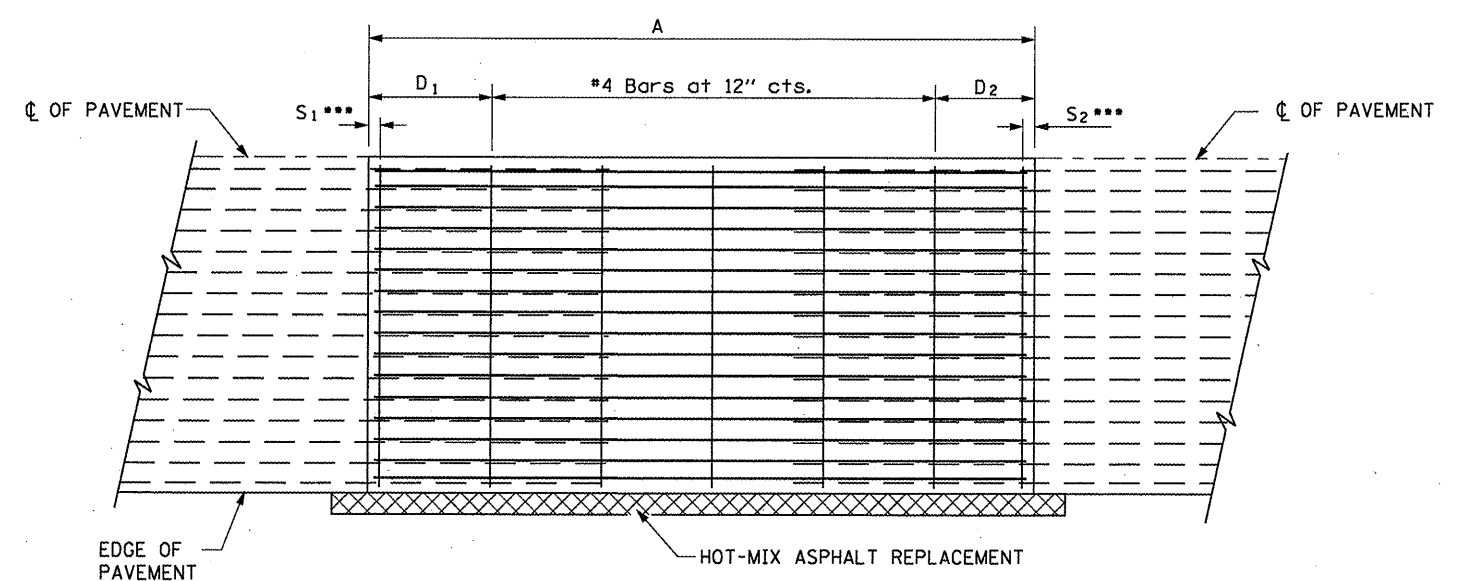

**PROPOSED PAVEMENT DETAIL**  
(AGAINST BITUMINOUS SHOULDER)

EXISTING LONGITUDINAL REINFORCEMENT BARS	A (min.)	B (min.)	C (min.)
No. 6	6'-0"	24"	19"

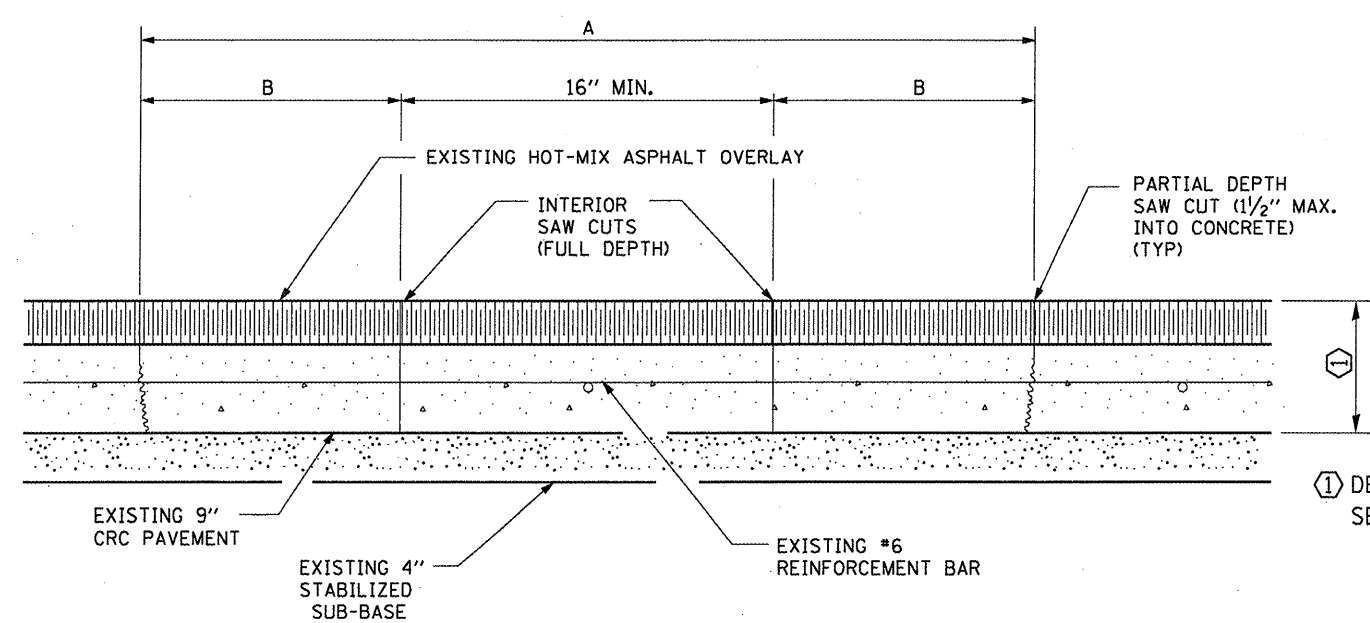

**EXISTING PAVEMENT SAW CUTTING DETAIL**

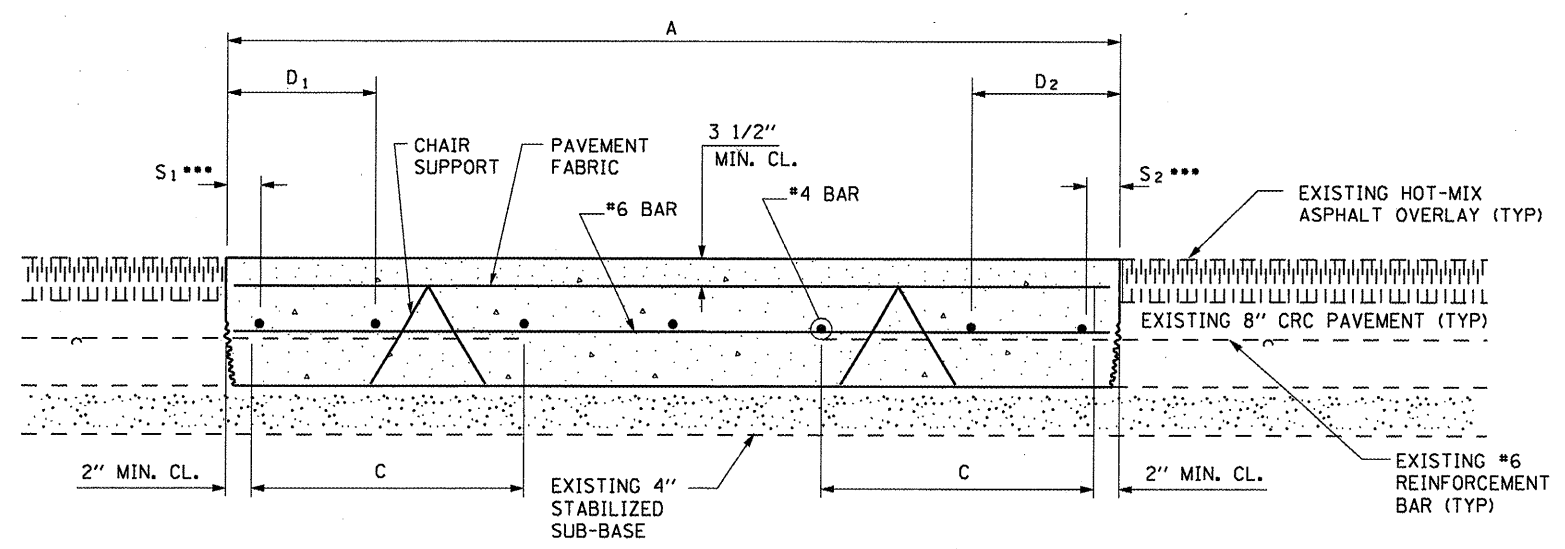

**PROPOSED CLASS A PATCHING DETAIL**

① DEPTH VARIES  
SEE TYPICAL SECTIONS

- NOTES:**
- EVERY 3<sup>rd</sup> INTERSECTION MUST BE TIED
  - LAP NEW REINFORCEMENT WITH EXISTING LONGITUDINAL REINFORCEMENT
  - VARIABLES: WHERE S<sub>1</sub> AND S<sub>2</sub> ARE 2 1/2" MIN. AND 12" MAX. D<sub>1</sub> = 2(S<sub>1</sub>) AND D<sub>2</sub> = 2(S<sub>2</sub>)

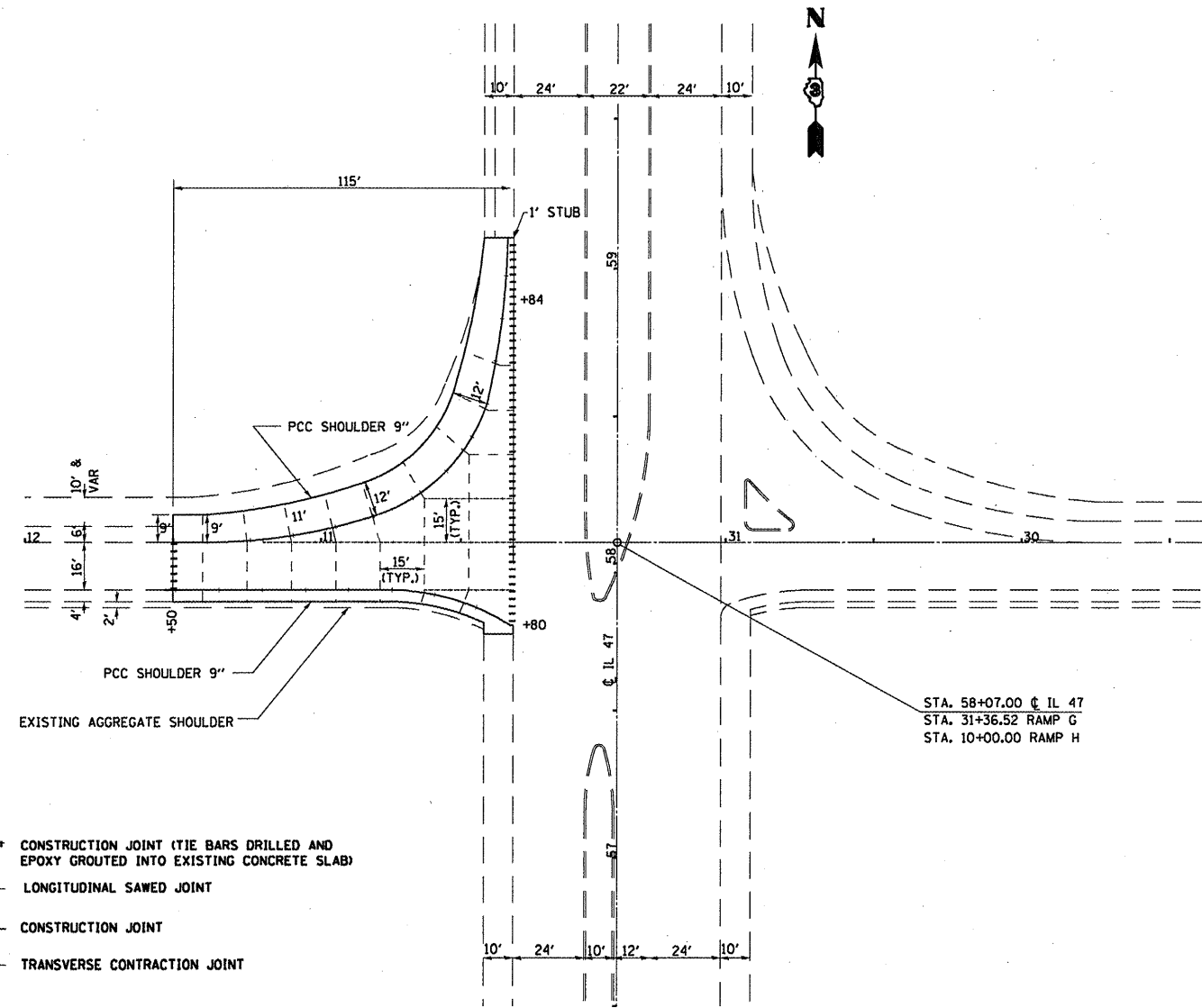
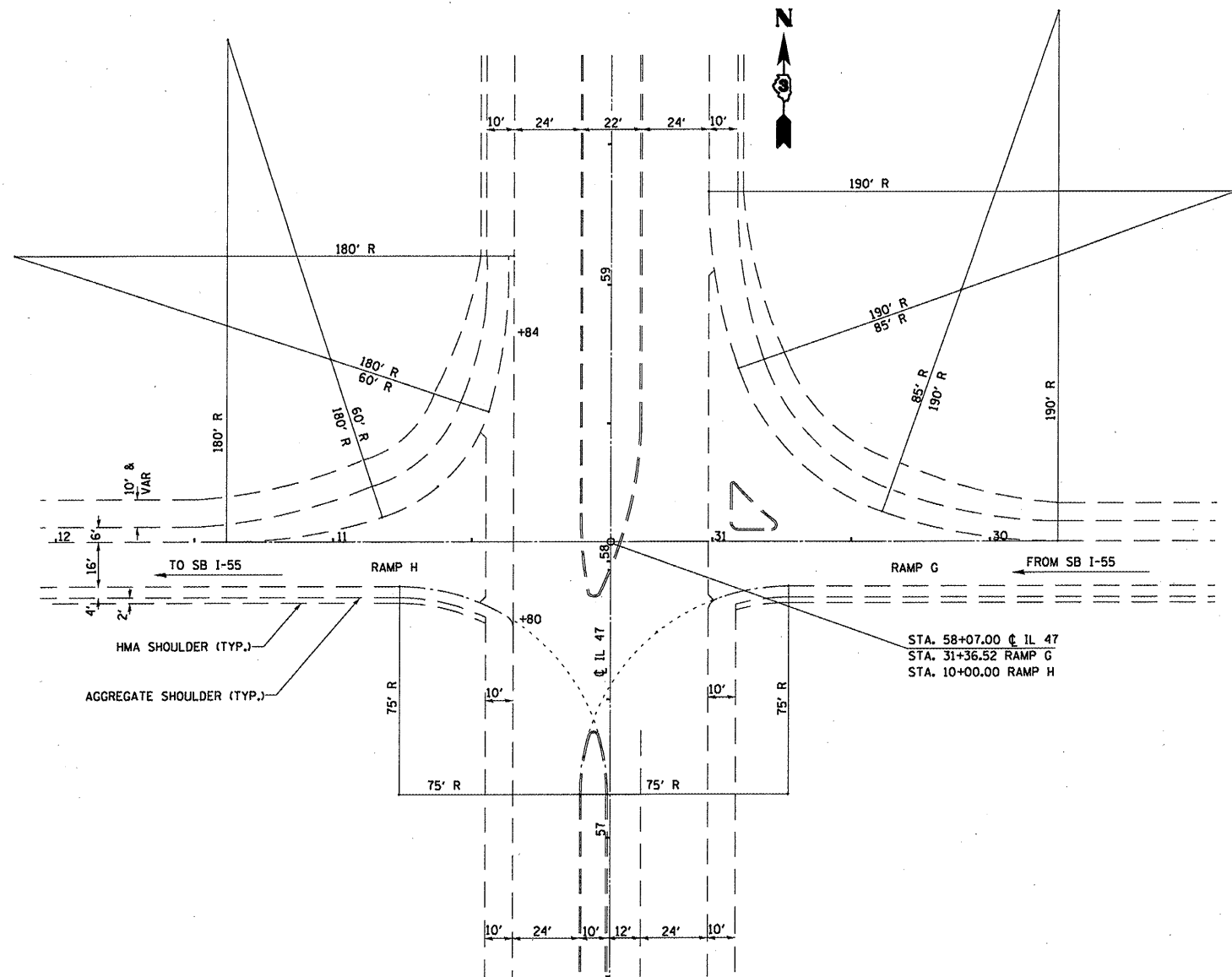

- \*\*\*\*\* CONSTRUCTION JOINT (TIE BARS DRILLED AND EPOXY GROUTED INTO EXISTING CONCRETE SLAB)
- LONGITUDINAL SAWED JOINT
- CONSTRUCTION JOINT
- TRANSVERSE CONTRACTION JOINT

**EXISTING PLAN**

**PROPOSED PLAN**

FILE NAME =  
 c:\pwork\pwwid\WOODSHANKRL\dms91693

USER NAME = woodshankr1  
 0366940-deta11.dgn  
 PLOT SCALE = 100.0000' / IN.  
 PLOT DATE = Mar 31, 2009 - 11:20:31 AM

DESIGNED - RON WOODSHANK  
 DRAWN - RON WOODSHANK  
 CHECKED -  
 DATE -

REVISED -  
 REVISED -  
 REVISED -  
 REVISED -

**STATE OF ILLINOIS  
 DEPARTMENT OF TRANSPORTATION**

**PAVEMENT RECONSTRUCTION DETAILS**

SCALE: SHEET NO. 1 OF 1 SHEETS STA. TO STA.

F.A.I. RTE.	SECTION	COUNTY	TOTAL SHEETS	SHEET NO.
55	VARIOUS		13	11
* LIVINGSTON AND GRUNDY			CONTRACT NO. 66940	
ILLINOIS				

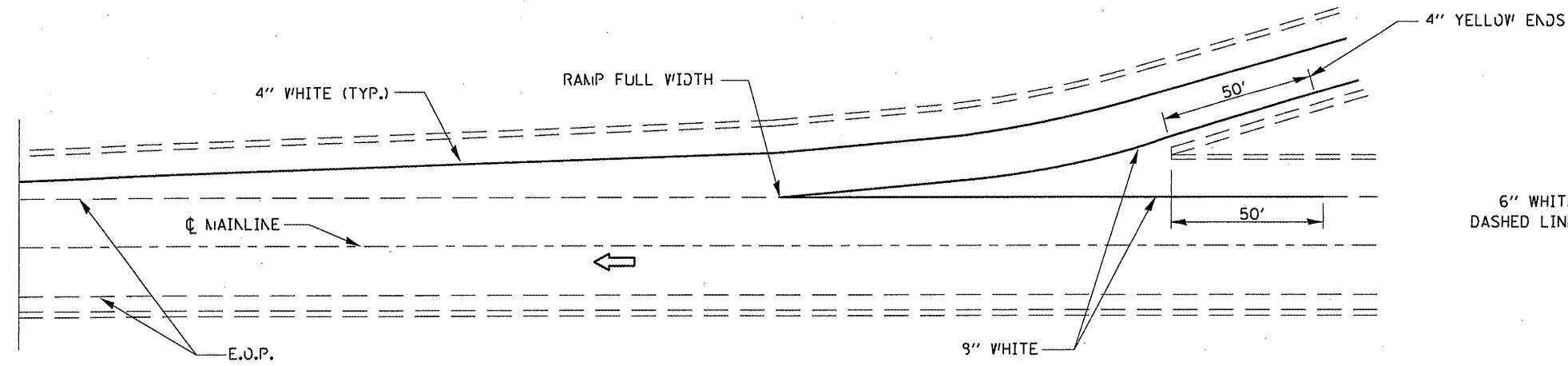

**TYPICAL PAVEMENT MARKING FOR ENTRANCE RAMP TERMINALS**

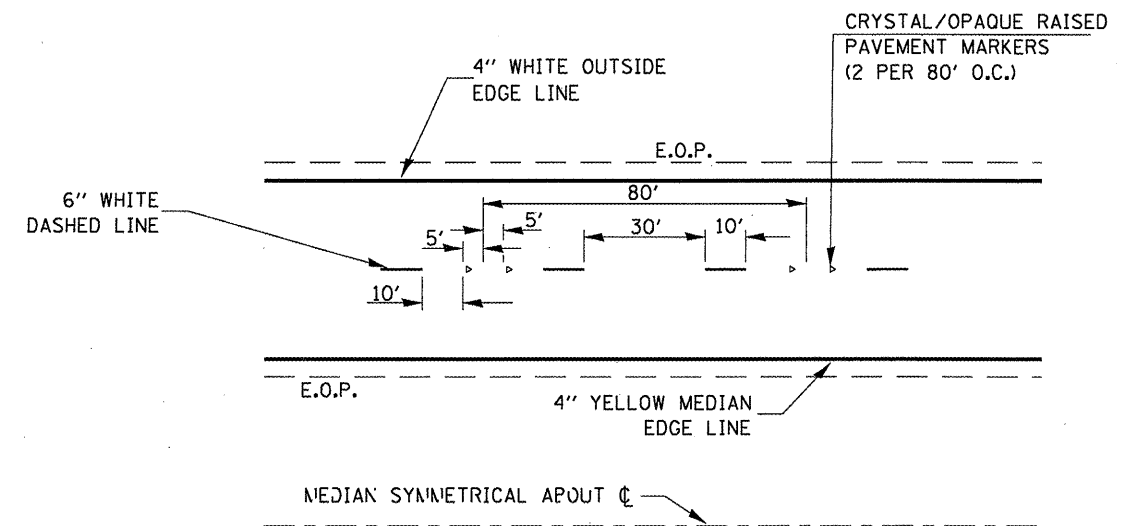

**TYPICAL PAVEMENT MARKINGS**

**NOTE:**  
 WHEN PATCHING IS ADJACENT TO 8" PAVEMENT MARKING LINE  
 THE 8" STRIP SHALL BE REPLACED WITH TWO 4" LINES.  
 RAISED REFLECTIVE PAVEMENT MARKERS THAT FALL WITHIN  
 PATCHED BOUNDARIES WILL NOT BE REPLACED.

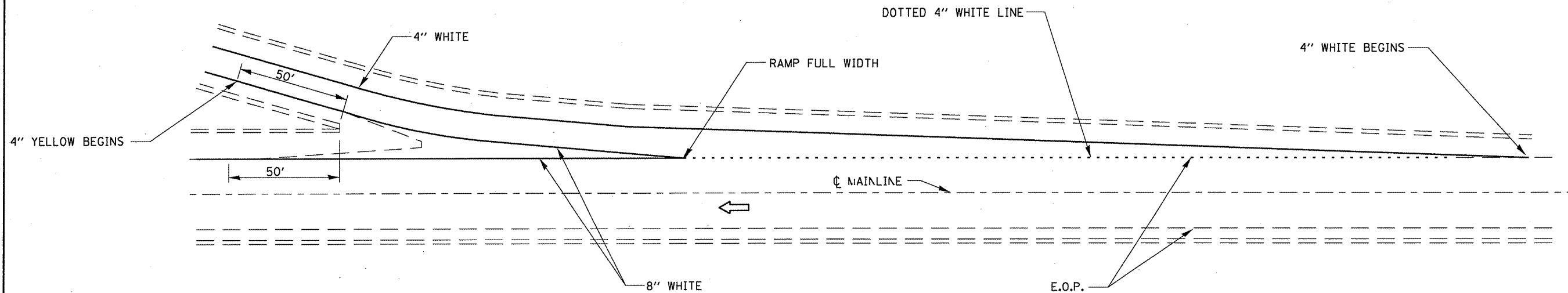

**TYPICAL PAVEMENT MARKINGS FOR EXIT RAMP TERMINALS**

FILE NAME =	USER NAME = woodshankr1	DESIGNED - RON WOODSHANK	REVISED -
c:\pwwork\PWIDOT\WOODSHANKRL\dms91693	0366940-details.dgn	DRAWN - RON WOODSHANK	REVISED -
PLOT SCALE = 1/8" = 1' / IN.	CHECKED -	REVISOR -	REVISED -
PLOT DATE = Mar 31, 2009 - 11:20:37 AM	DATE -	REVISOR -	REVISED -

**STATE OF ILLINOIS  
 DEPARTMENT OF TRANSPORTATION**

**TYPICAL PAVEMENT MARKING**

SCALE: \_\_\_\_\_ SHEET NO. 1 OF 1 SHEETS STA. \_\_\_\_\_ TO STA. \_\_\_\_\_

F.A.I. RTE.	SECTION	COUNTY	TOTAL SHEETS	SHEET NO.
55	VARIOUS	*	13	12
* LIVINGSTON AND GRUNDY ILLINOIS			CONTRACT NO. 66940	

# GRUNDY

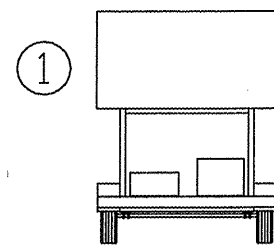

①

17

SBI 47

FAI 55

① THE MESSAGE BOARD SHALL BE LOCATED 1500 FEET IN ADVANCE OF THE OFF RAMP. TO BE PLACED ADJACENT TO THE SOUTHBOUND LANE SHOULDER.

THE MESSAGE BOARD SHALL BE USED TO DISPLAY STATUS OF THE RAMP CLOSURE. THE PRIMARY MESSAGE SHALL BE:  
"RAMP CLOSED AHEAD"  
"USE OLD ROUTE 66".

17

M1-1 24"x24"



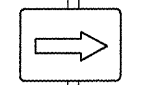

M6-1 21"x15"



DWIGHT

17

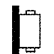
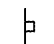
FAI 55

-  PORTABLE CHANGEABLE MESSAGE SIGN
-  SIGN
-  TYPE II BARRICADE, DRUM, OR VERTICAL BARRICADE WITH MONODIRECTIONAL FLASHING LIGHT

# LIVINGSTON

FILE NAME =	USER NAME = woodshankr1	DESIGNED - RON WOODSHANK	REVISED -	STATE OF ILLINOIS DEPARTMENT OF TRANSPORTATION	RAMP CLOSURE SIGNING	F.A.I. RTE.	SECTION	COUNTY	TOTAL SHEETS	SHEET NO.
cd:\pvt_work\PIWIDOT\WOODSHANKRL\dms91693	D366940-details.dgn	DRAWN - RON WOODSHANK	REVISED -			55	VARIOUS	*	13	13
PLOT SCALE = 100.0000' / IN.	CHECKED -	REVISED -	REVISED -			* LIVINGSTON AND GRUNDY		CONTRACT NO. 66940		
PLOT DATE = Mar 31, 2009 - 11:20:42 AM	DATE -	REVISED -	REVISED -			ILLINOIS				
				SCALE: _____	SHEET NO. 1 OF 1 SHEETS	STA. _____ TO STA. _____				