

THIS LOCATION IS CURRENTLY PART OF AN IDOT TRAFFIC SIGNAL MODERNIZATION PROJECT. THIS LOCATION IS ALSO CURRENTLY PART OF A CITY OF AURORA TRAFFIC SIGNAL INTERCONNECT PROJECT. COORDINATION WITH THOSE CONTRACTS WILL BE REQUIRED.

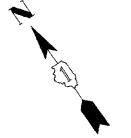
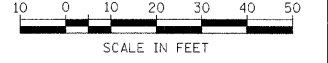

- NOTES:
1. THE WIRELESS ANTENNA SHALL BE MOUNTED ON THE WESTBOUND MAST ARM, 3' SOUTH OF THE OUTER SIGNAL HEAD OR AS DIRECTED BY THE ENGINEER (SEE MOUNTING DETAIL).
  2. THE PAN/TILT/ZOOM CAMERA SHALL BE MOUNTED ON THE COMBINATION MAST ARM POLE IN THE NORTHEAST CORNER BETWEEN THE MAST AND LUMINAIRE ARMS.

**TRAFFIC SIGNAL LEGEND**

	PROPOSED	EXISTING
CONTROLLER		
SERVICE INSTALLATION		
SIGNAL HEAD		
SIGNAL HEAD WITH BACKPLATE		
SIGNAL HEAD, PEDESTRIAN		
SIGNAL POST		
MAST ARM ASSEMBLY AND POLE, STEEL		
MAST ARM ASSEMBLY AND POLE, ALUMINUM		
COMBINATION MAST ARM ASSEMBLY AND POLE, STEEL WITH LUMINAIRE		
UNIT DUCT	UD	
COMMON TRENCH	CT	
HANDHOLE		
HEAVY DUTY HANDHOLE		
DOUBLE HANDHOLE		
G.S. CONDUIT IN TRENCH (T) OR PUSHED (P)		
PEDESTRIAN PUSHBUTTON DETECTOR		
DETECTOR LOOP		
CAST IRON JUNCTION BOX		
EMERGENCY VEHICLE LIGHT DETECTOR		
CONFIRMATION BEACON		
SIGNAL HEAD OPTICALLY PROGRAMMED		
CONDUIT SPLICE		
WOOD POLE		
RACEWAY FOR MAGNETIC DETECTOR, TYPE I OR TYPE II		
VEHICLE DETECTOR, NON COMPENSATED MAGNETIC TYPE		
RAILROAD CONTROL CABINET		
TELEPHONE CONNECTION		
ILLUMINATED SIGN "NO LEFT TURN"		
ILLUMINATED SIGN "NO RIGHT TURN"		
UNINTERRUPTABLE POWER SUPPLY	UPS	
WIRELESS ANTENNA		
VIDEO DETECTION CAMERA		
VIDEO DETECTION AREA		
PAN/TILT/ZOOM CAMERA		

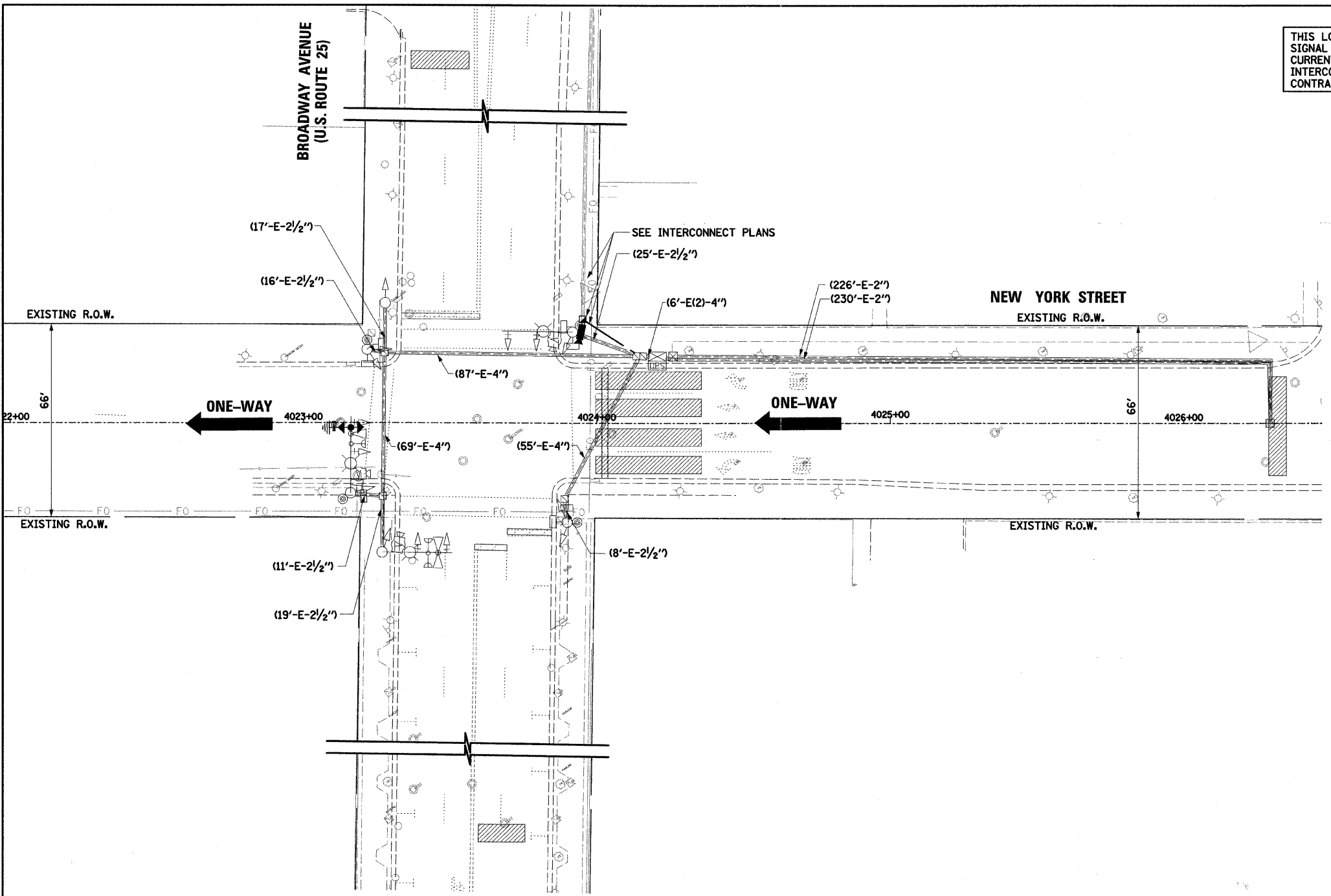

PLAN

DATE	
BY	
DESIGNED	
DRAWN	
CHECKED	
IN CHARGE	
NOTED	
FILE NAME	

PROFILE

DATE	
BY	
DESIGNED	
DRAWN	
CHECKED	
IN CHARGE	
NOTED	
FILE NAME	