

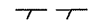

F.A.I. RTE.	SECTION	COUNTY	TOTAL SHEETS	SHEET NO.
90/94		COOK	22	14
STA. 201+70.00		TO STA. 203+00		
FED. ROAD DIST. NO. 1 ILLINOIS FED. AID PROJECT				
• (2021-922 PT1) & 2122-921 PT1) I-1 62986				

LEGEND:

-  AREA REMOVALS
-  LINEAR REMOVALS
-  INLET FILTER

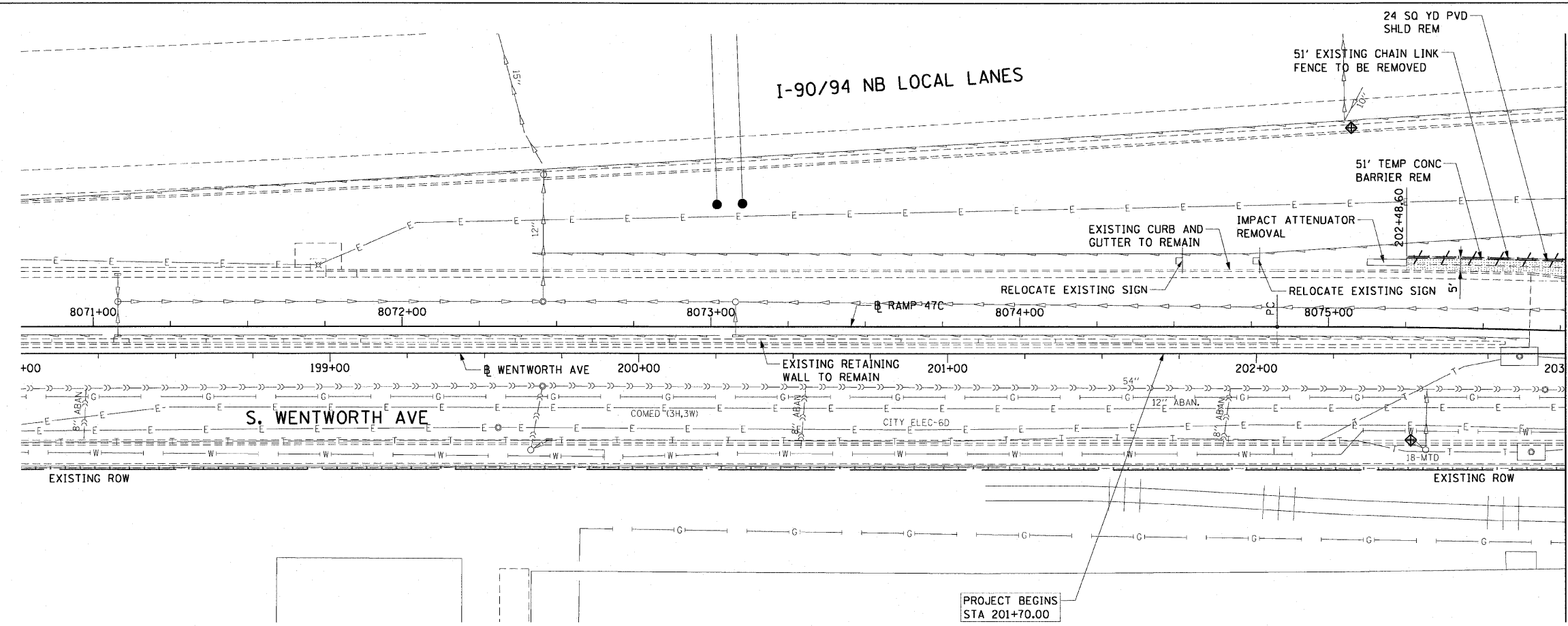

EXISTING CONDITIONS AND REMOVAL
PROPOSED IMPROVEMENTS

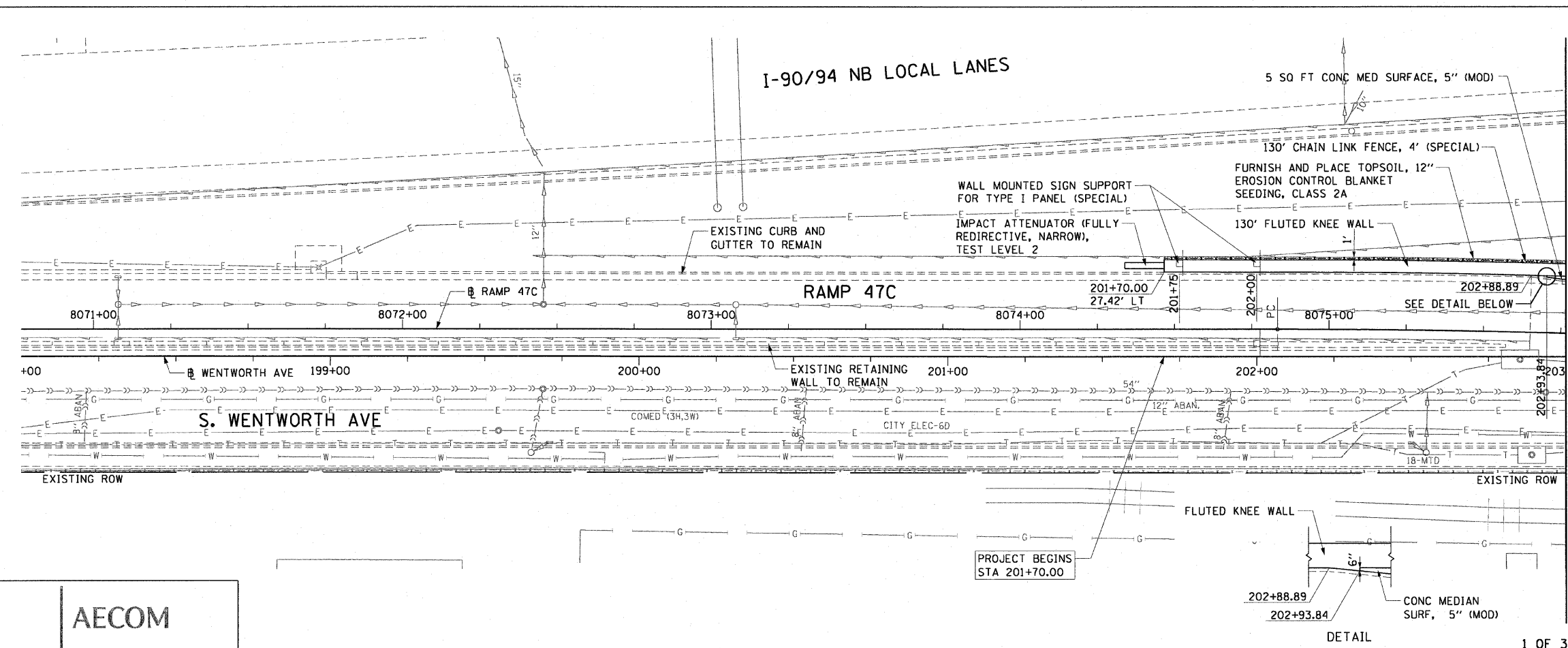

NOTES:

1. SEE STRUCTURAL DETAILS FOR FLUTED KNEE WALL DETAILS.
2. ALL POINT CALLOUTS ARE TAKEN AT THE EDGE OF THE KNEE WALL BASE (SEE BELOW).
3. SEE ROADWAY DETAILS FOR CONCRETE MEDIAN DETAILS.
4. SEE ROADWAY DETAILS FOR WALL MOUNTED SIGN SUPPORT DETAILS.

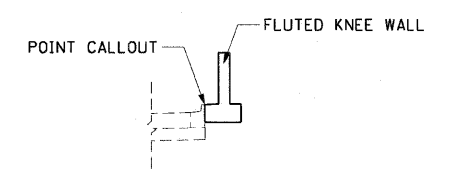

REVISIONS	
NAME	DATE

ILLINOIS DEPARTMENT OF TRANSPORTATION
F.A.I. 90/94 (DAN RYAN EXPRESSWAY)
59TH ST TO 47TH ST (NORTHBOUND KNEE WALLS)

EXISTING AND PROPOSED ROADWAY PLANS
WENTWORTH AVENUE

SCALE: 1"=20'
DATE: JANUARY 14, 2009
DRAWN BY: PHP
CHECKED BY: NJH

AECOM

U:\scgriff\p207\p40466\40466.dwg:ch1\28-knee_wall_1_fence.dwg:contract 29 up2900202a.dwg 1/13/2009 12:08:48 PM