

STATE OF ILLINOIS  
DEPARTMENT OF TRANSPORTATION

**GENERAL NOTES**

The contractor is advised that the existing structure contains members that are in a deteriorated condition with reduced load carrying capacity. It is the contractor's responsibility to account for the condition of the existing structure when developing construction procedures for complete or partial removal, or replacement of the structure. An Existing Structure Information Package is available upon request as noted in the Special Provisions.

Prior to placing equipment on new PPC deck beams, the following shall be done: placement and tightening of transverse tie assemblies, grouting and curing the dowel rods 24 hours minimum and grouting and curing the shear keys.

The top surface of the beams shall be finished according to the IDOT Manual for Fabrication of Precast Prestressed Concrete Products.

Plan dimensions and details relative to existing plans are subject to nominal construction variations. The Contractor shall field verify existing dimensions and details affecting new construction and make necessary approved adjustments prior to construction or ordering of materials. Such variations shall not be cause for additional compensation for a change in scope of the work, however, the Contractor will be paid for the quantity actually furnished at the unit price bid for the work.

Temporary concrete barrier shall only be anchored into the overlay and not into the PPC deck beams.

Existing reinforcement bars extending into the removal area shall be cleaned, straightened and incorporated into the new construction. Any reinforcement bars that are damaged during concrete removal shall be replaced with an approved bar splicer or anchorage system. Cost included with Concrete Removal.

Reinforcement bars shall conform to the requirements of ASTM A 706 Gr 60 (IL Modified). See Special Provisions.

Reinforcement bars designated (E) shall be epoxy coated.

Any damage done to the bridge during beam removal shall be repaired by the contractor. Cost to be included in the cost of Removal of Existing PPC Deck Beams.

The deck surface shall have its final finish lined according to Article 420.09(e)(1) of the Standard Specifications. Cost included with Concrete Wearing Surface.

The Contractor shall submit Structural Assessment Report(s) as required for the Contractor's Means and Methods of Construction. See Special Provisions.

Current Ratings on File for Existing Structure

Inventory: HS 12.5

Operating: HS 27.8

Live Load Restrictions: No

Inventory and Operating Ratings and Live Load Restrictions are provided for information only. Inventory and Operating Ratings are based on HS loading and configuration. Live Load Restrictions are based on Illinois legal loads and configurations. The Ratings and Live Load restrictions are not necessarily representative of capacities to support the Contractor's equipment



**ELEVATION**

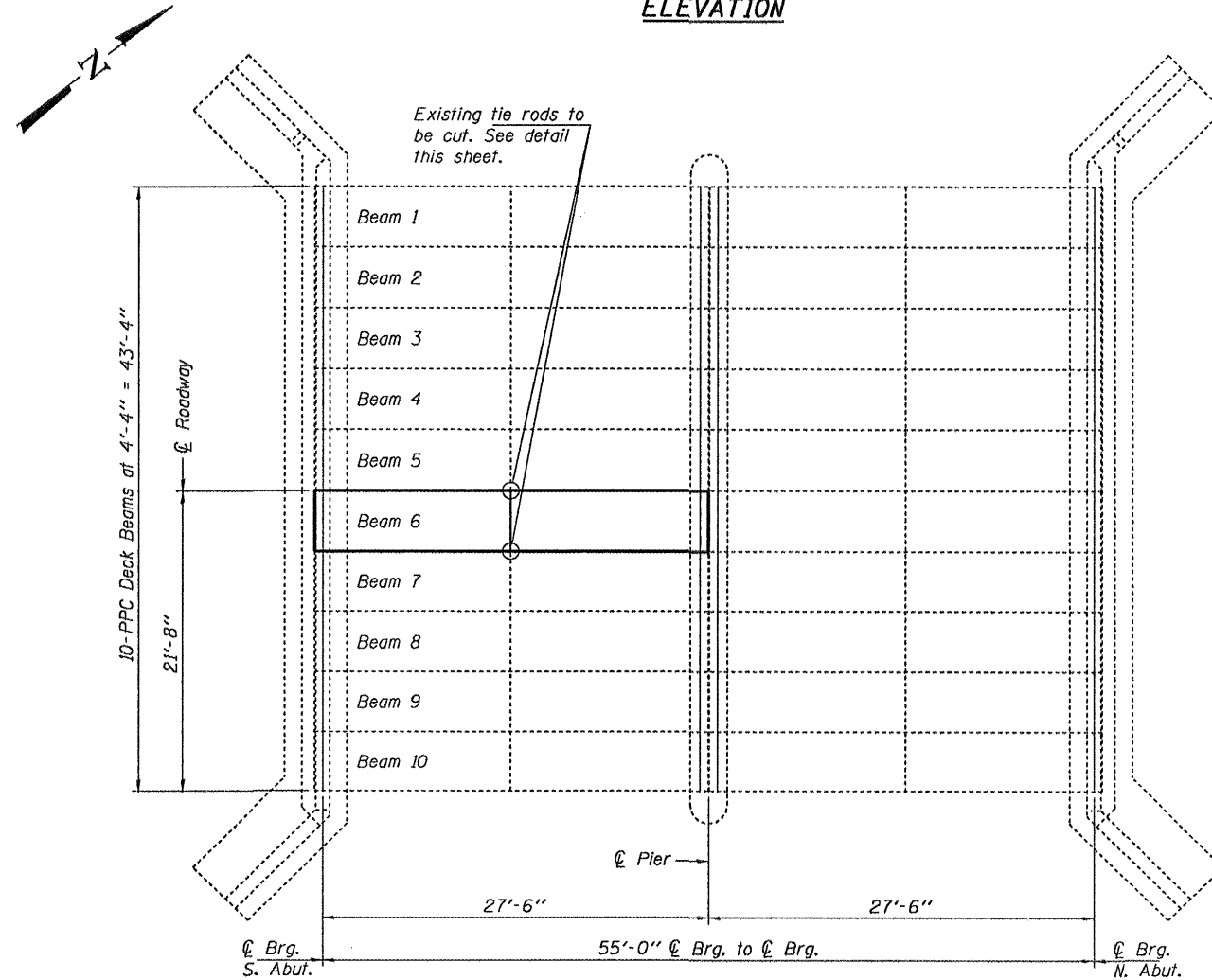

**PLAN**

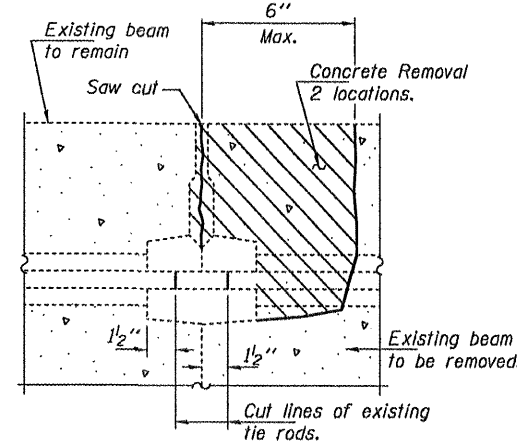

**BEAM REMOVAL DETAIL AT TRANSVERSE TIES**

**DESIGN STRESSES**

**FIELD UNITS**  
f'c = 3,500 psi  
fy = 60,000 psi (Reinforcement)

**PRECAST PRESTRESSED UNITS**  
f'c = 6,000 psi  
f'ci = 5,000 psi  
f's = 270,000 psi (1/2" low lax strands)  
f'si = 201,960 psi (1/2" low lax strands)

**TOTAL BILL OF MATERIAL**

ITEM	UNIT	QUANTITY
Removal of Existing PPC Deck Beams	Sq. Ft.	121.5
Precast Prestressed Concrete Deck Beams (11" Depth)	Sq. Ft.	119.2
Concrete Removal	Cu. Yd.	0.4
Concrete Wearing Surface	Sq. Yd.	17.0
Mechanical Splicers	Each	58
Reinforcement Bars Epoxy Coated	Pound	310

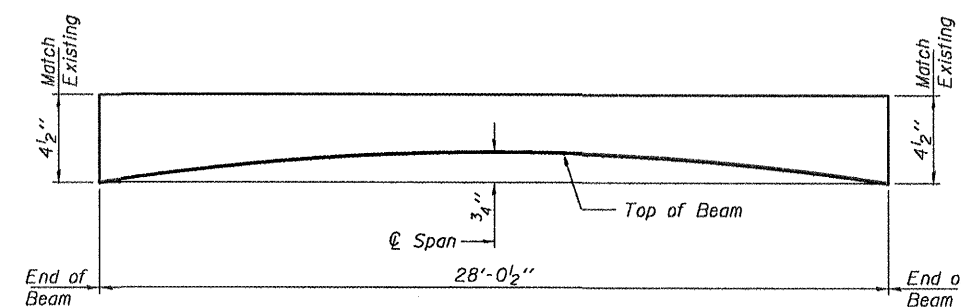

**ANTICIPATED INITIAL CAMBER DIAGRAM**

**PLAN & ELEVATION  
IL ROUTE 171 OVER  
LONG RUN CREEK  
SN 099-0080**

DESIGNED	[Signature]
CHECKED	[Signature]
DRAWN	Kyle M. Steffen
CHECKED	AIB [Signature]

EXAMINED	[Signature]	MAY 1, 2009
PASSED	[Signature]	



Expires: November 30, 2010

SHEET NO. 1  3 SHEETS	F.A.P. RTE. 577	SECTION -	COUNTY WILL	TOTAL SHEETS 13	SHEET NO. 5
	CONTRACT NO. 60G38			FED. ROAD DIST. NO. ILLINOIS FED. AID PROJECT	