

SCOPE OF WORK

1. Saw Cut and Remove Existing Pier Stem at a Height of 21'-10 1/2"± as Indicated on Partial Plan.
2. Reconstruct Pier Nose, See Sht. S2 for Details.

GENERAL NOTES:

Plan Dimensions and Details Relative to Existing Plans are Subject to Nominal Construction Variations. The Contractor Shall Field Verify Existing Dimensions and Details Affecting new Construction and make Necessary Approved Adjustments Prior to Construction or Ordering of Materials. Such Variations Shall not be Cause for Additional Compensation for a Change in Scope of the work, However, the Contractor will be paid for the Quantity Actually Furnished at the Unit Price Bid for the Work.

Saw Cutting Prior to any Removal of Items Noted on the Plan or as Directed by the Engineer Shall be Considered Included in the cost of the Items Being Removed.

Reinforcement Bars shall Conform to the Requirements of ASTM A-706, Grade 60. See Special Provisions.

Reinforcement Bars Designated (E) Shall be Epoxy Coated.

* Remove the Pier From Top El. 619.87± to El. 598.00±

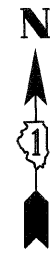
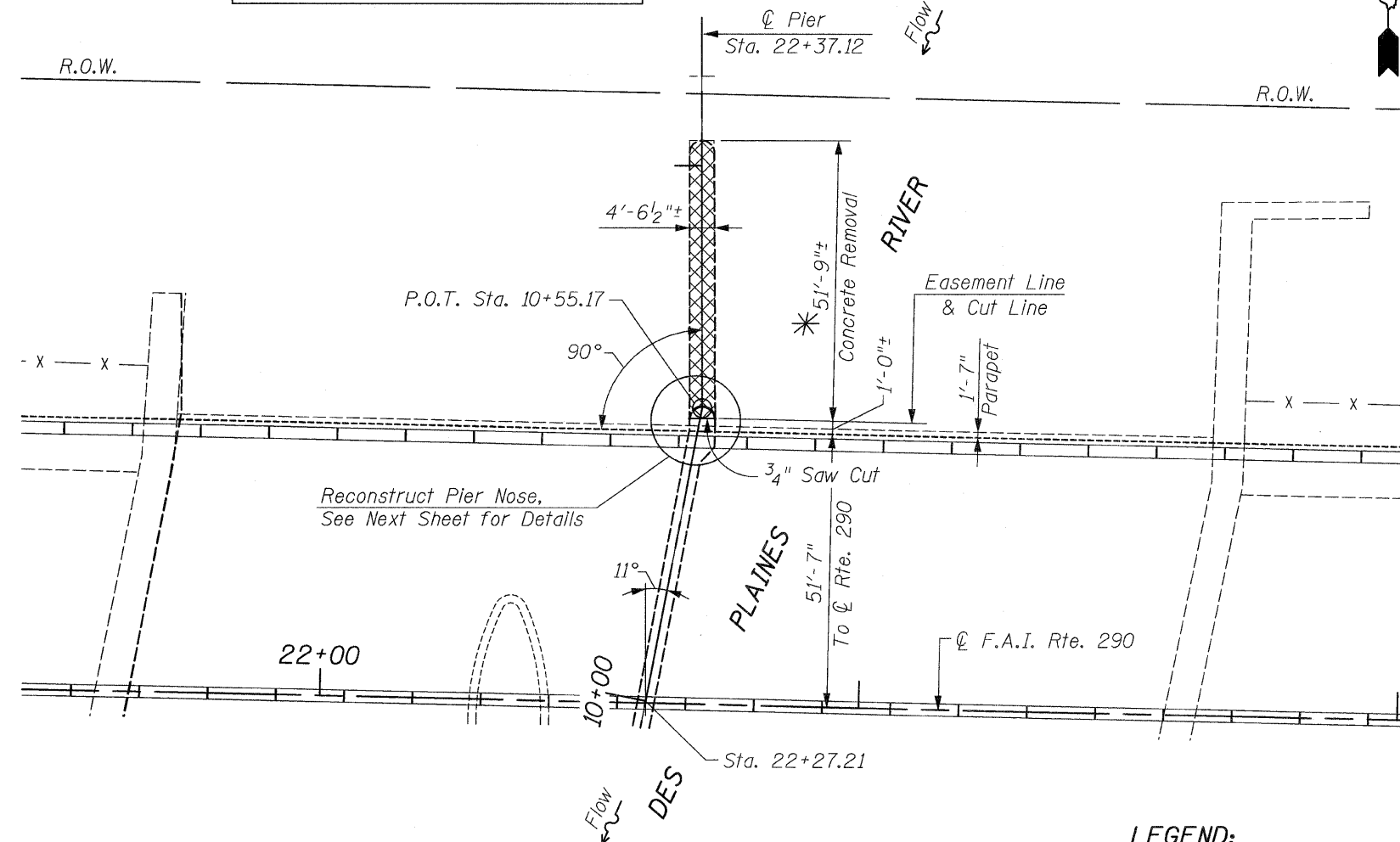

Reconstruct Pier Nose, See Next Sheet for Details

PARTIAL PLAN
(Showing Pier Removal)

LEGEND:

Concrete Removal

TOTAL BILL OF MATERIAL

Item	Unit	Quantity
Concrete Removal	Cu. Yd.	189
Concrete Structures	Cu. Yd.	10.3
Reinforcement Bars, Epoxy Coated	Pound	880
Structure Excavation	Cu. Yd.	6.7
Dewatering Structure No. 1	Each	1

**

** See Special Provision

DESIGN STRESSES

FIELD UNITS
 f'c = 3,500 psi
 fy = 60,000 psi (Reinforcement)

CR & A
 CHRISTIAN-ROGE & ASSOCIATES, INC.
 ENGINEERS / PLANNERS / SURVEYORS
 211 W. WACKER DRIVE CHICAGO, IL. 60606
 PHONE: (312)372-2023 FAX: (312)372-5274

FILE NAME = plan_sections.dgn	USER NAME = IDOT	DESIGNED - B.N.S./G.L.	REVISED -	STATE OF ILLINOIS DEPARTMENT OF TRANSPORTATION	PARTIAL PLAN - EXISTING PIER REMOVAL I-290 OVER DES PLAINES RIVER	F.A.P. RTE. VARIOUS	SECTION 2006-005 1	COUNTY COOK	TOTAL SHEETS 31	SHEET NO. 7			
PLT SCALE = 50.0000' / IN.	CHECKED - B.N.S./J.C.N./G.L.	REVISED -	SCALE:			SHEET NO. S1 OF S2 SHEETS	STA. TO STA.	FED. ROAD DIST. NO.	ILLINOIS FED. AID PROJECT	CONTRACT NO. 60B22			
PLT DATE = 1/30/2009	DATE - JANUARY, 2009	REVISED -											