

"PRINTED BY THE AUTHORITY OF THE STATE OF ILLINOIS"

STATE OF ILLINOIS
DEPARTMENT OF TRANSPORTATION
DIVISION OF HIGHWAYS

ROUTE NO. FAS 321	SECTION 17-00315-00-RS	COUNTY IROQUOIS	TOTAL SHEETS 8	SHEET NO. 1
JOB #: C-93-013-21			PROJECT #: KGOA(9772)	
CONTRACT 87747				

PLANS FOR PROPOSED IMPROVEMENT OF
FEDERAL AID SECONDARY HIGHWAY 321
SURFACE TRANSPORTATION PROGRAM - RURAL
"HMA RESURFACING PROJECT"
IROQUOIS COUNTY

INDEX OF SHEETS	
SHEET NUMBER	DESCRIPTION
1	COVER SHEET -- LOCATION MAP
2	SUMMARY OF QUANTITIES, GENERAL NOTES, MIXTURE TABLE, AND BUTT JOINT DETAIL
3	EXISTING & PROPOSED X-SECTIONS - STA. 277+00 TO 324+10 STA. 335+24.5 TO 348+46.4 & 359+64.2 TO 460+30
4	EXISTING & PROPOSED X-SECTIONS - STA. 324+10 TO 335+24.5 STA. 348+46.4 TO 359+64.2
5	EXISTING & PROPOSED X-SECTIONS - STA. 460+52 TO 563+30
6	TYPICAL ENTRANCES, SIDE ROAD INTERSECTIONS, MAIL BOX TURNOUTS & INCIDENTAL HMA SURFACING
7	QUANTITY TABLES
8	GUARDRAIL DETAILS

FAS ROUTE 321 (CH 4)
SECTION: 17-00315-00-RS
PROJECT NO. KGOA(9772)
JOB NO. C-93-013-21
CONTRACT NO. 87747

MILKS GROVE TOWNSHIP

ILLINOIS HIGHWAY STANDARD DRAWINGS	
000001-08	SYMBOLS AND ABBREVIATIONS
630001-12	STEEL PLATE BEAM GUARDRAIL
630106-02	LONG SPAN GUARDRAIL OVER CULVERT
701301-04	LANE CLOSURE, 2L 2W, SHORT TIME OPERATION, FOR SPEEDS > 45 MPH
701306-04	LANE CLOSURE, 2L 2W, SLOW MOVING DAY ONLY OPERATION, FOR SPEEDS > 45 MPH
701311-03	LANE CLOSURE 2L, 2W MOVING OPERATIONS - DAY ONLY
701901-08	TRAFFIC CONTROL DEVICES
725001-01	OBJECT AND TERMINAL MARKERS
780001-05	TYPICAL PAVEMENT MARKINGS
BLR 24-2	MAILBOX TURNOUT

END PROJECT
STA 563+30
(000E/3000N)

OMISSION
STA 460+30 TO
STA 460+52

BEGIN PROJECT
STA 277+00
(500E/2950N)

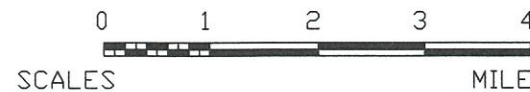
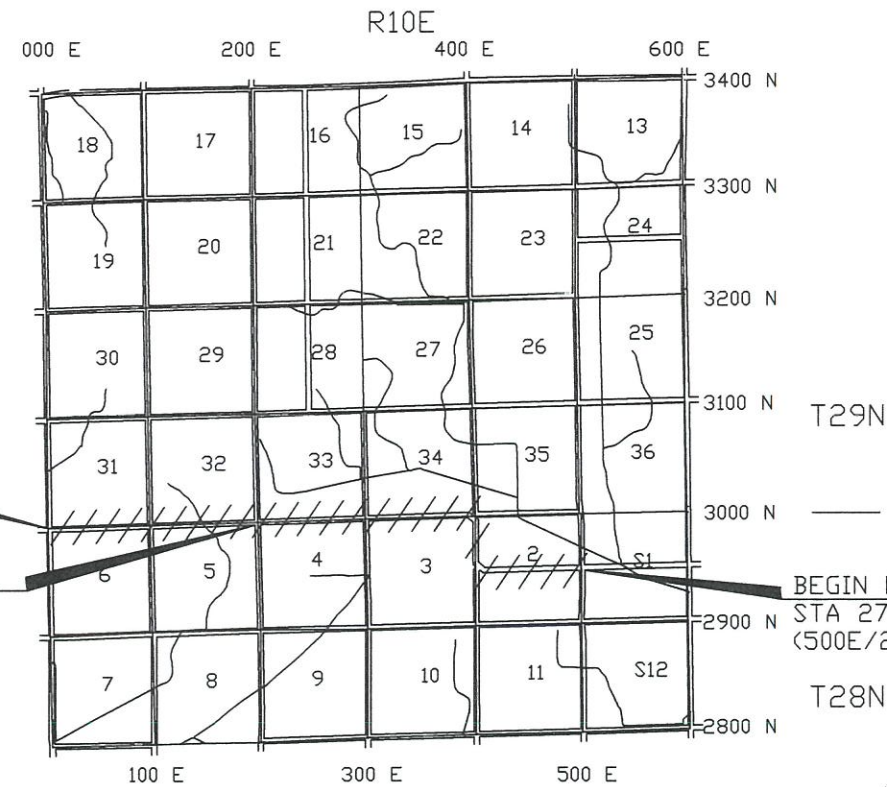

GROSS LENGTH = 28,630.00 FT. = 5.422 MILE
OMISSION LENGTH = 22.00 FT. = .004 MILE
NET LENGTH = 28,608.00 FT. = 5.418 MILE

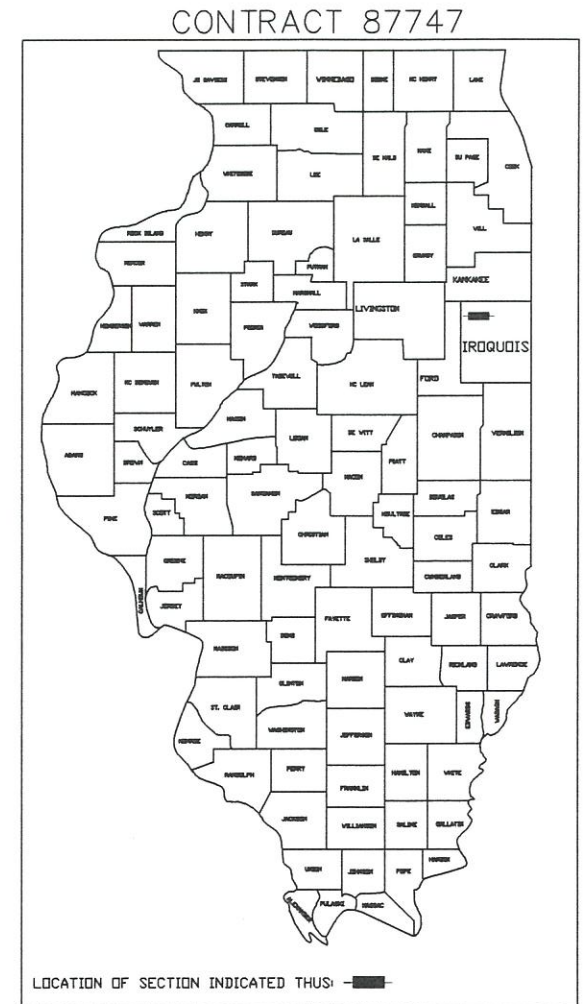

MAJOR COLLECTOR 2031 ADT = 248
PV = 88% SU = 7% MU = 5%
DESIGN SPEED = 50 M. P. H.

THESE PLAN WERE PREPARED BY ME OR BY A FULL TIME MEMBER OF MY STAFF WORKING UNDER MY DIRECT SUPERVISION

Joel V. Moore
JOEL V. MOORE, COUNTY ENGINEER
ILL. REG. PROF. ENG. #62056831
DATE EXPIRES: 11/30/21

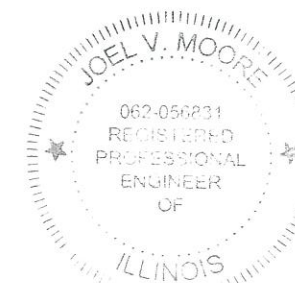

CONTRACT 87747

Approved *March 5*, 2021
JVM
County Engineer

Passed *April 9*, 2021
[Signature]
DISTRICT THREE LOCAL ROADS AND STREETS ENGINEER
RELEASED FOR BID
BASED ON LIMITED REVIEW
[Signature]
REGION TWO ENGINEER

STATE OF ILLINOIS
DEPARTMENT OF TRANSPORTATION

TOLL FREE JOINT UTILITY LOCATING
INFORMATION FOR EXCAVATORS (J. U. L. I. E.)
TELEPHONE NUMBER 1-800-892-0123

CONTRACT 87747

ROUTE NO.	SECTION	COUNTY	TOTAL SHEETS	SHEET NO.
FAS 321	17-00315-00-RS	IRROQUOIS	8	2
JOB # : C-93-013-21			PROJECT # : KGOA (9772)	
CONTACT 87747				

SUMMARY OF QUANTITIES

ITEM #	PAY ITEM #	PAY ITEM	UNIT	QUANTITY
			FUND CODE	0005
1	40600290	BITUMINOUS MATERIALS (TACK COAT)	POUND	47,500
2	40600982	HOT-MIX ASPHALT SURFACE REMOVAL-BUTT JOINT	SQ YD	738
3	40600990	TEMPORARY RAMP	SQ YD	155
4	40603080	HOT-MIX ASPHALT BINDER COURSE, IL-19.0, N50	TON	10,000
5	40604050	HOT-MIX ASPHALT SURFACE COURSE, IL-9.5, MIX 'C', N50	TON	6,100
6	40800050	INCIDENTAL HOT-MIX ASPHALT SURFACING	TON	245
7	44201745	CLASS D PATCHES, TYPE III, 8 INCH	SQ YD	80
* 8	48101200	AGGREGATE SHOULDERS, TYPE B	TON	7,300
9	54390140	INSERTION CULVERT LINER 18'	FOOT	54
10	54390180	INSERTION CULVERT LINER 24'	FOOT	40
11	54390210	INSERTION CULVERT LINER 30'	FOOT	106
Δ 12	63000003	STEEL PLATE BEAM GUARDRAIL, TYPE A, 9 FOOT POSTS	FOOT	150
Δ 13	63000009	STEEL PLATE BEAM GUARDRAIL, TYPE B, 9 FOOT POSTS	FOOT	100
Δ 14	63000370	LONG-SPAN GUARDRAIL OVER CULVERT, 25 FT SPAN	FOOT	200
Δ 15	63100167	TRAFFIC BARRIER TERMINAL, TYPE 1, (SPECIAL) TANGENT	EACH	8
16	63200310	GUARDRAIL REMOVAL	FOOT	730
*17	66700205	PERMANENT SURVEY MARKERS, TYPE 1	EACH	5
18	67100100	MOBILIZATION	L SUM	1
19	70300100	SHORT TERM PAVEMENT MARKING	FOOT	5,722
20	70300150	SHORT TERM PAVEMENT MARKING REMOVAL	SQ FT	954
21	70300220	TEMPORARY PAVEMENT MARKING-LINE 4'	FOOT	13,556
Δ 22	72501000	TERMINAL MARKER - DIRECT APPLIED	EACH	8
Δ 23	78000650	THERMOPLASTIC PAVEMENT MARKING - LINE 24'	FOOT	22
Δ *24	78001110	PAINT PAVEMENT MARKING - LINE 4'	FOOT	27,112
Δ 25	78200005	GUARDRAIL REFLECTORS, TYPE A	EACH	12
*26	X7010216	TRAFFIC CONTROL AND PROTECTION, (SPECIAL)	L SUM	1
Δ *27	X7830090	GROOVING FOR RECESSED PAVEMENT MARKING 25'	FOOT	22
28	Z0033700	LONGITUDINAL JOINT SEALANT	FOOT	28,608
*29	Z0034105	MATERIAL TRANSFER DEVICE	TON	16,100
*30	Z0055300	RUMBLE STRIP	EACH	6

* SEE SPECIAL PROVISIONS
 Δ SPECIALTY ITEMS

MIXTURE TABLE

	HMA BINDER	HMA SURFACE	INCIDENTAL HMA	HMA PATCHES
PG GRADE	PG64-22	PG64-22	PG64-22	PG64-22
DESIGN AIR Voids	4.0% @ N50	4.0% @ N50	4.0% @ N50	4.0% @ N50
MIXTURE COMPOSITION	IL 19.0	IL 9.5	IL 9.5	IL 19.0
FRICITION AGGREGATE		MIXTURE C	MIXTURE C	
DENSITY TEST METHOD	GROWTH CURVE	GROWTH CURVE	SATISFACTION OF ENGINEER	CORES/NUCLEAR
MIXTURE WEIGHT	112#/Sq. Yd./In.	112#/Sq. Yd./In.	112#/Sq. Yd./In.	112#/Sq. Yd./In.
QUALITY MANAGEMENT PROGRAM	QC/QA	QC/QA	QC/QA	QC/QA
SUBLOT SIZE	N/A	N/A	N/A	N/A
LOCATION(S)	ENTIRE PROJECT	ENTIRE PROJECT	ENTIRE PROJECT	ENTIRE PROJECT

MATERIAL SHALL BE COMPACTED TO 93.0-97.4 PERCENT OF THE MAXIMUM THEORETICAL DENSITY, EXCEPT THAT WHEN PLACED AS FIRST LIFT ON AN UNIMPROVED SUBGRADE THE MINIMUM PERCENT COMPACTION SHALL BE 92.0 PERCENT. THE MAXIMUM THEORETICAL DENSITY SHALL BE DETERMINED FROM THE MOVING AVERAGE AS SPECIFIED IN THE QC/QA SPECIFICATION.

GENERAL NOTES

THE THICKNESS OF HOT-MIX ASPHALT MIXTURES SHOWN ON THE TYPICAL X-SECTION IS THE NOMINAL THICKNESS. DEVIATIONS FROM THE NOMINAL THICKNESS WILL BE PERMITTED WHEN SUCH DEVIATIONS OCCUR DUE TO IRREGULARITIES IN THE EXISTING SURFACE.

THE ENGINEER SHALL BE THE SOLE JUDGE CONCERNING CURING TIME FOR THE VARIOUS HOT-MIX ASPHALT LIFTS.

FOR PAVEMENT MARKINGS ON FINAL SURFACES (I.E., MAINLINE PAVEMENT), FOR THE PAY ITEM TEMPORARY PAVEMENT MARKING LINE 4', PAVEMENT MARKING TAPE SHALL BE USED.

ANY REFERENCE TO A STANDARD IN THESE PLANS SHALL BE INTERPRETED TO MEAN THE EDITION AS INDICATED BY THE SUB-NUMBER LISTED IN THE INDEX OF SHEETS OR THE COPY OF THE STANDARD INCLUDED IN THESE PLANS.

SECTION NOTES

THE PROPOSED IMPROVEMENT CONSISTS OF A HOT MIX ASPHALT SURFACE COURSE INCLUDING BINDER COURSE, SHOULDER STONE AND ALL WORK NECESSARY TO COMPLETE THE PROJECT ACCORDING TO THE PLANS AND SPECIFICATIONS.

COUNTY HIGHWAY 4 IS A COMBINATION OF SECTIONS: (59-15d)W&RS, 59-15d, 89-15d, 94-00223-00-FP, 223-G, & 223-Q

APPLICATION RATES

THE FOLLOWING RATES OF APPLICATION HAVE BEEN ASSUMED IN CALCULATING PLAN QUALITIES:		
GRANULAR MATERIALS	2.05	TONS/CU YD
BITUMINOUS MATERIALS PRIME COAT	0.05/0.025	LBS/SQ FT
HOT MIX ASPHALT SURFACE COURSE	112	LBS/SQ YD/INCH
BINDER COURSE, IL-19.0, N50	112	LBS/SQ YD/INCH
SHORT TERM PAVEMENT MARKING	4	FT/40 FT OF APPLICATION
PAINT PAVEMENT MARKING - LINE 4'	10	FT/40 FT OF APPLICATION

HMA SURFACE REMOVAL BUTT JOINT DETAIL

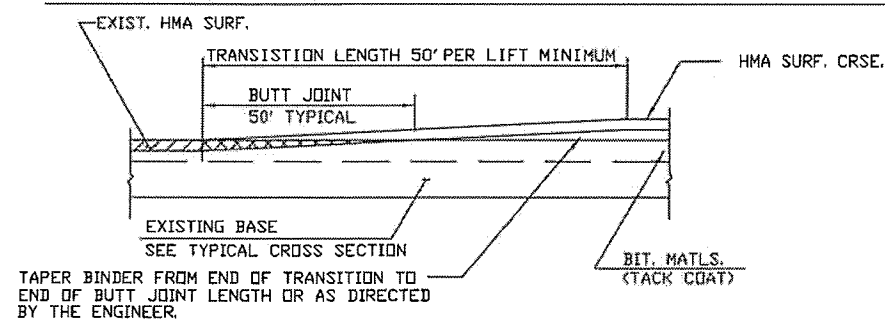

PAVEMENT DESIGN - CH 4 STATION 277+00 TO 460+30

STRUCTURAL DESIGN TRAFFIC: YEAR 2031	
PV= 218 (88%)	SU= 17 (7%) MU= 13 (5%)
ROAD CLASSIFICATION CLASS III	
TRAFFIC FACTOR:	ACTUAL TF = 0.07 AC TYPE = PG 64-22 MINIMUM TF = 1.70
PG GRADE:	BINDER = PG 64-22 SURFACE = PG 64-22
SUB GRADE SUPPORT RATING: IBV = 3.0	

PAVEMENT DESIGN - CH 4 STATION 460+52 TO 563+30

STRUCTURAL DESIGN TRAFFIC: YEAR 2031	
PV= 218 (88%)	SU= 17 (7%) MU= 13 (5%)
ROAD CLASSIFICATION CLASS III	
TRAFFIC FACTOR:	ACTUAL TF = 0.07 AC TYPE = PG 64-22 MINIMUM TF = 1.70
PG GRADE:	BINDER = PG 64-22 SURFACE = PG 64-22
SUB GRADE SUPPORT RATING: IBV = 3.0	

EXISTING TYPICAL SECTION 1
 STATION 277+00 TO 324+10
 STATION 335+24.5 TO 348+46.4
 STATION 359+64.2 TO 460+30

ROUTE NO.	SECTION	COUNTY	TOTAL SHEETS	SHEET NO.
FAS 321	17-00315-00-RS	IRROQUOIS	8	3
JOB # C-93-013-21			PROJECT # KGOAK 9772	
CONTACT 87747				

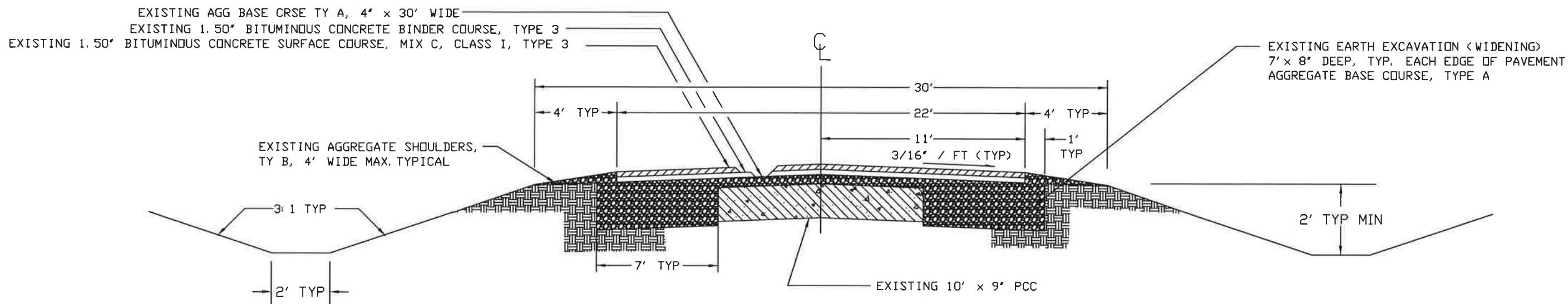

PROPOSED TYPICAL SECTION 1
 STATION 277+00 TO 324+10
 STATION 335+24.5 TO 348+46.4
 STATION 359+64.2 TO 460+30

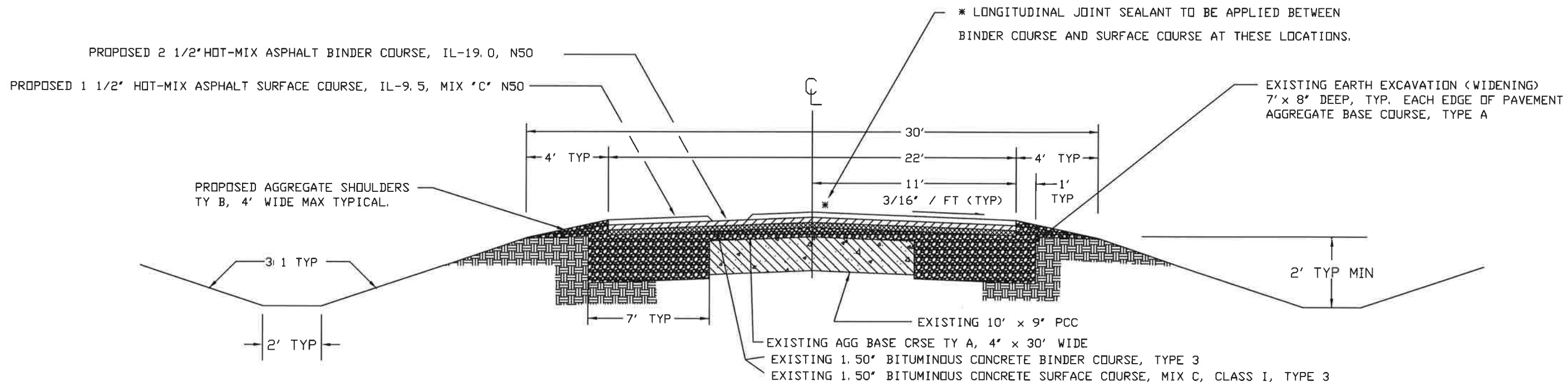

EXISTING TYPICAL SECTION 2
 STATION 324+10 TO 335+24.5
 STATION 348+46.4 TO 359+64.2

ROUTE NO.	SECTION	COUNTY	TOTAL SHEETS	SHEET NO.
FAS 321	17-00315-00-RS	IRROQUOIS	8	4
JOB # : C-93-013-21			PROJECT # : KGOA(9772)	
CONTACT 87747				

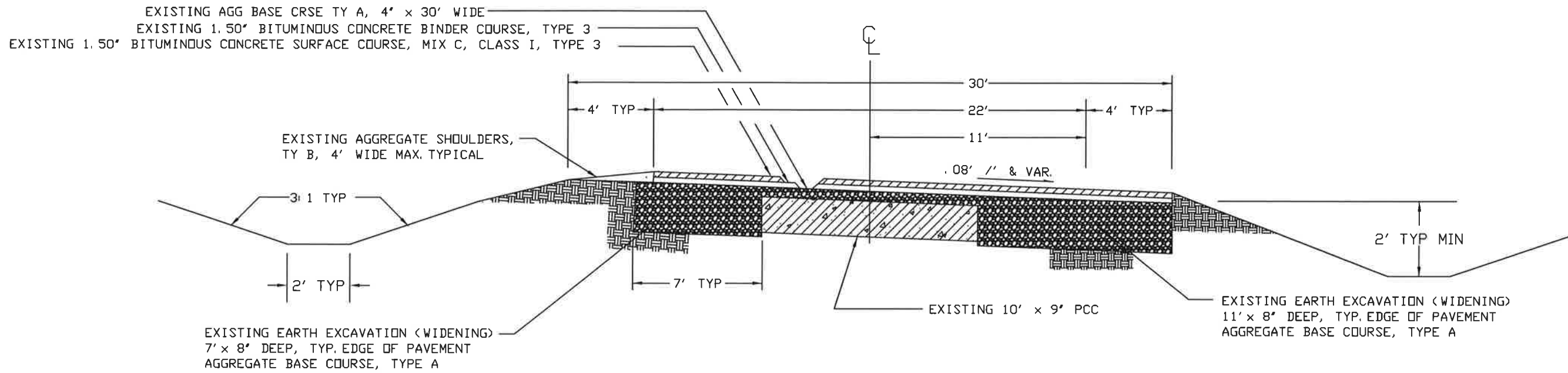

PROPOSED TYPICAL SECTION 2
 STATION 324+10 TO 335+24.5
 STATION 348+46.4 TO 359+64.2

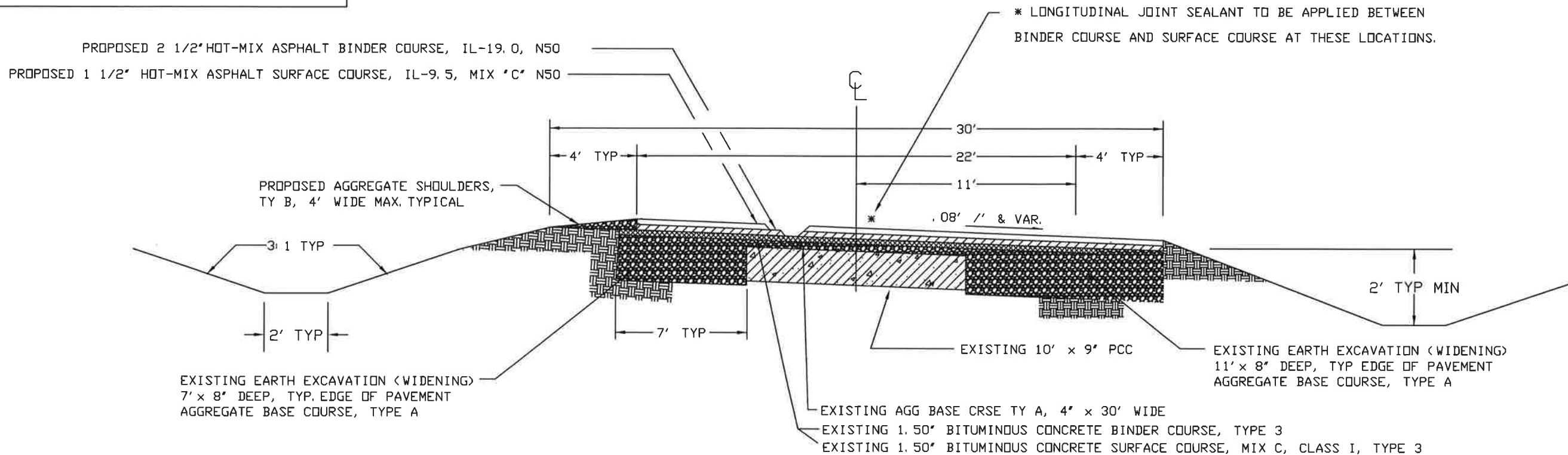

EXISTING TYPICAL SECTION 3
STATION 460+52 TO 563+30

ROUTE NO.	SECTION	COUNTY	TOTAL SHEETS	SHEET NO.
FAS 321	17-00315-00-RS	IRROQUOIS	8	5
JOB #: C-93-013-21			PROJECT #: KGOAK 9772	
CONTRACT 87747				

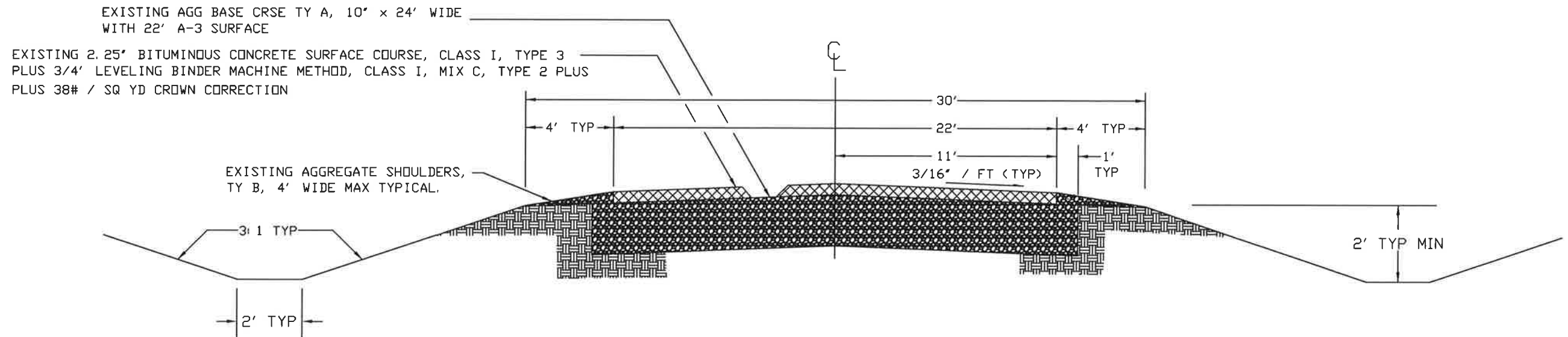

PROPOSED TYPICAL SECTION 3
STATION 460+52 TO 563+30

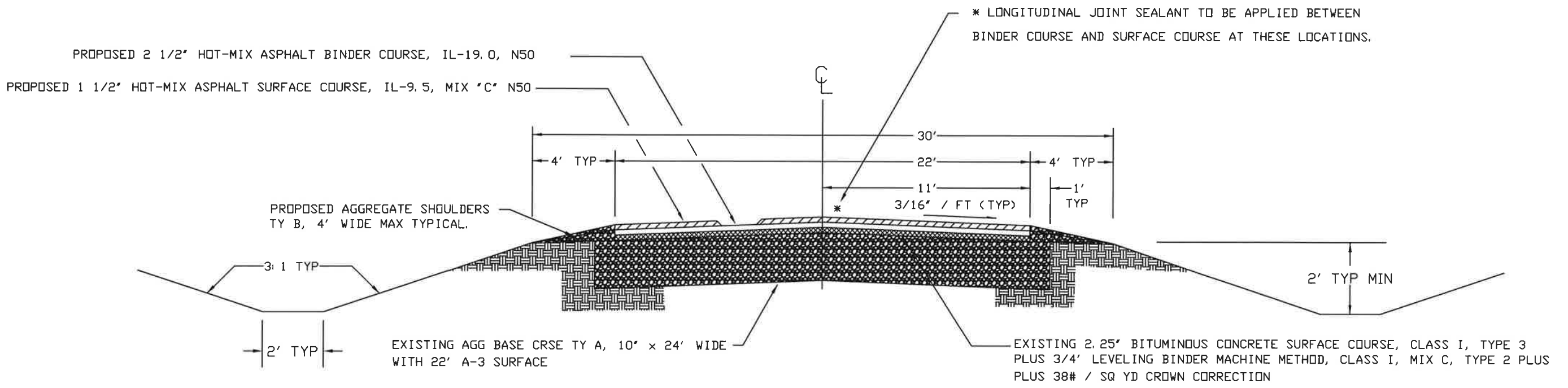

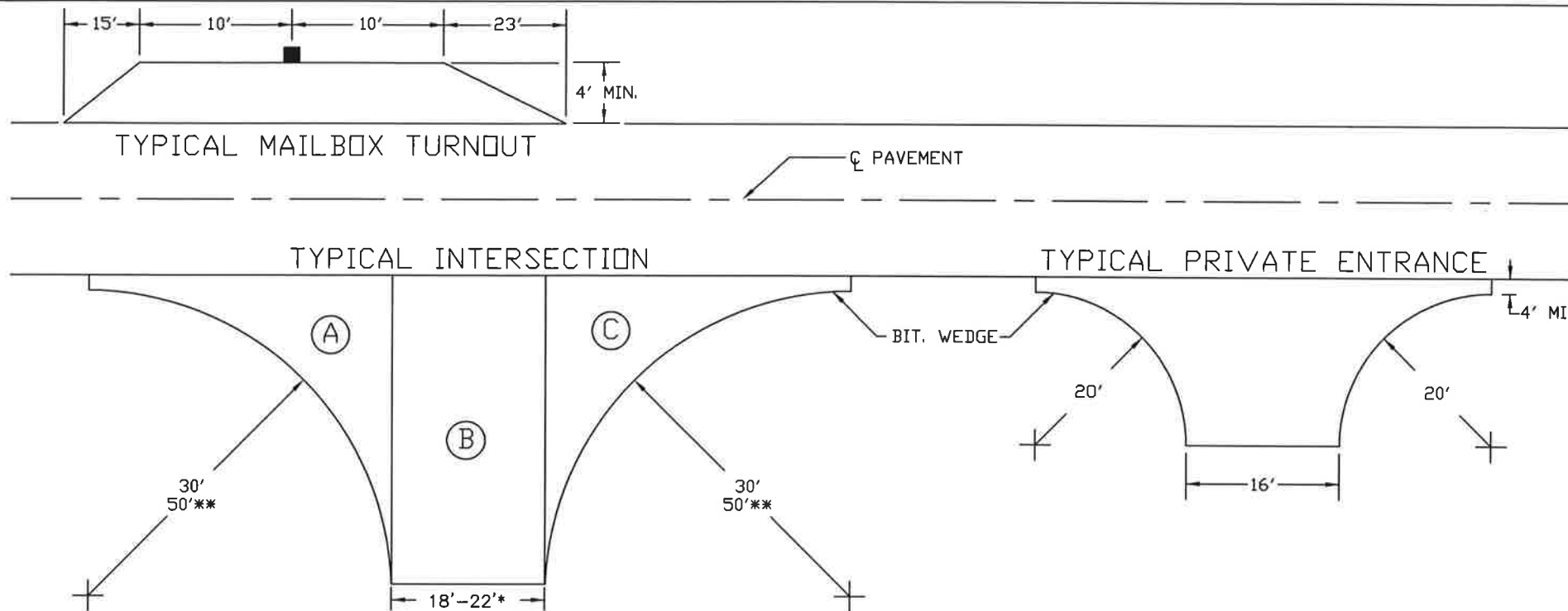

A+C = RADIUS ON MAINLINE SHOWN AS SIDE = VAR
 ALL INTERSECTION ARE 18' WIDE UNLESS INDICATED WITH A *.
 A+B+C = TYPICAL SIDE ROAD INTERSECTION

NOTE: ALL PRIVATE ENTRANCES, MAIL BOX TURNOUTS AND SIDE ROAD INTERSECTIONS SHALL BE PAID FOR AS INCIDENTAL BITUMINOUS SURFACING - TOTAL 245 TON.

TOTAL AGGREGATE FOR FIELD ENTRANCES = 195 TONS
 THIS QUANTITY IS INCLUDED IN AGGREGATE SHOULDERS, TYPE B TOTAL QUANTITY.

NOTE: AGGREGATE SHALL BE PLACED AROUND ALL PRIVATE ENTRANCES, MAIL BOX TURNOUTS AND SIDE ROAD INTERSECTIONS AND SHALL BE CONSIDERED INCIDENTAL TO AGGREGATE SHOULDERS, TYPE B AND PLACED AS DIRECTED BY THE ENGINEER.

40800050 - INCIDENTAL HMA SURFACING

STATION	RT/LT	SQ. YD.	LOCATION	TON
277+98	RT	100	500E/2950N	15 TON
277+98	LT	100	500E/2950N	15 TON
329+69	LT	120	400E/2950N	20 TON
353+75	RT	120	400E/3000N	20 TON
406+93	RT	100	300E/3000N	15 TON
406+93	LT	100	300E/3000N	15 TON
513+78	RT	100	100E/3000N	15 TON
513+78	LT	100	100E/3000N	15 TON
TOTALS		840		130 TON

STATION	RT/LT	SQ. YD.	TON
285+20	RT	55	8 TON
357+25	RT	55	8 TON
393+33	LT	55	8 TON
402+86	RT	55	8 TON
408+47	RT	55	8 TON
439+51	RT	55	8 TON
500+15	RT	55	8 TON
506+90	LT	55	8 TON
508+17	LT	55	8 TON
518+05	LT	55	8 TON
542+79	RT	55	8 TON
TOTALS		605	88 TON

STATION	RT/LT	SQ. YD.	TON
285+45	LT	20	3 TON
357+25	LT	20	3 TON
393+55	LT	20	3 TON
403+87	LT	20	3 TON
408+45	LT	20	3 TON
439+25	LT	20	3 TON
500+12	LT	20	3 TON
508+02	LT	20	3 TON
517+90	RT	20	3 TON
TOTALS		180	27 TON

TYPICAL INT.'S & SIDE ROADS	130 TONS
PRIVATE ENTRANCES	88 TONS
TYPICAL MAILBOX TURNOUT	27 TONS
TOTAL = 245 TONS	

48101200 - AGGREGATE SHOULDERS, TYPE B

STATION	RT/LT	TYPE	PROPOSED	TON	STATION	RT/LT	TYPE	PROPOSED	TON
285+20	LT	FE	AGG	5 TON	433+40	RT	FE	AGG	5 TON
291+25	RT	FE	AGG	5 TON	439+45	LT	FE	AGG	5 TON
291+25	LT	FE	AGG	5 TON	446+48	LT	FE	AGG	5 TON
307+45	RT	FE	AGG	5 TON	464+66	RT	FE	AGG	5 TON
317+48	RT	FE	AGG	5 TON	464+70	LT	FE	AGG	5 TON
317+58	LT	FE	AGG	5 TON	473+75	RT	FE	AGG	5 TON
324+30	RT	FE	AGG	5 TON	473+75	LT	FE	AGG	5 TON
334+80	LT	FE	AGG	5 TON	485+70	LT	FE	AGG	5 TON
342+31	RT	FE	AGG	5 TON	485+70	RT	FE	AGG	5 TON
345+61	LT	FE	AGG	5 TON	494+11	RT	FE	AGG	5 TON
347+93	RT	FE	AGG	5 TON	499+65	LT	FE	AGG	5 TON
359+60	RT	FE	AGG	5 TON	508+40	LT	FE	AGG	5 TON
370+80	RT	FE	AGG	5 TON	520+37	LT	FE	AGG	5 TON
379+89	RT	FE	AGG	5 TON	527+88	RT	FE	AGG	5 TON
379+89	LT	FE	AGG	5 TON	527+88	LT	FE	AGG	5 TON
393+33	RT	FE	AGG	5 TON	540+34	RT	FE	AGG	5 TON
396+85	LT	FE	AGG	5 TON	550+55	RT	FE	AGG	5 TON
409+65	RT	FE	AGG	5 TON	555+30	RT	FE	AGG	5 TON
419+65	LT	FE	AGG	5 TON	557+95	LT	FE	AGG	5 TON
419+75	RT	FE	AGG	5 TON					
TOTALS = 195 TONS									

MAINLINE QUANTITIES	7105 TONS
FIELD ENTRANCE QUANTITIES	195 TONS
TOTAL = 7300 TONS	

ROUTE NO.	SECTION	COUNTY	TOTAL SHEETS	SHEET NO.
FAS 321	17-00315-00-RS	IRROQUOIS	8	7
JOB #: C-93-013-21			PROJECT #: KGQA(9772)	

CONTRACT 87747

78001110 – PAINT PAVEMENT MARKING – LINE 4”
70300220 – TEMPORARY PAVEMENT MARKING – LINE 4”

TYPE	STATION TO STATION	FEET	LINE 4”
	CENTERLINE (YELLOW)		
SKIP DASH	277+00 TO 315+44	3,844'	961'
SKIP DASH	368+44 TO 460+30	9,186'	2,297'
SKIP DASH	460+52 TO 563+30	10,278'	2,570'
SUB-TOTAL =		5,828'	
	NO PASSING ZONE (YELLOW)		
SINGLE NO PASS & SKIP DASH	315+44 TO 327+47 RT	1,203'	1,504'
DOUBLE NO PASS	327+47 TO 332+90 RT & LT	543'	1,086'
SINGLE NO PASS & SKIP DASH	332+90 TO 340+05 LT	715'	894'
DOUBLE NO PASS	340+05 TO 344+70 RT & LT	465'	930'
SINGLE NO PASS & SKIP DASH	344+70 TO 352+00 RT	730'	913'
DOUBLE NO PASS	352+00 TO 356+61 RT & LT	461'	922'
SINGLE NO PASS & SKIP DASH	356+61 TO 368+44 LT	1,183'	1,479'
SUB-TOTAL =		7,728'	

TOTAL FOR TEMPORARY PAVEMENT MARKING = 13,556'
TOTAL ALL STRIPING FOR PAINT PAVEMENT MARKING LINE 4” (TWO APPLICATIONS) = 27,112'

X7830090
GROOVING FOR RECESSED PAVEMENT MARKING 25”

STATION TO STATION	FOOT
459+88 RT	11
461+04 LT	11
TOTAL =	22

54390140
INSERTION CULVERT LINER 18”

STATION TO STATION	FOOT
503+16	54
TOTAL =	54

54390180
INSERTION CULVERT LINER 24”

STATION TO STATION	FOOT
513+78 LT	40
TOTAL =	40

54390210
INSERTION CULVERT LINER 30”

STATION TO STATION	FOOT
513+33	54
526+54	52
TOTAL =	106

40600982
HMA SURFACE REMOVAL BUTT JOINT

STATION TO STATION	SQ. YDS.
277+00 TO 277+50	122
329+69 LT	31
353+75 RT	31
459+80 TO 460+30	191
460+52 TO 460+82	241
562+80 TO 563+30	122
TOTAL =	738

Z0055300
RUMBLE STRIPS

STATION	EACH
449+60 TO 449+85 RT	1
454+60 TO 454+85 RT	1
456+60 TO 456+85 RT	1
464+04 TO 464+29 LT	1
466+04 TO 466+29 LT	1
471+04 TO 471+29 LT	1
TOTAL =	6

40600990
TEMPORARY RAMP

STATION	SQ. YDS.
277+00	12
329+69 LT	11
353+75 RT	11
460+30	53
460+52	56
563+30	12
TOTAL =	155

78000650
THERMOPLASTIC PAVEMENT MARKING LINE – 24”

STATION TO STATION	FOOT
459+88 RT	11
461+04 LT	11
TOTAL =	22

66700205
PERMANENT SURVEY MARKERS TYPE 1

STATION	EACH
277+98	1
304+44	1
379+89	1
406+93	1
433+69	1
TOTAL =	5

44201745-CLASS D PATCHES, TY III, 8 INCH SCHEDULE – CLASS D PATCHING 8”			
STATION	WESTBOUND LANE	EASTBOUND LANE	PATCH LOCATION
	PATCH TYPE III SQ YD	PATCH TYPE III SQ YD	
469+92 TO 470+08 LT		20	HMA PAVEMENT
469+92 TO 470+08 RT	20		HMA PAVEMENT
480+69 TO 480+85 LT		20	HMA PAVEMENT
480+69 TO 480+85 RT	20		HMA PAVEMENT
TOTALS	40	40	
TYPE III TOTALS	= 80 SQ YD		

PAVEMENT SCHEDULE

PAY ITEM	40603080	40604050	48101200	40600290	Z0033700	Z0034105
UNIT	(TON)	(TON)	(TON)	(POUND)	(FOOT)	(TON)
STATION TO STATION	HMA BINDER COURSE IL-19.0, N50	HMA SURFACE COURSE IL-9.5 MIX 'C' N50	AGGREGATE SHOULDERS TYPE B	BITUMINOUS MATERIALS (TACK COAT)	LONGITUDINAL JOINT SEALANT	MATERIAL TRANSFER DEVICE
277+00 TO 460+30	6,511	3,764	4,583	31,271	18,330	10,275
460+52 TO 563+30	3,489	2,336	2,717	16,229	10,278	5,825
TOTAL =	10,000	6,100	7,300	47,500	28,608	16,100

GUARDRAIL PLAN VIEW

ROUTE NO. FAS 321	SECTION 17-00315-00-RS	COUNTY IROQUOIS	TOTAL SHEETS 8	SHEET NO. 8
JOB #: C-93-013-21			PROJECT # KGOA(9772)	
CONTRACT 87747				

LOCATION #1

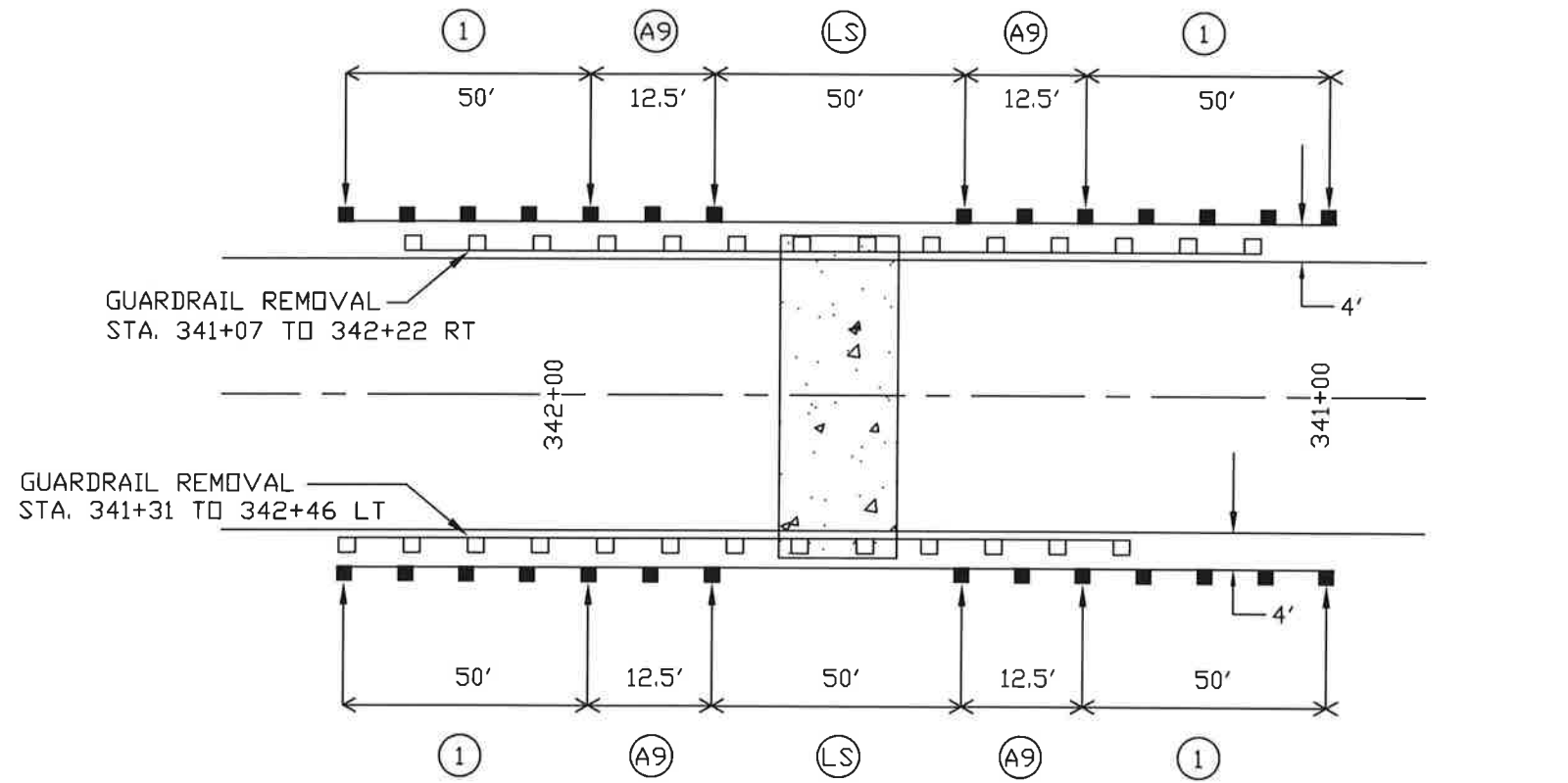

LOCATION #2

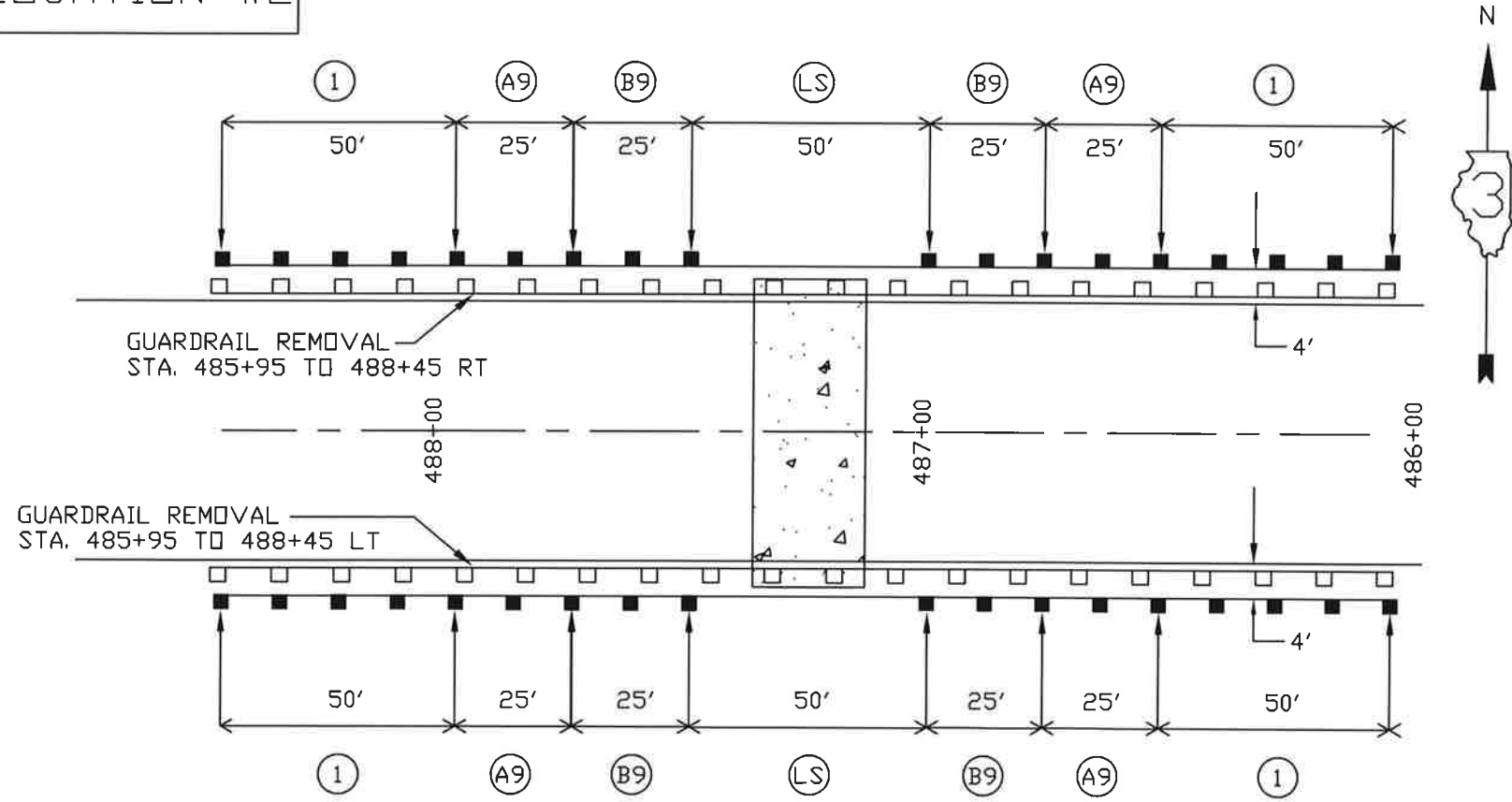

LEGEND

(1)	TRAFFIC BARRIER TERMINAL, TYPE 1 (SPECIAL) TANGENT
(A9)	STEEL PLATE BEAM GUARDRAIL, TYPE A, 9 FOOT POSTS
(B9)	STEEL PLATE BEAM GUARDRAIL, TYPE B, 9 FOOT POSTS
(LS)	LONG SPAN GUARDRAIL OVER CULVERT, 25 FOOT SPAN

NOTES

- REMOVED GUARDRAIL THAT IS NOT REPLACED ON THE SAME DAY MUST BE DELINEATED WITH LIGHTED BARRICADES. NO LOCATIONS SHALL BE LEFT WITHOUT EITHER LIGHTED BARRICADES OR RESTORED GUARDRAIL AT ANY TIME.

GUARDRAIL SCHEDULE

LOCATION NUMBER	QUADRANT (NE, SE, NW, SW, LEFT, RIGHT)	SPBGR TY A 9' POSTS	SPBGR TY B 9' POSTS	LONG SPAN GUARDRAIL OVER CULVERT 25 FT SPAN	TBT TY 1 (SPECIAL) TANGENT	GUARDRAIL REMOVAL	GUARDRIAL REFLECTORS TYPE A	TERMINAL MARKER - DIRECT APPLIED
		FOOT	FOOT	FOOT	EACH	FOOT	EACH	EACH
1	RIGHT	25		50	2	115	2	2
	LEFT	25		50	2	115	2	2
2	RIGHT	50	50	50	2	250	4	2
	LEFT	50	50	50	2	250	4	2
TOTAL		150	100	200	8	730	12	8