

03_EROS_5208.DGN MAR. 15, 2010

GENERAL NOTES:

1. CONTRACTOR SHALL CONSULT JOB SPECIFICATIONS FOR MORE INFORMATION.
2. LAYOUT OF EROSION CONTROL MEASURES MAY BE ADJUSTED IN FIELD BY ENGINEER FOR VARYING GROUND CONDITIONS.
3. TEMPORARY DITCH CHECKS SHALL BE URETHANE FOAM/GEOTEXTILE DITCH CHECKS PER STD. 280001.
4. HAY OR STRAW BALES SHALL NOT BE USED FOR TEMPORARY DITCH CHECKS.
5. AGGREGATE DITCH CHECKS SHALL BE PLACED ACCORDING TO DETAILS AND SCHEDULE SHOWN ON THIS SHEET.
6. CONTRACTOR SHALL PROVIDE STABILIZED CONSTRUCTION ENTRANCES AS NECESSARY TO MINIMIZE OFF SITE VEHICLE TRACKING OF SOIL AND DEBRIS. SEE SPECS.
7. ALL DISTURBED AREAS SHALL RECEIVE TEMPORARY EROSION CONTROL SEEDING AS DESCRIBED IN SPECS. UNTIL PERMANENT STABILIZATION CAN BE PERFORMED.
8. THE COUNTY WILL ASSUME RESPONSIBILITY FOR MAINTAINING EROSION CONTROL MEASURES THROUGH FINAL STABILIZATION AFTER I.D.O.T. ACCEPTANCE OF WORK BY CONTRACTOR.

AGGREGATE DITCH CHECK SCHEDULE

STATION	DEPTH
86+75 (L.T.)	12"
86+75 (RT.)	12"
87+40 (L.T.)	15"
87+40 (RT.)	12"

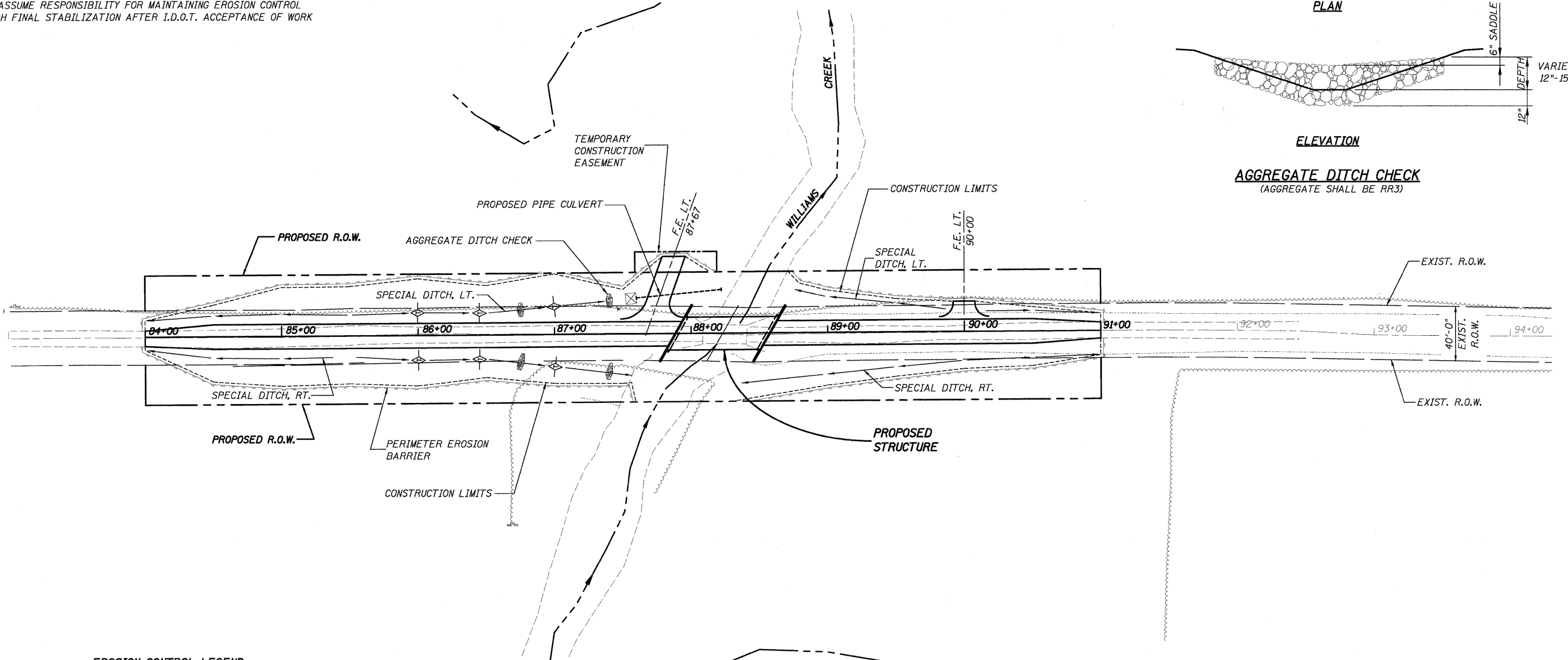
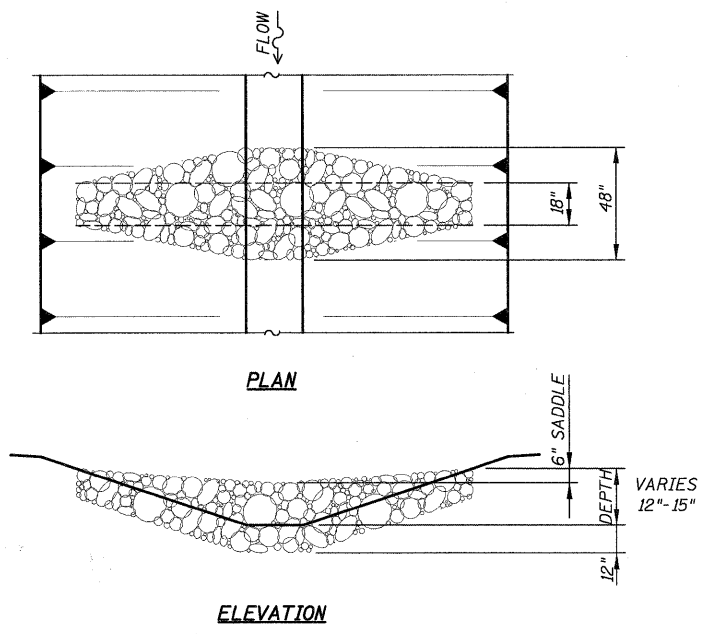

EROSION CONTROL LEGEND

- PERIMETER EROSION BARRIER
- ◇ TEMPORARY DITCH CHECK
- FLOW DIRECTION
- ⊠ INLET & PIPE PROTECTION

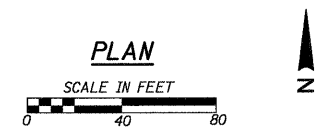

FILE NAME = h:\5208\03_EROS_5208.dgn
 USER NAME = _USERDESCR_

DESIGNED - BIB
 DRAWN - KHL
 CHECKED - LDG
 DATE - 3/16/2010

REVISED -
 REVISED -
 REVISED -
 REVISED -

STATE OF ILLINOIS
 DEPARTMENT OF TRANSPORTATION

EROSION CONTROL PLAN

F.A.	SECTION	COUNTY	TOTAL SHEETS	SHEET NO.
165	96-14115-00-BR	WASHINGTON	15	3
S.N. 095-3251			CONTRACT NO. 97435	
ILLINOIS FED. AID PROJECT				

PLM & G. NO. 5208