

DATE	BY
FINAL SURVEY	SURVEYED
NOTE BOOK NO.	PLOTTED
	TEMPLATE
	AREAS CHECKED

DATE	BY
ORIGINAL SURVEY	SURVEYED
NOTE BOOK NO.	PLOTTED
	TEMPLATE
	AREAS CHECKED

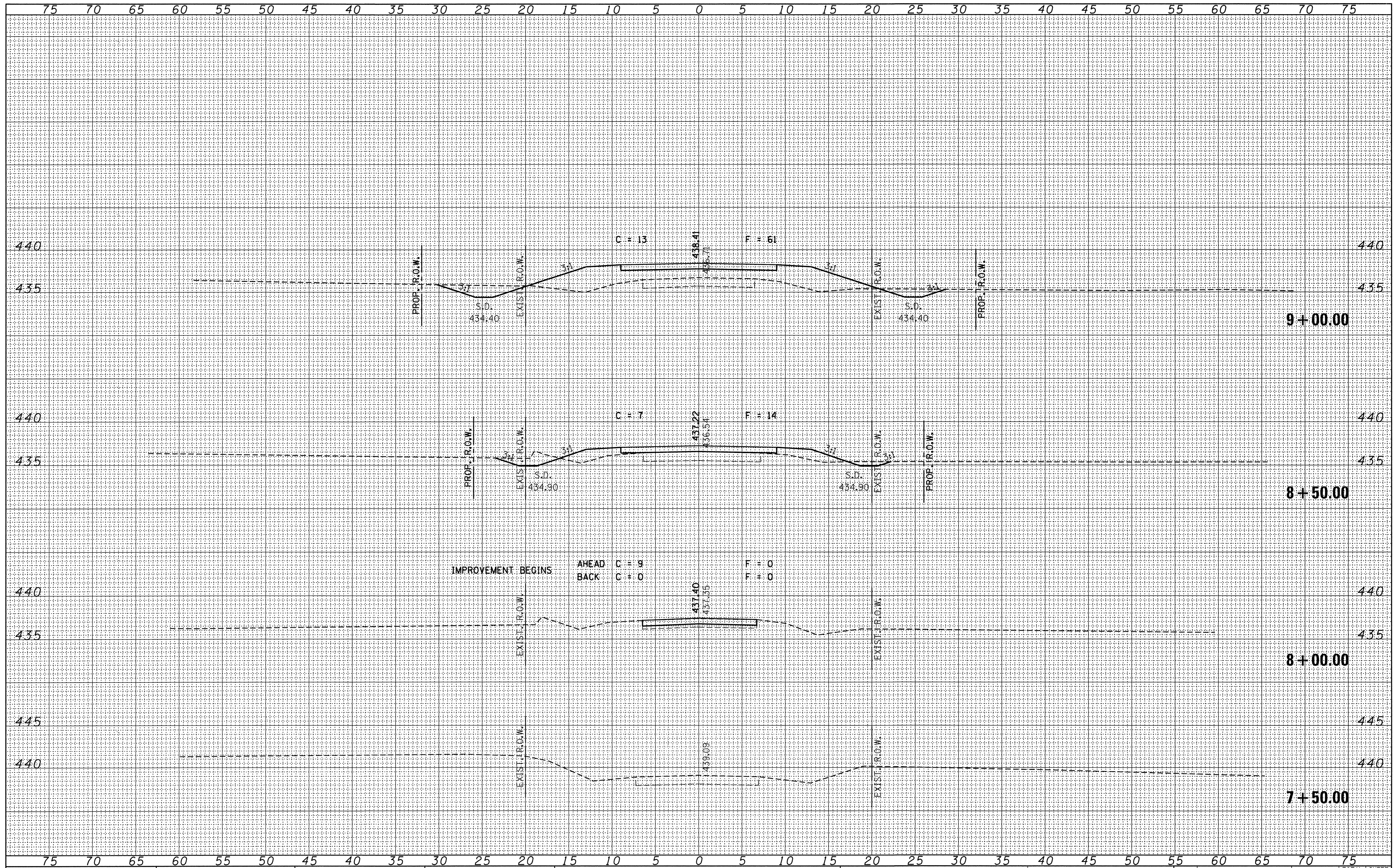

FILE NAME = 090128-sht-axs.dgn

USER NAME =  
 PLOT SCALE =  
 PLOT DATE = 2/18/2010

DESIGNED - A.S.L.  
 DRAWN - D.T.M.  
 CHECKED - S.W.M.  
 DATE - 08/05/09

REVISED -  
 REVISED -  
 REVISED -  
 REVISED -

STATE OF ILLINOIS  
 CLAY COUNTY HIGHWAY DEPARTMENT

**HLR** HAMPTON, LENZINI & RENWICK, INC.  
 CIVIL & STRUCTURAL ENGINEERS  
 LAND SURVEYORS  
 SCALE: 5H:5V SHEET NO. OF SHEETS

**CROSS SECTIONS  
 MARIGOLD LN.**  
 STA. 7+50.00 TO STA. 9+00.00

T.R.	SECTION	COUNTY	TOTAL SHEETS	SHEET NO.
363	06-11129-00-BR	CLAY	16	5
FED. ROAD DIST. NO.			ILLINOIS FED. AID PROJECT BROS-025(061)	
			CONTRACT NO. 95621	