

STATE OF ILLINOIS
DEPARTMENT OF TRANSPORTATION
DIVISION OF HIGHWAYS

**PLANS FOR PROPOSED
HIGHWAY BRIDGE PROGRAM**

PROJECT BROS-025(061)
SECTION 06-11129-00-BR
STANFORD ROAD DISTRICT
CLAY COUNTY
T.R. 363 / MARIGOLD LANE
PROPOSED STRUCTURE NO. 013-3235
C-97-047-10

ROUTE NO. T.R. 363	SECTION 06-11129 -00-BR	COUNTY CLAY	TOTAL SHEETS 16	SHEET NO. 1
FED. ROAD DIST. NO.		ILLINOIS	CONTRACT NO. 95621	

INDEX OF SHEETS

SHEET NO.	DESCRIPTION
1.	COVER SHEET
2.	SUMMARY OF QUANTITIES AND GENERAL NOTES
3.	TYPICAL SECTIONS
4.	PLAN AND PROFILE
5.-8.	STATION CROSS SECTIONS
9.-15.	BRIDGE PLANS
16.	BORINGS

HIGHWAY STANDARDS:

000001-05	STANDARD SYMBOLS, ABBREVIATIONS, AND PATTERNS
515001-03	NAME PLATE FOR BRIDGES
701901-01	TRAFFIC CONTROL DEVICES
BLR 21-8	TYPICAL APPLICATION OF TRAFFIC CONTROL DEVICES FOR CONSTRUCTION ON RURAL LOCAL HIGHWAYS

UTILITIES

VERIZON
225 EAST CHESTNUT ST.
OLNEY, IL 62450

CLAY ELECTRIC CO-OP, INC.
7784 OLD HIGHWAY 50
P.O. BOX 517
FLORA, IL 62839-0517



FUNCTIONAL CLASSIFICATION: LOCAL ROAD (NON-URBAN) < 150 ADT
DESIGN SPEED: 30 MPH
DESIGN TRAFFIC: 125 ADT (2005)

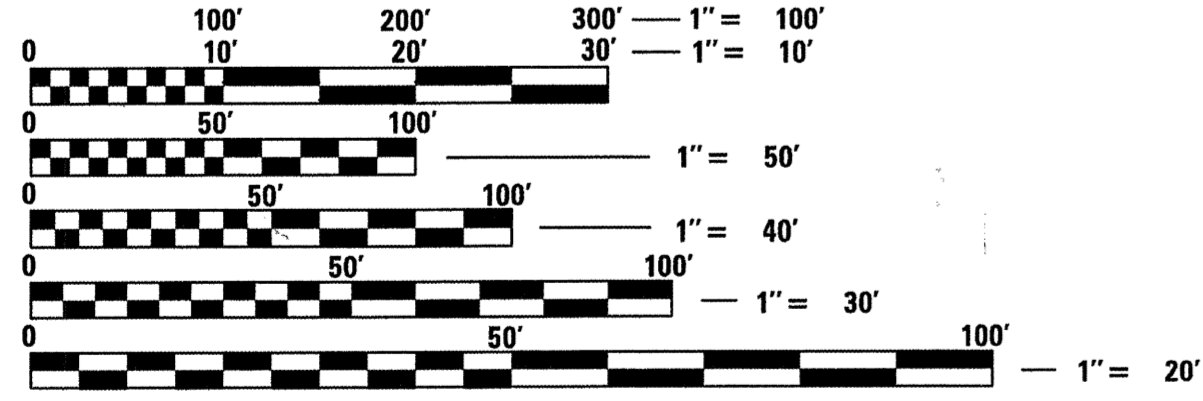

FULL SIZE PLANS HAVE BEEN PREPARED USING STANDARD ENGINEERING SCALES. REDUCED SIZED PLANS WILL NOT CONFORM TO STANDARD SCALES. IN MAKING MEASUREMENTS ON REDUCED PLANS, THE ABOVE SCALES MAY BE USED.

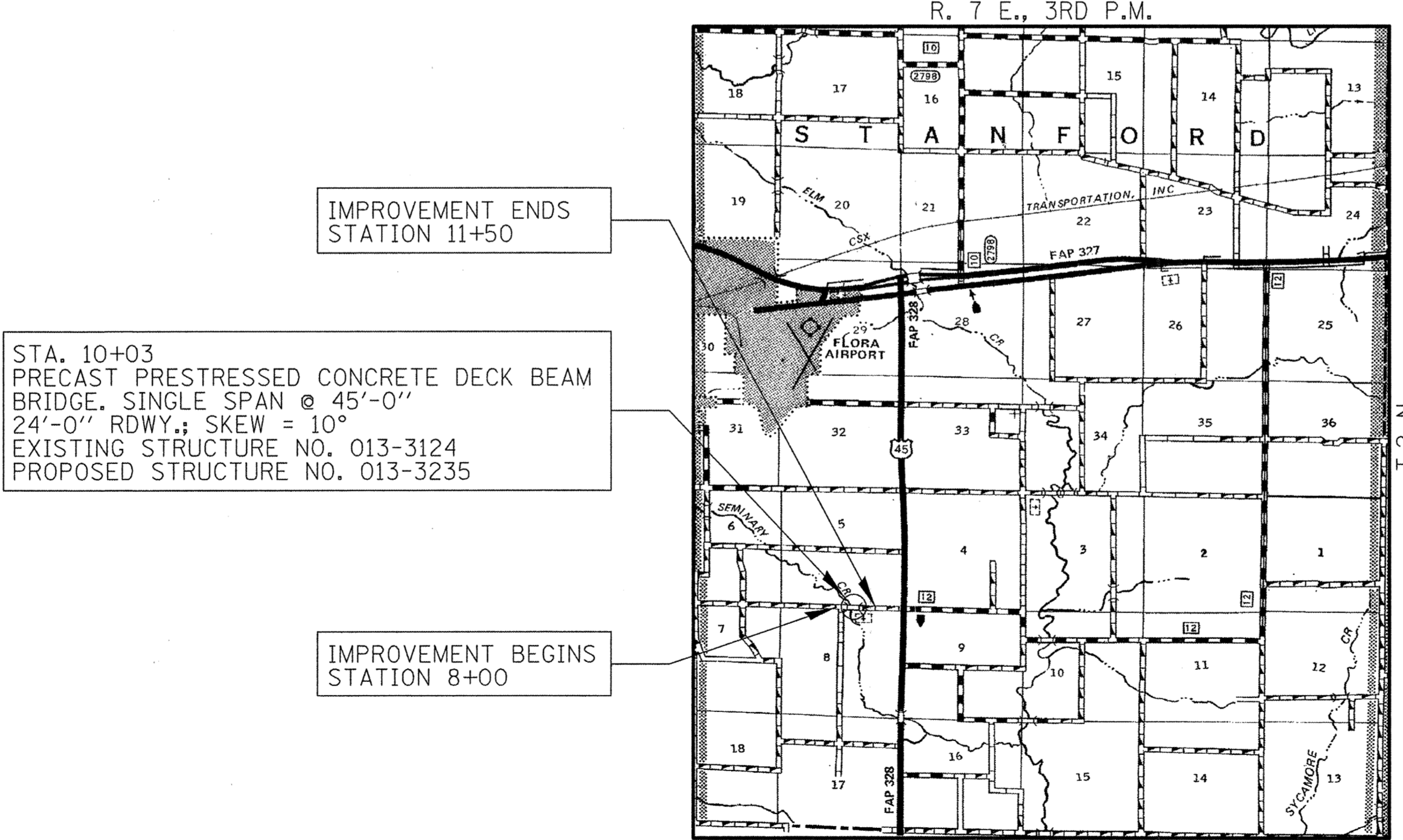

LOCATION MAP

APPROXIMATE SCALE: 0 1 MILE
NET LENGTH OF SECTION = 350 FEET = 0.066 MILES



ILLINOIS DEPT. OF TRANSPORTATION

APPROVED February 23 2010
COUNTY ENGINEER

APPROVED 2-22-2010 Tom Leah
ROAD COMMISSIONER

PASSED 4/13 2010
DISTRICT SEVEN ENGINEER OF LOCAL ROADS & STREETS

Releasing For Bid Based on Limited Review
4/13 2010
DEPUTY DIRECTOR OF HIGHWAYS
REGION FOUR ENGINEER
STATE OF ILLINOIS
DEPARTMENT OF TRANSPORTATION

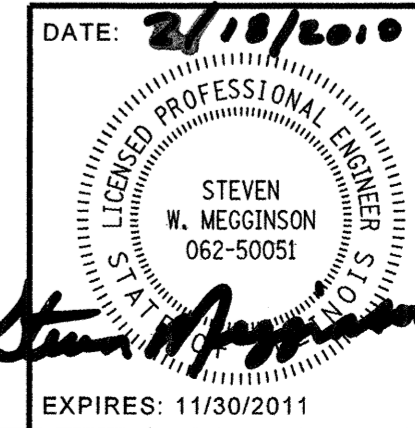

HAMPTON, LENZINI AND RENWICK, INC.
CIVIL ENGINEERS - STRUCTURAL ENGINEERS - LAND SURVEYORS
HLR
3085 STEVENSON DRIVE, SUITE 201
SPRINGFIELD, ILLINOIS 62703
217.546.3400 www.hltrengineering.com
184.000959
ILLINOIS PROFESSIONAL DESIGN FIRM LS / PE / SE CORPORATION

CONTRACT NO. 95621

CLAY COUNTY

SECTION 06-11129-00-BR

PROJECT NUMBER: 09.0128.130 DATE: 02/18/10