

F.A.P. RTE.	SECTION	COUNTY	TOTAL SHEETS	SHEET NO.
312	101-2(RS-1,N-1)	ALEXANDER	189	138
STA. 5+425.00		TO STA. 5+450.00		
FED. ROAD DIST. NO.		ILLINOIS	FED. AID PROJECT	
44	46	48	50	52

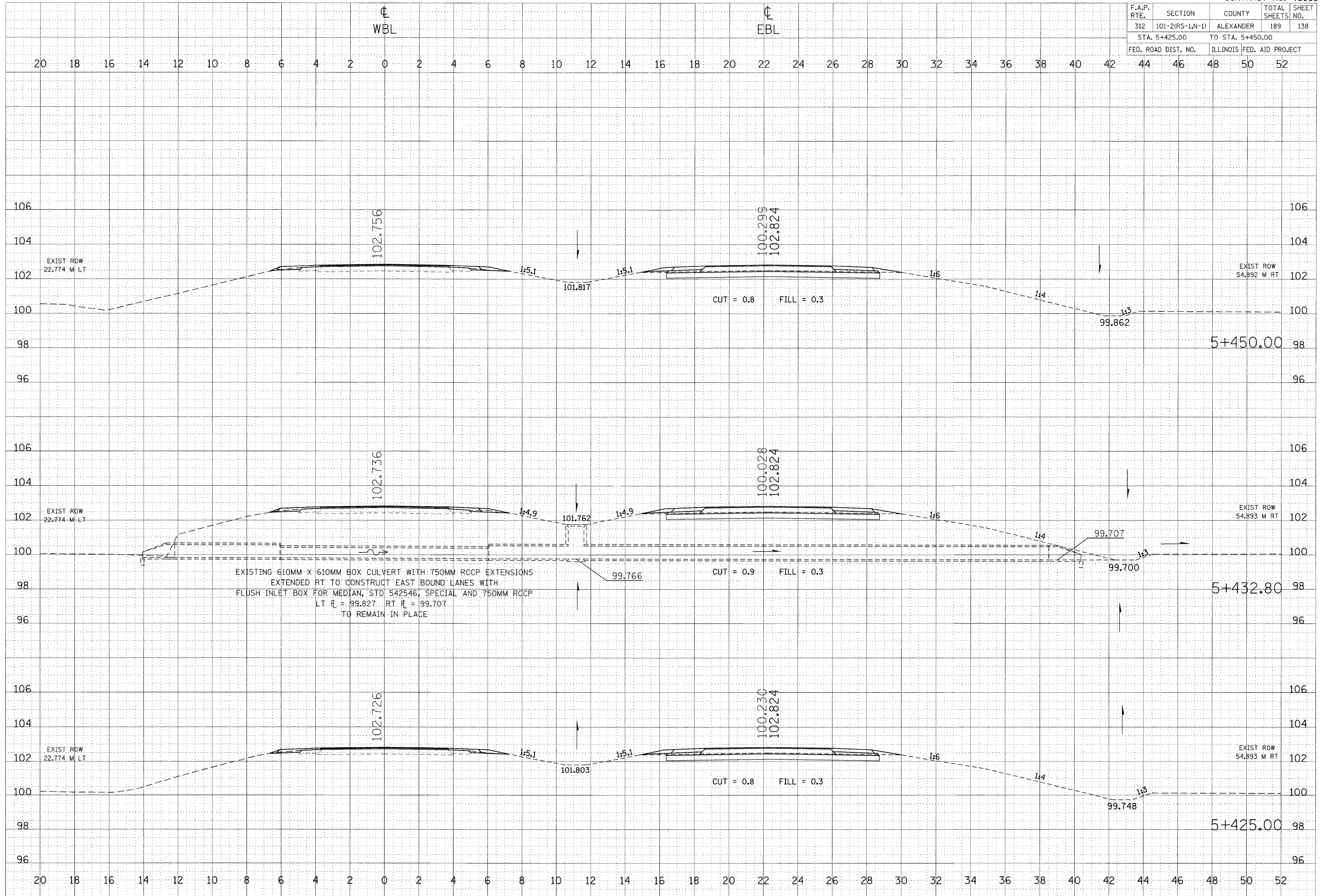

EXISTING 610MM X 610MM BOX CULVERT WITH 750MM RCCP EXTENSIONS
 EXTENDED RT TO CONSTRUCT EAST BOUND LANES WITH
 FLUSH INLET BOX FOR MEDIAN, STD 542546, SPECIAL AND 750MM RCCP
 LT \bar{r} = 99.827 RT \bar{r} = 99.707
 TO REMAIN IN PLACE

FINAL SURVEY	SURVEYED	BY	DATE
NOTE BOOK	PLOTTED		
NO.	AREAS CHECKED		

ORIGINAL SURVEY	SURVEYED	BY	DATE
NOTE BOOK	PLOTTED		
NO.	AREAS CHECKED		

PLOT DATE = 9/17/2009
 FILE NAME = c:\npw\work\1011\1011.dwg
 PLOT SCALE = 100.0000 m / H.
 USER NAME = jefwarcnd