

F.A.P. RTE.	SECTION	COUNTY	TOTAL SHEETS	SHEET NO.
312	101-2(RS-1,N-1)	ALEXANDER	189	133
STA. 5+075.00		TO STA. 5+097.70		
FED. ROAD DIST. NO.		ILLINOIS	FED. AID PROJECT	

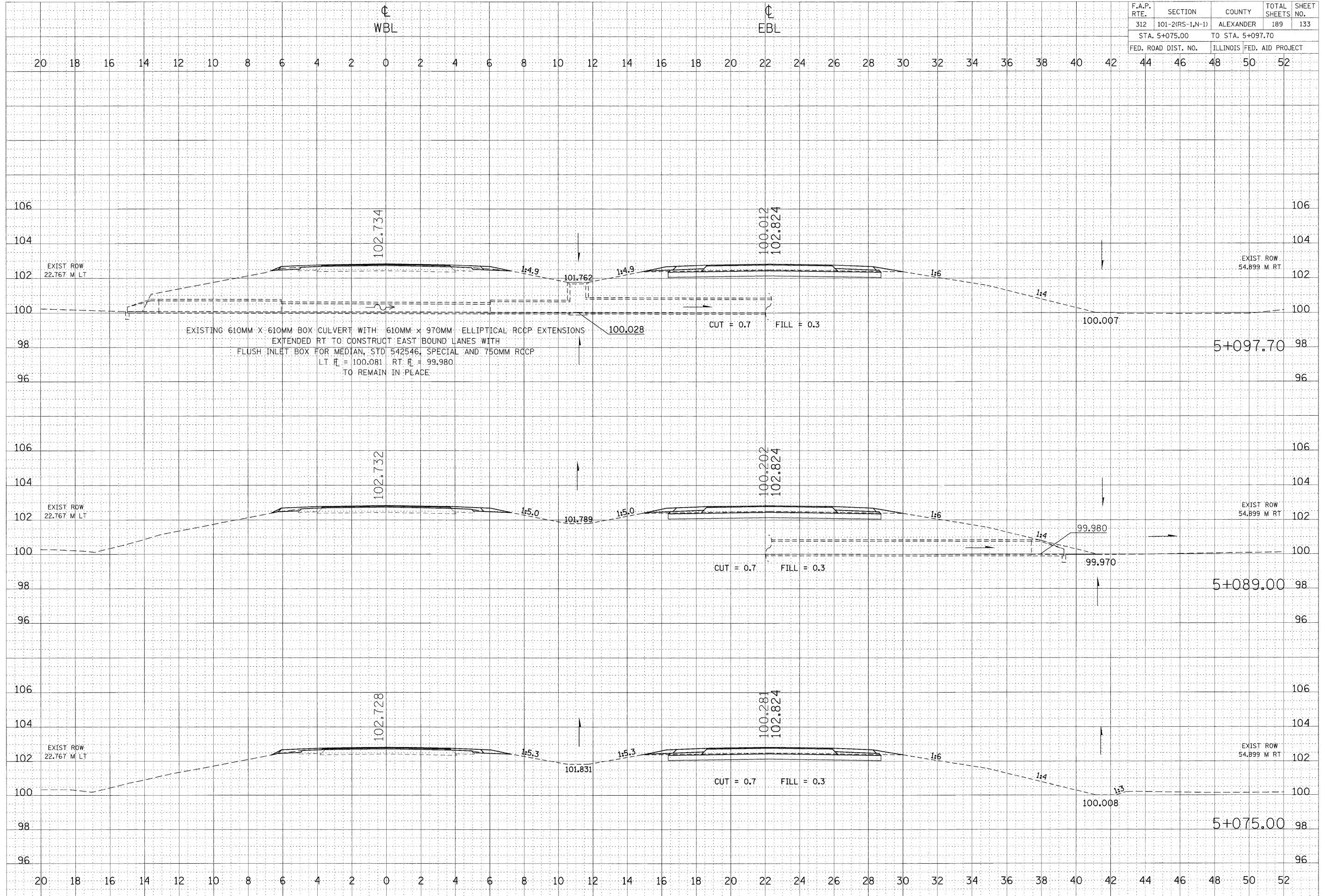

EXISTING 610MM X 610MM BOX CULVERT WITH 610MM x 970MM ELLIPTICAL RCCP EXTENSIONS
 EXTENDED RT TO CONSTRUCT EAST BOUND LANES WITH
 FLUSH INLET BOX FOR MEDIAN, STD 542546, SPECIAL AND 750MM RCCP
 LT ℓ = 100.081 RT ℓ = 99.980
 TO REMAIN IN PLACE

DATE	
BY	
FINAL SURVEY	
NOTED	
NO. AREAS CHECKED	

DATE	
BY	
ORIGINAL SURVEY	
NOTED	
NO. AREAS CHECKED	

PLOT DATE = 9/17/2009
 FILE NAME = c:\pvc-works\pvc\DOT\LEFT\TWOCHOLE\090910\02599ps-R146shps-C2.m32
 PLOT SCALE = 100.0000 m / M.
 USER NAME = ler@twinkl