

F.A.P. RTE.	SECTION	COUNTY	TOTAL SHEETS	SHEET NO.
312	101-2(RS-1,N-1)	ALEXANDER	189	108
STA. 3+320.21		TO STA. 3+350.00		
FED. ROAD DIST. NO.		ILLINOIS	FED. AID PROJECT	

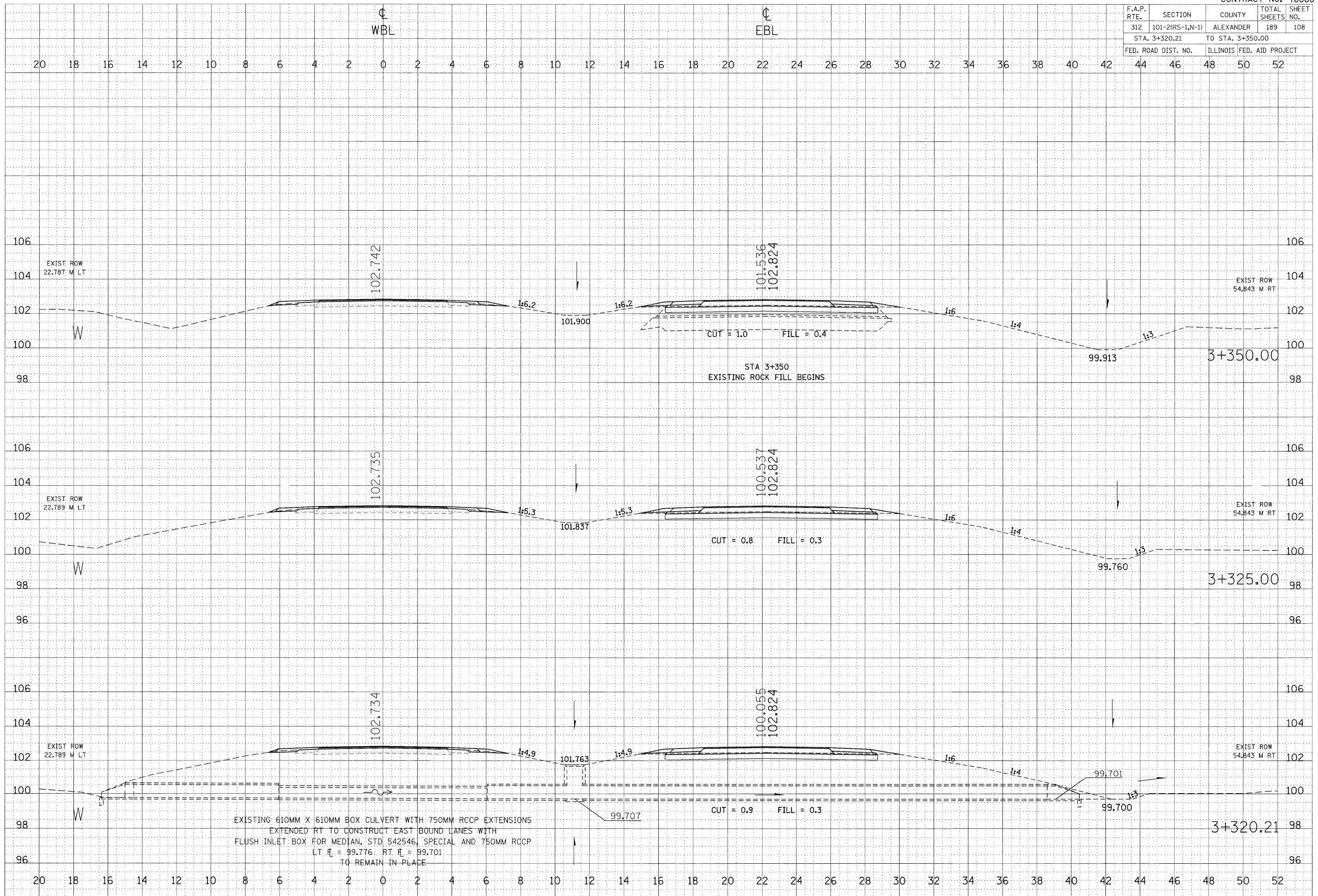

EXISTING 610MM X 610MM BOX CULVERT WITH 750MM RCCP EXTENSIONS
 EXTENDED RT TO CONSTRUCT EAST BOUND LANES WITH
 FLUSH INLET BOX FOR MEDIAN, STD 542546, SPECIAL AND 750MM RCCP
 LT ℓ = 99.776 RT ℓ = 99.701
 TO REMAIN IN PLACE

FINAL SURVEY BY DATE
 SURVEYED BY DATE
 CHECKED BY DATE
 NOTE BOOK NO.
 AREAS CHECKED

ORIGINAL SURVEY BY DATE
 SURVEYED BY DATE
 CHECKED BY DATE
 NOTE BOOK NO.
 AREAS CHECKED

PLOT DATE = 9/17/2009
 FILE NAME = G:\pwork\146\1001\LEFT\WBL\101-2(RS-1,N-1)\101-2(RS-1,N-1)-R146.mxd
 USER NAME = jef@acandl