

F.A.P. RTE.	SECTION	COUNTY	TOTAL SHEETS	SHEET NO.
312	101-2(RS-1,N-1)	ALEXANDER	189	85
STA.		TO STA.		
FED. ROAD DIST. NO.		ILLINOIS	FED. AID PROJECT	

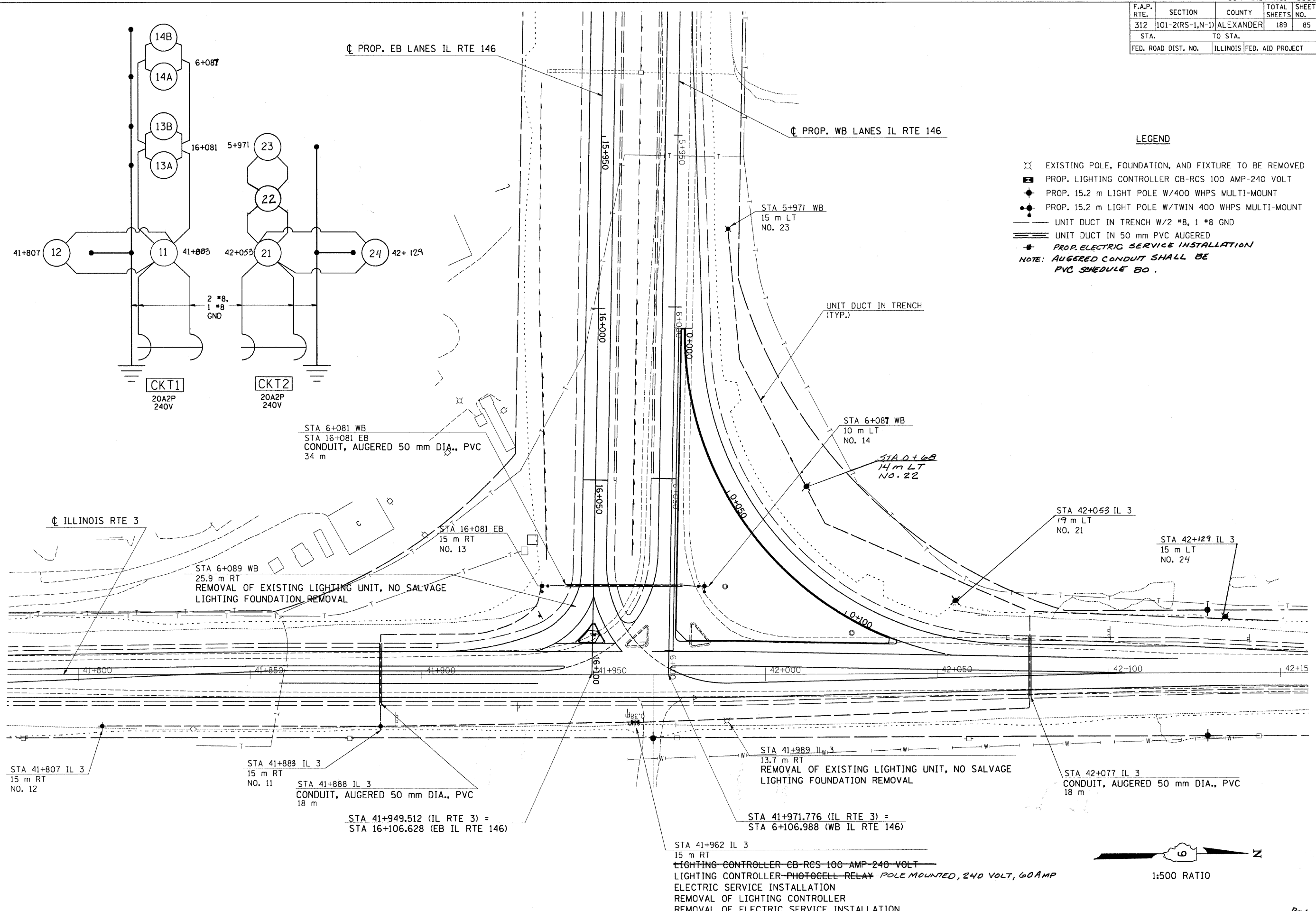

LEGEND

- ⊗ EXISTING POLE, FOUNDATION, AND FIXTURE TO BE REMOVED
 - ⊠ PROP. LIGHTING CONTROLLER CB-RCS 100 AMP-240 VOLT
 - PROP. 15.2 m LIGHT POLE W/400 WHPS MULTI-MOUNT
 - ⊙ PROP. 15.2 m LIGHT POLE W/TWIN 400 WHPS MULTI-MOUNT
 - UNIT DUCT IN TRENCH W/2 #8, 1 #8 GND
 - ≡≡≡ UNIT DUCT IN 50 mm PVC AUGERED
 - ⚡ PROP. ELECTRIC SERVICE INSTALLATION
- NOTE: AUGERED CONDUIT SHALL BE PVC SCHEDULE 80.

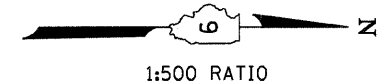

Monday, September 14, 2009 @ 11:09:30 AM
 c:\pwworking\KRW\DOT\KRW\ZJC\dms43640\pmpgepci.dgn LV=2-45,47-63