

F.A.P. RTE.	SECTION	COUNTY	TOTAL SHEETS	SHEET NO.
312	101-2(RS-1,N-1)	ALEXANDER	189	65
STA.		TO STA.		
FED. ROAD DIST. NO.		ILLINOIS FED. AID PROJECT		

NOTE: CONSTRUCTION LIMITS ON NORTH SIDE HAVE BEEN OMITTED FOR CLARITY.

BY	DATE

FINAL SURVEY PLOTTED
NOTE BOOK TEMPLATE AREAS CHECKED



1:500 RATIO

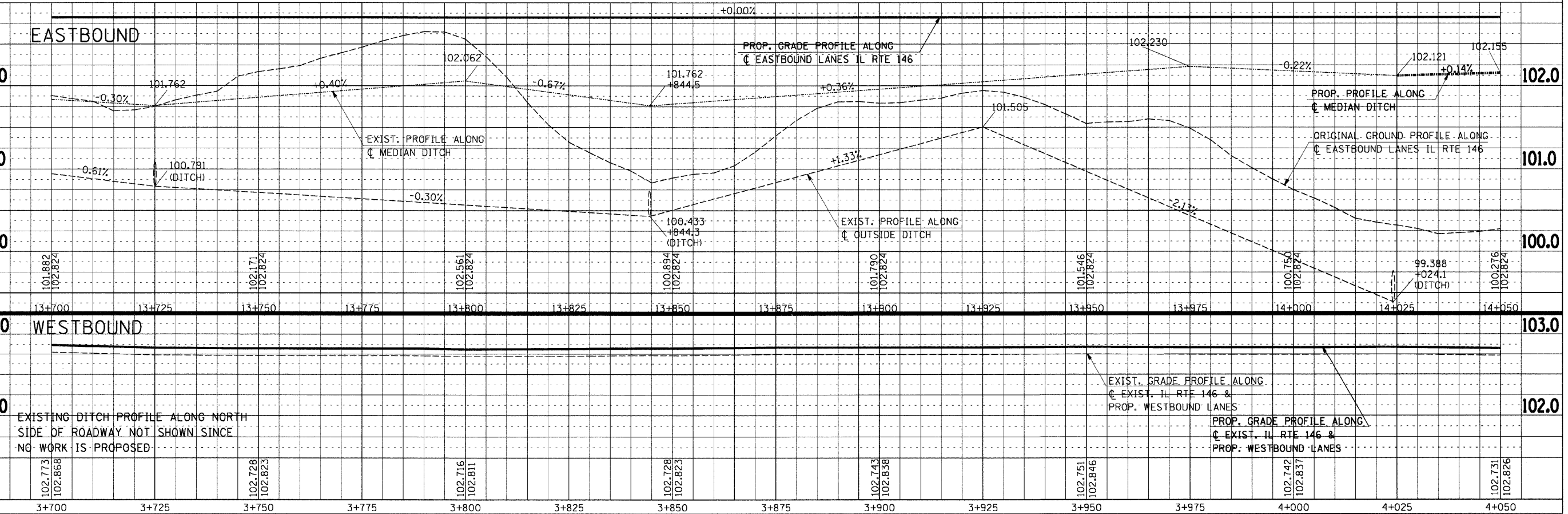
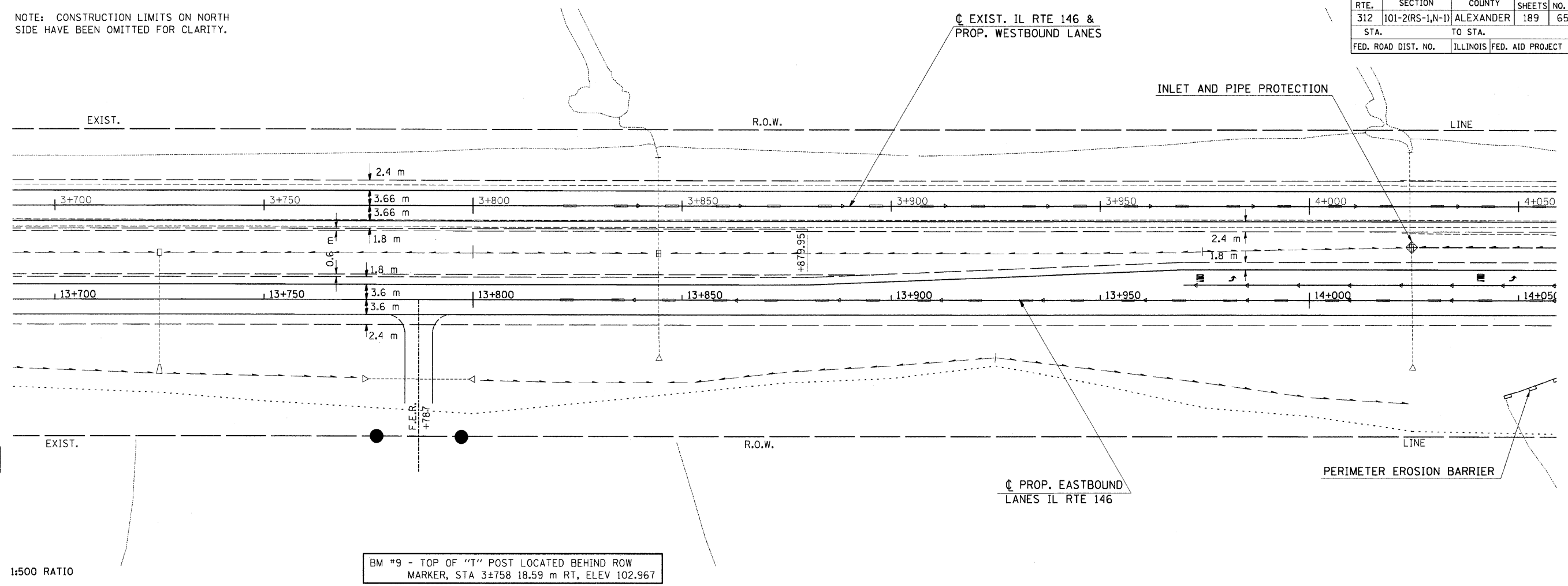

Tuesday September 15, 2009 @ 9:00:23 AM
 c:\pwworkspace\pwworkspace\Kranz\JC\mms43640\m0259991.dgn LV=2-23-25-63
 c:\pwworkspace\pwworkspace\Kranz\JC\mms39843\m0259991.dgn LV=1-5-7-15-17-20-24-62
 c:\pwworkspace\pwworkspace\Kranz\JC\mms39843\m0259991.dgn LV=2-9-11-13-17-19-23-25-48-50-62