

F.A.P. RTE.	SECTION	COUNTY	TOTAL SHEETS	SHEET NO.
312	101-2(RS-1,N-1)	ALEXANDER	189	56
STA.	TO STA.			
FED. ROAD DIST. NO.	ILLINOIS	FED. AID PROJECT		

STAGE 2 NOTES:

TRAFFIC:

IL 146: TRAFFIC ON NORTH LANES
 IL 3: SHIFT TRAFFIC TO EAST SIDE OF PAVEMENT

PROPOSED WORK:

BUILD ASPHALT GRADE RAISE ON IL 3
 BUILD ASPHALT TAPER FOR TRAFFIC ON IL 146 NORTH LANES
 USE TRAFFIC CONTROL STANDARD 701306 FOR IL 3 HMA RESURFACING/GRADE RAISE
 USE TRAFFIC CONTROL STANDARD 701326 FOR IL 3 HMA WIDENING
 USE TRAFFIC CONTROL AND PROTECTION, (SPECIAL)

LEGEND:

X STOP SIGN

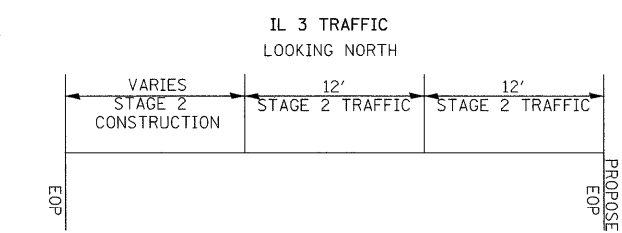
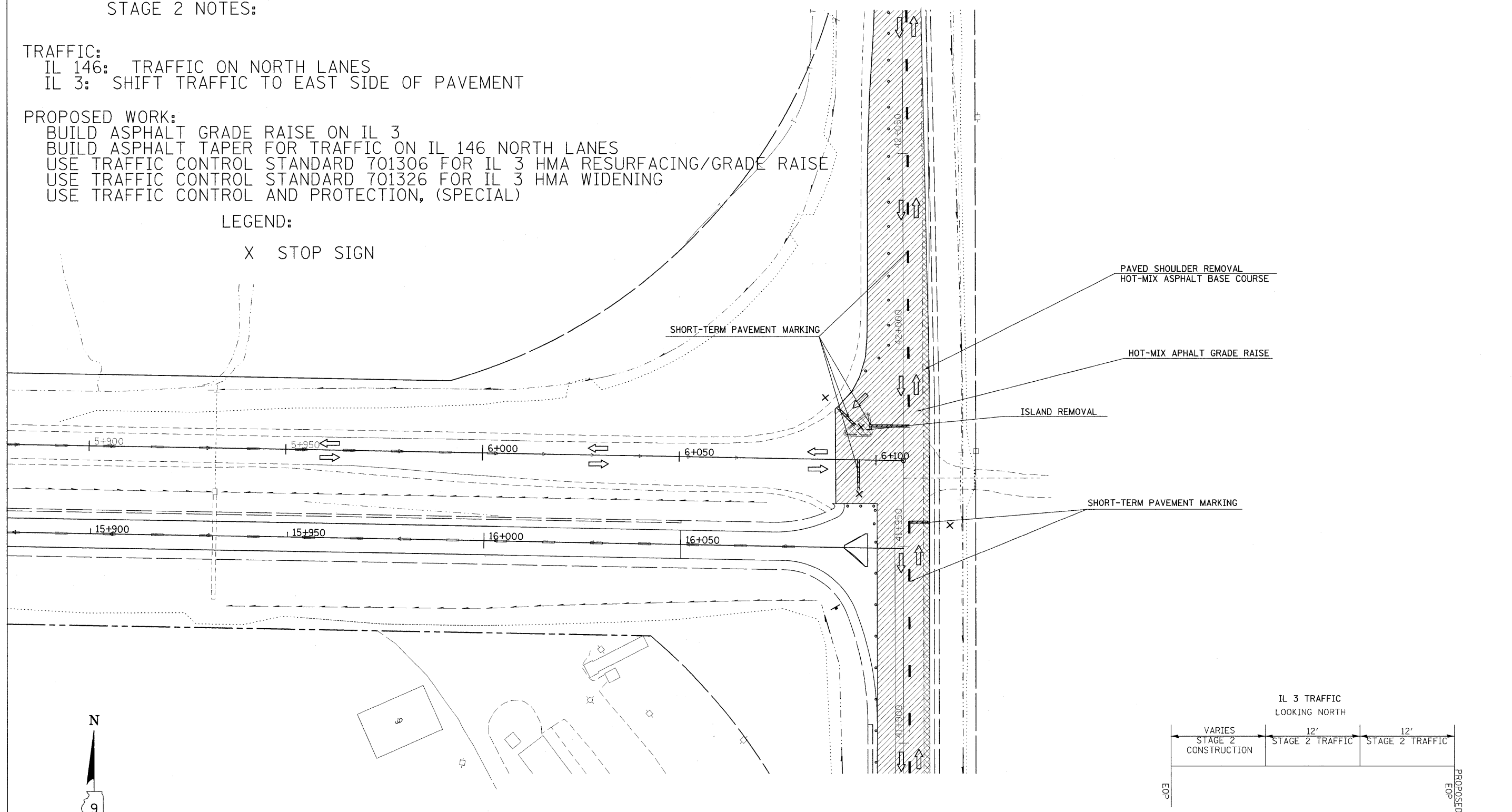

NOTE: ANY EXTRA BARRICADES, SIGNS, OR TRAFFIC CONTROL REQUIRED BY THE ENGINEER OR PLANS WILL BE INCLUDED IN THE COST OF THE TRAFFIC CONTROL AND PROTECTION, (SPECIAL). NO EXTRA COMPENSATION WILL BE GIVEN.

REVISIONS		ILLINOIS DEPARTMENT OF TRANSPORTATION
NAME	DATE	
		<p>STAGE 2 IL146/IL3 INTERSECTION</p> <p>DRAWN BY JCK CHECKED BY</p> <p>DATE</p>

PLOT DATE = 9/4/2010
 FILE NAME = c:\pwworkspace\p11001\VRANZ\JC\dms43640\m02599a2-sched.dgn
 PLOT SCALE = 12.7000 / IN.
 USER NAME = hrenzjc