

F.A.P. RTE.	SECTION	COUNTY	TOTAL SHEETS	SHEET NO.
315	(7,B)-I & (1)I-1, (2)I-2	MASON	34	1

D-96-194-10

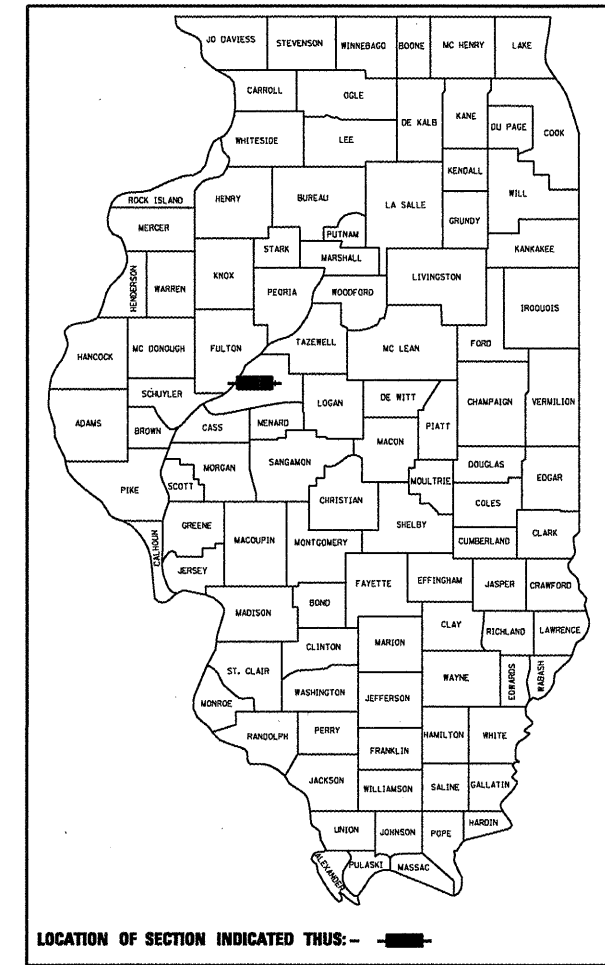

A.D.T. = 2700 (2008) - 21% TRUCKS

STATE OF ILLINOIS
DEPARTMENT OF TRANSPORTATION
DIVISION OF HIGHWAYS

SUBMITTED MARCH 23 2010
Rep Z Dmby DISTRICT ENGINEER

May 7 2010
Scott E. Stitt, P.E. & Co. ENGINEER OF DESIGN AND ENVIRONMENT

May 7 2010
Christine M. Reed, Esq. DIRECTOR, DIVISION OF HIGHWAYS

PRINTED BY THE AUTHORITY
OF THE STATE OF ILLINOIS

STATE OF ILLINOIS
DEPARTMENT OF TRANSPORTATION
DIVISION OF HIGHWAYS

**PROPOSED
HIGHWAY PLANS**

F.A.P. ROUTE 315 (US 136)
SECTION (7,B)-I & (1)I-1, (2)I-2
MASON COUNTY
C-96-194-10

PROJ. ACF-0315(059)

INDEX OF SHEETS

1	COVER SHEET
2	GENERAL NOTES
3	SUMMARY OF QUANTITIES
4-10	TYPICAL SECTIONS
11-14	SCHEDULE OF QUANTITIES
15-33	PLAN SHEETS
34	RUMBLE STRIP DETAILS

HIGHWAY STANDARDS

000001-05
701011-02
701201-03
701301-03
701306-02
701311-03
701326-03
701501-05
701901-01

LIMITS OF IMPROVEMENT
BEGINS AT STA. 9+15.52

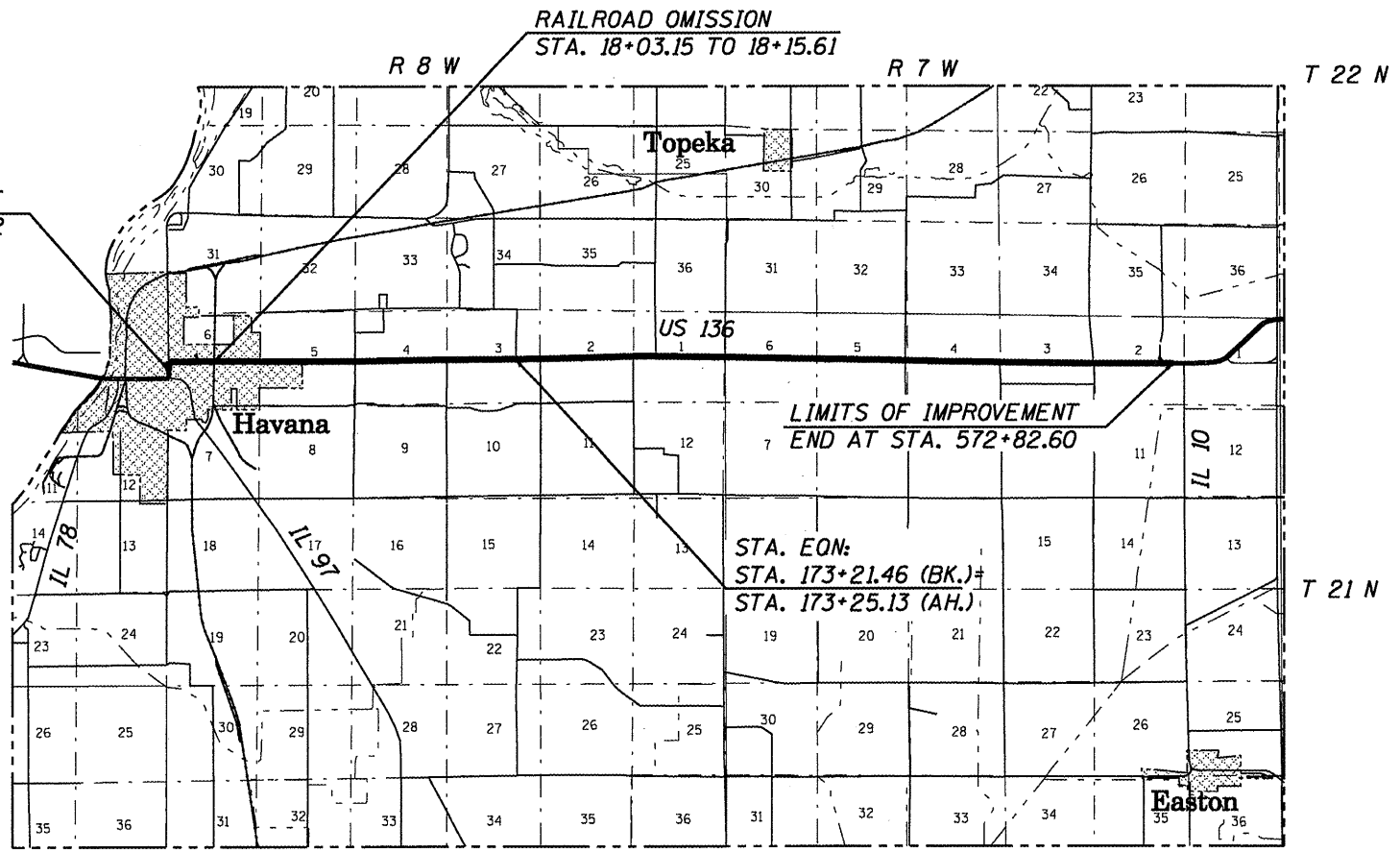

LOCATION MAP

GROSS LENGTH = 56350.98 ft. = 10.67 mi.
NET LENGTH = 56,363.44 ft. = 10.67 mi.

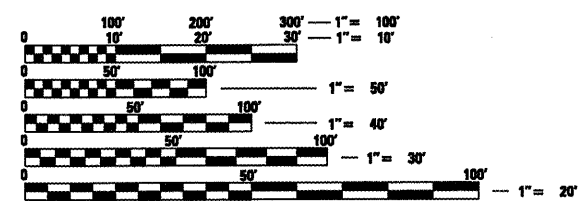

FULL SIZE PLANS HAVE BEEN PREPARED USING STANDARD
ENGINEERING SCALES. REDUCED SIZED PLANS WILL NOT
CONFORM TO STANDARD SCALES. IN MAKING MEASUREMENTS
ON REDUCED PLANS, THE ABOVE SCALES MAY BE USED.

J.U.L.I.E.
JOINT UTILITY LOCATION INFORMATION FOR EXCAVATION
1-800-892-0123

CONTRACT NO. 72D61

PROJECT ENGINEER: SAL MADONIA (217) 782-4761
TEAM LEADER: BRIAN LAMINGHAM (217) 524-0472