

EXIST. CURVE DATA	PROP. S.E. DATA
PI STA. = 333+53.12	e = 2.5%
$\Delta$ = 33° 47' 00" (LT)	T.R. = 40'
D = 2° 00' 01"	S.E. RUN = 66'
R = 2,864.35'	
T = 869.80'	
L = 1,688.91'	
E = 129.15'	
P.C. STA. = 324+83.32	
P.T. STA. = 341+72.23	
e = 2.5%	
ATTAIN SUPER	
STA. 324+23 TO STA. 325+42	
REMOVE SUPER	
STA. 341+12 TO STA. 342+31	

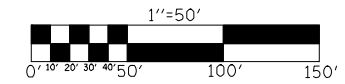
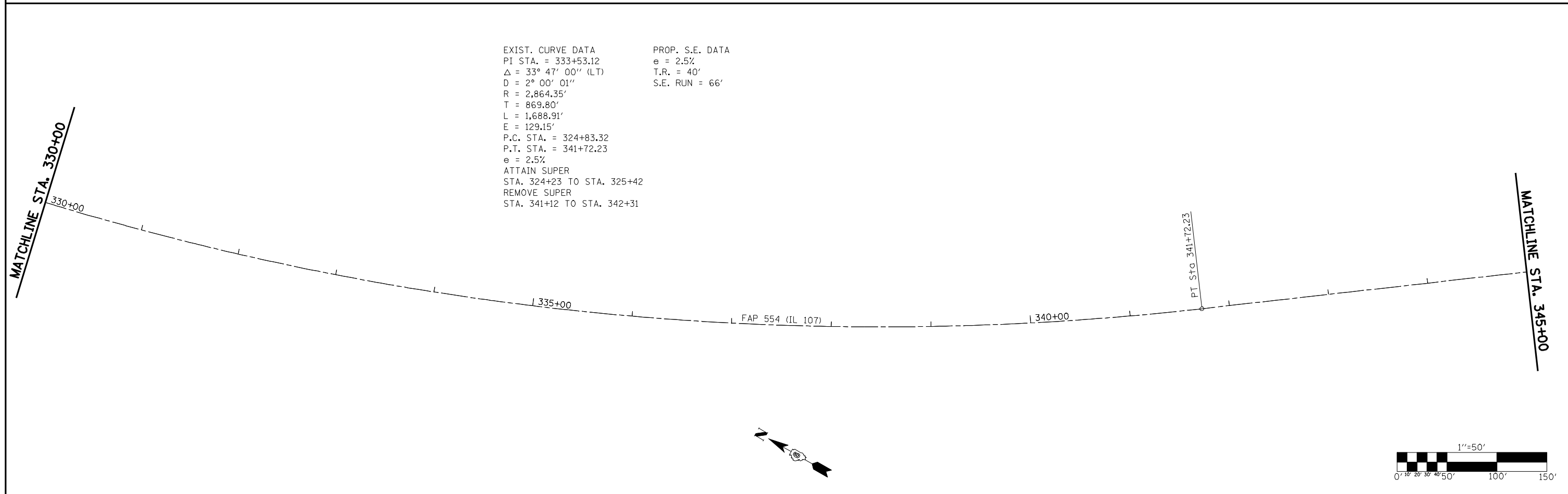

FILE NAME =	USER NAME = laughlinr1	DESIGNED -	REVISED -
e:\pwwork\pwidot\LAUGHLINRL\0200040\672C37-shr-plan.dgn		DRAWN -	REVISED -
		CHECKED -	REVISED -
		DATE -	REVISED -

**STATE OF ILLINOIS  
DEPARTMENT OF TRANSPORTATION**

**PLAN SHEET FAP 554 (ILLINOIS 107)**

SCALE: 1" = 50'    SHEET NO.    OF    SHEETS    STA. 315+00 TO STA. 345+00

F.A.P. RTE.	SECTION	COUNTY	TOTAL SHEETS	SHEET NO.
554	16(RS-6) & 18(RS-6)	BROWN	49	26
CONTRACT NO. 72C37				
ILLINOIS FED. AID PROJECT				

