

EXIST. CURVE DATA  
 PI STA. = 235+72.03  
 $\Delta = 34^\circ 21' 00''$  (LT)  
 D = 2° 29' 59"  
 R = 2,292.01'  
 T = 708.40'  
 L = 1,374.11'  
 E = 106.98'  
 P.C. STA. = 228+63.63  
 P.T. STA. = 242+37.74  
 e = 2.5%  
 ATTAIN SUPER  
 STA. 227+88 TO STA. 229+37  
 REMOVE SUPER  
 STA. 241+62 TO STA. 243+11

PROP. S.E. DATA  
 e = 2.5%  
 T.R. = 40'  
 S.E. RUN = 66'

MATCHLINE STA. 225+00

MATCHLINE STA. 240+00

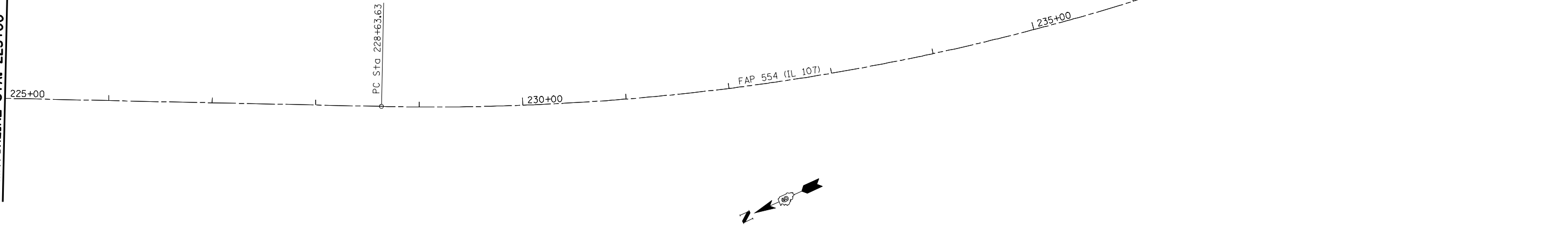

MATCHLINE STA. 240+00

MATCHLINE STA. 255+00

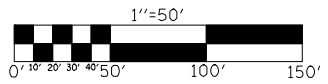
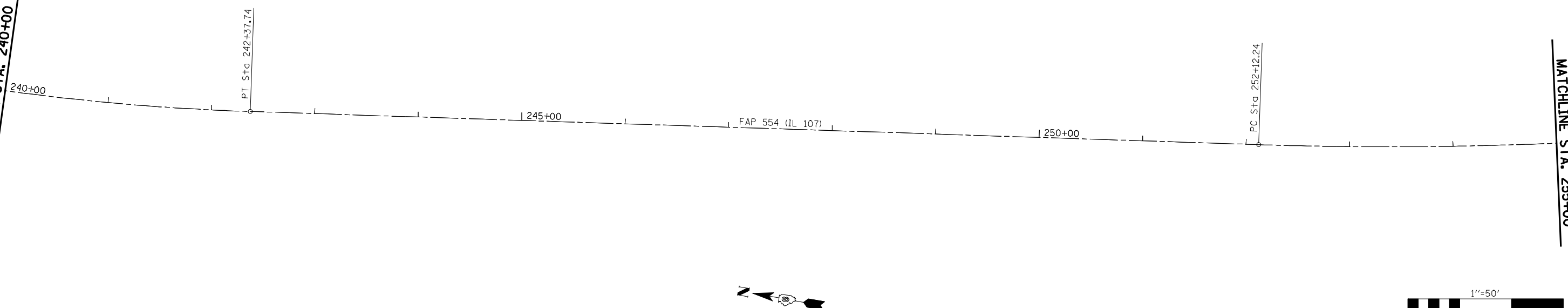

FILE NAME = e:\pwwork\pwwid\LAUGHLINRL\0200040\672C37-shr-plan.dgn	USER NAME = laughlinr1	DESIGNED -	REVISED -
Johnson, Depp & Quisenberry CONSULTING ENGINEERS Springfield, Illinois	PLOT SCALE = 100.0000' / IN. PLOT DATE = Apr-08-2010 03:19:28PM	DRAWN -	REVISED -
		CHECKED -	REVISED -
		DATE -	REVISED -

**STATE OF ILLINOIS  
 DEPARTMENT OF TRANSPORTATION**

**PLAN SHEET FAP 554 (ILLINOIS 107)**

SCALE: 1" = 50'    SHEET NO.    OF    SHEETS    STA. 225+00 TO STA. 255+00

F.A.P. RTE.	SECTION	COUNTY	TOTAL SHEETS	SHEET NO.
554	16(RS-6) & 18(RS-6)	BROWN	49	23
CONTRACT NO. 72C37				
ILLINOIS FED. AID PROJECT				