

NOT TO SCALE

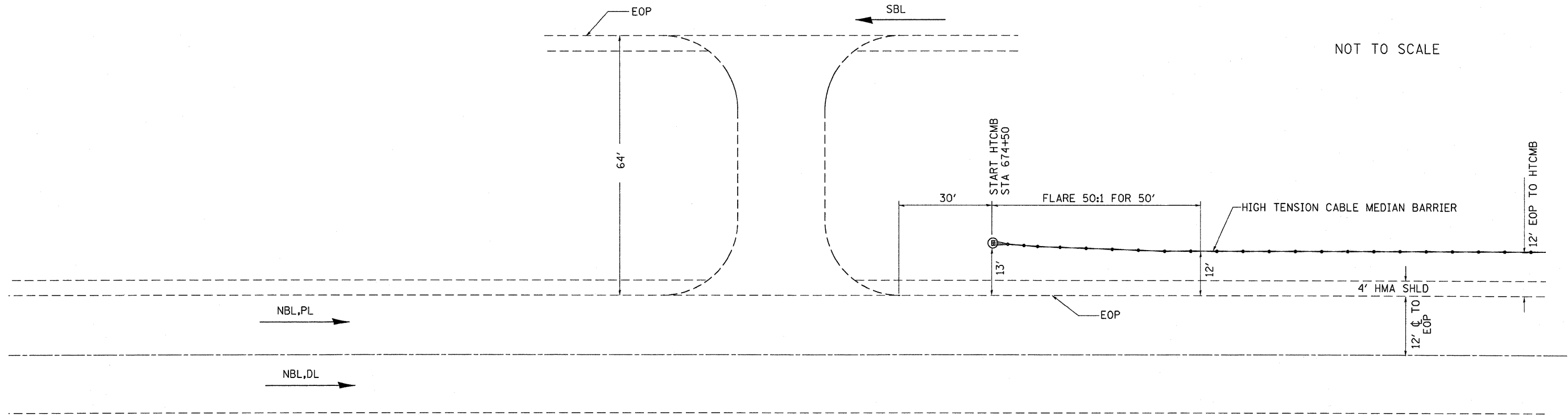

- NOTES:
1. POSTS SHALL BE DRIVEN IN ACCORDANCE WITH MANUFACTURES SPECIFICATIONS.
  2. POST SPACING MAY BE ALTERED TO AVOID DRAINAGE OR OTHER OBSTACLES.

**HIGH TENSION CABLE  
MEDIAN BARRIER SYSTEM**

HTCMB RUNS FROM MAINTENANCE CROSS-OVER  
NORTH OF THE MANTENO INTERCHANGE TO THE  
WILL COUNTY LINE

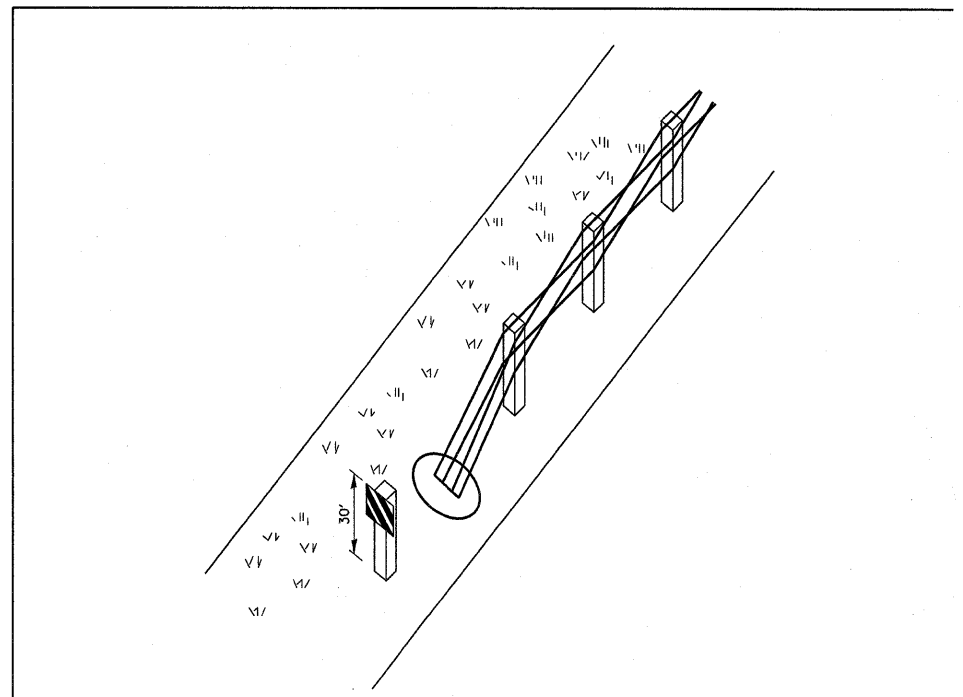

**HIGH TENSION CABLE MEDIAN BARRIER  
TERMINAL MARKER-POST MOUNTED DETAIL**

FILE NAME =	USER NAME = braboypp	DESIGNED -	REVISED -	<b>STATE OF ILLINOIS DEPARTMENT OF TRANSPORTATION</b>	<b>HIGH TENSION CABLE MEDIAN BARRIER SYSTEM</b>	F.A.I. RTE.	SECTION	COUNTY	TOTAL SHEETS	SHEET NO.	
c:\pw_work\p\dot\braboypp\dms30564\det	11.s.dgn	DRAWN -	REVISED -			57	146-1.21BS-3 & I	KANKAKEE	115	56	
		CHECKED -	REVISED -			CONTRACT NO. 66608					
		DATE -	REVISED -			ILLINOIS FED. AID PROJECT					
		PLOT SCALE = 1/250.0000 ' / IN.		SCALE: _____ SHEET NO. ___ OF ___ SHEETS STA. _____ TO STA. _____							
		PLOT DATE = Mar 25, 2010 - 12:29:58 PM									