

DESIGN SPECIFICATIONS

2002 AASHTO Standard Specifications for Highway Bridges, 17th Edition

DESIGN STRESSES

FIELD UNITS

$f'_c = 3,500 \text{ psi}$
 $f_y = 60,000 \text{ psi (Reinforcement)}$

EXISTING CONSTRUCTION

$f'_c = 3,500 \text{ psi}$
 $f_s = 20,000 \text{ psi (Reinforcement)}$

STATE OF ILLINOIS
 DEPARTMENT OF TRANSPORTATION

HIGHWAY CLASSIFICATION

F.A.I. Rte. I-57 - Interstate 57
 Functional Class: Interstate
 ADT: 27,400 (2007); 54,000 (2027)
 (Two-Way)
 Posted Speed: 65 m.p.h.

T.R. 27
 Functional Class: Local Road, (Non-Urban)
 ADT: 50 (2002); 75 (2027)

PROPOSED WORK:

1. Repair spalling and delaminations on the East Abutment and Piers 1 and 3.
2. Clean and paint exposed reinforcing bars at the underside of the superstructure as indicated on the superstructure repair plan (see sheet S25).
2. Remove and Replace portions of slopewall panels as indicated. Fill gaps between existing slopewall panel and abutments with Controlled Low-Strength Material (CLSM) as indicated (See Detail A, Sheet S24).

GENERAL NOTES:

1. Plan dimensions and details relative to existing plans are subject to nominal construction variations. The Contractor shall field verify existing dimensions and details affecting new construction and make necessary approved adjustments prior to construction or ordering of materials. Such variations shall not be cause for additional compensation for a change in scope of the work, however, the Contractor will be paid for the quantity actually furnished at the unit price bid for the work.

INDEX OF STRUCTURAL SHEETS

SHEET	TITLE
S23	GENERAL PLAN AND ELEVATION
S24	BILL OF MATERIAL
S25	SUPERSTRUCTURE REPAIR PLAN I
S26	SUPERSTRUCTURE REPAIR PLAN II
S27	SUBSTRUCTURE REPAIR PLAN

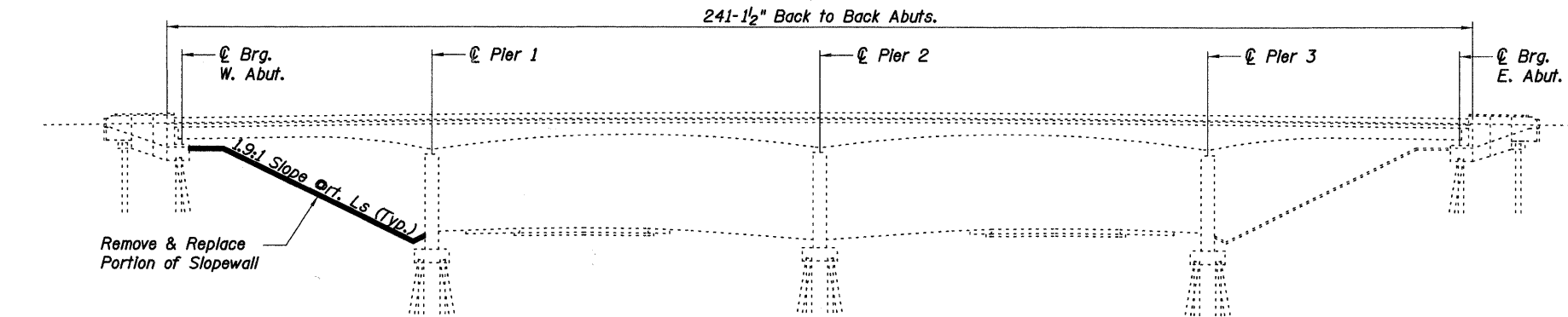

ELEVATION

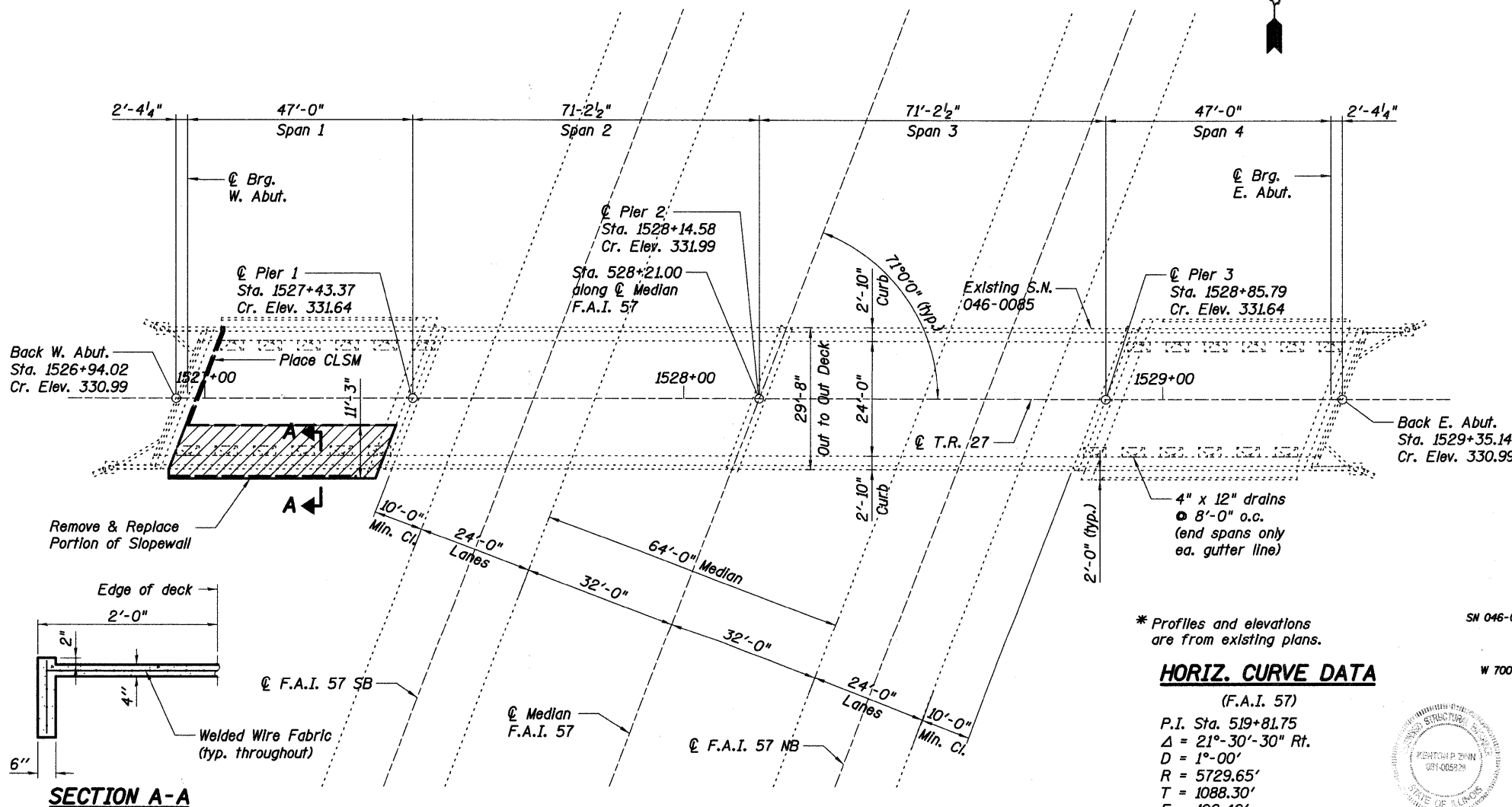

SECTION A-A

PLAN

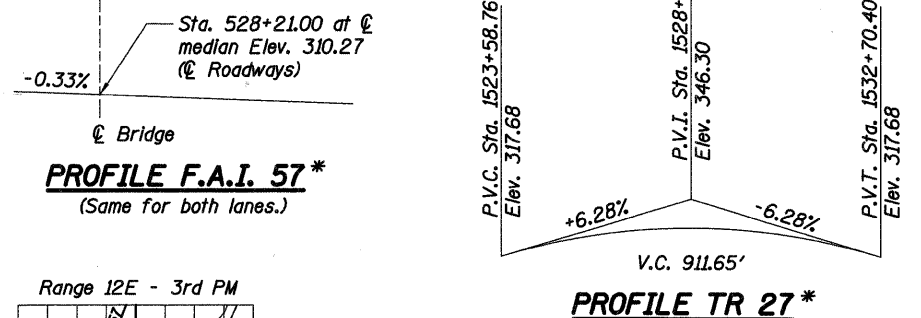

PROFILE F.A.I. 57*
 (Same for both lanes.)

PROFILE TR 27*

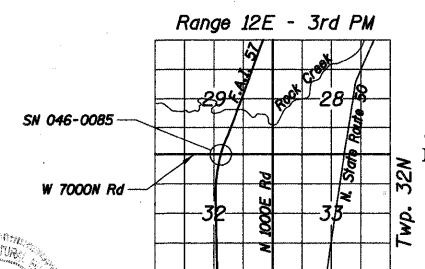

LOCATION SKETCH

GENERAL PLAN AND ELEVATION
T.R. 27 OVER I-57
F.A.I. RTE. 57 - SEC. (46-1,2)RS-3&I
KANKAKEE COUNTY
STA. 528+21.00
S.N. 046-0085

* Profiles and elevations are from existing plans.

HORIZ. CURVE DATA

(F.A.I. 57)
 P.I. Sta. 519+81.75
 $\Delta = 21^\circ - 30' - 30'' \text{ Rt.}$
 $D = 1^\circ - 00'$
 $R = 5729.65'$
 $T = 1088.30'$
 $E = 102.40'$
 $L = 2150.83'$
 $S = 0.01 \text{ FT/FT}$



Kenton P. Z...
 Expires: 11/16

SHEET NO.	F.A.I. RTE.	SECTION	COUNTY	TOTAL SHEETS	SHEET NO.
S23	57	(46-1,2)RS-3&I	KANKAKEE	115	48
S27 SHEETS					
			CONTRACT NO. 66608		
FED. ROAD DIST. NO. 7 ILLINOIS FED. AID PROJECT					

H:\18772.W01\3.0 deliverables\3.3 structure\Drawings\Final\0085genplan.dgn
 4/7/2010

DESIGNED:	GWG
CHECKED:	KPZ
DRAWN:	MAM
CHECKED:	KPZ