

STATE OF ILLINOIS  
DEPARTMENT OF TRANSPORTATION

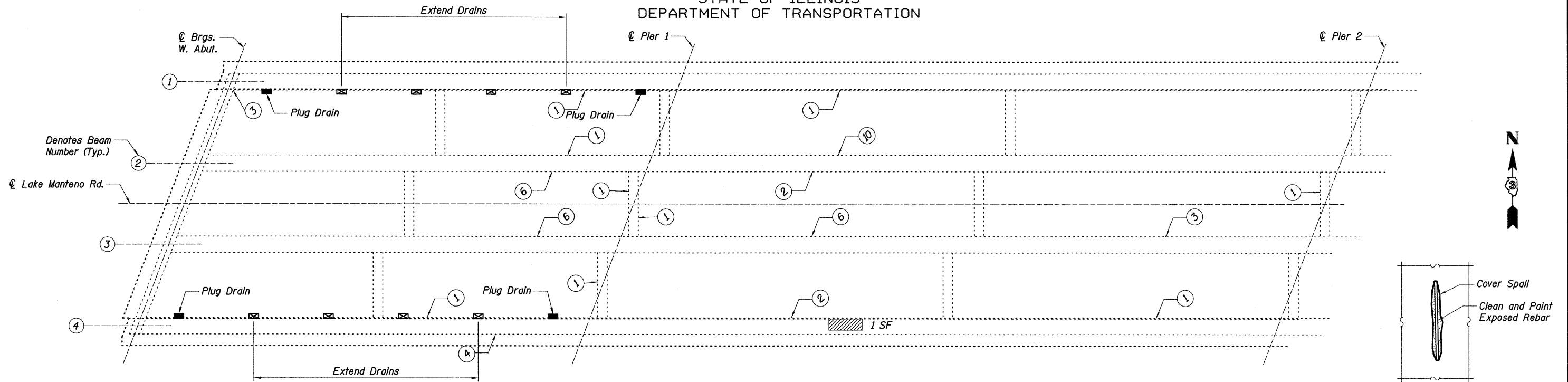

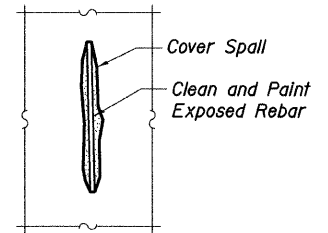

**CLEANING AND PAINTING  
EXPOSED REBAR**

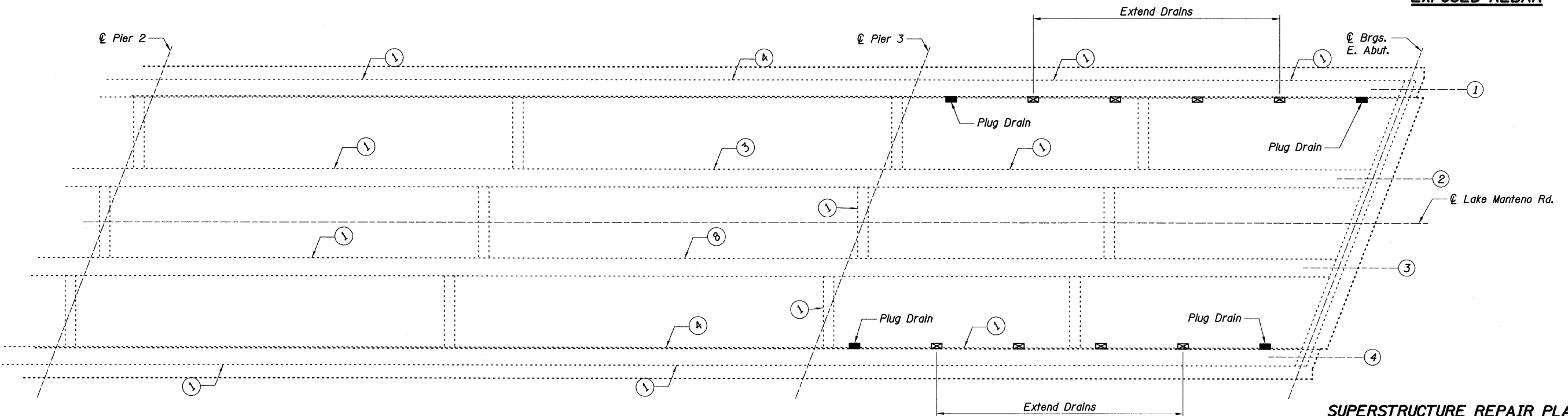

Denotes Beam  
Number (Typ.)

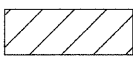

**SUPERSTRUCTURE REPAIR PLAN**

- LEGEND**
-  Structural Repair of Concrete (Depth Equal to or Less Than 5") - Top of Deck
  -  Structural Repair of Concrete (Depth Equal to or Less Than 5") - Bottom of Deck
  -  Denotes Number of Cover Spalls w/ Exposed Reinforcement to be Cleaned and Painted

**SUPERSTRUCTURE REPAIR PLAN I  
LAKE MANTENO RD. OVER I-57  
F.A.I. RTE. 57 - SEC. (46-1,2)RS-3&I  
KANKAKEE COUNTY  
STA. 697+99.50  
S.N. 046-0084**

h:\18772\_wol\3.0 deliverables\3.3 structure\drawings\find\c4\_0084superstr.dgn 4/7/2010

DESIGNED:	GWG
CHECKED:	KPZ
DRAWN:	MAN
CHECKED:	KPZ

**Baker**

SHEET NO. S19 S27 SHEETS	F.A.I. RTE.	SECTION	COUNTY	TOTAL SHEETS	SHEET NO.
	57	(46-1,2)RS-3&I	KANKAKEE	115	44
			CONTRACT NO. 66608		
FED. ROAD DIST. NO. 7 ILLINOIS FED. AID PROJECT					