

STATE OF ILLINOIS
DEPARTMENT OF TRANSPORTATION

DESIGN SPECIFICATIONS

2002 AASHTO Standard Specifications
for Highway Bridges, 17th Edition

DESIGN STRESSES

FIELD UNITS

$f'_c = 3,500$ psi
 $f_y = 60,000$ psi (Reinforcement)

EXISTING CONSTRUCTION

$f'_c = 3,500$ psi
 $f_s = 20,000$ psi (Reinforcement)

HIGHWAY CLASSIFICATION

F.A.I. Rte. I-57 - Interstate 57
Functional Class: Interstate
ADT: 32,300 (2007); 61,000 (2027)
(Two-Way)
Posted Speed: 65 m.p.h.

Lake Manteno Rd. (T.R. 11)
Functional Class: Collector (Non-Urban)
ADT: 1,450 (2007); 1,750 (2027)

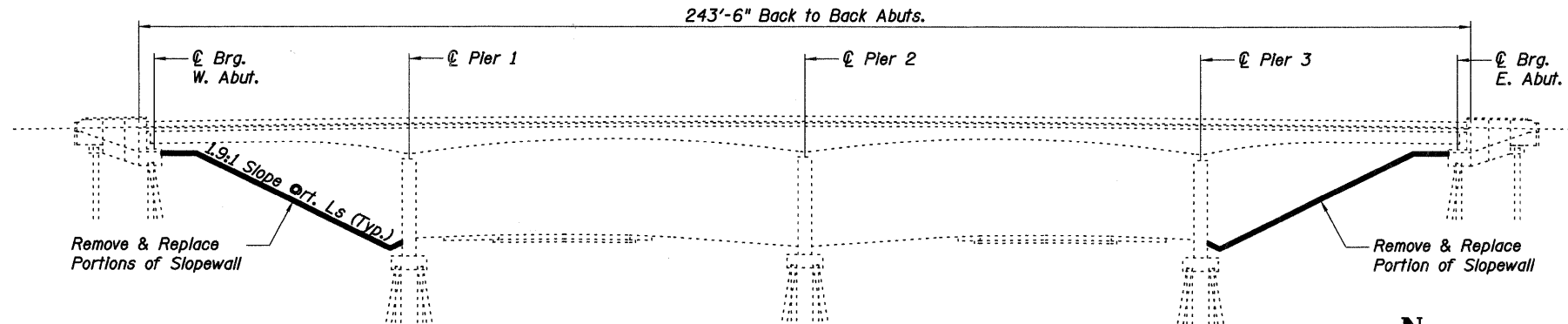

INDEX OF STRUCTURAL SHEETS

SHEET	TITLE
S16	GENERAL PLAN AND ELEVATION
S17	STAGING DIAGRAM AND BILL OF MATERIAL
S17A	STEEL RAILING REPAIR
S18	TEMPORARY CONCRETE BARRIER FOR STAGE CONSTRUCTION
S19	SUPERSTRUCTURE REPAIR PLAN I
S20	SUPERSTRUCTURE REPAIR PLAN II
S21	DRAIN MODIFICATION DETAILS
S22	SUBSTRUCTURE REPAIR PLAN

ELEVATION



PROPOSED WORK:

Traffic shall be maintained using stage construction.

1. Repair spall on the bridge curb.
2. Clean and paint exposed reinforcing bars at the underside of the superstructure as indicated on the superstructure repair plan (see sheet S19).
3. Repair spalls and delaminations on the East Abutment and the piers.
4. Replace damaged bridge rail transitions at the NE and SW corners of the bridge (see Roadway Plans for details).
5. Repair damaged bridge railing, and install missing rail bolts.
6. Plug deck drains within 10' of substructures and extend remaining deck drains.
7. Remove and Replace portions of slopewall panels as indicated. Fill gaps between existing slopewall panel and abutments with Controlled Low-Strength Material (CLSM) as indicated (See Detail A, Sheet S17).

GENERAL NOTES:

1. Plan dimensions and details relative to existing plans are subject to nominal construction variations. The Contractor shall field verify existing dimensions and details affecting new construction and make necessary approved adjustments prior to construction or ordering of materials. Such variations shall not be cause for additional compensation for a change in scope of the work, however, the Contractor will be paid for the quantity actually furnished at the unit price bid for the work.

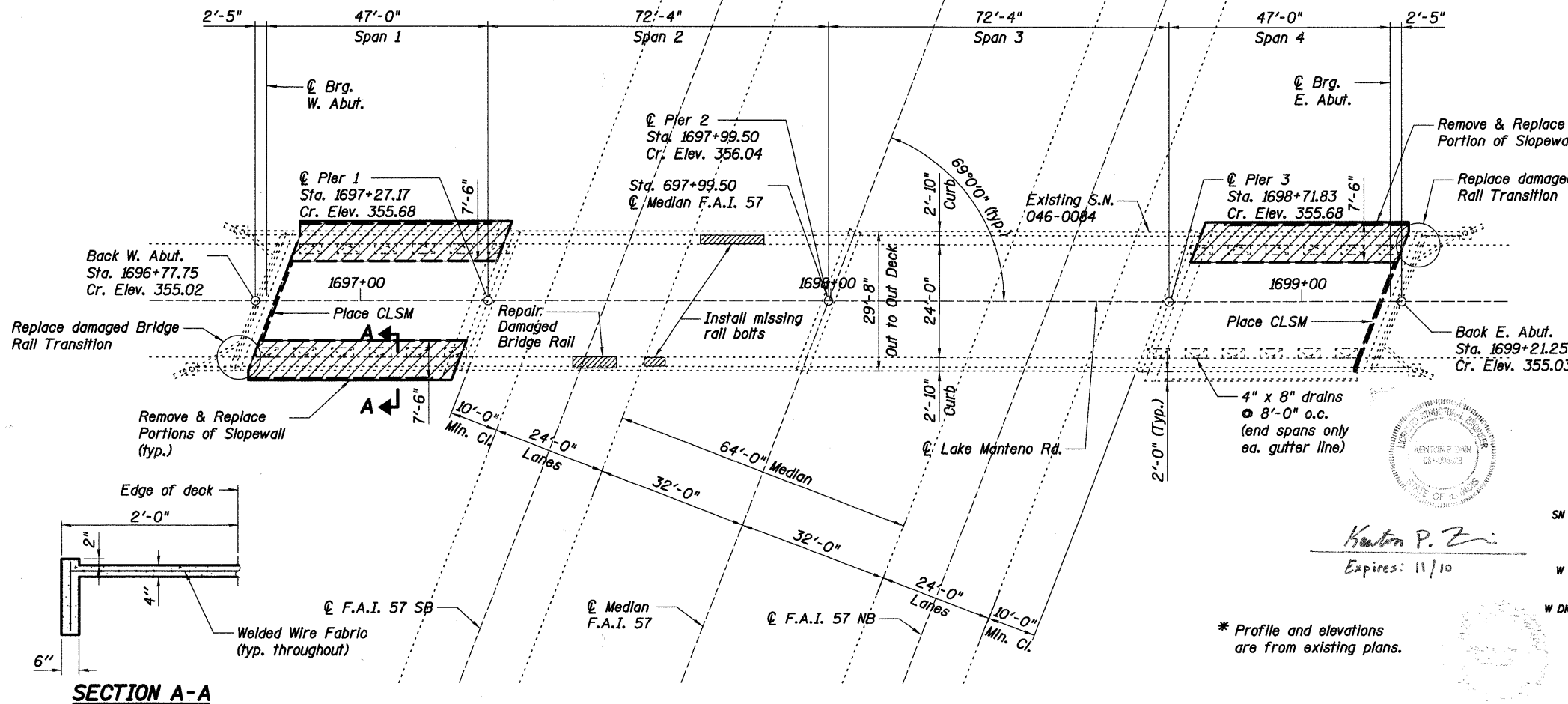

PLAN

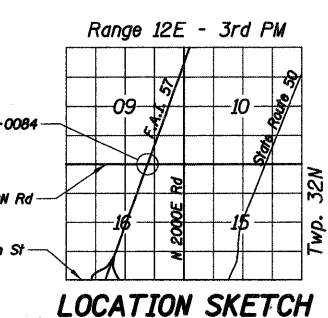
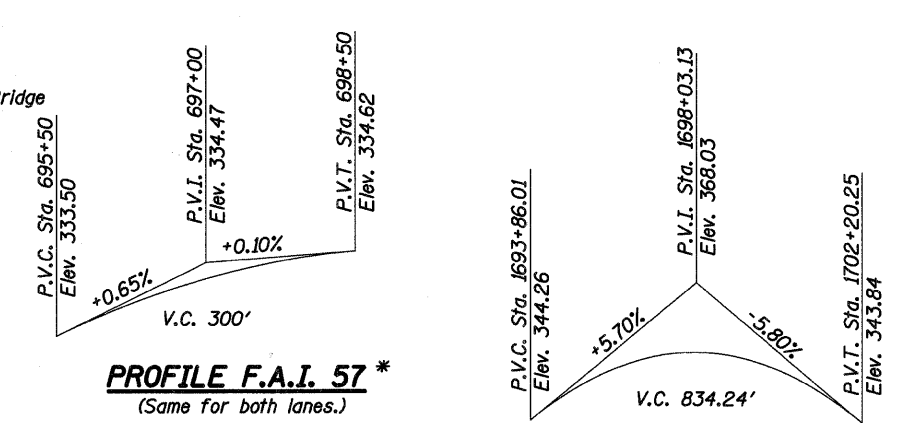

LOCATION SKETCH

Kenton P. Zi
Expires: 11/10

* Profile and elevations are from existing plans.

Baker

**GENERAL PLAN AND ELEVATION
LAKE MANTENO RD. OVER I-57
F.A.I. RTE. 57 - SEC. (46-1,2)RS-3&I
KANKAKEE COUNTY
STA. 697+99.50
S.N. 046-0084**

SHEET NO. S16	F.A.I. RTE.	SECTION	COUNTY	TOTAL SHEETS	SHEET NO.
	57	(46-1,2)RS-3&I	KANKAKEE	115	41
S27 SHEETS		CONTRACT NO. 66608			
FED. ROAD DIST. NO. 7 ILLINOIS FED. AID PROJECT					

H:\18772_W01\3.0 deliverables\3.3 structure\Drawings\Final\0084genplan.dgn 4/1/2010