

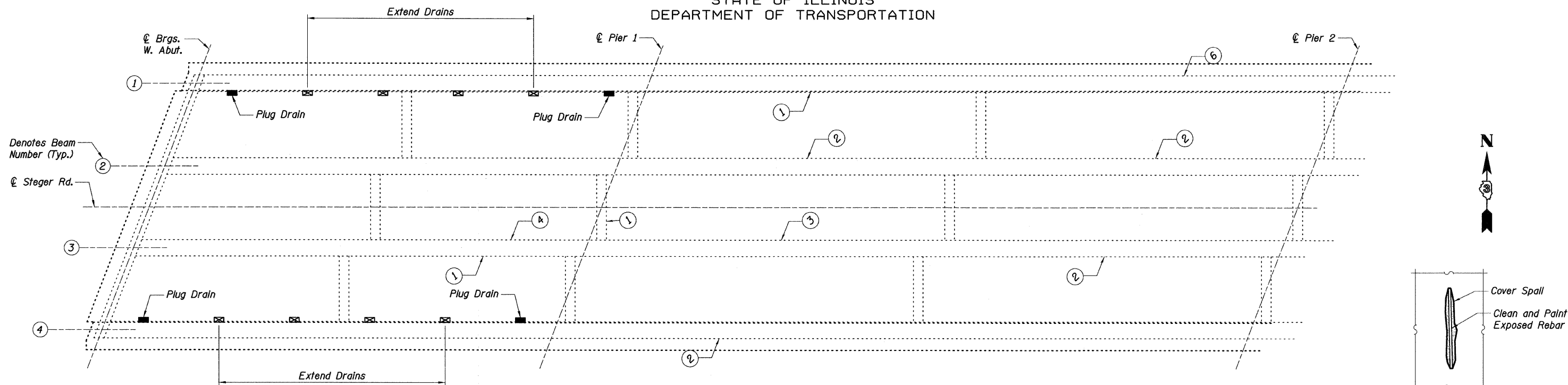

STATE OF ILLINOIS  
DEPARTMENT OF TRANSPORTATION

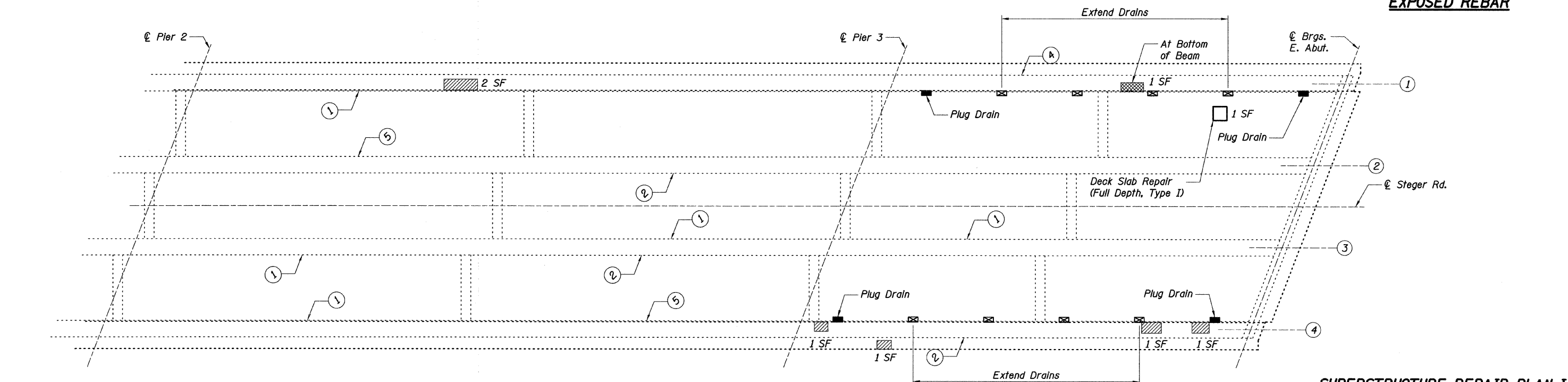

**CLEANING AND PAINTING  
EXPOSED REBAR**

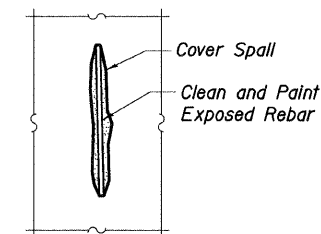

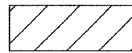
**SUPERSTRUCTURE REPAIR PLAN**

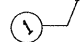
- LEGEND**
-  Structural Repair of Concrete (Depth Equal to or Less Than 5") - Top of Deck
  -  Structural Repair of Concrete (Depth Equal to or Less Than 5") - Bottom of Deck
  -  Denotes Number of Cover Spalls w/ Exposed Reinforcement to be Cleaned and Painted

**SUPERSTRUCTURE REPAIR PLAN I  
STEGER ROAD OVER I-57  
F.A.I. RTE. 57 - SEC. (46-1,2)RS-3&I  
KANKAKEE COUNTY  
STA. 815+16.50  
S.N. 046-0083**

D:\NIB72\well\3.0 deliverables\3.3 structure drawings\final\b4 0083superstr.dgn 4/7/2010

DESIGNED:	GWG
CHECKED:	KPZ
DRAWN:	MAN
CHECKED:	KPZ

**Baker**

SHEET NO. S12 S27 SHEETS	F.A.I. RTE. 57	SECTION (46-1,2)RS-3&I	COUNTY KANKAKEE	TOTAL SHEETS 115	SHEET NO. 37
	CONTRACT NO. 66608			FED. ROAD DIST. NO. 7 ILLINOIS FED. AID PROJECT	