

DESIGN SPECIFICATIONS
2002 AASHTO Standard Specifications for
Highway Bridges, 17th Edition

DESIGN STRESSES

FIELD UNITS

$f'_c = 3,500$ psi
 $f_y = 60,000$ psi (Reinforcement)

EXISTING CONSTRUCTION

$f'_c = 3,500$ psi
 $f_s = 20,000$ psi (Reinforcement)

HIGHWAY CLASSIFICATION

F.A.I. Rte. I-57 - Interstate 57
Functional Class: Interstate
I-57 S.B. ADT: 13,700 (2007); 27,000 (2027)
I-57 N.B. ADT: 13,700 (2007); 27,000 (2027)
Posted Speed: 65 m.p.h.

STATE OF ILLINOIS
DEPARTMENT OF TRANSPORTATION

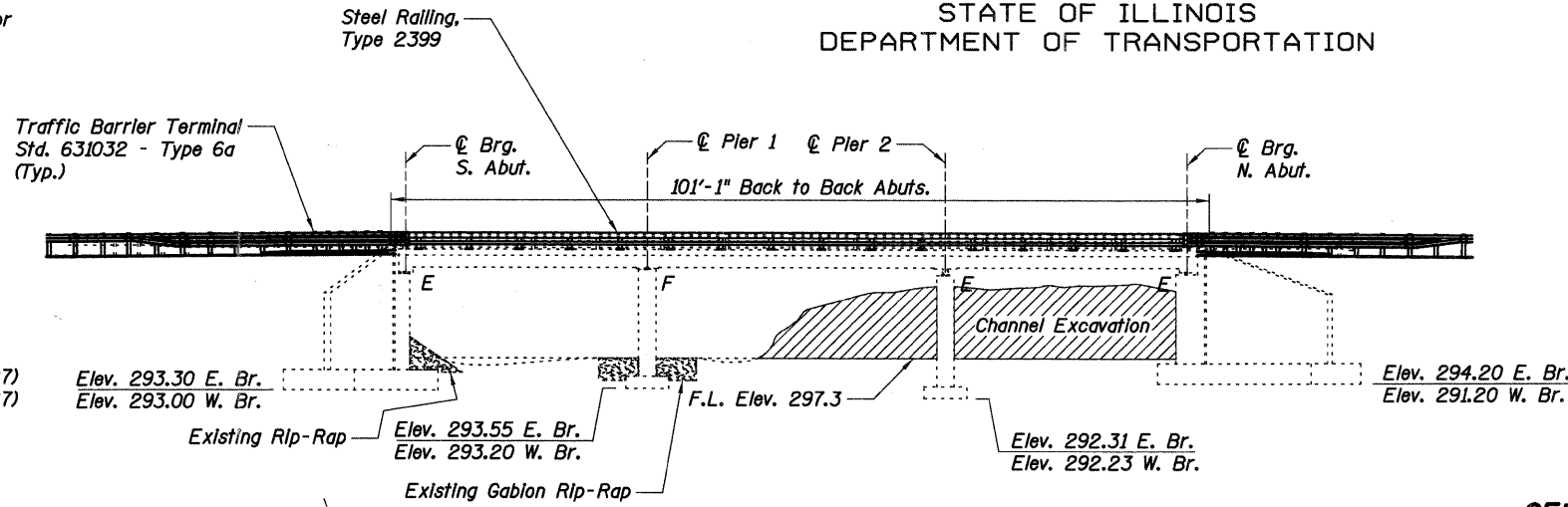

ELEVATION

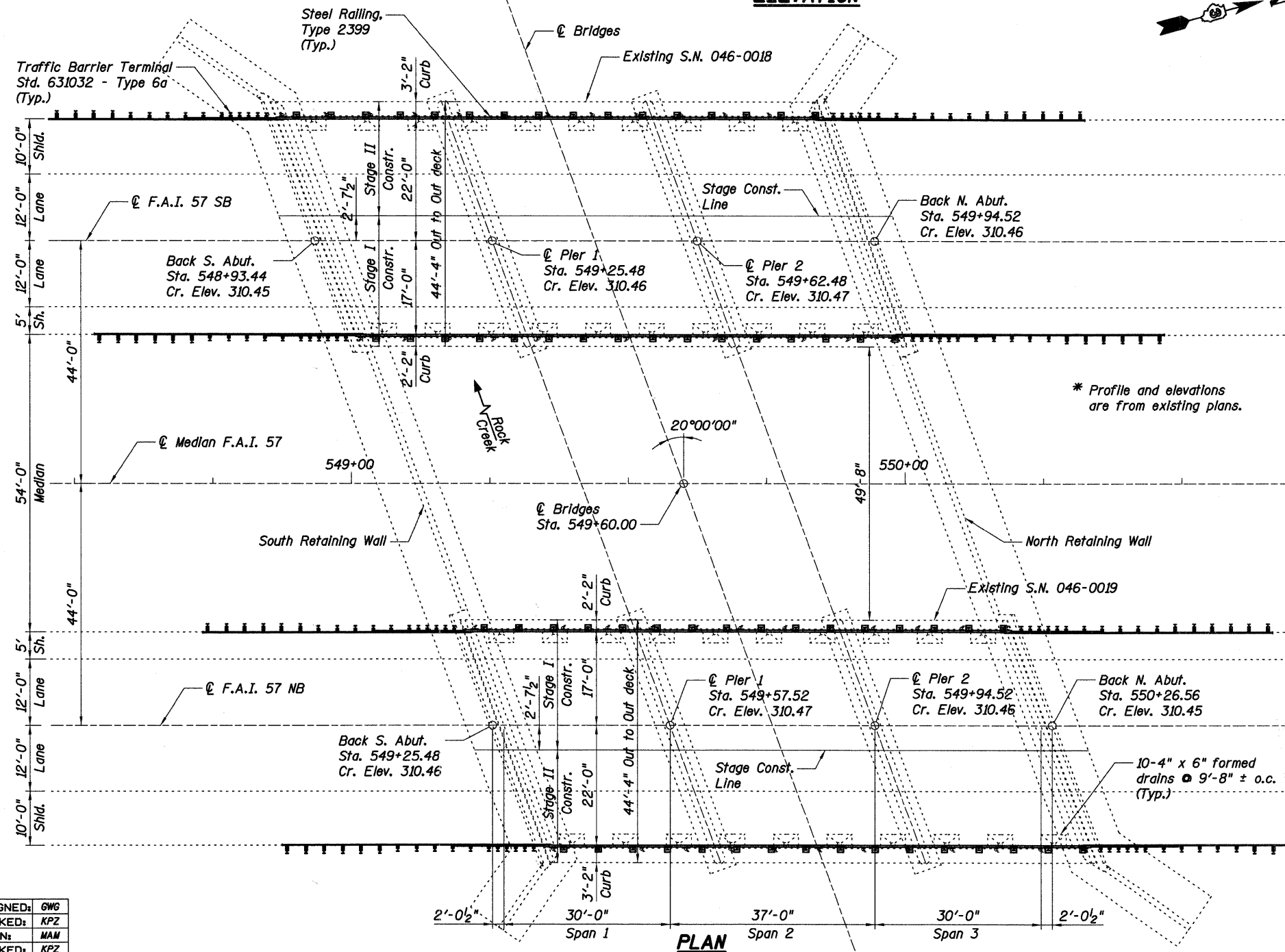

PLAN

PROPOSED WORK:

Traffic shall be maintained using stage construction.

1. Remove the asphalt overlay and membrane.
2. Remove aluminum deck drain extensions prior to Hydro-Scarification, and reinstall after Installation of Latex Concrete Overlay (See Detail A, Sheet S2).
3. Hydro-Scarify the deck.
4. Perform full and partial depth repair on the deck slab and install Latex Concrete Overlay.
5. Remove the existing railings and replace with Steel Railing, Type 2399.
6. Repair spalls and delaminations at the substructures.
7. Perform channel excavation (See Sheet S8).

GENERAL NOTES:

1. Plan dimensions and details relative to existing plans are subject to nominal construction variations. The Contractor shall field verify existing dimensions and details affecting new construction and make necessary approved adjustments prior to construction or ordering of materials. Such variations shall not be cause for additional compensation for a change in scope of the work, however, the Contractor will be paid for the quantity actually furnished at the unit price bid for the work.

INDEX OF STRUCTURAL SHEETS

SHEET	TITLE
S1	GENERAL PLAN AND ELEVATION
S2	STAGING DIAGRAM AND BILL OF MATERIAL
S3	TEMPORARY CONCRETE BARRIER FOR STAGE CONSTRUCTION
S4	S.N. 046-0018 DECK SLAB REPAIR PLAN
S5	S.N. 046-0019 DECK SLAB REPAIR PLAN
S6	STEEL RAILING, TYPE 2399
S7	S.N. 046-0018 SUBSTRUCTURE REPAIR PLAN
S8	S.N. 046-0019 SUBSTRUCTURE REPAIR PLAN



Kenton P. Zini
Expires: 11/10

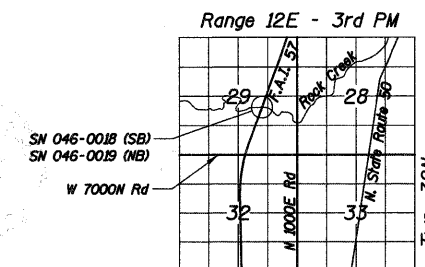

LOCATION SKETCH

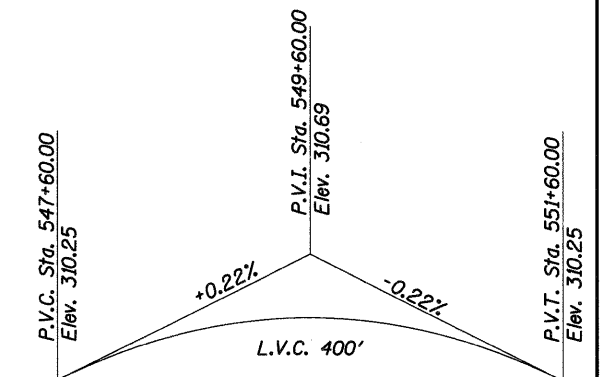

PROFILE F.A.I. 57*
(Same for both lanes)

GENERAL PLAN AND ELEVATION
I-57 OVER ROCK CREEK
F.A.I. RTE. 57 - SEC. (46-1,2)RS-3&I
KANKAKEE COUNTY
STA. 549+60.00
S.N. 046-0018 & S.N. 046-0019

SHEET NO. S1	F.A.I. RTE.	SECTION	COUNTY	TOTAL SHEETS	SHEET NO.
S27 SHEETS	57	(46-1,2)RS-3&I	KANKAKEE	115	26
			CONTRACT NO. 66608		
			FED. ROAD DIST. NO. 7 ILLINOIS FED. AID PROJECT		

Baker

H:\18772_W01\3.0 deliverables\3.3 structure\Drawings\Final\008genplan.dgn 4/17/2010

DESIGNED:	GWG
CHECKED:	KPZ
DRAWN:	MAM
CHECKED:	KPZ