

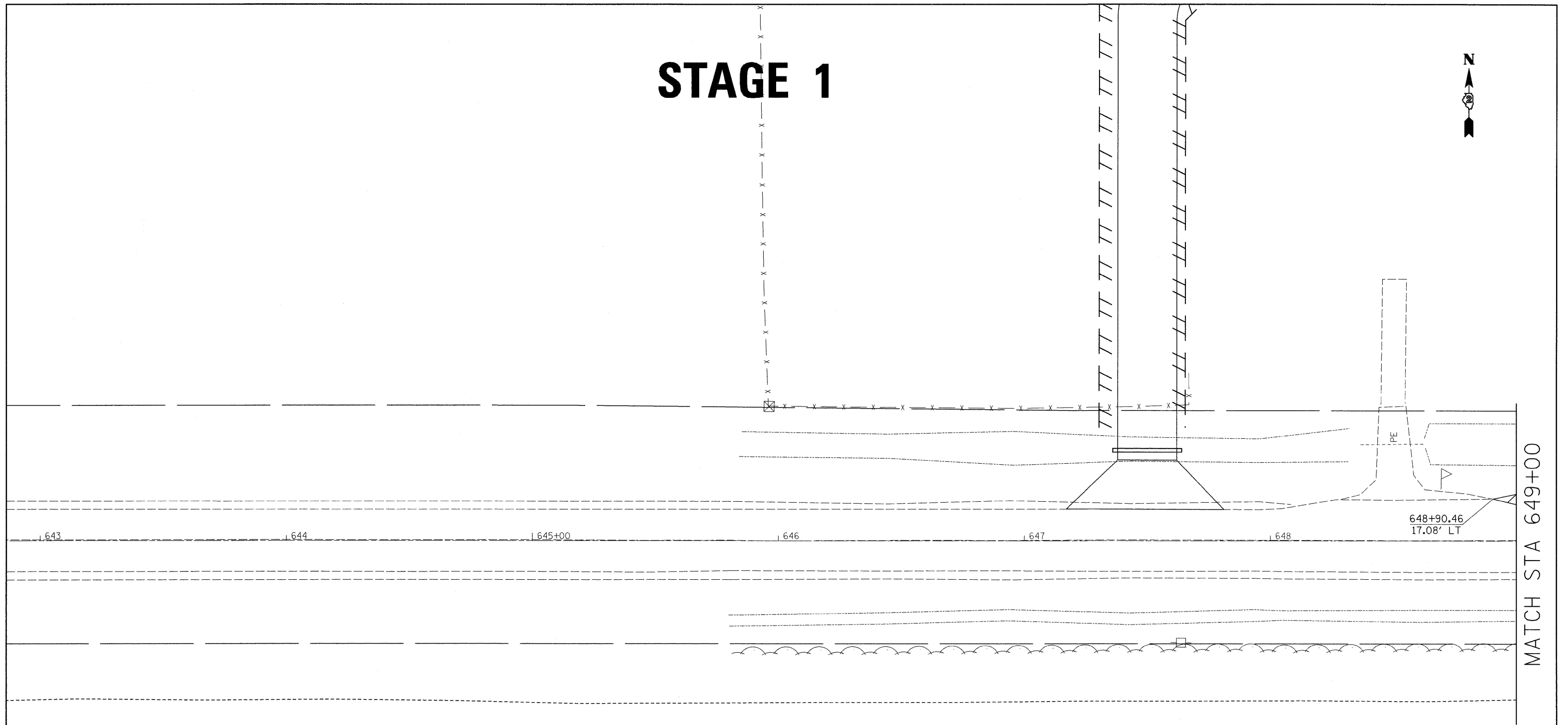







# STAGE 1

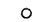

## STAGE 1 NOTES

1. USE STANDARD 701326 FOR TEMPORARY WIDENING.
2. PLACE TEMPORARY WIDENING LT. STA. 649+25 TO STA. 655+75
3. CONSTRUCT TEMPORARY ENTRANCE LT. STA. 647+50

	= WORK ZONE
	= TYPE III BARRICADE WITH FLASHING LIGHTS
	= SIGN
	= BARRICADE, OR DRUM WITH STEDAY BURNING LIGHTS
	= INDUCTION LOOP DETECTOR
	= TRAFFIC SIGNAL
	= TEMPORARY RUMBLE STRIPS

FILE NAME =	USER NAME = grantpm	DESIGNED -	REVISED -	<b>STATE OF ILLINOIS DEPARTMENT OF TRANSPORTATION</b>	<b>STAGE 1</b>	F.A.P. RTE.	SECTION	COUNTY	TOTAL SHEETS	SHEET NO.
ct\pw_work\pwidot\grantpm\dms36948\0204906-sh1-staging.dgn		DRAWN -	REVISED -			585	128T-1	HENRY	35	15
PLOT SCALE = 20.0000' / IN.		CHECKED -	REVISED -			CONTRACT NO. 64G18				
PLOT DATE = Thu Mar 18 11:22:05 2010		DATE -	REVISED -			ILLINOIS FED. AID PROJECT				
				SCALE:	SHEET NO. OF SHEETS STA. TO STA.					