

- ① MH (A-1-C) 4' DIA.
W/ FST (STD 602601)
26.0' LT STA 32+64.81
LID = 641.42
INV = 634.16
- ② MH (A-1-C) 4' DIA.
W/ FST (STD 602601)
36.5' LT STA 32+64.81
LID = 637.39
INV = 627.84
- ③ MH (A-1-C) 4' DIA.
W/ FST (STD 602601)
52.5' LT STA 32+64.81
LID = 631.23
INV = 620.00
- ④ MH (A-1-C) 4' DIA.
68.1' LT STA 32+64.81
LID = 625.24
INV = 612.70

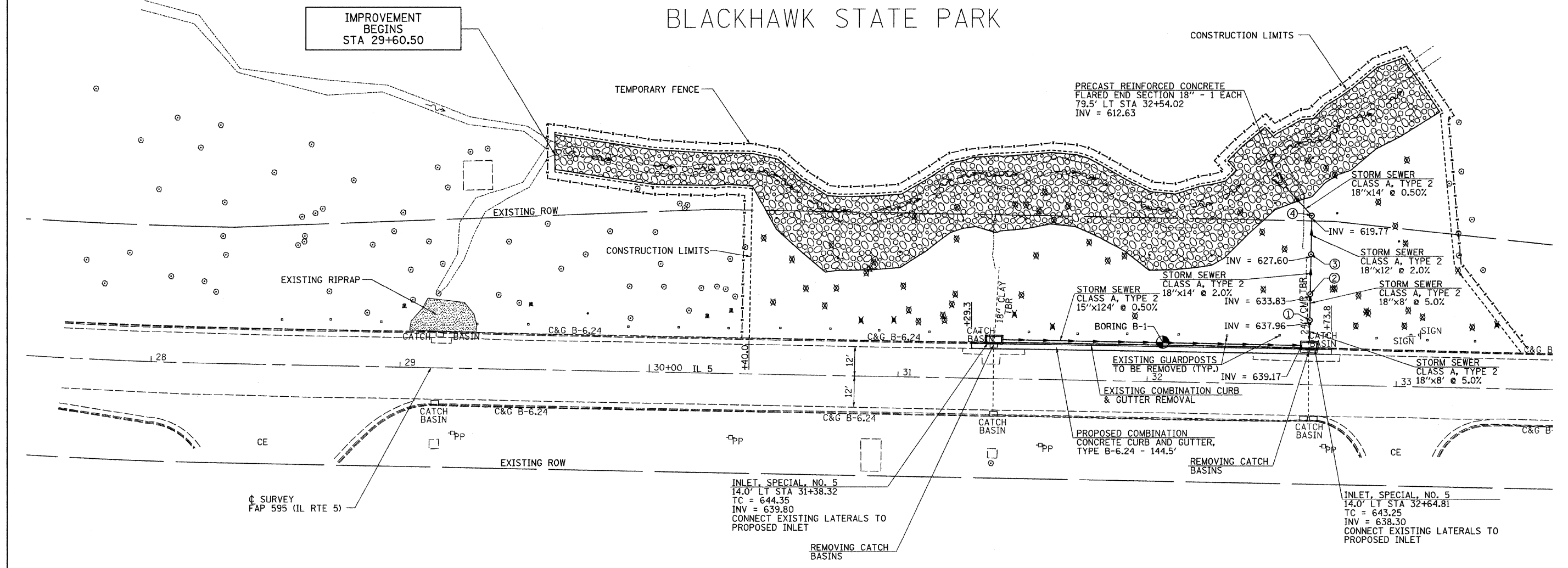

SEC 14, T 17 N, R 2 W, 4TH PM
BLACKHAWK STATE PARK



NOTE: CATCH BASINS TO BE CLEANED
LT STA 37+88.85 13' 0/S/
RT STA 39+87.29 13' 0/S

IMPROVEMENTS
END
STA 39+87.29



X TREE REMOVAL

SEC 14, T 17 N, R 2 W, 4TH PM

FILE NAME =	USER NAME = jdeen	DESIGNED - AWM	REVISED -	STATE OF ILLINOIS DEPARTMENT OF TRANSPORTATION	PLAN SHEET	F.A.P. RTE. = 595	SECTION = (182)M-2	COUNTY = ROCK ISLAND	TOTAL SHEETS = 41	SHEET NO. = 9
v:\transportation\2244\2244-20\202909\PL\1.dgn	DRAWN - T.JD	CHECKED - AWM	REVISED -			SCALE: 1" = 20'-0"	SHEET NO. 1 OF 2 SHEETS	STA. 27+50.00 TO STA. 33+50.00	CONTRACT NO. 64E75	
PLOT SCALE = 20.0000' / IN.	DATE = 3/1/2010	REMOVED -	REVISED -			FED. ROAD DIST. NO. ILLINOIS FED. AID PROJECT				
PLOT DATE = 3/9/2010										