

IMPROVEMENT BEGINS
STATION 1+02

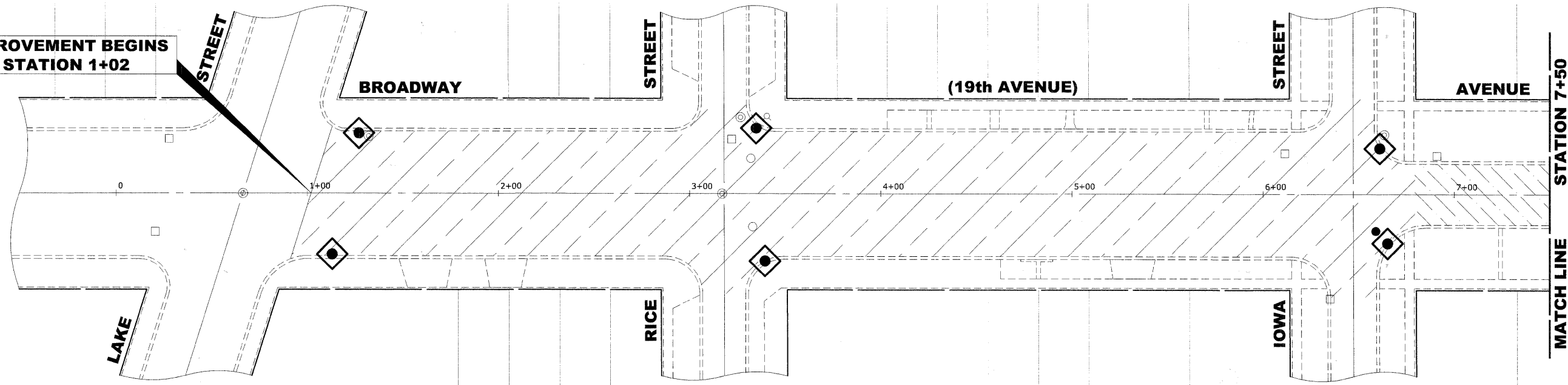

EROSION CONTROL NOTES

- SEE IDOT STANDARD 280001-05 FOR TEMPORARY EROSION CONTROL SYSTEMS.
- THE CONTRACTOR SHALL ENSURE THAT ADJACENT PROPERTIES REMAIN PROTECTED FROM SEDIMENT DEPOSITION.
- SOIL STOCKPILES SHALL BE PROTECTED WITH PERIMETER EROSION BARRIER OR OTHER EROSION PROTECTION SPECIFIED BY THE RESIDENT ENGINEER. THE COST SHALL BE INCLUDED IN THE UNIT PRICE FOR THE INDIVIDUAL SOIL MATERIALS.
- WHEREVER CONSTRUCTION VEHICLE ACCESS ROUTES INTERSECT PAVED PUBLIC ROADS, PROVISIONS SHALL BE MADE TO MINIMIZE THE TRANSPORT OF SEDIMENT BY RUNOFF OR VEHICLE TRACKING ONTO THE PAVED SURFACE. THE PROVISIONS MAY INCLUDE SPRAYING VEHICLE WHEELS TO CLEAR SEDIMENT BEFORE EXITING THE CONSTRUCTION SITE OR OTHER MEASURES APPROVED BY THE ENGINEER.

LEGEND OF SYMBOLS

SYMBOL	DESCRIPTION
	PROPOSED HOT-MIX ASPHALT AREA, PAVEMENT RECONSTRUCTION
	PROPOSED HOT-MIX ASPHALT AREA, PAVEMENT RESURFACING
	INLET FILTER

MATCH LINE

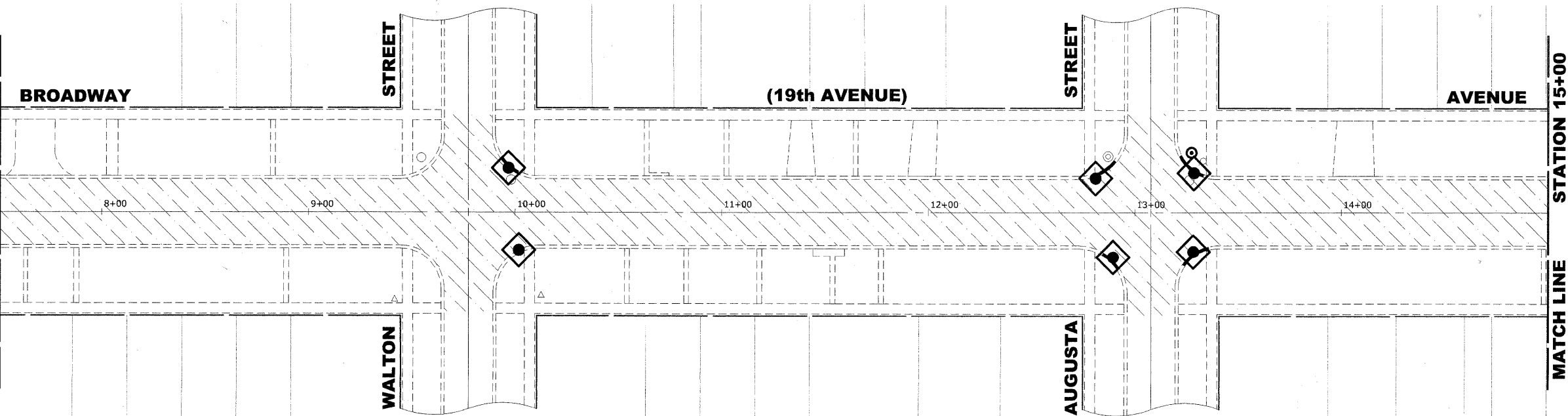

MATCH LINE



USER NAME -
DESIGNED - WOP
DRAWN - MK/LEV/DMM
CHECKED - WOP
PLOT DATE -
DATE - 3-29-10

REVISÉD -
REVISÉD -
REVISÉD -
REVISÉD -

**STATE OF ILLINOIS
DEPARTMENT OF TRANSPORTATION**

EROSION CONTROL AND ASPHALT PLAN

SCALE: 1" = 30' SHEET NO. 1 OF 2 SHEETS STA. 1+02 TO STA. 15+00

ROUTE NO. 2406	SECTION 09-00114-00-FP	COUNTY COOK	TOTAL SHEETS 33	SHEET NO. 24
FIELD BOOK NO. 1588/AERIALS/LL		CONTRACT NO. 63455		
FED. ROAD DIST. NO. 1 ILLINOIS FED. AID PROJECT ARA-M-9003 (516)				

E.H.E. PROJECT NO. 600-09-00101