

STATE OF ILLINOIS
DEPARTMENT OF TRANSPORTATION

TOTAL SHEETS	SHEET NO.
77	39

EAST EDGE OF PAVEMENT

Location	Station	Offset	Theoretical Grade Elevations
End N. Appr. Slab	13+23.12	-26.00	609.96
A1	13+33.12	-26.00	610.02
A2	13+43.12	-26.00	610.07
Bk. N. Abut.	13+53.12	-26.00	610.13

EAST LANE LINE

Location	Station	Offset	Theoretical Grade Elevations
End N. Appr. Slab	13+23.12	-12.00	610.25
A1	13+33.12	-12.00	610.31
A2	13+43.12	-12.00	610.36
Bk. N. Abut.	13+53.12	-12.00	610.42

☉ ROADWAY, P.G. & STAGE CONSTRUCTION JOINT

Location	Station	Offset	Theoretical Grade Elevations
End N. Appr. Slab	13+23.12	0.00	610.44
A1	13+33.12	0.00	610.50
A2	13+43.12	0.00	610.55
Bk. N. Abut.	13+53.12	0.00	610.61

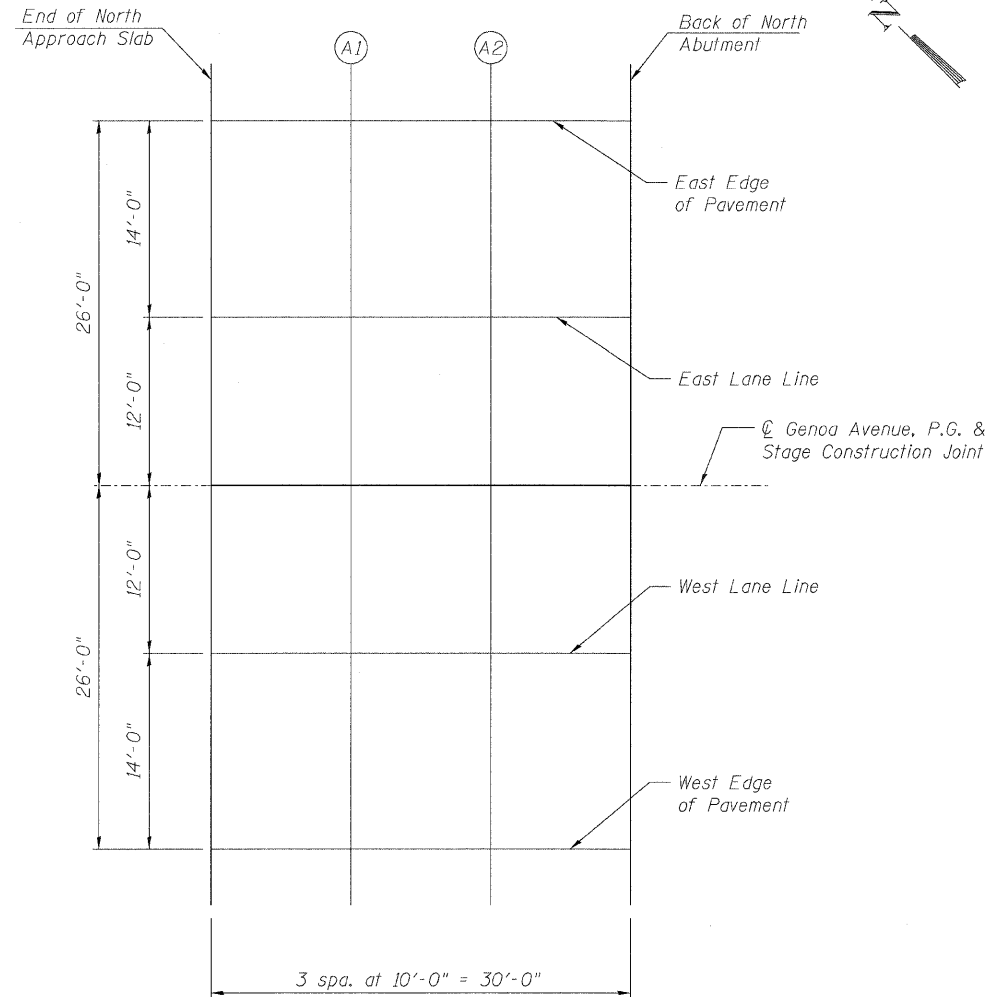

PLAN

WEST LANE LINE

Location	Station	Offset	Theoretical Grade Elevations
End N. Appr. Slab	13+23.12	12.00	610.25
A1	13+33.12	12.00	610.31
A2	13+43.12	12.00	610.36
Bk. N. Abut.	13+53.12	12.00	610.42

WEST EDGE OF PAVEMENT

Location	Station	Offset	Theoretical Grade Elevations
End N. Appr. Slab	13+23.12	26.00	609.96
A1	13+33.12	26.00	610.02
A2	13+43.12	26.00	610.07
Bk. N. Abut.	13+53.12	26.00	610.13

TOP OF NORTH APPROACH
SLAB ELEVATIONS
STRUCTURE NO. 016-2030

	SHEET NO. 9	F.A.I. RTE.	SECTION	COUNTY	TOTAL SHEETS	SHEET NO.	
	32 SHEETS	57	2222.3B	COOK	77	39	
<small>Designed By: ESH Checked By: MTH Drawn By: ESH Date: 7/2009 File: 016-2030.dgn</small>		FED. ROAD DIST. NO. ILLINOIS FED. AID PROJECT				CONTRACT NO. 62119	