

F.A.I. RTE.	SECTION	COUNTY	TOTAL SHEETS	SHEET NO.
57	2222.3B	COOK	77	13
STA. 12+06.00		TO STA. 16+17.11		
FED. ROAD DIST. NO.		ILLINOIS		FED. AID PROJECT

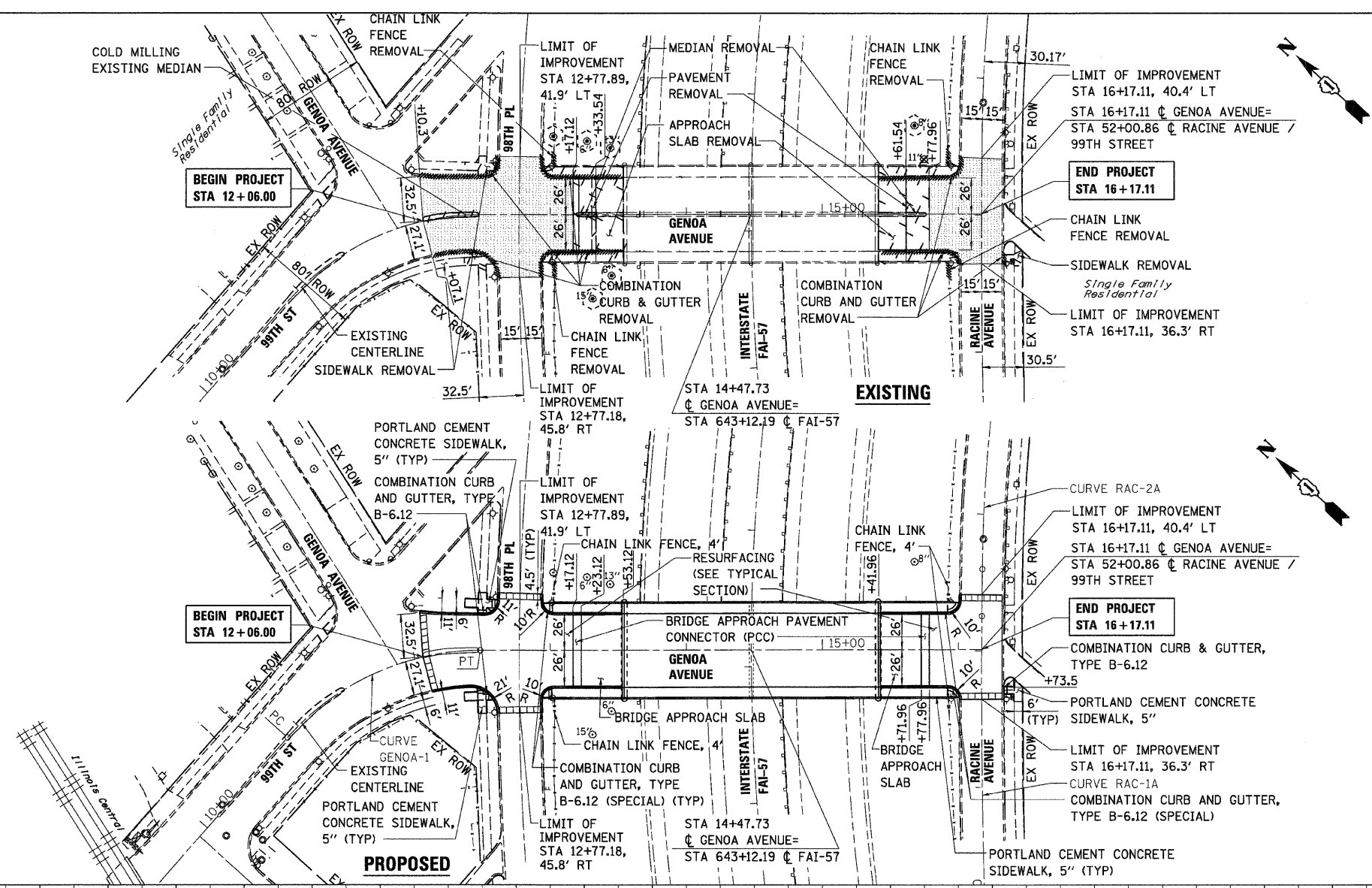

LEGEND:

- HOT-MIX ASPHALT SURFACE REMOVAL - BUTT JOINT
- HOT-MIX ASPHALT SURFACE REMOVAL
- REMOVAL ITEMS
- TREE PROTECTION USING TEMPORARY FENCE
- TREE REMOVAL

NOTE:

1. SEE BRIDGE PLANS AND APPROACH SLAB DETAILS FOR ADDITIONAL INFORMATION.
2. ANY FILL REQUIRED FOR THE PROPOSED SUBGRADE UNDERNEATH THE SIDEWALK SHALL BE CONSIDERED INCLUDED IN THE COST OF THE PAY ITEM FOR PCC SIDEWALK.
3. PCC SIDEWALK 5 INCH, SPECIAL SHALL BE CONSTRUCTED IN LOCATIONS SHOWN IN THE SCHEDULE OF QUANTITIES AND CONSTRUCTED AS PER THE SPECIAL PROVISIONS.

DATE	BY
DATE	BY

DATE	BY
DATE	BY

PLOT DATE = Monday, March 06, 2018
 FILE NAME = S:\11-CADD\01-13\13_550app01.dgn
 PLOT SCALE = 5/8"=1'
 USER NAME = 3658

