

| | | |
|---------------|----|------|
| FINAL SURVEY | BY | DATE |
| SURVEYED | | |
| NOTE BOOK | | |
| TEMPLATE | | |
| AREAS CHECKED | | |
| NO. | | |

| | | |
|-----------------|----|------|
| ORIGINAL SURVEY | BY | DATE |
| SURVEYED | | |
| NOTE BOOK | | |
| TEMPLATE | | |
| AREAS CHECKED | | |
| NO. | | |

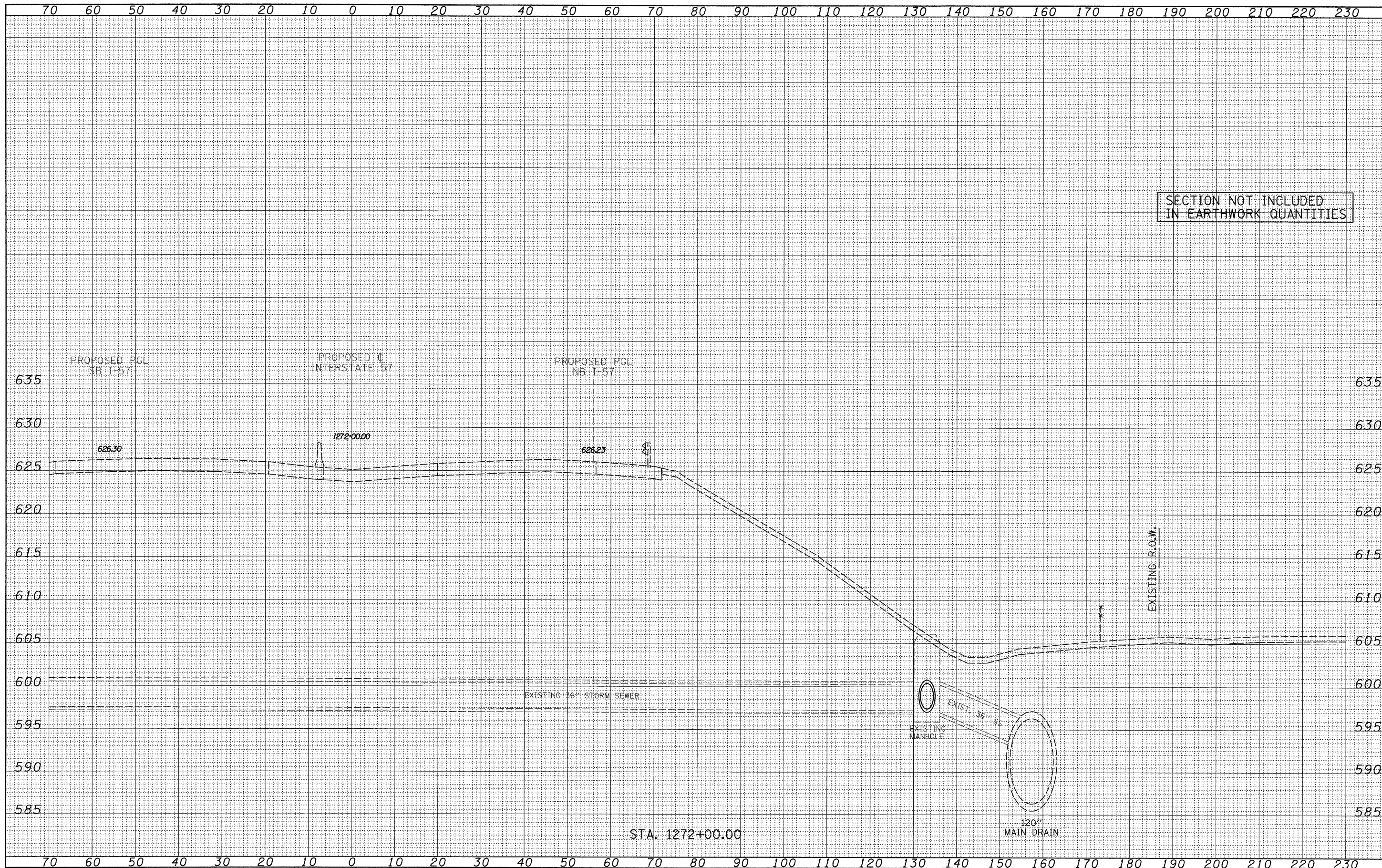

SECTION NOT INCLUDED
IN EARTHWORK QUANTITIES

| | | | | | | | | | | |
|--|------------------|---------------------|---|---|---------------------|------------------------------------|--------------------|-------------|---------------------------|----------------|
| TYLIN INTERNATIONAL USER NAME = PLOT SCALE = PLOT DATE = | DESIGNED - JDF | REVISED - 4/29/2010 | STATE OF ILLINOIS DEPARTMENT OF TRANSPORTATION | I-57 AT I-294 INTERCHANGE PROJECT PROPOSED I-57 CROSS SECTIONS | | F.A.I. RTE. 57 | SECTION 1414.28 | COUNTY COOK | TOTAL SHEETS 516 | SHEET NO. 516J |
| | DRAWN - JDF | REVISED - | | SCALE: 1" = 10' H | SHEET NO. OF SHEETS | STA. 1272+00.00 TO STA. 1272+00.00 | CONTRACT NO. 60J27 | | ILLINOIS FED. AID PROJECT | |
| | CHECKED - JPM | REVISED - | | | | | | | | |
| | DATE - 3/18/2010 | REVISED - | | | | | | | | |

P:\602540(57-294)\Road\PI.157 BR\PI.157XS_SHT_R.dgn